



Holly Project

Open House #3

Virtual Public Meeting

June 24, 2021



Agenda

1. Meeting Guidelines
2. Introduction of Guest Speakers
3. Holly Shores Vision Plan / Lakefront Trail
4. The Trail Foundation
5. Planning Process / Timeline
6. Review Public Input
7. Review Updated Plan
8. Open Discussion
9. What Comes Next

This session is being recorded.





Holly Shores/ Edward Rendon Sr. at Festival Beach

Vision Plan

Figure 25.
Aerial sketch view showing
preliminary master plan
concepts

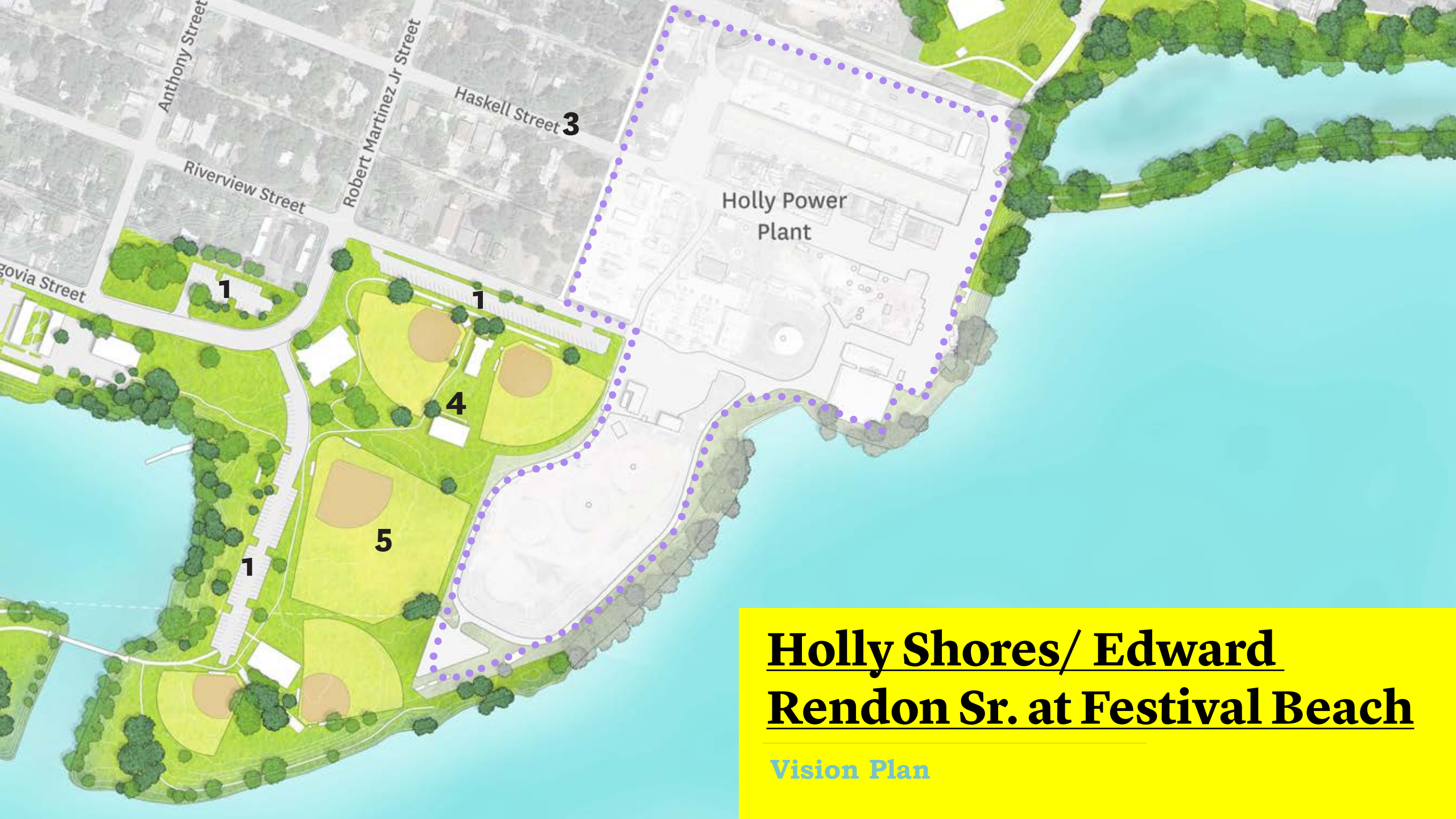

Holly Shores/ Edward Rendon Sr. at Festival Beach

Vision Plan



**Holly Shores / Edward Rendon Sr. Park
at Festival Beach - Vision Plan Goal:**

**Improve path and trail connections
around the Austin Energy property.**

- **Canoe Launch**
- **Picnic Garden**
- **Viewpoint**
- **ADA Accessible Paths**
- **Pedestrian, Bicycle, and Service Paths**
- **Pier**
- **Wetland Habitat**



**Holly Shores / Edward Rendon Sr. Park
at Festival Beach - Vision Plan Goal:**

**Improve path and trail connections
around the Austin Energy property.**

- **Canoe Launch**
- **Picnic Garden**
- **Viewpoint**
- **ADA Accessible Paths**
- **Pedestrian, Bicycle, and Service Paths**
- **Pier**
- **Wetland Habitat**



The Trail Foundation Core Values

- **Community**
Champion diversity and access for all.
- **Excellence**
Dream big, set a bold vision and achieve transformative results.
- **Collaboration**
Cultivate strong partnerships to amplify our efforts.
- **Stewardship**
Honor the legacy of the Trail and ensure its vitality for generations to come.
- **Environment**
Preserve and protect the urban natural setting and our experience in it.
- **Well-being**
Stay safe, be healthy, have fun.





Zilker Trailhead

With the growing use of the Trail, there is an increasing number of Trail users entering between the end of the Zilker berms and the Trail's native areas. By creating a trailhead that addresses this increased use, while protecting the sensitive natural areas, we can accommodate the needs of nature and users alike.



Lamar Boardwalk Study (Northshore)

One of the few remaining pinch points, the Trail at Lamar and Cesar Chavez poses a safety hazard due to its proximity to the busy street. A feasibility study on an overwater boardwalk structure could provide a road map to a safer Trail in this area.



North Drake Bridge Trail Under Bridge

This project intends to improve the zone under the north side of the First Street Bridge, giving particular consideration to the water's edge, the Trail surface and the concrete abutment of the bridge itself. It may also consider concessions, seating, lighting and artwork. While the focus is the area under the bridge itself, an extended zone on each side will also be considered. Funds will be used to hire designers for development of the vision, scope and conceptual design.



Brazos Bluff

The parkland adjacent to the Four Seasons is steeply sloped, causing significant erosion of the Trail and the riparian edge when it rains. This project would address the stormwater that flows across this site in an aesthetically pleasing and ecologically sensitive manner that prevents further erosion of the Trail and the lake edge. This includes a deck along the Trail for users to gather or rest as well as to protect the existing shade trees' sensitive roots.



Playground - East Side

As Austin continues to grow, more and more families are looking for places to gather, rest and play along the Trail. The Trail Foundation would like to provide creative spaces for play that will engage entire families and reflect the immersive feeling of nature the Trail evokes.



Holly Project - Fiesta Gardens Water Access

Anticipating the realignment of the Trail along Holly Shores in 2019, there will be increased desire to view and access the water, whether for kayaking, fishing or other recreation. By providing more formalized access in an area that is already well used, we can protect the riparian habitat while still allowing people to engage in the activities that they love.



Holly Trail Enhancement

As part of the future phase of the Holly Shores Master Plan, the Austin Parks and Recreation Department will realign the Trail to the lake edge. With this realignment comes the opportunity to provide shade and cooling through creative design solutions and trees.



Holly Shores Trailhead - Connection to EastLink Trail

Connectivity for pedestrians and cyclists is a growing priority for the City of Austin, and providing a safe connection to EastLink at the new Trail alignment at Holly Shores brings together two important trails that will connect all Austinites.



Pleasant Valley/Lakeshore Trailhead & Water Access

With the completion of the Oracle Campus across Lakeshore Boulevard, and the proposed upgrade to the Country Club Creek Trail across Pleasant Valley, the parkland and Trail at Pleasant Valley and Lakeshore Boulevard will become more heavily used than ever before. As shown in the TTF-created Southeast Shores Masterplan, a trailhead will create a gathering space for people to meet, as well as a water access point to interact with the water and nature, while protecting sensitive shoreline habitat.



Pleasant Valley/Lakeshore Blvd Restroom

As the east side of the Trail continues to see increased usage, the Pleasant Valley and Lakeshore Boulevard intersection will function more as a Trailhead and entry point. With Country Club Creek Trail across the street and the nearest rest-rooms over a half mile away, there is great need for a restroom facility.



Comprehensive Signage (entire Trail)

Excellent signage is a critical component of a successful urban trail. TTF has already completed a Master Signage Package that has been installed west of I-35 that includes wayfinding and spoke trails signs. This signage promotes a favorable image of Austin characterized by originality, quality, beauty and civic pride. Not only does the master signage package need to be installed on the Trail's east side, an inventory of all remaining Trail signs needs to be completed so that all signage is comprehensive coordinated and functional.



Ecological Restoration (entire Trail)

The Trail Foundation's Ecological Restoration program is now entering its fifth year of implementation. Using the Ecological Restoration Guidelines as reference for this ongoing work, this program continues to grow in sophistication and impact for the health of the Trail and surrounding parkland ecosystems. This program encourages the strategic use of resources from all city departments, including the Parks and Recreation Department, Forestry and Watershed Protection, to have the greatest impact to the ecological and aesthetic value of an exceptional natural resource, our Trail.



Festival Beach Restroom Replacement

The existing restroom at Festival Beach, east of I-35, has been identified for replacement in the Holly Shores Master Plan. The selection of an architect that is sensitive to the depth of history and cultural identity of this special park space is imperative to creating a successful design for this facility.



Lakeshore Park: Deck and Overlook

On the Boardwalk's east side, off Lakeshore Boulevard, are two opportunities to provide inviting gathering spaces through the creation of an over water platform at an existing outfall structure as well as a deck underneath the towering Live Oaks overlooking a playful, grassy field.



Bridge Study: Holly/Lakeshore Peninsula

While the Trail's west side has regular north/south opportunities to cross the lake, the 4 miles of Trail on the east side do not. TTF would like to conduct a feasibility study on the north/south connection from the new Trail alignment at Holly Shores to the peninsula off Lakeshore Blvd.



The Trail Foundation
15th Anniversary

Holly Project: **Timeline**

Phase 1 | Understanding Conditions and Needs

- February-April 2019**
 - Project Scoping
- One-on-one meetings with community members
- May 2019**
 - Project Introduction Event at Camacho Activity Center - May 18
 - Project Survey Launched
- June – August 2019**
 - Community Open House - June 8
 - Small Group Discussions
 - Butler Hike-and-Bike Trail Tabling
 - Survey Close

Phase 2 | Development of Schematic Design & Review

- September – November 2019**
 - Review of Public Input
 - Draft Concept Design
 - Small Group Discussions
- December 2019 - May 2021**
 - Concept Design Presentations
 - Community Open House
 - Plan Review and Revisions
- June – August 2021**
 - Community Open House to Present Updated Design
 - PARC Review & Approval

Phase 3 | Fundraising /Design Dev.

- Newly Projected
Fall 2021 – Winter 2022**
 - Project Fundraising
 - Design Development
 - Permitting
(Tentative)

Phase 1: Holly Vision Plan Public Input

The vision plan goals emerged out of a robust and open community process and represent many voices and opinions. The over-arching call was for this place to remain first and foremost a neighborhood park, and many of the goals stemming from that are concerned with better connectivity, openness and integration between the various park elements, so that the park itself will continue to encourage connectivity within the community.

Beyond that, an emphasis on the natural environment, a tranquil and pastoral character, and park comfort will make Holly Shores an even better place to find a moment of respite from the stresses of city life.

- ✓ **Maintain neighborhood park character, while improving amenities, comfort and maintenance.**
- ✓ Align with 1989 Town Lake Comprehensive Plan.
- ✓ **Improve path and trail connections around the Austin Energy property.**
- ✓ Integrate ball fields with the wider park landscape.
- ✓ Improve lagoon water quality and open to surrounding landscape.
- ✓ Reuse existing buildings for community-based program as a focus of park activity.
- ✓ **Improve pedestrian and bicycle accessibility and connectivity.**
- ✓ Maintain the simple, tranquil character of the West Park.
- ✓ **Preserve and enhance tree canopy and wildlife habitat.**
- ✓ Celebrate local art and heritage throughout the park.

Phase 1: Public Engagement Events & Activities 2019

April (7 Community Leaders)

In-depth Interviews

April 29 (5 sign-ins)

ETLCNA Town Hall
6:00 to 8:00 PM

May 18 (16 sign-ins)

Project Kick-off Event
Camacho Activity Center
9:00 to 12:00 PM

June 8 (42 sign-ins)

Public Open House
(4,000 mailers in Eng/Span mailed to neighborhood)
Camacho Activity Center
10:00 to 12:00 PM

June 12 (6 sign-ins)

Group Presentation
Festival Beach Community Garden
Terrazas Branch Library
6:00 to 8:00 PM

June 13 (22 sign-ins)

Group Presentation
Rebekah Baines Johnson Center (RBJ Center)
3:00 to 4:00 PM

June 15 (12 sign-ins)

Holly Point Tabling/Intercepts
Butler Hike-and-Bike Trail
8:00 to 10:00 AM

June 19 (20 attendees)

Group Presentation
East Cesar Chavez
Neighborhood Contact Team
Terrazas Branch Library
6:00 to 8:30 PM

August 1 (3 surveys)

ETLCNA - Neighborhood Meeting
5:30 to 7:30 PM

September 21 (15 sign-ins)

Hispanic Heritage Month
Cepeda Branch
Library/Parque Zaragoza
Recreation Center
10:00 to 1:00 PM

7

In-depth interviews with community leaders

136+

Participant sign-ins at tablings, presentations, meetings

247

Survey responses

Phase 1: Public Input Received

- Are there specific concerns or areas that you feel should be considered in the planning to improve ADA accessibility?
“improved access to the waterfront”
- What would enhance security or safety?
“improved lighting would make the park feel safer”
- Are there any existing challenges/obstacles that prevent you from accessing the water?
“a lack of existing ramps, pathways that provided access to the water or were wheelchair accessible. Erosion, steep slopes and banks at the water’s edge and vegetation overgrowth”
- What improvement would you like to see that could enhance/improve your access to the water?
“increasing boat access with a dock, boat ramp, and fishing pier.” “seating by the water with views”
- Do you have any concerns about the current vegetation at Holly Point, and what would you like to see improved?
“greater use of native plants” “support a healthy habitat for birds, fish and other wildlife”

Phase 2: Public Engagement Events & Activities



December 7, 2019
Public Open House
(35 Participants)
Camacho Activity Center
9:00 to 12:00 PM

December 16, 2019
Group Presentation
(15 Participants)
Rebekah Baines Johnson Center
(RBJ Center)
3:00 to 4:30 PM

December 18, 2019
Group Presentation
East Cesar Chavez Neighborhood
Contact Team
(7 Participants)
Terrazas Branch Library
6:00 to 8:30 PM

December 21, 2019
Holly Project Tabling/Intercepts
(29 Participants)
Butler Hike-and-Bike Trail
9:00 to 11:00 AM

January 10, 2020
Parent Meeting (Spanish-speaking)
(9 Participants)
Metz Elementary
8:00 to 9:00 AM

95+
Participant sign-ins at tablings,
presentations, meetings

142
Questionnaire responses

Phase 2: Schematic Design Concepts



Concept 'A'



Concept 'B'

Phase 2: Sampling of Public Input from December 2019

“Keep it simple and natural with focus on native plants. Less is more”

“More formal/identifiable spots to fish off the banks.

“One of the important unique features of the trail is its natural feel. Use of man-made hardscape materials and non-native vegetation should be limited in favor of natural materials and vegetation that will provide the trail with an Austin vibe.

“Se veria muy elegante y seria un punto clave de el parque.”

“Este concepto tiene más aprovechamiento del terreno, los merenderos pueden ser usados por varias familias y la pérgola seria un éxito.”

“One added benefit of this concept is that it seems to keep the space natural looking and untouched - I like having more area of that in the city and accessible to all.”

“The less vegetation blocking the view of the water the better.”

“Leave it as wild as possible.”

Updated Plan



Phase 2: Design Approach

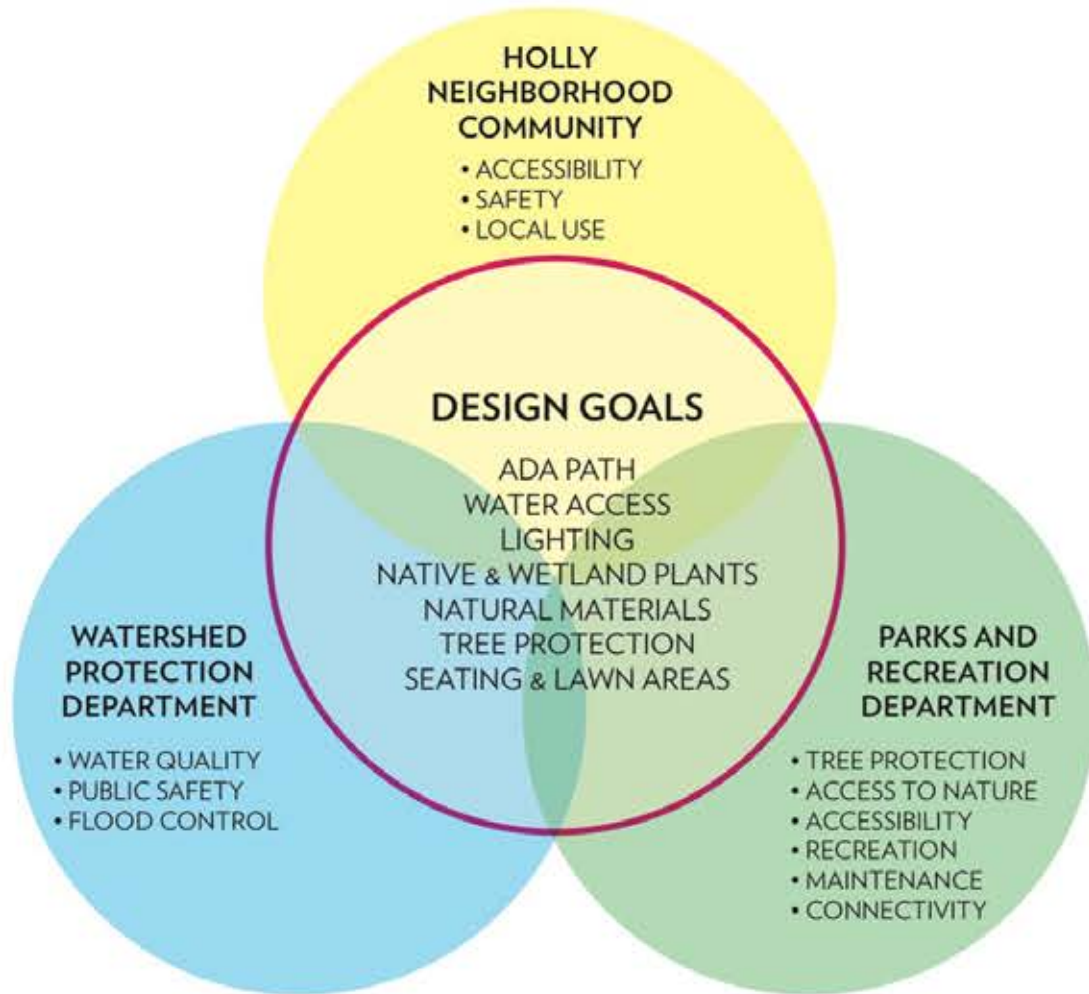

Phase 2:

Trail Plan

Plano de Senderos



Phase 2:

Seating Plan

Plano de Áreas Para Sentarse



Phase 2:

Planting Plan

Plano de Plantaciones





NATIVE GRASSES, FLOWERING PERENNIALS & SHRUBS | GRAMAS NATIVAS, PLANTAS DE FLORACION PERENNE Y ARBUSTOS

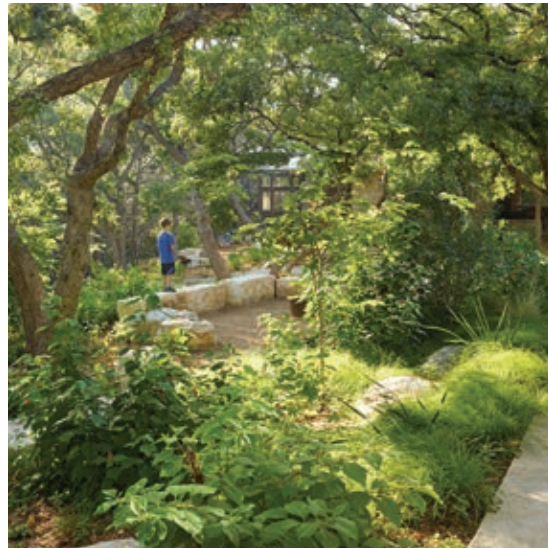

SHADE-TOLERANT PLANTINGS | PLANTACIONES TOLERANTES A LA SOMBRA

WETLANDS PLANTS | PLANTAS DE ZONAS HUMEDAS

LAWN | JARDIN



PAVING: DECOMPOSED GRANITE, CONCRETE PATH, ENGINEERED WOOD FIBER MULCH
PAVIMENTACIÓN: GRANITO DESCOMPUESTO, RECORRIDO DE CONCRETO, COBERTURA DE SUELO DE FIBRA DE MADERA DE INGENIERÍA

SALVAGE OAK TREE STUMPS: SEATING AND NATURE PLAY
TRONCOS DE ROBLES DE SALVAMENTO: ASIENTOS Y JUEGOS EN LA NATURALEZA



WATER ACCESS: PIER, STEPS AT WATER'S EDGE
ACCESO AL AGUA: MUELLE, ESCALONES FRENTE AL AGUA

BRIDGE OVER SWALE
PUENTE SOBRE EL ALCANTARILLADO

DRAINAGE SWALE
ALCANTARILLADO DE DESAGÜE



PLANT PROTECTION: EDUCATIONAL SIGNAGE, RUSTIC FENCE, STONE CURBS
PROTECCIÓN DE PLANTAS: SEÑALIZACIÓN EDUCACIONAL, CERCA RÚSTICA, CURVAS DE PIEDRA

SEATING: STONE BENCH SEATING, GARDEN BENCHES
ÁREAS PARA SENTARSE: BANCAS DE PIEDRA, BANCAS DE JARDÍN

PROPOSED IMPROVEMENTS | MEJORAS PROPUESTAS

Phase 2:

Site Plan

Plano del Sitio



Open Discussion



Chat



Raise Hand



Q&A

Please Complete the Questionnaire:

https://www.surveymonkey.com/r/TTF-Holly_Project

Holly Project: **Timeline**

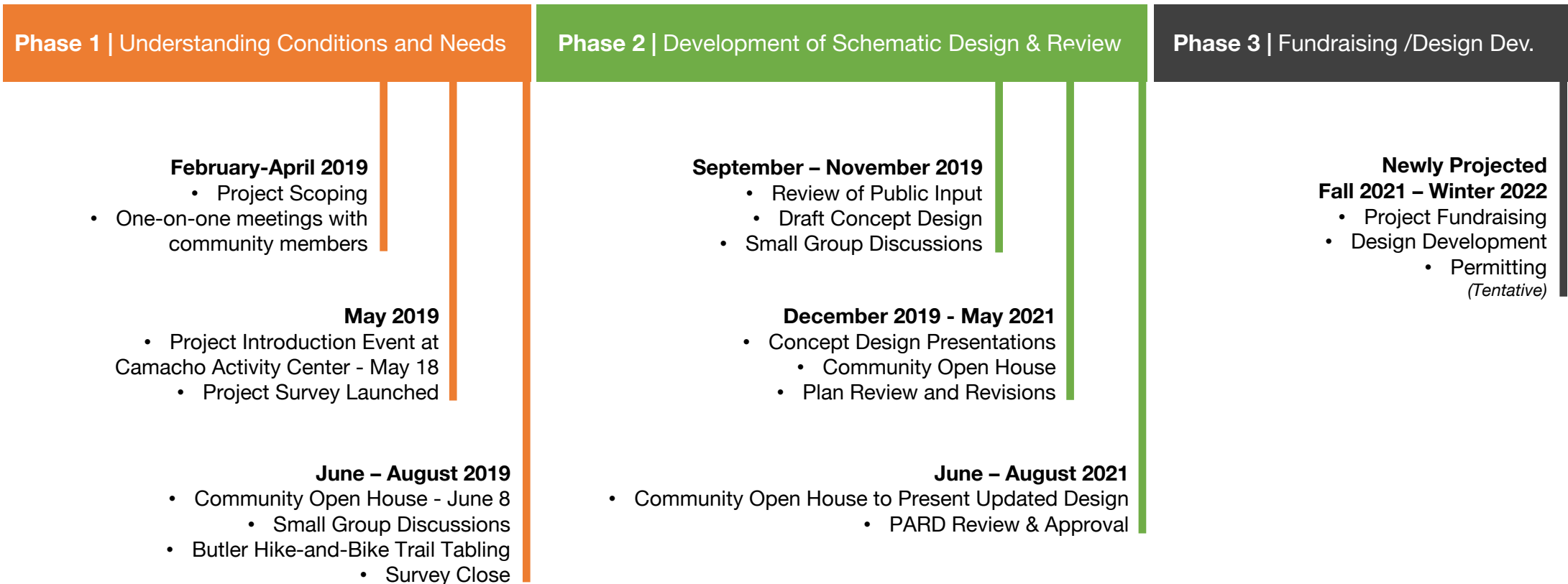



Holly Project Thank You!

thetrailfoundation.org

