

EAST RIVERSIDE/OLTORF COMBINED NEIGHBORHOOD PLAN
Future Land Use Map --DRAFT
March 1, 2007 City Council Hearing
Tracts 45 and 45B

Tract 45 (1801-1919 E Riverside Dr)
 Tract 45B (1905 E Riverside Dr)
 Land Use Designation of Mixed Use

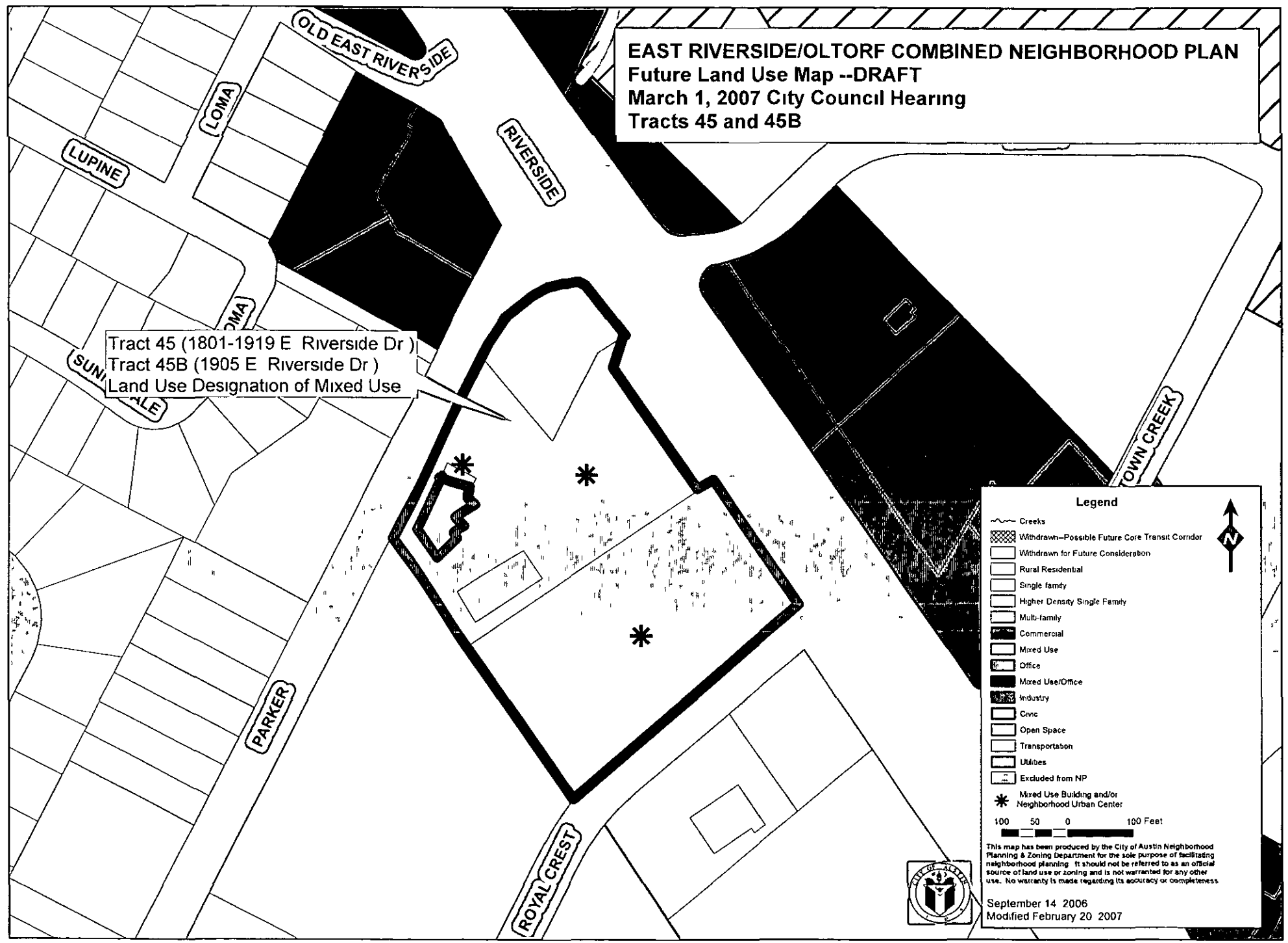

Legend

- Creeks
- Withdrawn--Possible Future Core Transit Corridor
- Withdrawn for Future Consideration
- Rural Residential
- Single family
- Higher Density Single Family
- Multi-family
- Commercial
- Mixed Use
- Office
- Mixed Use/Office
- Industry
- Civic
- Open Space
- Transportation
- Utilities
- Excluded from NP
- Mixed Use Building and/or Neighborhood Urban Center

100 50 0 100 Feet

This map has been produced by the City of Austin Neighborhood Planning & Zoning Department for the sole purpose of facilitating neighborhood planning. It should not be referred to as an official source of land use or zoning and is not warranted for any other use. No warranty is made regarding its accuracy or completeness.

September 14, 2006
 Modified February 20, 2007

