

ORDINANCE NO. _____

1 AN ORDINANCE REZONING AND CHANGING THE ZONING MAP FOR THE
2 PROPERTY LOCATED AT 7520-7530 NORTH LAMAR BOULEVARD IN THE
3 CRESTVIEW NEIGHBORHOOD PLAN AREA FROM LIMITED INDUSTRIAL
4 SERVICE-PLANNED DEVELOPMENT AREA-NEIGHBORHOOD PLAN (LI-
5 PDA-NP) COMBINING DISTRICT TO PUBLIC-NEIGHBORHOOD PLAN (P-NP)
6 COMBINING DISTRICT.

7
8 **BE IT ORDAINED BY THE CITY COUNCIL OF THE CITY OF AUSTIN:**

9
10 **PART 1.** The zoning map established by Section 25-2-191 of the City Code is amended to
11 change the base district from limited industrial service-planned development area-
12 neighborhood plan (LI-PDA-NP) combining district to public-neighborhood plan (P-NP)
13 combining district on the property described in Zoning Case No. C14-2007-0095, on file at
14 the Neighborhood Planning and Zoning Department, as follows:

15
16 Lots 1-4, Block A, Northgate Addition, a subdivision in the City of Austin, Travis
17 County, Texas, according to the map or plat of record in Plat Book 3, Page 196, of
18 the Plat Records of Travis County, Texas; and

19
20 Tracts 1 and 2, Kivlin-Smith Subdivision, a subdivision in the City of Austin,
21 Travis County, Texas, according to the map or plat of record in Plat Book 29, Page
22 43, of the Plat Records of Travis County, Texas (the "Property"),

23
24 locally known as 7520-7530 North Lamar Boulevard, in the City of Austin, Travis County,
25 Texas, and generally identified in the map attached as Exhibit "A".

26
27 **PART 2.** Except as otherwise provided in this ordinance, the Property is subject to
28 Ordinance No. 040401-32B, amended by Ordinance No. 040415-50, that established the
29 Crestview neighborhood plan combining district.
30
31
32
33
34
35
36
37

1
2 **PART 3.** This ordinance takes effect on _____, 2007.
3

4
5 **PASSED AND APPROVED**
6

7 §
8 §
9 _____, 2007 § _____
10

11 Will Wynn
12 Mayor
13

14 **APPROVED:** _____ **ATTEST:** _____
15

16 David Allan Smith
City Attorney

Shirley A. Gentry
City Clerk

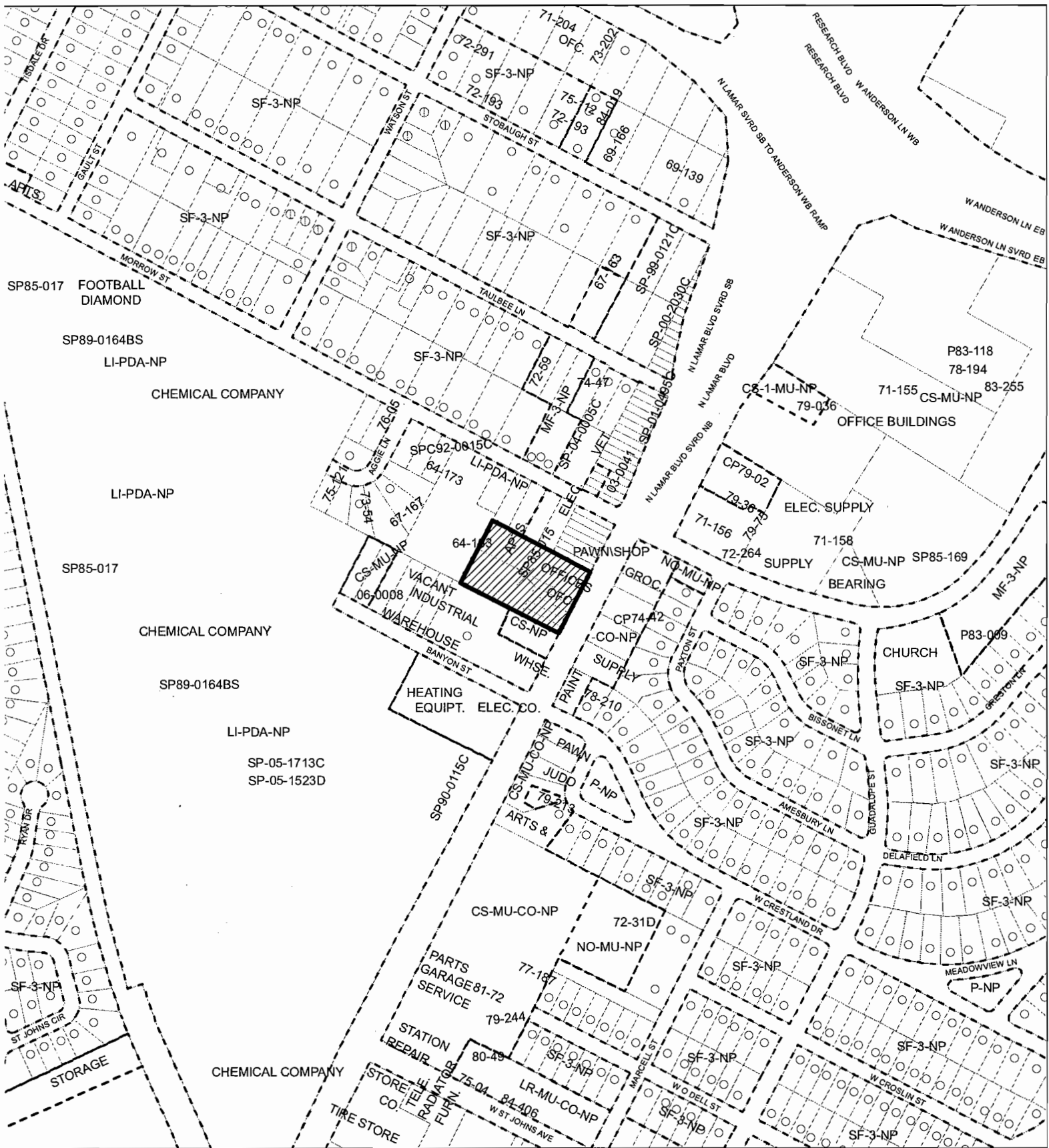

ZONING

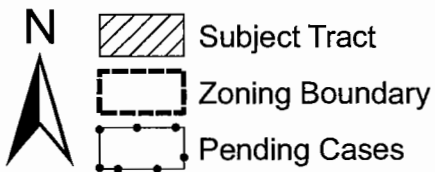

ZONING CASE#: C14-2007-0095
ADDRESS: 7520 N LAMAR BLVD
SUBJECT AREA: 2.036 ACRES
GRID: K28-29
MANAGER: J. ROUSSELIN



1" = 400' OPERATOR: SM

This map has been produced by G.I.S. Services for the sole purpose of geographic reference. No warranty is made by the City of Austin regarding specific accuracy or completeness.