

ORDINANCE NO _____

1 **AN ORDINANCE REZONING AND CHANGING THE ZONING MAP FOR THE**
2 **PROPERTY LOCATED AT 11726 JOLLYVILLE ROAD FROM SINGLE FAMILY**
3 **RESIDENCE STANDARD LOT (SF-2) DISTRICT AND LIMITED OFFICE (LO)**
4 **DISTRICT TO LIMITED OFFICE-CONDITIONAL OVERLAY (LO-CO)**
5 **COMBINING DISTRICT**

6
7 **BE IT ORDAINED BY THE CITY COUNCIL OF THE CITY OF AUSTIN**

8
9 **PART 1** The zoning map established by Section 25-2-191 of the City Code is amended to
10 change the base district from single family residence standard lot (SF-2) district and
11 limited office (LO) district to limited office-conditional overlay (LO-CO) combining
12 district on the property described in Zoning Case No C14-2007-0148, on file at the
13 Neighborhood Planning and Zoning Department, as follows

14
15 Lot A, Summit Oaks Annex Subdivision, a subdivision in the City of Austin,
16 Travis County, Texas, the property being more particularly described in a warranty
17 deed of record in Volume 11351, Page 527, of the Official Public Records of
18 Travis County, Texas (the "Property"),

19
20 locally known as 11726 Jollyville Road, in the City of Austin, Travis County, Texas, and
21 generally identified in the map attached as Exhibit "A"

22
23 **PART 2** The Property within the boundaries of the conditional overlay combining district
24 established by this ordinance is subject to the following conditions



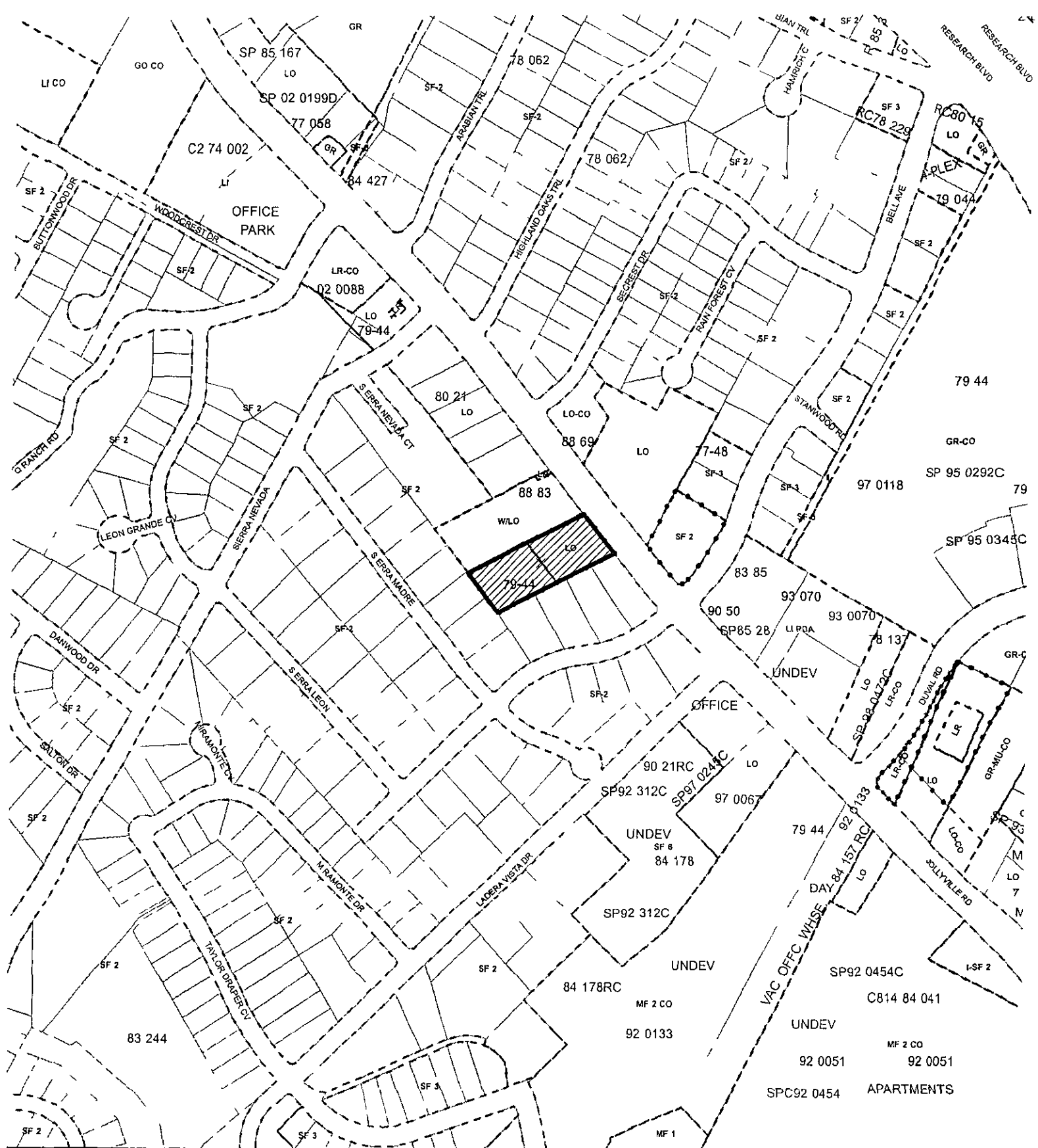

25
26 A A site plan or building permit for the Property may not be approved, released,
27 or issued, if the completed development or uses of the Property, considered
28 cumulatively with all existing or previously authorized development and uses,
29 generate traffic that exceeds 2,000 trips per day

30
31 B The maximum height of a building or structure on the Property is 35 feet from
32 ground level

33
34 Except as specifically restricted under this ordinance, the Property may be developed and
35 used in accordance with the regulations established for the limited office (LO) base district,
36 and other applicable requirements of the City Code
37



ZONING EXHIBIT A

-  N
-  Subject Tract
-  Zoning Boundary
-  Pending Cases

ZONING CASE# C14 2007 0148
 ADDRESS 11726 JOLLYVILLE RD
 SUBJECT AREA 1.53 ACRES
 GRID H35
 MANAGER S SIRWAITIS



1" = 400' OPERATOR SM

This map has been produced by GIS Services for the sole purpose of geographic reference. No warranty is made by the City of Austin regarding specific accuracy or completeness.