



**CITY OF AUSTIN
TO THE
CITY OF AUSTIN
(WASTEWATER EASEMENT)**

DESCRIPTION FOR PARCEL 5024.08 WE

DESCRIPTION OF 0.162 OF ONE ACRE (7039 SQUARE FEET) OF LAND, OUT OF THE JESSE C. TANNEHILL SURVEY NO. 29 AND BEING A PORTION OF OF THAT CALLED 197.59 ACRE TRACT OF LAND DESCRIBED IN THE SPECIAL WARRANTY DEED TO THE CITY OF AUSTIN, A MUNICIPAL CORPORATION, DATED SEPTEMBER 20, 2002 AND RECORDED UNDER DOCUMENT NUMBER 2002178092, OFFICIAL PUBLIC RECORDS OF TRAVIS COUNTY TEXAS; SAID 0.162 OF ONE ACRE TRACT OF LAND, AS SHOWN ON THE ATTACHED SKETCH, BEING MORE PARTICULARLY DESCRIBED BY METES AND BOUNDS AS FOLLOWS:

COMMENCING at a 5/8" iron rod found in the east right-of-way line on Springdale Road (width varies), being the west line of said 197.59 acre tract, and the west line of an existing 3.134 acre Wastewater Easement to the City of Austin in Document No. 2003210116 of the Official Public Records of Travis County, Texas, from which a westerly exterior ell corner of said 197.59 acre tract at Springdale Road bears S27°23'06"W a distance of 1449.74 feet to a 1/2" iron rod found and from which the calculated northwest corner of said 197.59 acre tract bears N18°12'35"E, a distance of 51.22 feet,

THENCE, S29°10'15"W, with said east right-of-way of Springdale Road, a distance of 2.20 feet to the most westerly northwest corner of said 3.134 acre Wastewater Easement, being also the most northerly corner of a Temporary Work Space Easement to the City of Austin in Document No. 2003210116 of the Official Public Records of Travis County, Texas;

THENCE, S62°10'01"E, leaving said east right-of-way of Springdale Road, and crossing said 197.59 acre tract with the common line of said 3.134 acre Wastewater Easement and said Temporary Work Space Easement, at a distance of 805.80 feet, passing an angle point in the west line of said 3.134 acre Wastewater Easement, continuing said course, crossing said 3.134 acre Wastewater Easement for a total distance of 853.29 feet, to the east line of said 3.134 acre Wastewater Easement, for a calculated angle point;

THENCE, S17°04'12"E, with said east line of the 3.134 acre Wastewater Easement, being also the west line of said Temporary Work Space Easement, a distance of 539.98 feet to a 60d nail set for the **POINT OF BEGINNING** for the northwest corner of the herein described tract, having Texas Coordinate System of 1983 (Central Zone, HARN, U.S. Survey Feet, Combined Scale Factor of 0.99993) values of N=10083801.32, E=3137829.12;

THENCE, leaving the east line of said 3.134 acre Wastewater Easement, the following five (5) courses and distances:

1. N63°48'10"E, a distance of 12.56 feet to a 60d nail set for an angle point,
2. S54°29'57"E, a distance of 29.29 feet to a 60d nail set for an angle point,
3. N80°30'03"E, a distance of 45.23 feet to a 60d nail set for an angle point,
4. S09°29'57"E, a distance of 15.84 feet to a 60d nail set for an angle point, and

5. N80°30'03"E, at 72.69 feet to a 60d nail set at the westerly intersection of an existing 10 foot Wastewater Easement recorded in Volume 4038, Page 1588 of the Deed Records of Travis County, Texas, having a total distance of 254.50 feet to a calculated point for the northeast corner of the herein described tract, in the westerly line of Lot 61, Block A, The Bluffs of University Hills, Sec. 3, a subdivision recorded in Book 54, Page 63 of the Plat Records of Travis County, Texas, and in the east line of said 197.59 acre tract,

THENCE, S21°19'22"E, with said common line a distance of 15.33 feet to a calculated point for the southeast corner of the herein described tract;

THENCE, leaving said common line, again crossing said 197.59 acre tract, the following five (5) courses and distances:

1. S80°30'03"W, at 148.25 feet to a 60d nail set for the intersection of the northerly line of said 10 foot Wastewater Easement, having a total distance of 257.64 feet to a 60d nail set for an angle point,
2. S09°29'57"E, a distance of 9.16 feet to a 60d nail set for an angle point,
3. S80°30'03"W, a distance of 63.14 feet to an 60d nail set for the southwest corner of the herein described tract in the east line of said 3.134 acre Wastewater Easement,
4. N26°52'12"W, with said east line of said 3.134 acre Wastewater Easement, a distance of 42.20 feet to a 60d nail set for an angle point of said 3.134 acre Wastewater Easement, and
5. N17°04'32"W, a distance of 16.97 feet to the **POINT OF BEGINNING** and containing 0.162 of one acre (7039 square feet) of land, more or less.

BEARING BASIS NOTE

The coordinates described herein are based upon the Texas Coordinate System of 1983 (Central Zone, HARN, U.S. Survey Feet, Adjustment Factor of 0.99993). The bearings were established from fixed control monuments "AUSTIN RRP2 (TxAu)" and "CB21", as published by the City of Austin.

SURVEYED BY:

I, Bryan D. Newsome, do hereby certify that the foregoing Description and Sketch are based on a survey performed on the ground under my direction and supervision in January 2006 and do hereby declare that it is true and correct to the best of my knowledge and belief.

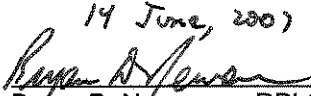
14 June, 2007

Bryan D. Newsome, RPLS
Texas Registration No. 5657



TCAD NO. 02 1824 01 01
AUSTIN GRID M & N-25

FIELD NOTES REVIEWED
By:  Date: 6/15/07
Austin Clean Water Program
Survey Coordinator

C FAULKNER ENGINEERING
www.cfeamerica.com
907 5th Street, Suite 250
Austin, Texas 78703
P: 512.495.9470
F: 512.495.9473

A SKETCH TO ACCOMPANY FIELDNOTE DESCRIPTION

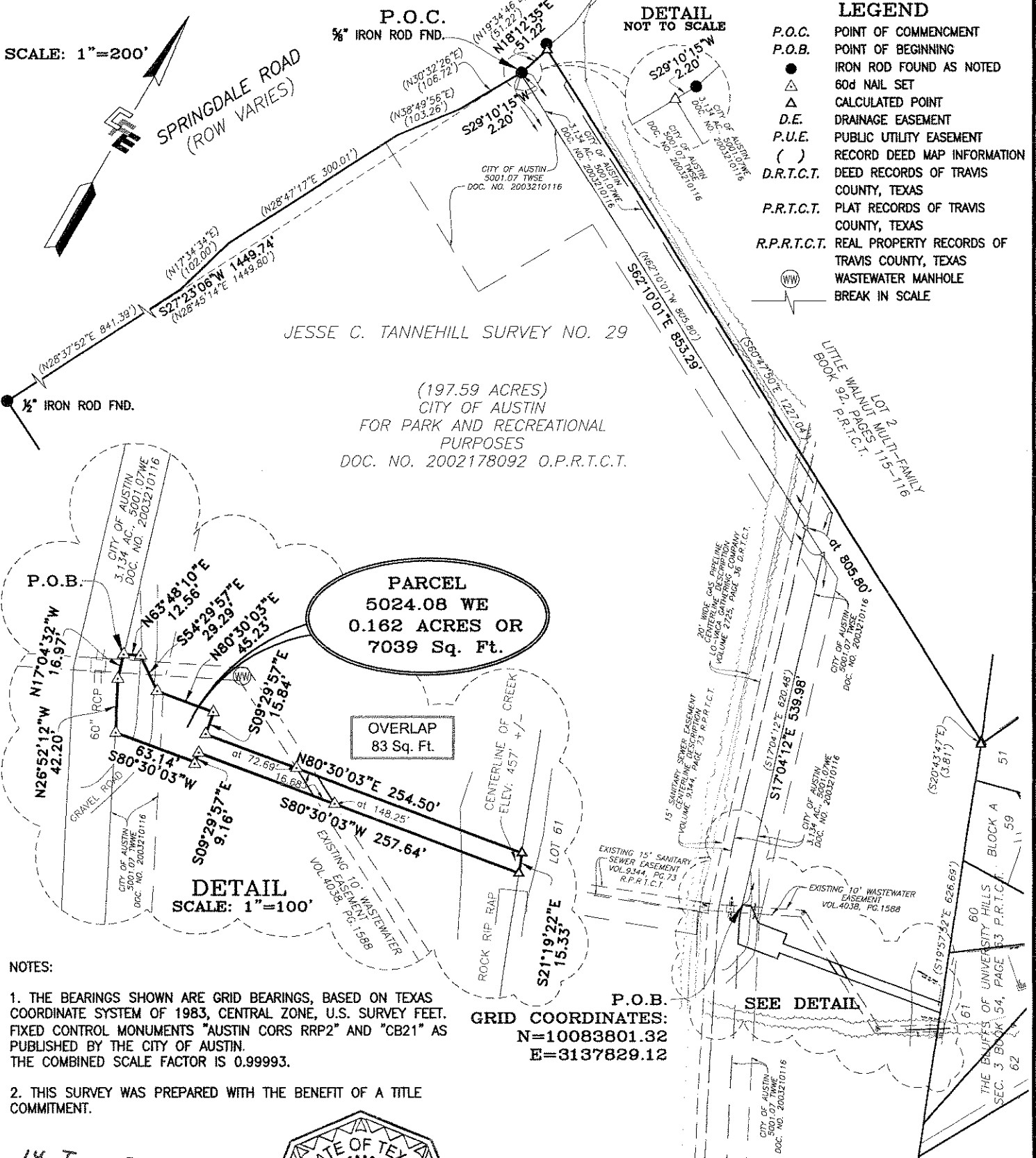

14 June, 2007

BRYAN D. NEWSOME, R.P.L.S. # 5657

REFERENCE:
TCAD PARCEL NO. 02 1824 01 01
AUSTIN GRID M & N -25

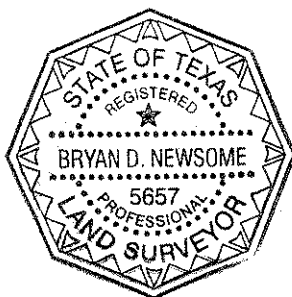

CITY OF AUSTIN
JESSE C. TANNEHILL SURVEY
TRAVIS COUNTY, TEXAS

DATE:	JUNE 2007
DESCRIPTION:	COA (JQ) ACWP5024.08WE
TECHNICIAN:	SHARON RHOD
JOB NUMBER:	3014.001.04
DRAWING:	K:\COA (JQ)\Group 2 Inverted Siphons
	Survey\Acad\ACWP5024.DWG

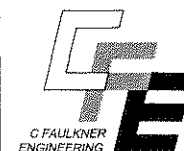

400 Bowie Street, Suite 250
Austin, Texas 78703
P: 512.495.9470
F: 512.495.9473

P.O. Box 1528
Austin, Texas 78767-1528
www.cfaulknerengineering.com



**CITY OF AUSTIN
TO THE
CITY OF AUSTIN
(TEMPORARY WORK SPACE EASEMENT)**

DESCRIPTION FOR PARCEL 5024.08 TWSE

DESCRIPTION OF 0.446 OF ONE ACRE (19,434 SQUARE FEET) OF LAND, OUT OF THE JESSE C. TANNEHILL SURVEY NO. 29 AND BEING A PORTION OF THAT CALLED 197.59 ACRE TRACT OF LAND DESCRIBED IN THE SPECIAL WARRANTY DEED TO THE CITY OF AUSTIN, A MUNICIPAL CORPORATION, DATED SEPTEMBER 20, 2002 AND RECORDED UNDER DOCUMENT NUMBER 2002178092, OFFICIAL PUBLIC RECORDS OF TRAVIS COUNTY TEXAS; SAID 0.446 OF ONE ACRE TRACT OF LAND, AS SHOWN ON THE ATTACHED SKETCH, BEING MORE PARTICULARLY DESCRIBED BY METES AND BOUNDS AS FOLLOWS:

COMMENCING at a 5/8" iron rod found in the east right-of-way line of Springdale Road (width varies), being the west line of said 197.59 acre tract, and the west line of an existing 3.134 acre Wastewater Easement to the City of Austin in Document No. 2003210116 of the Official Public Records of Travis County, Texas, from which a westerly exterior ell corner of said 197.59 acre tract at Springdale Road bears S27°23'06"W a distance of 1449.74 feet to a 1/2" iron rod found and from which the calculated northwest corner of said 197.59 acre tract bears N18°12'35"E, a distance of 51.22 feet,

THENCE, S29°10'15"W, with said east right-of-way of Springdale Road, a distance of 2.20 feet to the most westerly northwest corner of said 3.134 acre Wastewater Easement to the City of Austin in Document No. 2003210116 of the Official Public Records of Travis County, Texas;

THENCE, S62°10'01"E, leaving said east right-of-way of Springdale Road, and crossing said 197.59 acre tract with a southerly line of said 3.134 acre Wastewater Easement, distance of 784.64 feet to the west line of a 15' Sanitary Sewer Easement as described by a centerline in Volume 9344, Page 73 of the Real Property Records of Travis County, Texas, same being 15 feet west and parallel of said 3.134 acre Wastewater Easement, for a calculated angle point;

THENCE, S17°01'11"E, with the west line of said 15' Sanitary Sewer Easement, same being 15 feet west of and parallel with said 3.134 acre Wastewater Easement, a distance of 605.51 feet for a calculated angle point;

THENCE, S26°52'59"E, with the west line of said 15' Sanitary Sewer Easement, same being 15 feet west of and parallel with said 3.134 acre Wastewater Easement, a distance of 7.33 feet to the **POINT OF BEGINNING** for the northeast corner of the herein described tract, having Texas Coordinate System of 1983 (Central Zone, HARN, U.S. Survey Feet, Combined Scale Factor of 0.99993) values of N=10083764.04, E=3137790.44;

THENCE, S26°52'59"E, continuing with the west line of said 15' Sanitary Sewer Easement, same being 15 feet west of and parallel with said 3.134 acre Wastewater Easement, a distance of 35.18 feet to a calculated point for the southeast corner of the herein described tract;

THENCE, leaving the west line of said 15' Sanitary Sewer Easement, the following five (5) courses and distances:

1. S68°52'19"W, a distance of 505.10 feet to a calculated point,
2. S70°57'19"W, a distance of 52.54 feet to a calculated point for the southwest corner of the herein described tract,
3. N19°02'41"W, a distance of 35.00 feet to a calculated point in the south line of a 15' Sanitary Sewer Easement as described by a centerline in Volume 7031, Page 2399 of the Real Property Records of Travis County, Texas, for the northwest corner of the herein described tract,
4. N70°57'19"E, with the said south line, a distance of 51.91 feet to a calculated point,
5. N68°52'19"E, continuing with the said south line, a distance of 500.94 feet to the **POINT OF BEGINNING** and containing 0.446 of one acre (19,434 square feet) of land, more or less.

BEARING BASIS NOTE

The coordinates described herein are based upon the Texas Coordinate System of 1983 (Central Zone, HARN, U.S. Survey Feet, Adjustment Factor of 0.99993). The bearings were established from fixed control monuments "AUSTIN RRP2 (TxAu)" and "CB21", as published by the City of Austin.

SURVEYED BY:

I, Bryan D. Newsome, do hereby certify that the foregoing Description and Sketch are based on a survey performed on the ground under my direction and supervision in January 2006 and do hereby declare that it is true and correct to the best of my knowledge and belief.

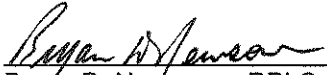
Bryan D. Newsome, RPLS
Texas Registration No. 5657
24 October, 2007

TCAD NO. 02 1824 01 01
AUSTIN GRID M & N-25

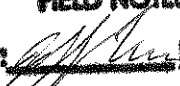

FIELD NOTES REVIEWED
By:  Date: 11/7/07
**Austin Clean Water Program
Survey Coordinator**

C FAULKNER ENGINEERING
www.cfeamerica.com
907 5th Street, Suite 250
Austin, Texas 78703
P: 512.495.9470
F: 512.495.9473



**CITY OF AUSTIN
TO THE
CITY OF AUSTIN
(ACCESS EASEMENT)**

DESCRIPTION FOR PARCEL 5024.08 AE

DESCRIPTION OF 1.70 ACRES (73,842 SQUARE FEET) OF LAND, OUT OF THE JESSE C. TANNEHILL SURVEY NO. 29 AND BEING A PORTION OF THAT CALLED 197.59 ACRE TRACT OF LAND DESCRIBED IN THE SPECIAL WARRANTY DEED TO THE CITY OF AUSTIN, A MUNICIPAL CORPORATION, DATED SEPTEMBER 20, 2002 AND RECORDED UNDER DOCUMENT NUMBER 2002178092, OFFICIAL PUBLIC RECORDS OF TRAVIS COUNTY TEXAS; SAID 1.70 ACRE TRACT OF LAND, AS SHOWN ON THE ATTACHED SKETCH, BEING MORE PARTICULARLY DESCRIBED BY METES AND BOUNDS AS FOLLOWS:

COMMENCING at a 5/8" iron rod found on the east right-of-way line of Springdale Road (width varies), being the west line of said 197.59 acre tract, and the west line of an existing 3.134 acre Wastewater Easement to the City of Austin in Document No. 2003210116 of the Official Public Records of Travis County, Texas, from which a 1/2" iron rod found for a westerly exterior ell corner of said 197.59 acre tract at Springdale Road bears S27°23'06"W a distance of 1449.74 feet, and also from which the calculated northwest corner of said 197.59 acre tract bears N18°12'35"E, a distance of 51.22 feet,

THENCE, S29°10'15"W, with said east right-of-way of Springdale Road, a distance of 2.20 feet to the most westerly northwest corner of said 3.134 acre Wastewater Easement, being also the most northerly corner and **POINT OF BEGINNING** of the herein described tract, having Texas Coordinate System of 1983 (Central Zone, HARN, U.S. Survey Feet, Combined Scale Factor of 0.999993) values of N=10084715.91, E=3136916.03;

THENCE, crossing said 197.59 acre tract the following five (5) courses and distances as follows:

1. S62°10'01"E, leaving said east right-of-way of Springdale Road, with the southerly line of said 3.134 acre Wastewater Easement, a distance of 763.48 feet, to the west line of a 15' Sanitary Sewer Easement to the City of Austin in Volume 2753, Page 297 Deed Records of Travis County, Texas for the calculated northeasterly corner of the herein described tract;
2. S17°01'11"E, with the west line of said 15' Sanitary Sewer Easement, a distance of 42.32 feet to a calculated point for the most southeasterly corner of the herein described tract,
3. N62°10'01"W, leaving the west line of said 15' Sanitary Sewer Easement, a distance of 543.86 feet to a calculated interior ell corner of the herein described tract,
4. S29°10'15"W, a distance of 197.55 feet to a calculated exterior ell corner of the herein described tract,
5. N62°10'01"W, a distance of 264.42 feet to the most westerly calculated corner of the herein described tract, on the said east right-of-way line on Springdale Road,

THENCE, with said east right-of-way line of Springdale Road, same being the west line of said 197.59 acre tract, the following three (3) courses and distances as follows;

1. N27°25'08"E, a distance of 21.20 feet to a calculated angle point,
2. N37°27'47"E, a distance of 103.26 feet to a calculated angle point,
3. N29°10'18"E, a distance of 104.53 feet to the **POINT OF BEGINNING** and containing 1.70 acre (73,842 square feet) of land, more or less.

BEARING BASIS NOTE

The coordinates described herein are based upon the Texas Coordinate System of 1983 (Central Zone, HARN, U.S. Survey Feet, Adjustment Factor of 0.99993). The bearings were established from fixed control monuments "AUSTIN RRP2 (TxAu)" and "CB21", as published by the City of Austin.

SURVEYED BY:

I, Bryan D. Newsome, do hereby certify that the foregoing Description and Sketch are based on a survey performed on the ground under my direction and supervision in January 2006 and do hereby declare that it is true and correct to the best of my knowledge and belief.

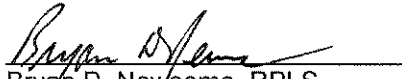
Bryan D. Newsome, RPLS
Texas Registration No. 5657

24 October, 2007

TCAD NO. 02 1824 01 01
AUSTIN GRID M & N-25

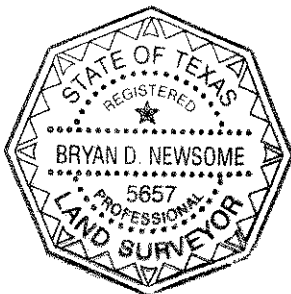

FIELD NOTES REVIEWED
By:  Date: 11/7/07
**Austin Clean Water Program
Survey Coordinator**

C FAULKNER ENGINEERING

www.cfeamerica.com
907 5th Street, Suite 250
Austin, Texas 78703
P: 512.495.9470
F: 512.495.9473

A SKETCH TO ACCOMPANY FIELDNOTE DESCRIPTION

DETAIL
NOT TO SCALE

P.O.B.
GRID COORDINATES:
N=10084715.91
E=3136916.03

SCALE: 1"=200'

SPRINGDALE ROAD
(ROW VARIES)

JESSE C. TANNEHILL SURVEY NO. 29

(197.59 ACRES)
CITY OF AUSTIN
FOR PARK AND RECREATIONAL
PURPOSES
DOC. NO. 2002178092 O.P.R.T.C.T.

PARCEL
5024.08 AE
1.70 ACRES OR
73,842 Sq. Ft.

LEGEND

- P.O.C. POINT OF COMMENCEMENT
- P.O.B. POINT OF BEGINNING
- IRON ROD FOUND AS NOTED
- △ 60d NAIL SET
- △ CALCULATED POINT
- D.E. DRAINAGE EASEMENT
- P.U.E. PUBLIC UTILITY EASEMENT
- () RECORD DEED MAP INFORMATION
- D.R.T.C.T. DEED RECORDS OF TRAVIS COUNTY, TEXAS
- P.R.T.C.T. PLAT RECORDS OF TRAVIS COUNTY, TEXAS
- R.P.R.T.C.T. REAL PROPERTY RECORDS OF TRAVIS COUNTY, TEXAS
- W WASTEWATER MANHOLE
- BREAK IN SCALE

NOTES:

1. THE BEARINGS SHOWN ARE GRID BEARINGS, BASED ON TEXAS COORDINATE SYSTEM OF 1983, CENTRAL ZONE, U.S. SURVEY FEET. FIXED CONTROL MONUMENTS "AUSTIN CORS RRP2" AND "CB21" AS PUBLISHED BY THE CITY OF AUSTIN. THE COMBINED SCALE FACTOR IS 0.99993.

2. THIS SURVEY WAS PREPARED WITH THE BENEFIT OF A TITLE COMMITMENT.

Bryan D. Newsome
BRYAN D. NEWSOME, R.P.L.S. # 5657

REFERENCE:
TCAD PARCEL NO. 02 1824 01 01
AUSTIN GRID M & N -25

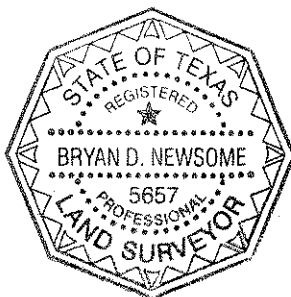

CITY OF AUSTIN
JESSE C. TANNEHILL SURVEY
TRAVIS COUNTY, TEXAS

DATE: OCT. 2007
DESCRIPTION: COA (JQ) ACWP5024.08AE
TECHNICIAN: SHARON RHOD
JOB NUMBER: 3014.001.04
DRAWING: K:\COA (JQ)\Group 2 Inverted Siphons
Survey\Acad\ACWP5024.DWG



400 Bowie Street, Suite 250
Austin, Texas 78703
P: 512.495.9470
F: 512.495.9473
P.O. Box 1528
Austin, Texas 78767-1528
www.cfaulknerengineering.com



CITY OF AUSTIN
TO THE
CITY OF AUSTIN
(TEMPORARY STAGING AREA AND MATERIAL
STORAGE SITE)

DESCRIPTION FOR PARCEL 5024.08 TSAAMSS

DESCRIPTION OF 1.70 ACRES (73,842 SQUARE FEET) OF LAND, OUT OF THE JESSE C. TANNEHILL SURVEY NO. 29 AND BEING A PORTION OF THAT CALLED 197.59 ACRE TRACT OF LAND DESCRIBED IN THE SPECIAL WARRANTY DEED TO THE CITY OF AUSTIN, A MUNICIPAL CORPORATION, DATED SEPTEMBER 20, 2002 AND RECORDED UNDER DOCUMENT NUMBER 2002178092, OFFICIAL PUBLIC RECORDS OF TRAVIS COUNTY TEXAS; SAID 1.70 ACRE TRACT OF LAND, AS SHOWN ON THE ATTACHED SKETCH, BEING MORE PARTICULARLY DESCRIBED BY METES AND BOUNDS AS FOLLOWS:

COMMENCING at a 5/8" iron rod found on the east right-of-way line of Springdale Road (width varies), being the west line of said 197.59 acre tract, and the west line of an existing 3.134 acre Wastewater Easement to the City of Austin in Document No. 2003210116 of the Official Public Records of Travis County, Texas, from which a 1/2" iron rod found for a westerly exterior ell corner of said 197.59 acre tract at Springdale Road bears S27°23'06"W a distance of 1449.74 feet, and also from which the calculated northwest corner of said 197.59 acre tract bears N18°12'35"E, a distance of 51.22 feet,

THENCE, S29°10'15"W, with said east right-of-way of Springdale Road, a distance of 2.20 feet to the most westerly northwest corner of said 3.134 acre Wastewater Easement, being also the most northerly corner and **POINT OF BEGINNING** of the herein described tract, having Texas Coordinate System of 1983 (Central Zone, HARN, U.S. Survey Feet, Combined Scale Factor of 0.99993) values of N=10084715.91, E=3136916.03;

THENCE, crossing said 197.59 acre tract the following five (5) courses and distances as follows:

1. S62°10'01"E, leaving said east right-of-way of Springdale Road, with the southerly line of said 3.134 acre Wastewater Easement, a distance of 763.48 feet, to the west line of a 15' Sanitary Sewer Easement to the City of Austin in Volume 2753, Page 297 Deed Records of Travis County, Texas for the calculated northeasterly corner of the herein described tract;
2. S17°01'11"E, with the west line of said 15' Sanitary Sewer Easement, a distance of 42.32 feet to a 60d nail found for the most southeasterly corner of the herein described tract,
3. N62°10'01"W, leaving the west line of said 15' Sanitary Sewer Easement, a distance of 543.86 feet to a calculated interior ell corner of the herein described tract,
4. S29°10'15"W, a distance of 197.55 feet to a calculated exterior ell corner of the herein described tract,

5. N62°10'01"W, a distance of 264.42 feet to the most westerly calculated corner of the herein described tract, on the said east right-of-way line on Springdale Road,

THENCE, with said east right-of-way line of Springdale Road, same being the west line of said 197.59 acre tract, the following three (3) courses and distances as follows;

1. N27°25'08"E, a distance of 21.20 feet to a calculated angle point,
2. N37°27'47"E, a distance of 103.26 feet to a calculated angle point,
3. N29°10'18"E, a distance of 104.53 feet to the **POINT OF BEGINNING** and containing 1.70 acre (73,842 square feet) of land, more or less.

BEARING BASIS NOTE

The coordinates described herein are based upon the Texas Coordinate System of 1983 (Central Zone, HARN, U.S. Survey Feet, Adjustment Factor of 0.99993). The bearings were established from fixed control monuments "AUSTIN RRP2 (TxAu)" and "CB21", as published by the City of Austin.

SURVEYED BY:

I, Bryan D. Newsome, do hereby certify that the foregoing Description and Sketch are based on a survey performed on the ground under my direction and supervision in January 2006 and do hereby declare that it is true and correct to the best of my knowledge and belief.

Bryan D. Newsome, RPLS
Texas Registration No. 5657

24 October, 2007

TCAD NO. 02 1824 01 01
AUSTIN GRID M & N-25



FIELD NOTES REVIEWED
By:  Date: 11/7/07
**Austin Clean Water Program
Survey Coordinator**

C FAULKNER ENGINEERING

www.cfeamerica.com
907 5th Street, Suite 250
Austin, Texas 78703
P: 512.495.9470
F: 512.495.9473

A SKETCH TO ACCOMPANY FIELDNOTE DESCRIPTION

DETAIL
NOT TO SCALE

P.O.B.
GRID COORDINATES:
N=10084715.91
E=3136916.03

SCALE: 1"=200'

SPRINGDALE ROAD
(ROW VARIES)

JESSE C. TANNEHILL SURVEY NO. 29

(197.59 ACRES)
CITY OF AUSTIN
FOR PARK AND RECREATIONAL
PURPOSES
DOC. NO. 2002178092 O.P.R.T.C.T.

PARCEL
5024.08 TSAAMSS
1.70 ACRES OR
73,842 Sq. Ft.

LEGEND

- P.O.C. POINT OF COMMENCEMENT
P.O.B. POINT OF BEGINNING
● IRON ROD FOUND AS NOTED
△ 60d NAIL SET
△ CALCULATED POINT
D.E. DRAINAGE EASEMENT
P.U.E. PUBLIC UTILITY EASEMENT
() RECORD DEED MAP INFORMATION
D.R.T.C.T. DEED RECORDS OF TRAVIS COUNTY, TEXAS
P.R.T.C.T. PLAT RECORDS OF TRAVIS COUNTY, TEXAS
R.P.R.T.C.T. REAL PROPERTY RECORDS OF TRAVIS COUNTY, TEXAS
WW WASTEWATER MANHOLE
— BREAK IN SCALE

NOTES:

1. THE BEARINGS SHOWN ARE GRID BEARINGS, BASED ON TEXAS COORDINATE SYSTEM OF 1983, CENTRAL ZONE, U.S. SURVEY FEET. FIXED CONTROL MONUMENTS "AUSTIN CORS RRP2" AND "CB21" AS PUBLISHED BY THE CITY OF AUSTIN. THE COMBINED SCALE FACTOR IS 0.99993.

2. THIS SURVEY WAS PREPARED WITH THE BENEFIT OF A TITLE COMMITMENT.

Bryan D. Newsome
BRYAN D. NEWSOME, R.P.L.S. # 5657
(24 October, 2007)

REFERENCE:
TCAD PARCEL NO. 02 1824 01 01
AUSTIN GRID M & N -25

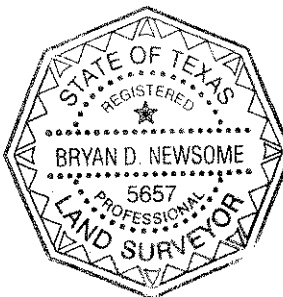

CITY OF AUSTIN JESSE C. TANNEHILL SURVEY TRAVIS COUNTY, TEXAS	
DATE:	OCT. 2007
DESCRIPTION:	COA (JQ) ACWP5024.08TSAAMSS
TECHNICIAN:	SHARON RHOD
JOB NUMBER:	3014.001.04
DRAWING:	K:\COA (JQ)\Group 2 Inverted Siphons Survey\Acad\ACWP5024.DWG

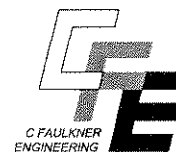

400 Bowie Street, Suite 250
Austin, Texas 78703
P: 512.495.9470
F: 512.495.9473
P.O. Box 1528
Austin, Texas 78767-1528
www.cfaulknerengineering.com