

ORDINANCE NO. 20080228-083

AN ORDINANCE REZONING AND CHANGING THE ZONING MAP FOR THE PROPERTY LOCATED AT 7520-7530 NORTH LAMAR BOULEVARD IN THE CRESTVIEW NEIGHBORHOOD PLAN AREA FROM LIMITED INDUSTRIAL SERVICE-PLANNED DEVELOPMENT AREA-NEIGHBORHOOD PLAN (LI-PDA-NP) COMBINING DISTRICT TO PUBLIC-NEIGHBORHOOD PLAN (P-NP) COMBINING DISTRICT.

BE IT ORDAINED BY THE CITY COUNCIL OF THE CITY OF AUSTIN:

PART 1. The zoning map established by Section 25-2-191 of the City Code is amended to change the base district from limited industrial service-planned development area-neighborhood plan (LI-PDA-NP) combining district to public-neighborhood plan (P-NP) combining district on the property described in Zoning Case No. C14-2007-0095, on file at the Neighborhood Planning and Zoning Department, as follows:

Lots 1-4, Block A, Northgate Addition, a subdivision in the City of Austin, Travis County, Texas, according to the map or plat of record in Plat Book 3, Page 196, of the Plat Records of Travis County, Texas; and

Tracts 1 and 2, Kivlin-Smith Subdivision, a subdivision in the City of Austin, Travis County, Texas, according to the map or plat of record in Plat Book 29, Page 43, of the Plat Records of Travis County, Texas (the "Property"),

locally known as 7520-7530 North Lamar Boulevard, in the City of Austin, Travis County, Texas, and generally identified in the map attached as Exhibit "A".

PART 2. Except as otherwise provided in this ordinance, the Property is subject to Ordinance No. 040401-32B, amended by Ordinance No. 040415-50, that established the Crestview neighborhood plan combining district.

PART 3. This ordinance takes effect on March 10, 2008.

PASSED AND APPROVED

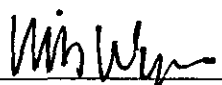
February 28, 2008 §
 §
 § 
 Will Wynn
 Mayor

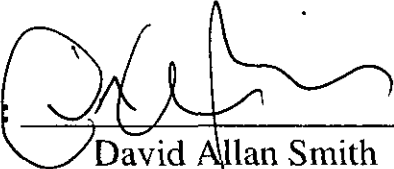
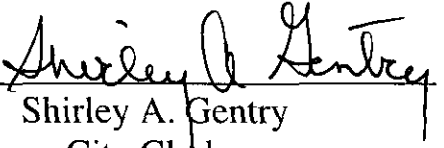
APPROVED:  **ATTEST:** 
 David Allan Smith Shirley A. Gentry
 City Attorney City Clerk

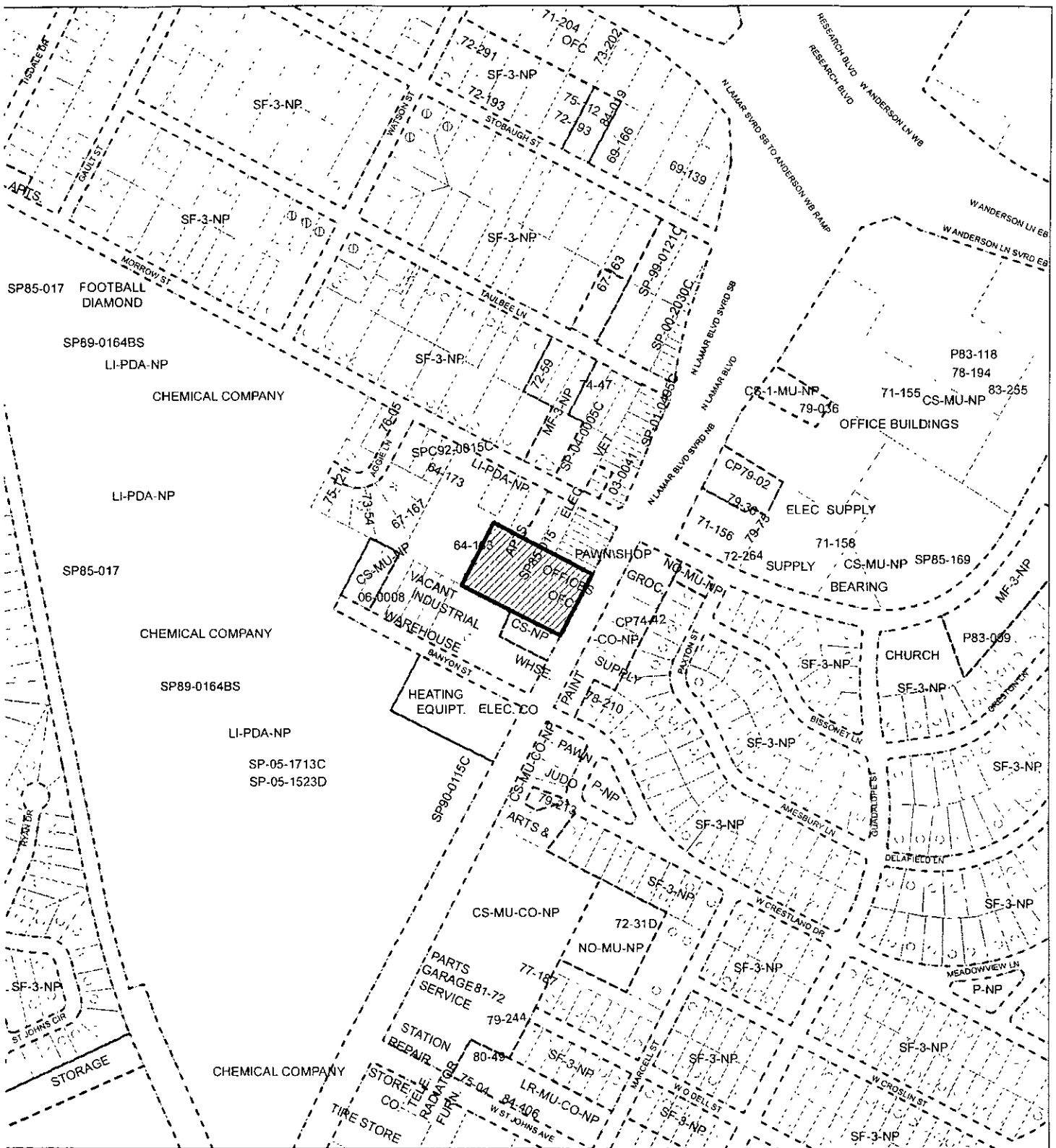

ZONING EXHIBIT A



Subject Tract

Zoning Boundary

Pending Cases

1" = 400'

OPERATOR SM

ZONING CASE#: C14-2007-0095

ADDRESS: 7520-7530 NORTH LAMAR BOULEVARD

SUBJECT AREA: 2.036 ACRES

GRID: K28-29

MANAGER: J. ROUSSELIN



This map has been produced by G.I.S. Services for the sole purpose of geographic reference. No warranty is made by the City of Austin regarding specific accuracy or completeness.