

ORDINANCE NO. _____

1 AN ORDINANCE REZONING AND CHANGING THE ZONING MAP FOR THE
2 PROPERTY LOCATED AT 2102 WEST BEN WHITE BOULEVARD FROM
3 FAMILY RESIDENCE (SF-3) DISTRICT TO LIMITED OFFICE-MIXED USE
4 (LO-MU) COMBINING DISTRICT.
5

6 BE IT ORDAINED BY THE CITY COUNCIL OF THE CITY OF AUSTIN:
7

8 **PART 1.** The zoning map established by Section 25-2-191 of the City Code is amended to
9 change the base district from family residence (SF-3) district to limited office-mixed use
10 (LO-MU) combining district on the property described in Zoning Case No. C14-2008-
11 0096, on file at the Neighborhood Planning and Zoning Department, as follows:
12

13 Lot 18, Goodnight and Pearson Subdivision, a subdivision in the City of Austin,
14 Travis County, Texas, according to the map or plat of record in Plat Book 5, Page
15 28, of the Plat Records of Travis County, Texas,
16

17 locally known as 2102 West Ben White Boulevard, in the City of Austin, Travis County,
18 Texas, and generally identified in the map attached as Exhibit "A".
19

20 **PART 2.** This ordinance takes effect on _____, 2008.
21

22
23 **PASSED AND APPROVED**
24

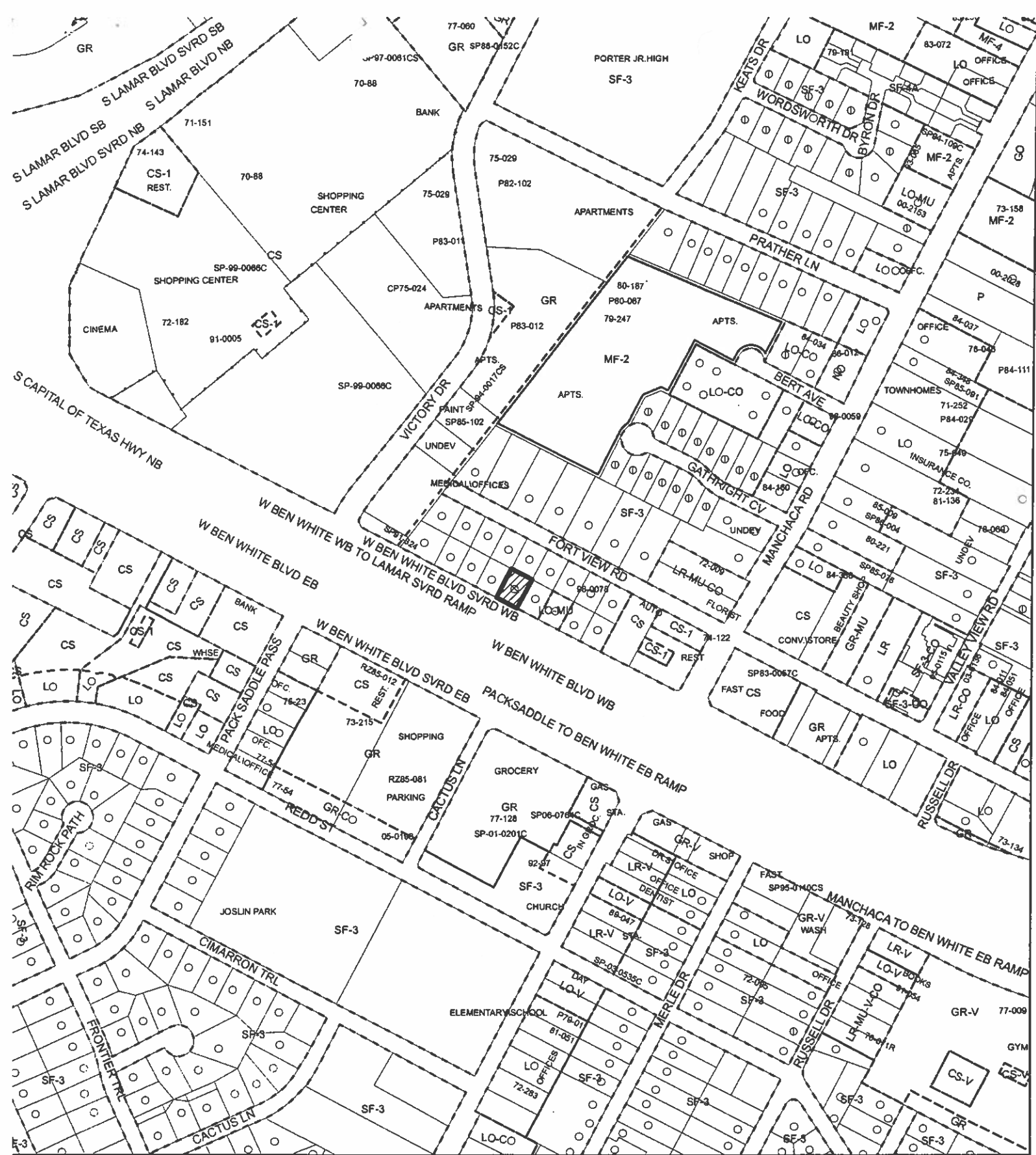

25 §
26 §
27 _____, 2008 § _____
28
29 Will Wynn
30 Mayor
31

32 **APPROVED:** _____ **ATTEST:** _____
33 David Allan Smith Shirley A. Gentry
34 City Attorney City Clerk



ZONING EXHIBIT A



-  **SUBJECT TRACT**
-  **ZONING BOUNDARY**
-  **PENDING CASE**

ZONING CASE#: C14-2008-0096
ADDRESS: 2102 W BEN WHITE BLVD
SUBJECT AREA: 0.17 ACRES
GRID: G19
MANAGER: R. LEVINSKI

OPERATOR: S. MEEKS

This map has been produced by G.I.S. Services for the sole purpose of geographic reference. No warranty is made by the City of Austin regarding specific accuracy or completeness.



1" = 400'