

## **ZONING CHANGE REVIEW SHEET**

**CASE:** C14-2008-0112 - Minware

**P.C. DATE:** June 24, 2008

**ADDRESS:** 4209 Clawson Road

**AREA:** 0.19 acres

**OWNER/APPLICANT:** Robert W. Anderson, Jr.

**ZONING FROM:** SF-3

**TO:** GR

### **SUMMARY STAFF RECOMMENDATION:**

Staff recommends approval of LO-CO (limited office – conditional overlay) combining district zoning. The conditional overlay shall restrict the number of daily vehicle trips to 2,000.

### **PLANNING COMMISSION RECOMMENDATION:**

The motion to deny the applicant's request for GR district zoning and remain SF-3; was approved by Commissioner Chris Ewen's motion, Commissioner Tracy Atkins second the motion on a vote of 7-0. Commissioners Jay Reddy and Clint Small were absent.

### **DEPARTMENT COMMENTS:**

A valid petition has been filed in opposition to the zone change request. The subject 0.19-acre tract is currently developed with a single-family residence. The applicant intends to rezone the property to GR (community commercial) district zoning to allow for the development of a small professional office.

The lot has frontage on Clawson Road, from which both ingress and egress access will be taken. A traffic impact analysis was waived for this case because the applicant agreed to limit the intensity and uses for this development. If the zoning is granted, development should be limited through a conditional overlay to less than 2,000 vehicle trips per day. [LDC, 25-6-117]

The area to the north of the property is predominately composed of single-family residences. To the south and west, there are several types of commercial uses, including automobile repair and custom manufacturing.

The applicant claims to have lost his homestead exemption due to the commercial status of the property and had thought he was already commercially zoned. For several years, the applicant used the property as both his primary residence and a custom manufacturing facility for hand-made guns.

There was a rezoning case in 1979 that may have caused some confusion, case #C14-79-214. This case rezoned the adjacent property to the south from Interim "A" Residence to "GR" General Retail. The legal description identified the correct property for rezoning in the subdivision reference. However, the addresses listed on the public hearing notices and ordinance incorrectly labeled the local address as 4205-4209 Clawson Road. The city rezones by legal description, so while the address 4209 Clawson was included, the subject property itself was not rezoned.

Earlier this year, the Planning Commission and City Council approved the rezoning of a single-family lot across the street, case #C14-2008-0046, from SF-3 (family residence) to LO-CO (limited office – conditional overlay) combining district zoning. The conditional overlay prohibited most commercial uses and predominately allowed for a new parking lot for an adjacent property.

The subject property is located in the South Lamar Combined Neighborhood Planning Area. The neighborhood plan for this area is temporarily on hold.

**EXISTING ZONING AND LAND USES:**

	<b>ZONING</b>	<b>LAND USES</b>
<i>Site</i>	SF-3	Single-Family Residence
<i>North</i>	SF-3	Single-Family Residences
<i>South</i>	GR	Automobile Repair, Pawn Shop, Auto Sales
<i>East</i>	GR; CS	Automobile Repair, Custom Manufacturing
<i>West</i>	GR; LO; SF-3	Automobile Repair, Single-Family Residences

**TIA:** Waived

**WATERSHED:** West Bouldin Creek

**DESIRED DEVELOPMENT ZONE:** YES

**CAPITOL VIEW CORRIDOR:** N/A

**HILL COUNTRY ROADWAY:** N/A

**NEIGHBORHOOD ORGANIZATIONS:**

Barton Springs / Edwards Aquifer  
Conservation District  
South Lamar Neighborhood Association

Homeless Neighborhood Association  
Austin Neighborhoods Council  
South Central Coalition

**SCHOOLS:**

Galindo Elementary  
Fulmore Middle School  
Travis High School

**CASE HISTORIES:**

<b>NUMBER</b>	<b>REQUEST</b>	<b>PLANNING COMMISSION</b>	<b>CITY COUNCIL</b>
C14-79-214 (adjacent property to the south)	From Interim "A" Residence, Interim First Height to "GR" General Retail, First Height	Approved GR; First Height	Approved GR; First Height [Vote: 7-0]
C14-2008-0046 (across street)	From SF-3 to LO-CO	Approved by consent	Approved by consent

## **STAFF RECOMMENDATION**

Staff recommends approval of the request for rezoning to LO-CO (limited office-conditional overlay) combining district zoning.

## **BASIS FOR RECOMMENDATION**

1. *Granting of the request should result in an equal treatment of similarly situated properties, and the rezoning should be consistent with the policies and principles adopted by the City Council or Planning Commission.*

Earlier this year, the Planning Commission and City Council approved the rezoning of a similarly-situated property across the street. In that case, the applicant agreed with the registered neighborhood association to limit the majority of the commercial uses to allow for a parking lot. The applicant also attached additional conditions on the GR-zoned property to the south. Providing a buffer to the single-family zoned properties to the north, like a limited office, would be consistent with the policies set forth by the previous rezoning case.

2. *Zoning should promote the policy of locating retail and more intensive zoning near the intersections of arterial roadways or at the intersections of arterials and major collectors.*

While the subject property is on a single-family street (Clawson), the office zoning provides a transition from the intense commercial uses located at the intersection of Clawson and Fort View.

## **Site Characteristics**

Any new development is subject to Subchapter E. Design Standards and Mixed Use. Additional comments will be made when the site plan is submitted.

The site is subject to compatibility standards. Along the north property line, the following standards apply:

- No structure may be built within 25 feet of the property line.
- No structure in excess of two stories or 30 feet in height may be constructed within 50 feet of the property line.
- No structure in excess of three stories or 40 feet in height may be constructed within 100 feet of the property line.
- No parking or driveways are allowed within 25 feet of the property line.
- In addition, a fence, berm, or dense vegetation must be provided to screen adjoining properties from views of parking, mechanical equipment, storage, and refuse collection.

Additional design regulations will be enforced at the time a site plan is submitted.

## **Environmental**

The site is not located over the Edwards Aquifer Recharge Zone. The site is located in the West Bouldin Creek Watershed of the Colorado River Basin, which is classified as an Urban Watershed by Chapter 25-8 of the City's Land Development Code. It is in the Desired Development Zone.

Impervious cover is not limited in this watershed class; therefore the zoning district impervious cover limits will apply.

This site is required to provide on-site structural water quality controls (or payment in lieu of) for all development and/or redevelopment when 5,000 s.f. cumulative is exceeded, and detention for the two-year storm. At this time, no information has been provided as to whether this property has any pre-existing approvals which would preempt current water quality or Code requirements.

According to flood plain maps, there is no flood plain within the project area.

At this time, site-specific information is unavailable regarding existing trees and other vegetation, areas of steep slope, or other environmental features such as bluffs, springs, canyon rimrock, caves, sinkholes, and wetlands.

Standard landscaping and tree protection will be required in accordance with LDC 25-2 and 25-8 for all development and/or redevelopment.

#### **Transportation**

No additional right-of-way is needed at this time.

A traffic impact analysis was waived for this case because the applicant agreed to limit the intensity and uses for this development. If the zoning is granted, development should be limited through a conditional overlay to less than 2,000 vehicle trips per day. [LDC, 25-6-117]

#### **ABUTTING STREETS:**

Name	ROW	Pavement	Class	Sidewalk	Bus Route	Bike Route
Clawson Road	50'	40'	Collector	No	No	No

#### **Water and Wastewater**

The landowner intends to serve the site with City of Austin water and wastewater utilities. The landowner, at own expense, will be responsible for providing the water and wastewater utility improvements, offsite main extensions, system upgrades, utility relocations and or abandonments required. The water and wastewater plan must be in accordance with the City of Austin utility design criteria. The water and wastewater utility plan must be reviewed and approved by the Austin Water Utility. All water and wastewater construction must be inspected by the City of Austin. The landowner must pay the City inspection fee with the utility construction. The landowner must pay the tap and impact fee once the landowner makes an application for a City of Austin water and wastewater utility tap permit.

**CITY COUNCIL DATE:** October 16, 2008

**ACTION:** N/A

**ORDINANCE READINGS:** 1st

2<sup>nd</sup>

3<sup>rd</sup>

**ORDINANCE NUMBER:**

**CASE MANAGER:** Robert Levinski

**PHONE:** 974-1384

# PETITION

Case Number:

**C14-2008-0112**

Date:

Aug. 13, 2008

**4209 CLAWSON RD**

Total Area Within 200' of Subject Tract

200,999.11

1	04-0609-0102	TWINING JEFFREY A PONDER CECILIA	9623.65	4.79%
2	04-0609-0130	GAYLE	1954.95	0.97%
3	04-0609-0136	QUINN ARTHUR J	3811.09	1.90%
4	04-0610-0226	ALVITER BASILIA	3087.05	1.54%
5	04-0610-0227	ANDERSON RICK C ALVITER ROSARIO & SALOME	13167.36	6.55%
6	04-0610-0238		10451.80	5.20%
7				0.00%
8				0.00%
9				0.00%
10				0.00%
11				0.00%
12				0.00%
13				0.00%
14				0.00%
15				0.00%
16				0.00%
17				0.00%
18				0.00%
19				0.00%
20				0.00%
21				0.00%
22				0.00%
23				0.00%
24				0.00%
25				0.00%
26				0.00%

Validated By:

Stacy Meeks

Total Area of Petitioner:

42,095.90

Total %

20.94%

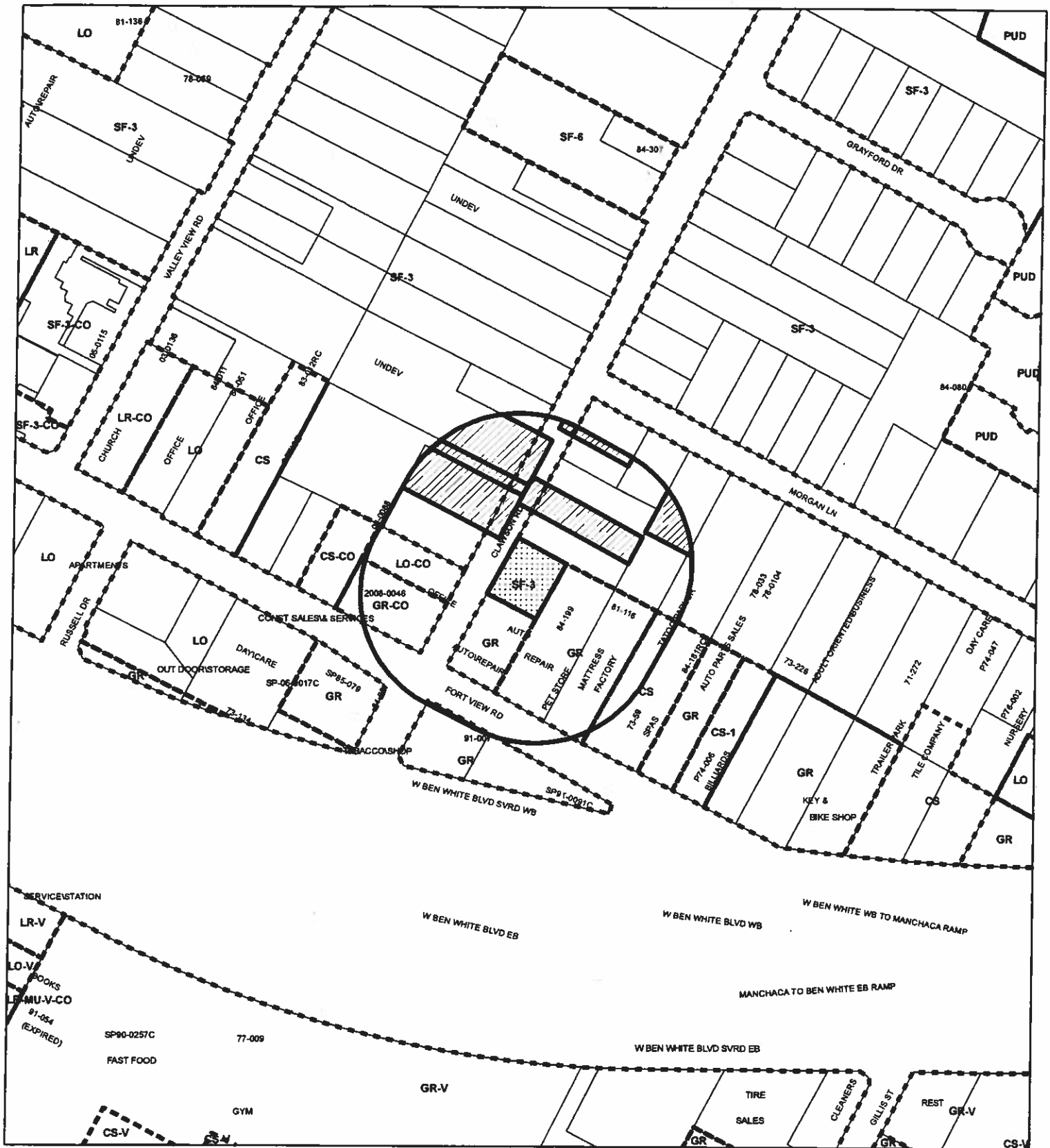

- Subject Tract
- Property Owner
- Buffer
- Zoning Boundary

OPERATOR: S. MEEKS

### PETITION

CASE#: C14-2008-0112  
 ADDRESS: 4209 CLAWSON RD  
 GRID: G19  
 CASE MANAGER: C. PATTERSON



1" = 200'

This map has been produced by G.I.S. Services for the sole purpose of geographic reference. No warranty is made by the City of Austin regarding specific accuracy or completeness.

P E T I T I O N

Date: July 7, 2008

File Number: C14-2008-0112

Address of

Rezoning Request: 4209 Clawson Road

To: Austin City Council

We, the undersigned owners of property affected by the requested zoning change described in the referenced file, do hereby protest against any change of the Land Development Code which would zone the property to any classification other than SF-3.

Our reasons for opposing this zoning change:

*Clawson Road is an overwhelmingly residential street.* Changing 4209 Clawson to commercial use underscores and endorses the serious development pressure that Ben White poses to our residential, urban, neighborhood. In addition, two- or three-story commercial massing does not fit the predominant one-story residential massing found in this part of the neighborhood. This march of commercial development down Clawson Road would seriously degrade our residential property values, to say nothing of the quality of life we enjoy in one of Austin's few urban neighborhoods.

*Clawson Road cannot support any more commercial traffic.* Currently, delivery vehicles and tow trucks serving the businesses at the corner of Clawson and Fort View block one lane or the other on a daily basis. Another commercial property on Clawson Road will lengthen the daily obstacle course faced by local drivers, cyclists, and pedestrians.

*Commercial parking at 4209 Clawson will pose serious problems for its neighbors.* Vehicles parked in front of the property would make it difficult or impossible to see oncoming traffic from our driveways. In addition, parking overflow will inevitably find its way to the limited "friends and family" spots in front of our homes.

(PLEASE USE BLACK INK WHEN SIGNING PETITION)

SignaturePrinted NameAddress

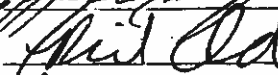
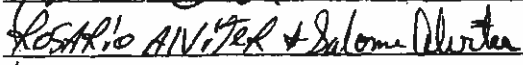
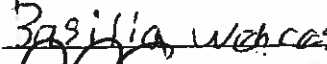
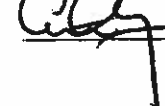
	Jeffery A. Twining	4205 Clawson
	Rick C. Anderson	4202 Clawson
	Rosario Alvirer + Salome Alvirer	4108 Clawson Rd
	Basilina Wehras	4200 Clawson Rd
	ARTHUR QUINN	1609 Morgan Ln

P E T I T I O N

Date: July 7, 2008

File Number: C14-2008-0112

Address of

Rezoning Request: 4209 Clawson Road

To: Austin City Council

We, the undersigned owners of property affected by the requested zoning change described in the referenced file, do hereby protest against any change of the Land Development Code which would zone the property to any classification other than SF-3.

Our reasons for opposing this zoning change:

*Clawson Road is an overwhelmingly residential street.* Changing 4209 Clawson to commercial use underscores and endorses the serious development pressure that Ben White poses to our residential, urban, neighborhood. In addition, two- or three-story commercial massing does not fit the predominant one-story residential massing found in this part of the neighborhood. This march of commercial development down Clawson Road would seriously degrade our residential property values, to say nothing of the quality of life we enjoy in one of Austin's few urban neighborhoods.

*Clawson Road cannot support any more commercial traffic.* Currently, delivery vehicles and tow trucks serving the businesses at the corner of Clawson and Fort View block one lane or the other on a daily basis. Another commercial property on Clawson Road will lengthen the daily obstacle course faced by local drivers, cyclists, and pedestrians.

*Commercial parking at 4209 Clawson will pose serious problems for its neighbors.* Vehicles parked in front of the property would make it difficult or impossible to see oncoming traffic from our driveways. In addition, parking overflow will inevitably find its way to the limited "friends and family" spots in front of our homes.

(PLEASE USE BLACK INK WHEN SIGNING PETITION)

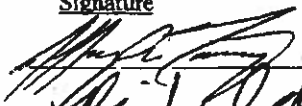
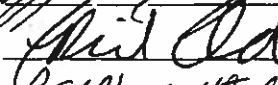
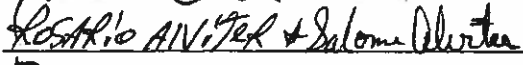
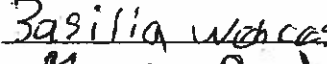
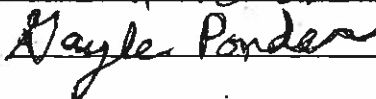
<u>Signature</u>	<u>Printed Name</u>	<u>Address</u>
	Kelly A. Twining	4205 Clawson
	Rick C. Anderson	4202 Clawson
	Roberto Alvarez	4108 Clawson Rd
	Basilia Wehner	4200 Clawson Rd
	GAYLE PONDER	1617 MORAN LN



**C14-2008-112 Petitioners**

Owner Name	Address	TCAD Parcel Number
<b>Jeffrey A. Twining</b>	4205 Clawson Road	0406090102
<b>Rick C. Anderson</b>	4202 Clawson Road	0406100227
<b>Rosario &amp; Salome Alviter</b>	4108 Clawson Road	0406100238
<b>Basilia Alviter</b>	4200 Clawson Road	0406100226
<b>Arthur Quinn</b>	1609 Morgan Lane	0406090136
<b>Gayle Ponder</b>	1617 Morgan Lane	0406090130

4 0609

Revision Date  
01/26/2006

0 120 200 Feet



40718	40719	40720
40721	40722	40723
40724	40725	40726
40727	40728	40729
40730	40731	40732
40733	40734	40735
40736	40737	40738
40739	40740	40741
40742	40743	40744
40745	40746	40747
40748	40749	40750
40751	40752	40753
40754	40755	40756
40757	40758	40759
40760	40761	40762
40763	40764	40765
40766	40767	40768
40769	40770	40771
40772	40773	40774
40775	40776	40777
40778	40779	40780
40781	40782	40783
40784	40785	40786
40787	40788	40789
40790	40791	40792
40793	40794	40795
40796	40797	40798
40799	40800	40801
40802	40803	40804
40805	40806	40807
40808	40809	40810
40811	40812	40813
40814	40815	40816
40817	40818	40819
40820	40821	40822
40823	40824	40825
40826	40827	40828
40829	40830	40831
40832	40833	40834
40835	40836	40837
40838	40839	40840
40841	40842	40843
40844	40845	40846
40847	40848	40849
40850	40851	40852
40853	40854	40855
40856	40857	40858
40859	40860	40861
40862	40863	40864
40865	40866	40867
40868	40869	40870
40871	40872	40873
40874	40875	40876
40877	40878	40879
40880	40881	40882
40883	40884	40885
40886	40887	40888
40889	40890	40891
40892	40893	40894
40895	40896	40897
40898	40899	40900
40901	40902	40903
40904	40905	40906
40907	40908	40909
40910	40911	40912
40913	40914	40915
40916	40917	40918
40919	40920	40921
40922	40923	40924
40925	40926	40927
40928	40929	40930
40931	40932	40933
40934	40935	40936
40937	40938	40939
40940	40941	40942
40943	40944	40945
40946	40947	40948
40949	40950	40951
40952	40953	40954
40955	40956	40957
40958	40959	40960
40961	40962	40963
40964	40965	40966
40967	40968	40969
40970	40971	40972
40973	40974	40975
40976	40977	40978
40979	40980	40981
40982	40983	40984
40985	40986	40987
40988	40989	40990
40991	40992	40993
40994	40995	40996
40997	40998	40999
41000	41001	41002
41003	41004	41005
41006	41007	41008
41009	41010	41011
41012	41013	41014
41015	41016	41017
41018	41019	41020
41021	41022	41023
41024	41025	41026
41027	41028	41029
41030	41031	41032
41033	41034	41035
41036	41037	41038
41039	41040	41041
41042	41043	41044
41045	41046	41047
41048	41049	41050
41051	41052	41053
41054	41055	41056
41057	41058	41059
41060	41061	41062
41063	41064	41065
41066	41067	41068
41069	41070	41071
41072	41073	41074
41075	41076	41077
41078	41079	41080
41081	41082	41083
41084	41085	41086
41087	41088	41089
41090	41091	41092
41093	41094	41095
41096	41097	41098
41099	41100	41101
41102	41103	41104
41105	41106	41107
41108	41109	41110
41111	41112	41113
41114	41115	41116
41117	41118	41119
41120	41121	41122
41123	41124	41125
41126	41127	41128
41129	41130	41131
41132	41133	41134
41135	41136	41137
41138	41139	41140
41141	41142	41143
41144	41145	41146
41147	41148	41149
41150	41151	41152
41153	41154	41155
41156	41157	41158
41159	41160	41161
41162	41163	41164
41165	41166	41167
41168	41169	41170
41171	41172	41173
41174	41175	41176
41177	41178	41179
41180	41181	41182
41183	41184	41185
41186	41187	41188
41189	41190	41191
41192	41193	41194
41195	41196	41197
41198	41199	41200

NAD\_1983\_StatePlane\_Texas\_Central\_FIPS\_4203\_Feet  
Projection: Lambert\_Conformal\_Conic  
N  
Red line: 100 scale map  
Blue line: 100 scale map  
Green line: 100 scale map  
Black line: 100 scale map

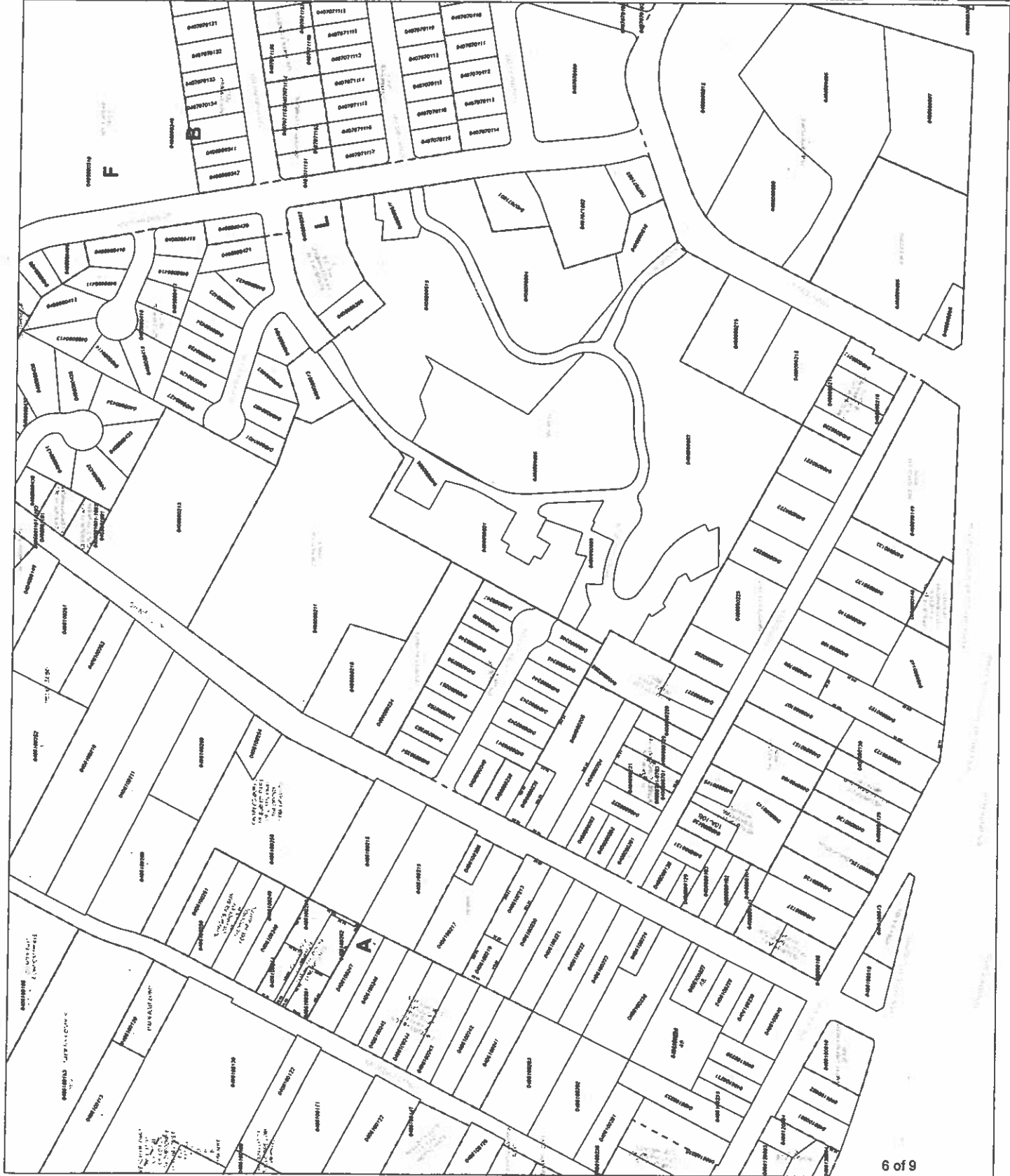
Travis Central Appraisal District  
8314 Cross Park Drive  
Austin, Texas 78754  
Internet Address: www.traviscentral.org  
Main Telephone Number (512) 834-8317  
TDD (512) 834-8328  
P.O. Box 149012  
Austin, Texas 78714

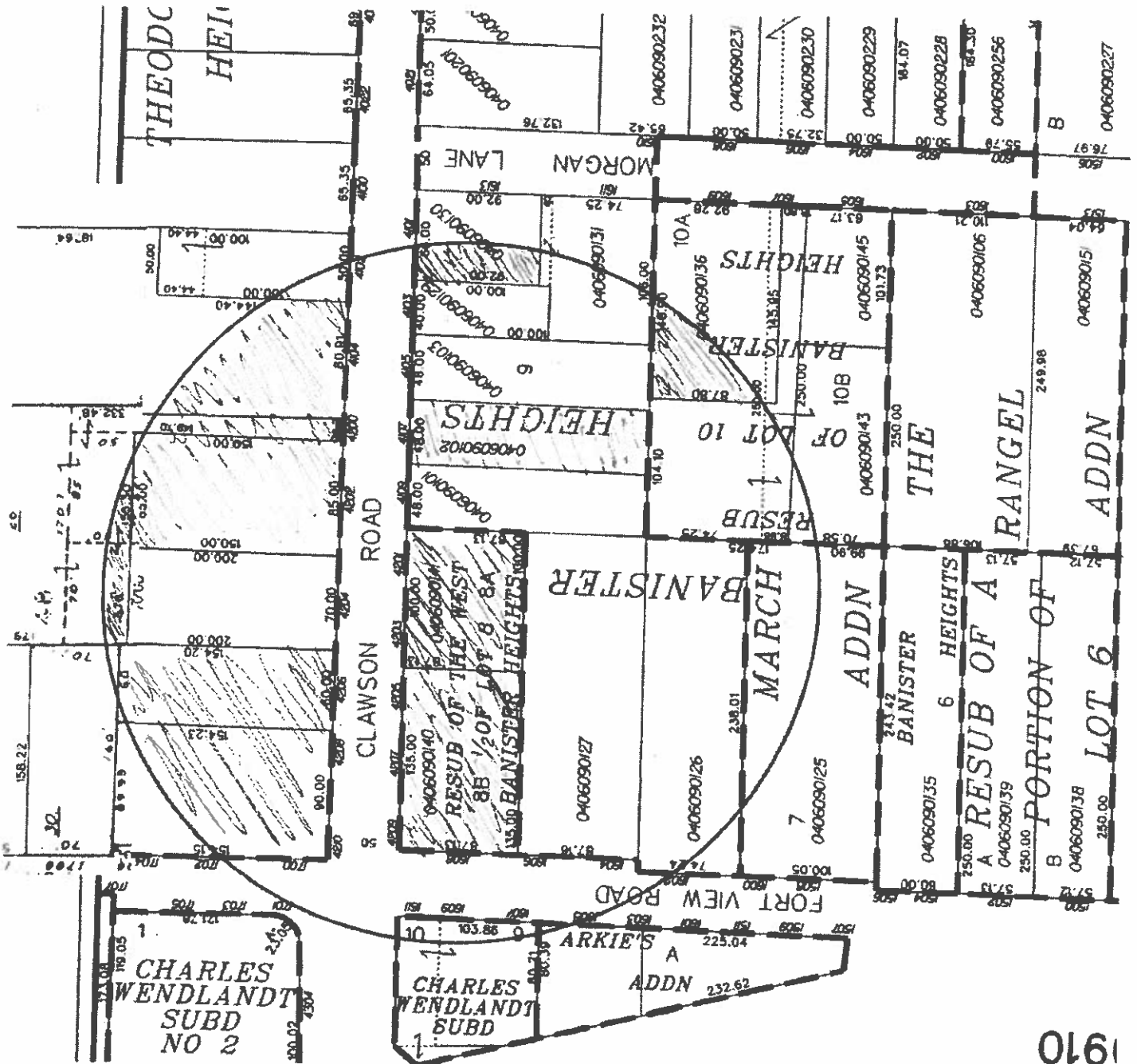



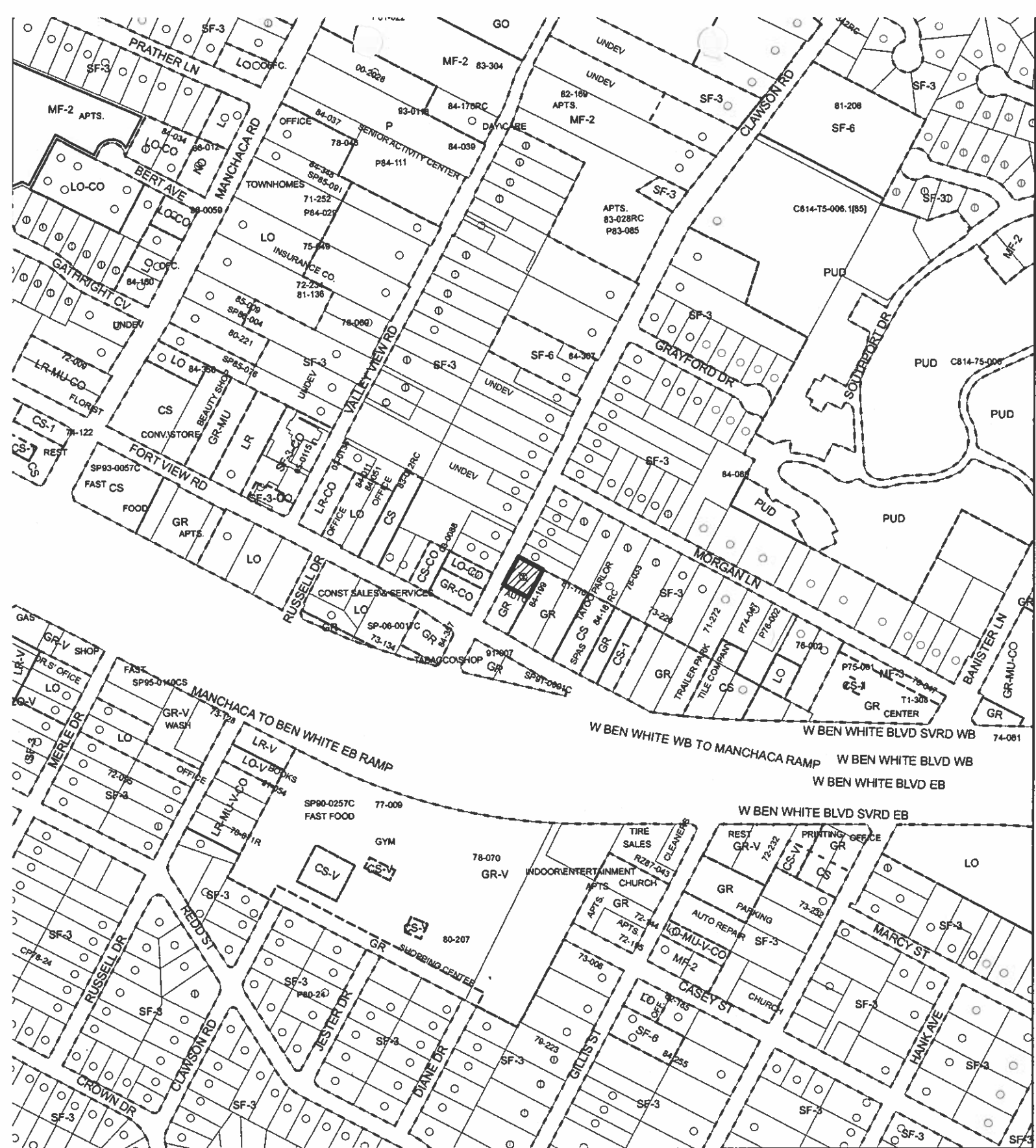

 For Zoning Change  
 Against Zoning Change

01910



# ZONING

ZONING CASE#: C14-2008-0112  
 ADDRESS: 4209 CLAWSON RD  
 SUBJECT AREA: 0.19 ACRES  
 GRID: G19  
 MANAGER: R. LEVINSKI

-  SUBJECT TRACT
-  ZONING BOUNDARY
-  PENDING CASE

OPERATOR: S. MEEKS

This map has been produced by G.I.S. Services for the sole purpose of geographic reference. No warranty is made by the City of Austin regarding specific accuracy or completeness.



1" = 400'

SF-3

MORGAN

10B

10A

SF-3

4209 CLAWSON RD

8A

CLAWSON

78-033  
78-0104

73-226

P74-006  
BILLIARDS

84-181RC  
AUTO PARTS SALES

73-89  
TATTOO PARLOR

SPAS

81-116

PET-STORE  
MATTRESS  
FACTORY

84-199

AUTO REPAIR

AUTO REPAIR

91-007

GR

TABACCO SHOP

SP91-0097C

WHITE BLVD

SF-3

LO-CO

OFFICE

2008-0046  
GR-CO

CONST-SALES & SERVICES

CS-CO

88-00-80

OFFICE

CS

OUT DOOR STORAGE

PAWN SHOP  
LQ  
SP-06-007C  
DAY CARE

73-134



REZONING REQUEST

C14-2008-0112

Minware - 4209 Clawson Road

From: SF-3

To: GR

