

ORDINANCE NO. Late Backup

106

1 AN ORDINANCE REZONING AND CHANGING THE ZONING MAP FOR THE
2 PROPERTY GENERALLY KNOWN AS THE VOLMA AND WARNETA
3 OVERTON HOUSE LOCATED AT 1403 SPRINGDALE ROAD IN THE MLK-183
4 NEIGHBORHOOD PLAN AREA FROM FAMILY RESIDENCE-
5 NEIGHBORHOOD PLAN (SF-3-NP) COMBINING DISTRICT TO FAMILY
6 RESIDENCE-HISTORIC LANDMARK-NEIGHBORHOOD PLAN (SF-3-H-NP)
7 COMBINING DISTRICT.

8
9 BE IT ORDAINED BY THE CITY COUNCIL OF THE CITY OF AUSTIN:

10
11 **PART 1.** The zoning map established by Section 25-2-191 of the City Code is amended to
12 change the base district from family residence-neighborhood plan (SF-3-NP) combining
13 district to family residence-historic landmark-neighborhood plan (SF-3-H-NP) combining
14 district on the property described in Zoning Case No. C14H-2008-0036, on file at the
15 Neighborhood Planning and Zoning Department, as follows:

16
17 Lot 4, Block 4, Cedar Valley Subdivision, a subdivision in the City of Austin,
18 Travis County, Texas, according to the map or plat of record in Plat Book 5, Page
19 55, of the Plat Records of Travis County, Texas (the "Property"),
20

21 generally known as the Volma and Warneta Overton House, locally known as 1403
22 Springdale Road, in the City of Austin, Travis County, Texas, and generally identified in
23 the map attached as Exhibit "A".

24
25 **PART 2.** Except as otherwise provided in this ordinance, the Property is subject to
26 Ordinance No. 021107-Z-12b that established the MLK-183 neighborhood plan combining
27 district.
28
29
30
31
32
33
34
35
36
37

1 **PART 3.** This ordinance takes effect on _____, 2008.
2
3

4 **PASSED AND APPROVED**
5

6 §
7 §
8 _____, 2008 § _____
9

10 Will Wynn
11 Mayor
12



13 **APPROVED:** _____ **ATTEST:** _____
14

15 David Allan Smith
City Attorney

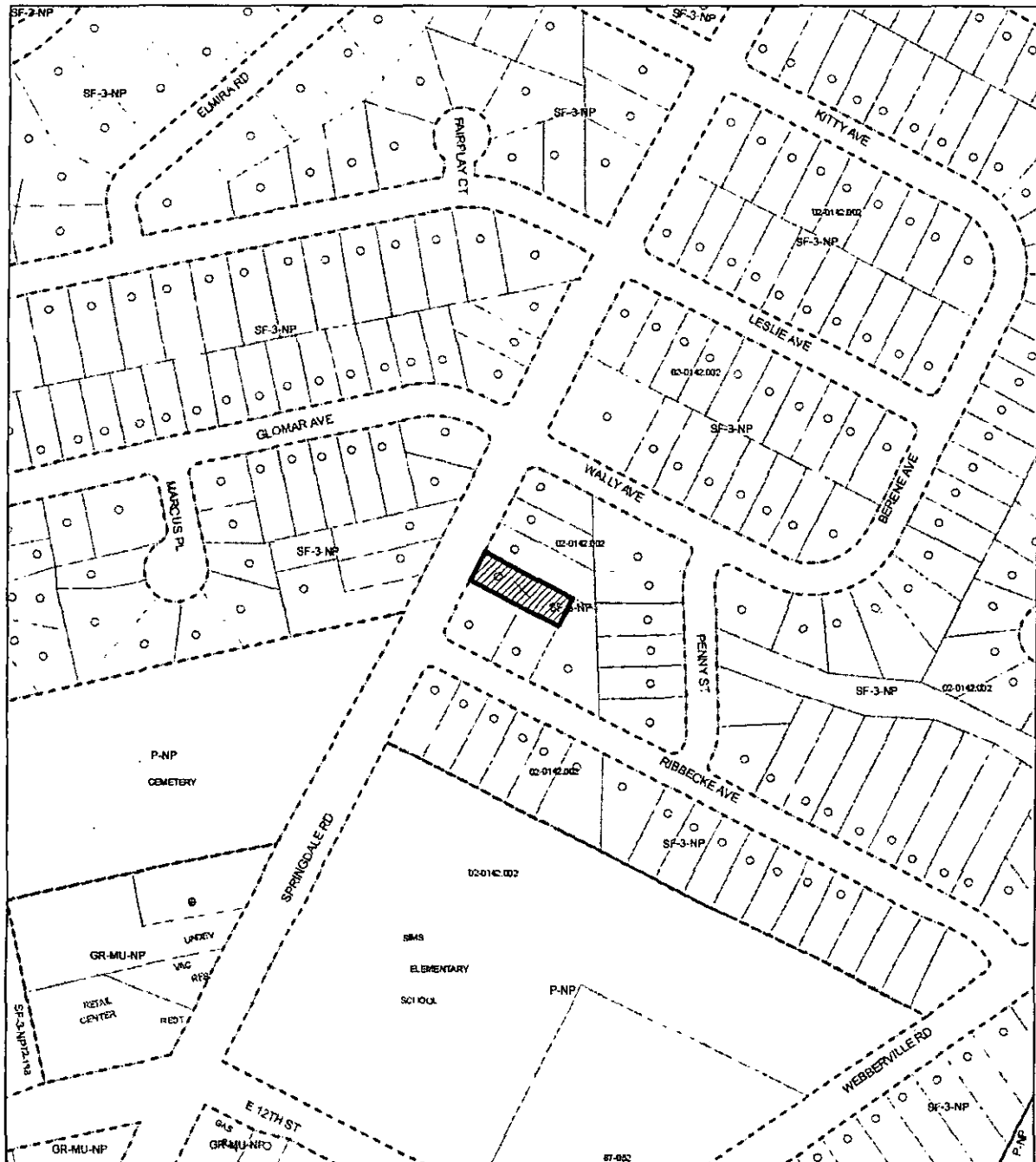
Shirley A. Gentry
City Clerk

LOCATION MAP

1" = 200'

-  **SUBJECT TRACT**
-  **ZONING BOUNDARY**
-  **PENDING CASE**

OPERATOR: S. MEEKS

HISTORIC ZONING

ZONING CASE#: C14H-2008-0036
 ADDRESS: 1403 SPRINGDALE RD
 SUBJECT AREA: 0.000 ACRES
 GRID: M23
 MANAGER: S. SADOWSKY



This map has been produced by G.I.S. Services for the sole purpose of geographic reference.
 No warranty is made by the City of Austin regarding specific accuracy or completeness.