

**ORDINANCE NO. 20081218-099**

**AN ORDINANCE REZONING AND CHANGING THE ZONING MAP FOR THE PROPERTY LOCATED AT 2608 AND 2610 EAST 2<sup>ND</sup> STREET IN THE HOLLY NEIGHBORHOOD PLAN AREA FROM LIMITED INDUSTRIAL SERVICE-NEIGHBORHOOD PLAN (LI-NP) COMBINING DISTRICT TO FAMILY RESIDENCE-NEIGHBORHOOD PLAN (SF-3-NP) COMBINING DISTRICT.**

**BE IT ORDAINED BY THE CITY COUNCIL OF THE CITY OF AUSTIN:**

**PART 1.** The zoning map established by Section 25-2-191 of the City Code is amended to change the base district from limited industrial service-neighborhood plan (LI-NP) combining district to family residence-neighborhood plan (SF-3-NP) combining district on the property described in Zoning Case No. C14-2008-0225, on file at the Neighborhood Planning and Zoning Department, as follows:

Lots 5 and 6, Block 3, Highway Addition Subdivision, a subdivision in the City of Austin, Travis County, Texas, according to the map or plat of record in Plat Book 3, Page 149, of the Plat Records of Travis County, Texas (the "Property"),

locally known as 2608 and 2610 East 2<sup>nd</sup> Street, in the City of Austin, Travis County, Texas, and generally identified in the map attached as Exhibit "A".

**PART 2.** The Property is subject to Ordinance No. 011213-44 that established the Holly neighborhood plan combining district.

**PART 3.** This ordinance takes effect on December 29, 2008.

**PASSED AND APPROVED**

December 18, 2008

§  
§  
§

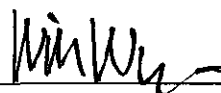

Will Wynn  
Mayor

**APPROVED:**

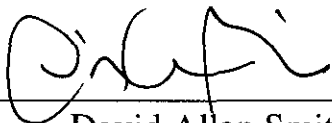

David Allan Smith  
City Attorney

**ATTEST:**

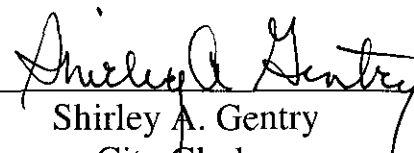

Shirley A. Gentry  
City Clerk

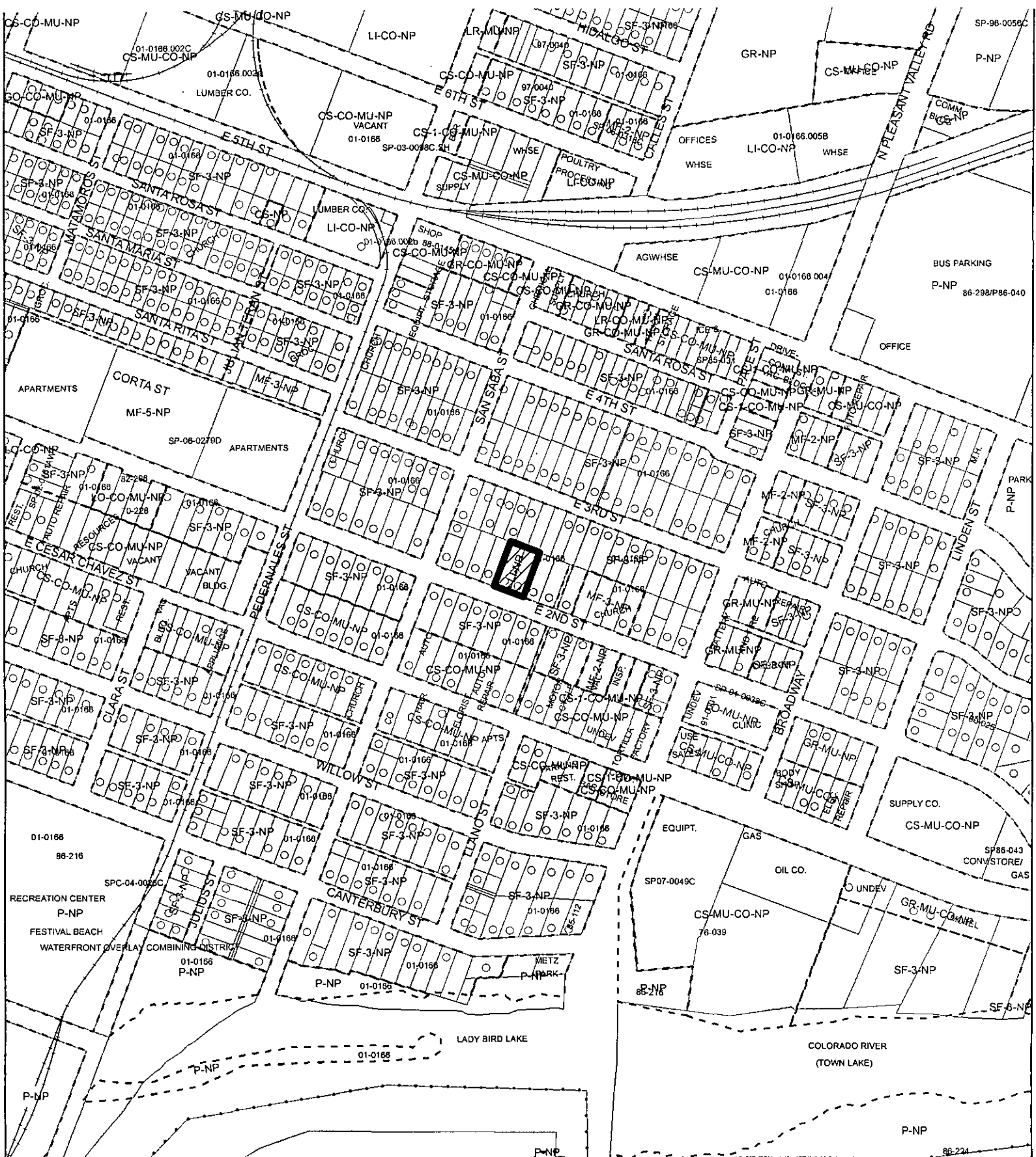

**N**

**1" = 400'**

**ZONING EXHIBIT A**

**LEGEND:**

- SUBJECT TRACT**
- ZONING BOUNDARY**
- PENDING CASE**

**OPERATOR: S. MEEKS**

**ZONING CASE#: C14-2008-0225**

**ADDRESS: 2608 & 2610 E 2ND ST**

**SUBJECT AREA: 0.34 ACRES**

**GRID: K21**

**MANAGER: J. HARDEN**

**CITY OF AUSTIN**  
FOUNDED 1839

This map has been produced by G.I.S. Services for the sole purpose of geographic reference. No warranty is made by the City of Austin regarding specific accuracy or completeness.