

ORDINANCE NO. 20090924-088

AN ORDINANCE AMENDING ORDINANCE NO. 021010-11, WHICH ADOPTED THE SOUTHEAST COMBINED NEIGHBORHOOD PLAN AS AN ELEMENT OF THE AUSTIN TOMORROW COMPREHENSIVE PLAN, TO CHANGE THE LAND USE DESIGNATION ON THE FUTURE LAND USE MAP FOR PROPERTY LOCATED AT 6511 EAST BEN WHITE BOULEVARD EASTBOUND.

BE IT ORDAINED BY THE CITY COUNCIL OF THE CITY OF AUSTIN:

PART 1. Ordinance No. 021010-11 adopted the Southeast Combined Neighborhood Plan as an element of the Austin Tomorrow Comprehensive Plan.

PART 2. Ordinance No. 021010-11 is amended to change the land use designation from industry use to commercial use for the property located at 6511 East Ben White Boulevard Eastbound on the future land use map attached as Exhibit "A" and incorporated in this ordinance, and described in File NPA-2009-0014.01 at the Neighborhood Planning and Zoning Department.

PART 3. This ordinance takes effect on October 5, 2009.

PASSED AND APPROVED

_____, September 24, 2009

§
§
§

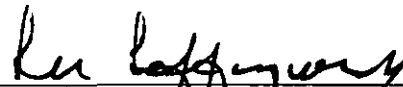
Lee Leffingwell
Mayor

APPROVED:

David Allan Smith
City Attorney

ATTEST:

Shirley A. Gentry
City Clerk

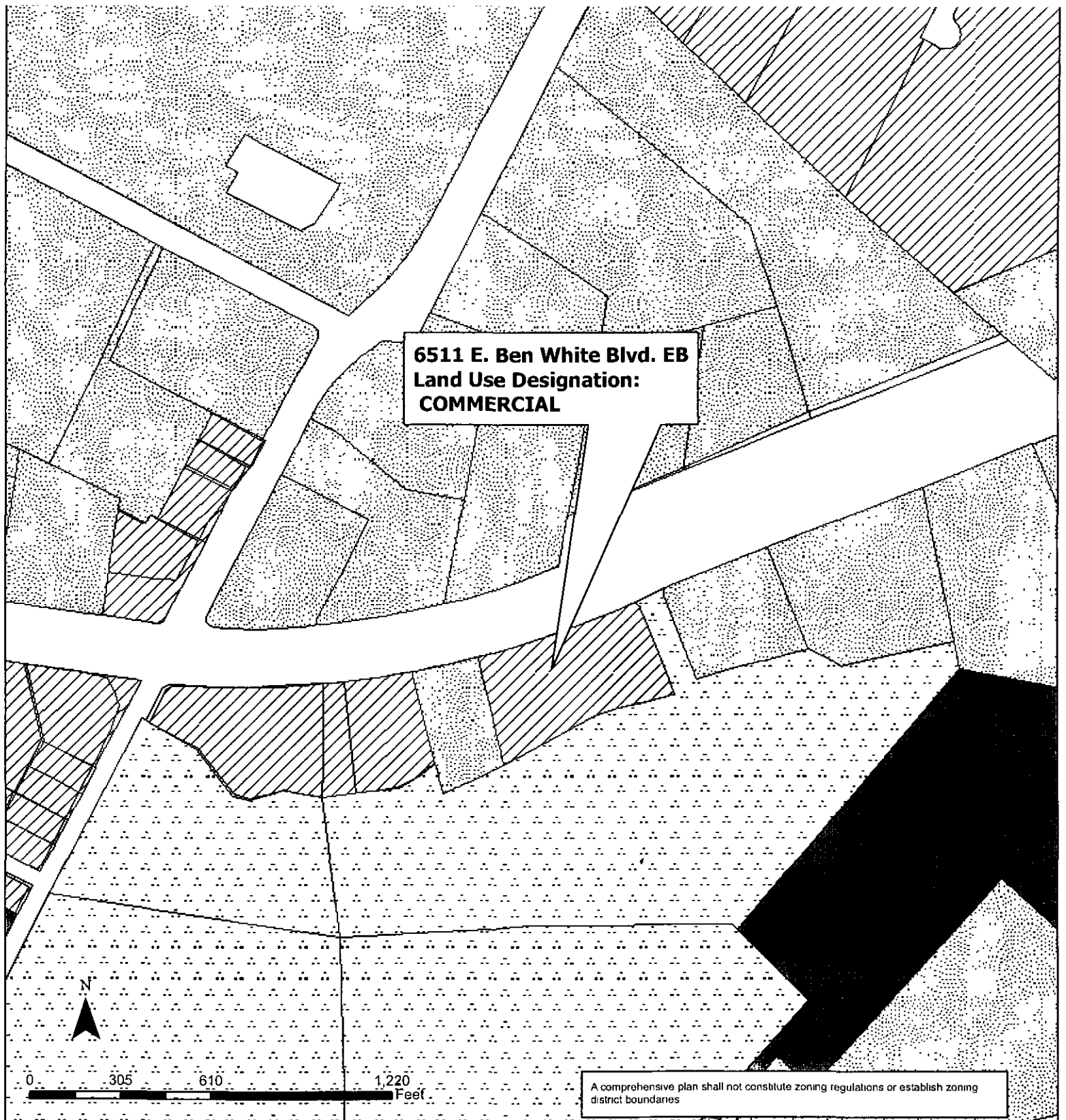

EXHIBIT A

Southeast Combined Neighborhood Plan NPA-2009-0014.01

This map has been produced by the City of Austin Planning & Development Review Department for the sole purpose of assisting in neighborhood planning discussions and decisions and is not warranted for any other use. No warranty is made by the City regarding its accuracy or completeness.



Created on Sept. 3, 2009_MM

Future Land Use

| | | | |
|--|------------|--|-------------------|
| | Civic | | Mixed Residential |
| | Office | | Mixed Use |
| | Commercial | | Multi-Family |
| | Industry | | Single-Family |