

ORDINANCE NO. \_\_\_\_\_

1 AN ORDINANCE ESTABLISHING INITIAL PERMANENT ZONING FOR THE  
2 PROPERTY GENERALLY KNOWN AS GREENSHORES ON LAKE AUSTIN  
3 LOCATED AT ROBBIN ROAD AND CHANGING THE ZONING MAP FROM  
4 INTERIM-LAKE AUSTIN RESIDENCE (I-LA) DISTRICT TO LAKE AUSTIN  
5 RESIDENCE (LA) DISTRICT.  
6

7 BE IT ORDAINED BY THE CITY COUNCIL OF THE CITY OF AUSTIN:  
8

9 PART 1. The zoning map established by Section 25-2-191 of the City Code is amended to  
10 change the base districts on the property described in Zoning Case No. C14-2010-0108, on  
11 file at the Planning and Development Review Department, as follows:  
12

13 Tract One: From interim-Lake Austin residence (I-LA) district to Lake Austin  
14 residence (LA) district.  
15

16 A 0.666 acre tract of land, more or less out of the James Spillman Survey No. Two,  
17 in Travis County, Texas, recorded in Volume 6857, Page 1692, Deed Records of  
18 Travis County, Texas, and more particularly described by metes and bounds as  
19 follows:  
20

21 BEGINNING in the East line of Lot 14, Briarpatch, at the Southwest corner of that  
22 certain tract conveyed to Wm. L. Richmond by Deed recorded in Volume 2316,  
23 Page 159, of the Travis County Deed Records, said point being the Northwest  
24 corner of this tract;  
25

26 THENCE S 18° 29' W 141.92 feet for the Southwest corner of this tract;  
27

28 THENCE S 54° 01' E 182.30 feet for the Southeast corner of this tract;  
29

30 THENCE N 27° 31' E 167.00 feet for the Northeast corner hereof;  
31

32 THENCE N 65° 32' W 44.90 feet and N 61° 38' W 158.00 feet to the place of  
33 beginning.  
34

35 locally known as the property located at Robbin Road, in the City of Austin, Travis  
36 County, Texas, and generally identified in the map attached as Exhibit "A".  
37

1  
2 **PART 2.** This ordinance takes effect on \_\_\_\_\_, 2010.  
3  
4

5 **PASSED AND APPROVED**  
6

7 §  
8 §  
9 \_\_\_\_\_, 2010 § \_\_\_\_\_  
10

11 Lee Leffingwell  
12 Mayor  
13



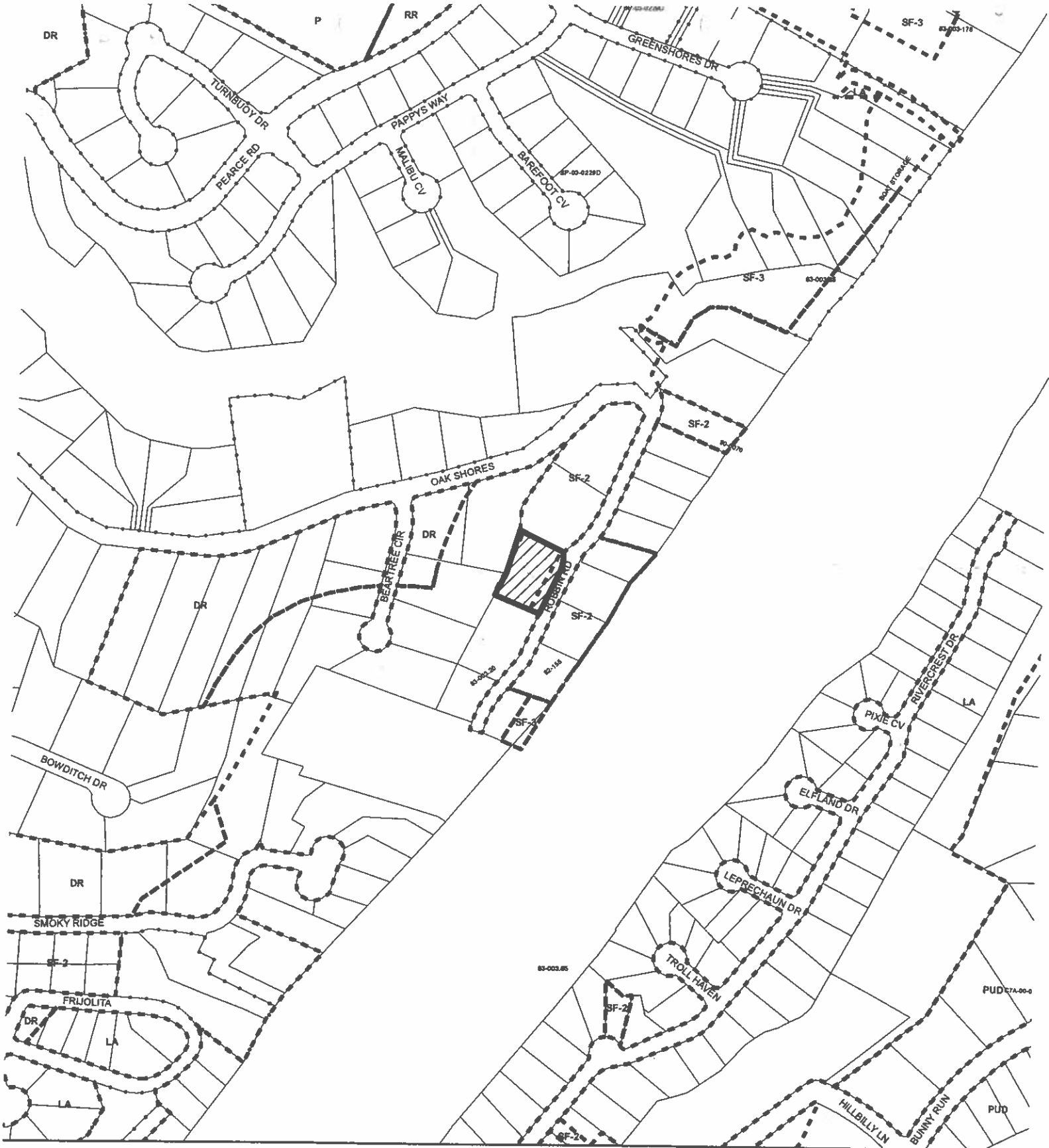

14 **APPROVED:** \_\_\_\_\_ **ATTEST:** \_\_\_\_\_  
15

16 Karen M. Kennard  
Acting City Attorney

Shirley A. Gentry  
City Clerk



# **ZONING EXHIBIT A**

-  N
-  SUBJECT TRACT
-  PENDING CASE
-  ZONING BOUNDARY

ZONING CASE#: C14-2010-0108  
 LOCATION: ROBBIN RD  
 SUBJECT AREA: 0.00  
 GRID: E28  
 MANAGER: CLARK PATTERSON



1" = 400'

This map has been produced by the Communications Technology Management Dept. on behalf of the Planning Development Review Dept. for the sole purpose of geographic reference. No warranty is made by the City of Austin regarding specific accuracy or completeness.