

ORDINANCE NO. 20110217-067

AN ORDINANCE AMENDING ORDINANCE NO. 20061116-055, WHICH ADOPTED THE EAST RIVERSIDE/OLTORF COMBINED NEIGHBORHOOD PLAN AS AN ELEMENT OF THE AUSTIN TOMORROW COMPREHENSIVE PLAN, TO CHANGE THE LAND USE DESIGNATION ON THE FUTURE LAND USE MAP FOR PROPERTY LOCATED AT 2501 SOUTH IH-35.

BE IT ORDAINED BY THE CITY COUNCIL OF THE CITY OF AUSTIN:

PART 1. Ordinance No. 20061116-055 adopted the East Riverside/Oltorf Combined Neighborhood Plan as an element of the Austin Tomorrow Comprehensive Plan.

PART 2. Ordinance No. 20061116-055 is amended to change the land use designation from commercial use to mixed use for the property located at 2501 South IH-35 on the future land use map attached as Exhibit "A" and incorporated in this ordinance, and described in File NPA-2010-0021.03.SH at the Planning and Development Review Department.

PART 3. This ordinance takes effect on February 28, 2011.

PASSED AND APPROVED

February 17, 2011

§
§
§



Leo Leffingwell
Mayor

APPROVED:

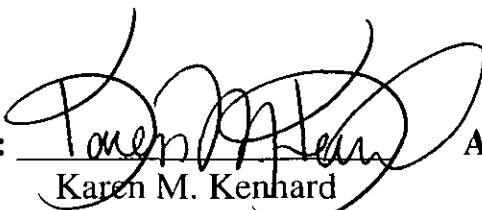

Karen M. Kenhard
Acting City Attorney

ATTEST:

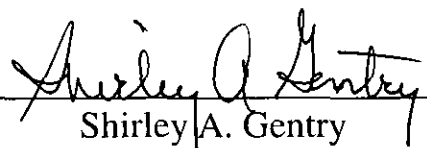

Shirley A. Gentry
City Clerk

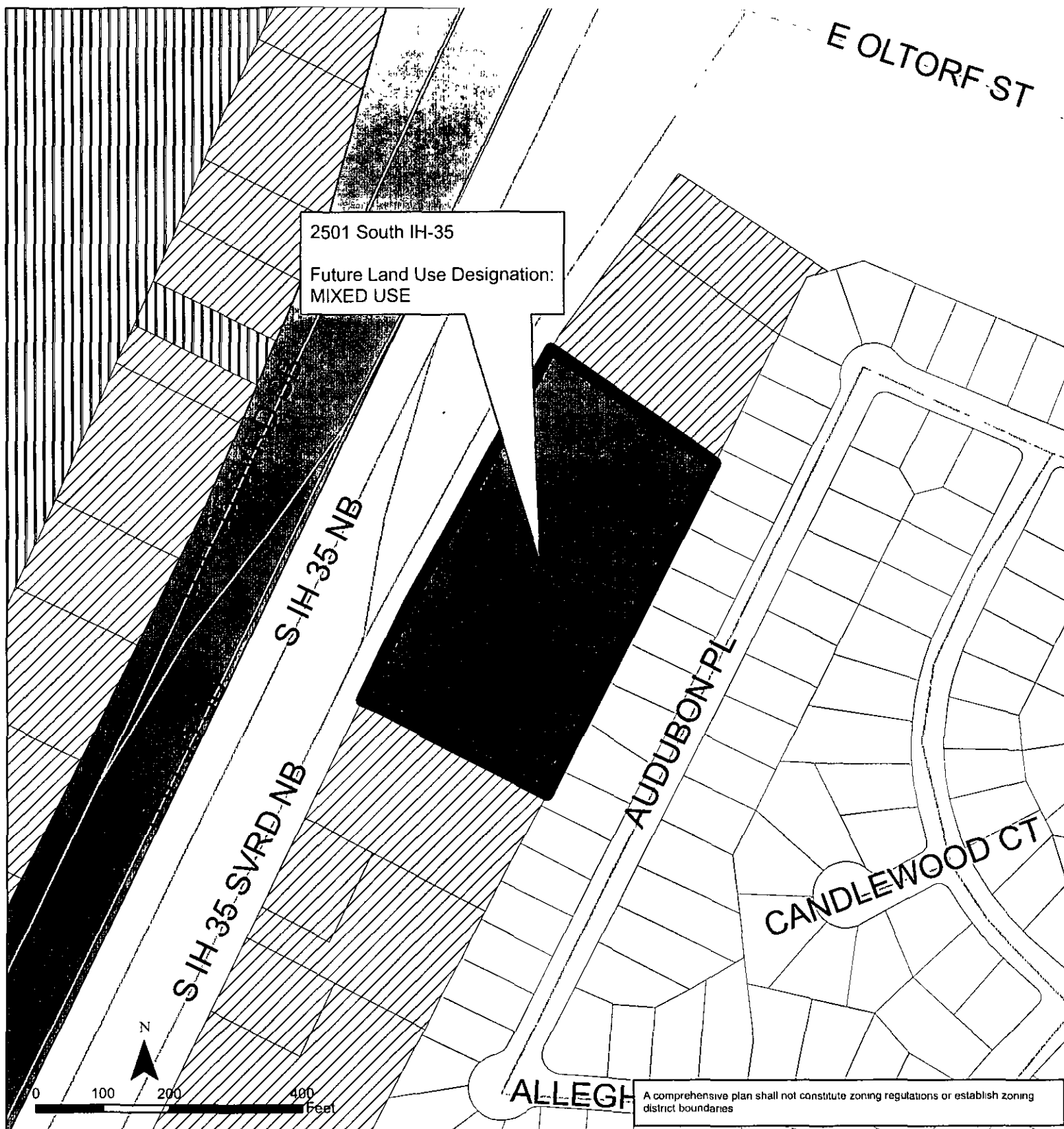

Exhibit A

East Riverside-Oltorf Combined Neighborhood Plan Amendment NPA-2010-0021.03.SH

This map has been produced by the City of Austin Planning & Development Review Department for the sole purpose of assisting in neighborhood planning decisions and is not warranted for any other use. No warranty is made by the City regarding its accuracy or completeness.

Future Land Use

- Mixed Use
- Single-Family
- Commercial
- Civic
- Transportation

