

C12
1

SUBDIVISION REVIEW SHEET

CASE NO.: C8-2011-0019.0A

Z.A.P. DATE: June 7, 2011

SUBDIVISION NAME: Resubdivision of Lots 2 and 3, Block A, Parmer South Subdivision

AREA: 86.299 acres

LOTS: 3

OWNER/APPLICANT: Dell USA LP

AGENT: Bury & Partners
(Joseph Isaja)

ADDRESS OF SUBDIVISION: E. Parmer Lane at Tech Ridge Blvd.

GRIDS: N - 33/34

COUNTY: Travis

WATERSHED: Walnut Creek

JURISDICTION: Full Purpose

EXISTING ZONING: LI-PDA

PROPOSED LAND USE: Office

SIDEWALKS:

Sidewalks will be installed along Parmer Lane, Tech Ridge Boulevard and McCallen Pass.

DEPARTMENT COMMENTS:

The request is for approval of a resubdivision namely, Resubdivision of Lots 2 and 3. Block A, Parmer South Subdivision. This plat consists of 3 lots on 86.299 acres.

STAFF RECOMMENDATION:

The staff recommends approval of the resubdivision plat; it meets all City of Austin and Texas Local Government Code requirements.

ZONING AND PLATTING COMMISSION ACTION:

CASE MANAGER: Sylvia Limon
Email Address: sylvia.limon@ci.austin.tx.us

PHONE: 974-2767

C12
2

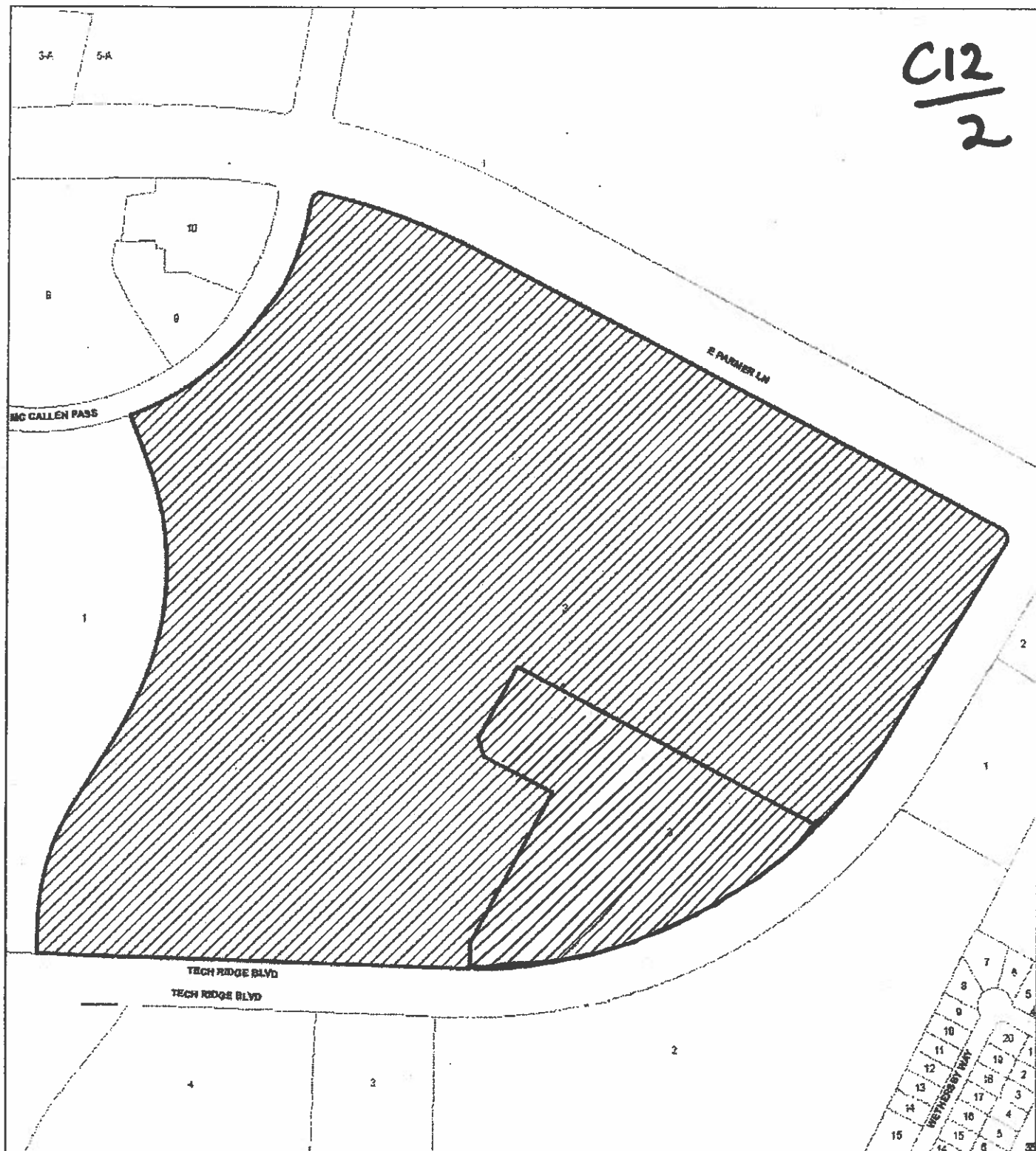

Subject Tract



Base Map

Parmer South Subdivision

CASE#: C8-2011-0019.0A

ADDRESS: E. Parmer Lane

MANAGER: Sylvia Limon

1" = 400'

OPERATOR: D. SUSTAITA

This map has been produced by Notification Services for the sole purpose of geographic reference.
No warranty is made by the City of Austin regarding specific accuracy or completeness.

PARMER SOUTH SUBDIVISION A RESUBDIVISION OF METROTECH SECTION ONE, METRO TECH SECTION TWO, THE CROSSING AT PARKER LANE SECTION ONE AND THE CROSSING AT PARKER LANE SECTION TWO.



CURVE TABLE

Sta.	Begin	End	Length	Radius	Chord Length	Chord Bearing
1	0+00.00	0+15.00	15.00	140.00	14.93	S 89° 54' 30" E
2	0+15.00	0+30.00	15.00	140.00	14.93	S 89° 54' 30" E
3	0+30.00	0+45.00	15.00	140.00	14.93	S 89° 54' 30" E
4	0+45.00	0+60.00	15.00	140.00	14.93	S 89° 54' 30" E
5	0+60.00	0+75.00	15.00	140.00	14.93	S 89° 54' 30" E
6	0+75.00	0+90.00	15.00	140.00	14.93	S 89° 54' 30" E
7	0+90.00	0+105.00	15.00	140.00	14.93	S 89° 54' 30" E
8	0+105.00	0+120.00	15.00	140.00	14.93	S 89° 54' 30" E
9	0+120.00	0+135.00	15.00	140.00	14.93	S 89° 54' 30" E
10	0+135.00	0+150.00	15.00	140.00	14.93	S 89° 54' 30" E
11	0+150.00	0+165.00	15.00	140.00	14.93	S 89° 54' 30" E
12	0+165.00	0+180.00	15.00	140.00	14.93	S 89° 54' 30" E
13	0+180.00	0+195.00	15.00	140.00	14.93	S 89° 54' 30" E
14	0+195.00	0+210.00	15.00	140.00	14.93	S 89° 54' 30" E
15	0+210.00	0+225.00	15.00	140.00	14.93	S 89° 54' 30" E
16	0+225.00	0+240.00	15.00	140.00	14.93	S 89° 54' 30" E
17	0+240.00	0+255.00	15.00	140.00	14.93	S 89° 54' 30" E
18	0+255.00	0+270.00	15.00	140.00	14.93	S 89° 54' 30" E
19	0+270.00	0+285.00	15.00	140.00	14.93	S 89° 54' 30" E
20	0+285.00	0+300.00	15.00	140.00	14.93	S 89° 54' 30" E
21	0+300.00	0+315.00	15.00	140.00	14.93	S 89° 54' 30" E
22	0+315.00	0+330.00	15.00	140.00	14.93	S 89° 54' 30" E
23	0+330.00	0+345.00	15.00	140.00	14.93	S 89° 54' 30" E
24	0+345.00	0+360.00	15.00	140.00	14.93	S 89° 54' 30" E
25	0+360.00	0+375.00	15.00	140.00	14.93	S 89° 54' 30" E
26	0+375.00	0+390.00	15.00	140.00	14.93	S 89° 54' 30" E
27	0+390.00	0+405.00	15.00	140.00	14.93	S 89° 54' 30" E
28	0+405.00	0+420.00	15.00	140.00	14.93	S 89° 54' 30" E
29	0+420.00	0+435.00	15.00	140.00	14.93	S 89° 54' 30" E
30	0+435.00	0+450.00	15.00	140.00	14.93	S 89° 54' 30" E
31	0+450.00	0+465.00	15.00	140.00	14.93	S 89° 54' 30" E
32	0+465.00	0+480.00	15.00	140.00	14.93	S 89° 54' 30" E
33	0+480.00	0+495.00	15.00	140.00	14.93	S 89° 54' 30" E
34	0+495.00	0+510.00	15.00	140.00	14.93	S 89° 54' 30" E
35	0+510.00	0+525.00	15.00	140.00	14.93	S 89° 54' 30" E
36	0+525.00	0+540.00	15.00	140.00	14.93	S 89° 54' 30" E
37	0+540.00	0+555.00	15.00	140.00	14.93	S 89° 54' 30" E
38	0+555.00	0+570.00	15.00	140.00	14.93	S 89° 54' 30" E
39	0+570.00	0+585.00	15.00	140.00	14.93	S 89° 54' 30" E
40	0+585.00	0+600.00	15.00	140.00	14.93	S 89° 54' 30" E
41	0+600.00	0+615.00	15.00	140.00	14.93	S 89° 54' 30" E
42	0+615.00	0+630.00	15.00	140.00	14.93	S 89° 54' 30" E
43	0+630.00	0+645.00	15.00	140.00	14.93	S 89° 54' 30" E
44	0+645.00	0+660.00	15.00	140.00	14.93	S 89° 54' 30" E
45	0+660.00	0+675.00	15.00	140.00	14.93	S 89° 54' 30" E
46	0+675.00	0+690.00	15.00	140.00	14.93	S 89° 54' 30" E
47	0+690.00	0+705.00	15.00	140.00	14.93	S 89° 54' 30" E
48	0+705.00	0+720.00	15.00	140.00	14.93	S 89° 54' 30" E
49	0+720.00	0+735.00	15.00	140.00	14.93	S 89° 54' 30" E
50	0+735.00	0+750.00	15.00	140.00	14.93	S 89° 54' 30" E
51	0+750.00	0+765.00	15.00	140.00	14.93	S 89° 54' 30" E
52	0+765.00	0+780.00	15.00	140.00	14.93	S 89° 54' 30" E
53	0+780.00	0+795.00	15.00	140.00	14.93	S 89° 54' 30" E
54	0+795.00	0+810.00	15.00	140.00	14.93	S 89° 54' 30" E
55	0+810.00	0+825.00	15.00	140.00	14.93	S 89° 54' 30" E
56	0+825.00	0+840.00	15.00	140.00	14.93	S 89° 54' 30" E
57	0+840.00	0+855.00	15.00	140.00	14.93	S 89° 54' 30" E
58	0+855.00	0+870.00	15.00	140.00	14.93	S 89° 54' 30" E
59	0+870.00	0+885.00	15.00	140.00	14.93	S 89° 54' 30" E
60	0+885.00	0+900.00	15.00	140.00	14.93	S 89° 54' 30" E
61	0+900.00	0+915.00	15.00	140.00	14.93	S 89° 54' 30" E
62	0+915.00	0+930.00	15.00	140.00	14.93	S 89° 54' 30" E
63	0+930.00	0+945.00	15.00	140.00	14.93	S 89° 54' 30" E
64	0+945.00	0+960.00	15.00	140.00	14.93	S 89° 54' 30" E
65	0+960.00	0+975.00	15.00	140.00	14.93	S 89° 54' 30" E
66	0+975.00	0+990.00	15.00	140.00	14.93	S 89° 54' 30" E
67	0+990.00	0+1005.00	15.00	140.00	14.93	S 89° 54' 30" E
68	0+1005.00	0+1020.00	15.00	140.00	14.93	S 89° 54' 30" E
69	0+1020.00	0+1035.00	15.00	140.00	14.93	S 89° 54' 30" E
70	0+1035.00	0+1050.00	15.00	140.00	14.93	S 89° 54' 30" E
71	0+1050.00	0+1065.00	15.00	140.00	14.93	S 89° 54' 30" E
72	0+1065.00	0+1080.00	15.00	140.00	14.93	S 89° 54' 30" E
73	0+1080.00	0+1095.00	15.00	140.00	14.93	S 89° 54' 30" E
74	0+1095.00	0+1110.00	15.00	140.00	14.93	S 89° 54' 30" E
75	0+1110.00	0+1125.00	15.00	140.00	14.93	S 89° 54' 30" E
76	0+1125.00	0+1140.00	15.00	140.00	14.93	S 89° 54' 30" E
77	0+1140.00	0+1155.00	15.00	140.00	14.93	S 89° 54' 30" E
78	0+1155.00	0+1170.00	15.00	140.00	14.93	S 89° 54' 30" E
79	0+1170.00	0+1185.00	15.00	140.00	14.93	S 89° 54' 30" E
80	0+1185.00	0+1200.00	15.00	140.00	14.93	S 89° 54' 30" E
81	0+1200.00	0+1215.00	15.00	140.00	14.93	S 89° 54' 30" E
82	0+1215.00	0+1230.00	15.00	140.00	14.93	S 89° 54' 30" E
83	0+1230.00	0+1245.00	15.00	140.00	14.93	S 89° 54' 30" E
84	0+1245.00	0+1260.00	15.00	140.00	14.93	S 89° 54' 30" E
85	0+1260.00	0+1275.00	15.00	140.00	14.93	S 89° 54' 30" E
86	0+1275.00	0+1290.00	15.00	140.00	14.93	S 89° 54' 30" E
87	0+1290.00	0+1305.00	15.00	140.00	14.93	S 89° 54' 30" E
88	0+1305.00	0+1320.00	15.00	140.00	14.93	S 89° 54' 30" E
89	0+1320.00	0+1335.00	15.00	140.00	14.93	S 89° 54' 30" E
90	0+1335.00	0+1350.00	15.00	140.00	14.93	S 89° 54' 30" E
91	0+1350.00	0+1365.00	15.00	140.00	14.93	S 89° 54' 30" E
92	0+1365.00	0+1380.00	15.00	140.00	14.93	S 89° 54' 30" E
93	0+1380.00	0+1395.00	15.00	140.00	14.93	S 89° 54' 30" E
94	0+1395.00	0+1410.00	15.00	140.00	14.93	S 89° 54' 30" E
95	0+1410.00	0+1425.00	15.00	140.00	14.93	S 89° 54' 30" E
96	0+1425.00	0+1440.00	15.00	140.00	14.93	S 89° 54' 30" E
97	0+1440.00	0+1455.00	15.00	140.00	14.93	S 89° 54' 30" E
98	0+1455.00	0+1470.00	15.00	140.00	14.93	S 89° 54' 30" E
99	0+1470.00	0+1485.00	15.00	140.00	14.93	S 89° 54' 30" E
100	0+1485.00	0+1500.00	15.00	140.00	14.93	S 89° 54' 30" E

REMAINDER OF
QUENTIN CORPORATION
VOL. 12034, PG. 2083

LOT 6
BLOCK 'A'
TIMBERLINE
SECTION 2
DOC. NO. 199800135

LOT 4
TIMBERLINE
SECTION 2
DOC. NO. 199800135

LOT 7
REMAINDER OF
218.594 ACRES
QUENTIN CORPORATION
VOL. 12034, PG. 2083

BEARING BASIS:
THE EAST OF REMAINDER SHOWN HEREON IS THE
EAST LINE OF THAT 218.594 ACRE TRACT CONVEYED
TO QUENTIN CORPORATION BY DEED OF RECORD IN
VOLUME 1234, PAGE 2083 AND AS FOUND
HEREON LIES ON THE GROUND AT THE TIME OF THIS
SURVEY.

REMAINDER OF
218.594 ACRES
QUENTIN CORPORATION
VOL. 12034, PG. 2083

LOT 4
REMAINDER OF
DRAINAGE AND FILTRATION
POD EASEMENT
VOL. 12034, PG. 37

LOT 3
REMAINDER OF
DRAINAGE AND FILTRATION
POD EASEMENT
VOL. 12034, PG. 37

BLOCK 'A'
THE CROSSING AT
PARKER LANE
SECTION THREE
VOL. 102, PG. 279

PARMER SOUTH
SUBDIVISION
A THREE LOT SUBDIVISION
CONSISTING OF 122.330 ACRES
DATE: AUGUST 14, 2001
PREPARED BY:

Bury+Partners
Consulting Engineers and Surveyors
Austin, Texas Tel 512/220-0011 Fax 512/220-0023
Bury+Partners, Inc. Copyright 2002

CS006 12/14/02
Drawn by: MAF

C8-02-0007.0A

11657

PREVIOUS PLAT

PHOTOGRAPHIC RETRAK

