

ORDINANCE NO.

AN ORDINANCE AMENDING ORDINANCE NO. 20010927-05, WHICH ADOPTED THE MONTOPOLIS NEIGHBORHOOD PLAN AS AN ELEMENT OF THE AUSTIN TOMORROW COMPREHENSIVE PLAN, TO CHANGE THE LAND USE DESIGNATION ON THE FUTURE LAND USE MAP FOR PROPERTY LOCATED AT 6716 EAST RIVERSIDE DRIVE.

BE IT ORDAINED BY THE CITY COUNCIL OF THE CITY OF AUSTIN:

PART 1. Ordinance No. 20010927-05 adopted the Montopolis Neighborhood Plan as an element of the Austin Tomorrow Comprehensive Plan.

PART 2. Ordinance No. 20010927-05 is amended to change the land use designation from commercial use and multifamily use to higher density single family use for the property located at 6716 East Riverside Drive on the future land use map attached as Exhibit "A" and incorporated in this ordinance, and described in File NPA-2011-0005.01 at the Planning and Development Review Department.

PART 3. This ordinance takes effect on _____, 2011.

PASSED AND APPROVED

_____, 2011 § _____
 § _____
 § _____
 Lee Leffingwell
 Mayor

APPROVED: _____
 Karen M. Kennard
 City Attorney

ATTEST: _____
 Shirley A. Gentry
 City Clerk

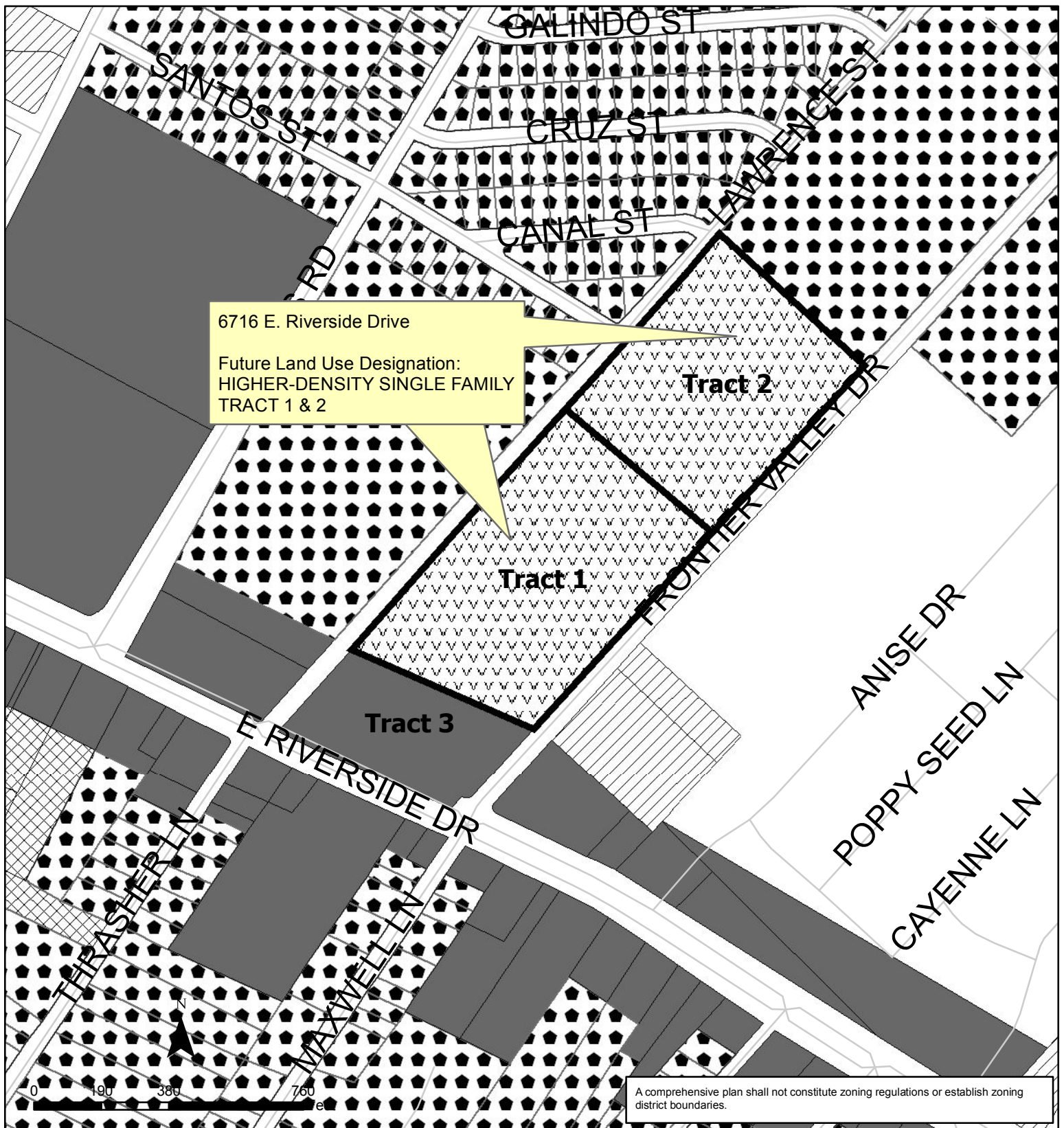

Exhibit A

Montopolis Neighborhood Plan Amendment NPA-2011-0005.01

This map has been produced by the City of Austin Planning & Development Review Department for the sole purpose of assisting in neighborhood planning decisions and is not warranted for any other use. No warranty is made by the City regarding its accuracy or completeness.



City of Austin
Planning and Development Review Department
Created on 05/02/2011, PF

Future Land Use

	Single-Family
	Higher-Density Single-Family
	Multi-Family
	Commercial
	Mixed Use
	Transportation