

C1
1

ZONING CHANGE REVIEW SHEET

CASE: C14-2010-0111 – 10301 Old San Antonio Road Rezone
Z.A.P. DATE: October 5, 2010
November 2, 2010
May 3, 2011
June 7, 2011
July 5, 2011

ADDRESS: 10301 Old San Antonio Road

OWNER: Sheldon Stablewood, LP
(Rick Sheldon)

AGENT: Thrower Design
(Ron Thrower)

ZONING FROM: MF-2-CO **TO:** MF-2-CO **AREA:** 18.198 acres
to change a condition of zoning

SUMMARY STAFF RECOMMENDATION:

The Staff's recommendation is to deny the Applicant's request to remove the Conditional Overlay that prohibits access to Old San Antonio Road.

ZONING & PLATTING COMMISSION RECOMMENDATION:

October 5, 2010: *APPROVED A POSTPONEMENT REQUEST BY THE STAFF TO NOVEMBER 2, 2010.*

[S. BALDRIDGE; T. RABAGO – 2ND] (7-0)

November 2, 2010: *APPROVED AN INDEFINITE POSTPONEMENT REQUEST BY THE APPLICANT.*

[G. BOURGEOIS; P. SEEGER - 2ND] (7-0)

May 3, 2011: *APPROVED A POSTPONEMENT REQUEST BY THE APPLICANT TO JUNE 7, 2011.*

[D. TIEMANN; P. SEEGER – 2ND] (6-0) 1 VACANCY ON THE COMMISSION

June 7, 2011: *APPROVED A POSTPONEMENT REQUEST BY THE APPLICANT TO JULY 5, 2011.*

[P. SEEGER; D. TIEMANN – 2ND] (6-0) 1 VACANCY ON THE COMMISSION

July 5, 2011:

ISSUES:

On April 19, 2011, the Applicant requested that the case be re-notified for Zoning and Platting Commission.

C1
1/2**DEPARTMENT COMMENTS:**

The subject tract is undeveloped and was zoned multi-family residence – low density – conditional overlay (MF-2-CO) district in August 2000. The Conditional Overlay limits development to 2,000 vehicle trips per day, states that there shall be no vehicular access to Old San Antonio Road, and that access must be taken from other adjacent public streets or adjacent property. Please refer to Exhibit B. The tract has frontage along Old San Antonio Road, a two-lane roadway, and directly east is a low water crossing. There are two single family residences, and the South Park Meadows shopping center to the north (GR-MU-CO; GR-CO; GR-MU-H-CO; CS-CO); undeveloped property to the east and southeast that is proposed for CS-MU zoning; and Akins High School, the football field, and two single family residences to the southwest and west (I-RR). The rezoning tract surrounds one single family residence (SF-2). Please refer to Exhibits A (Zoning Map) and A-1 (Aerial View).

The Applicant proposes to change the item in the conditional overlay which prohibits access to Old San Antonio Road. As background information, this tract was part of the Stablewood at Slaughter Creek Preliminary Plan that included the adjacent land to the east and south. Please refer to Exhibit C. A collector road extending between FM 1626 and the IH 35 southbound frontage road, known as Stablewood Drive bordered the tract's southeast property line. Therefore, at the time of the original zoning, the tract would have the ability to access the loop road as shown on the Preliminary Plan. The Preliminary Plan has since expired and therefore, the Stablewood property does not currently have any vehicular access. The zoning approved on an adjacent property, Double Creek Village – C14-2008-0220, included the dedication of right-of-way for the new loop road at the time the zoning was finalized by City Council, on November 18, 2010.

The Staff has concerns about multifamily residential development taking access to Old San Antonio Road which is a narrow, two-lane roadway and the nearby low water crossing which could create public safety issues in the event of an emergency, and therefore, recommends denial of the Applicant's request to remove the conditional overlay pertaining to vehicular access placed on the tract in 2000. The right-of-way is available to the subject property, and if the subject tract develops before Double Creek Village, then the owner could build a driveway from the property to the southbound IH 35 service road.

EXISTING ZONING AND LAND USES:

	ZONING	LAND USES
<i>Site</i>	MF-2-CO	Undeveloped
<i>North</i>	I-RR; GR-CO; GR-MU-H-CO; CS-CO	Two single family residences; Theater; Restaurant; Auto repair within the South Park Meadows shopping center
<i>South</i>	I-RR	Football field for Akins High School; Undeveloped (proposed for CS-MU zoning by C14-2008-0220)
<i>East</i>	I-RR	Undeveloped (proposed for CS-MU zoning by C14-2008-0220)
<i>West</i>	I-RR	Two single family residences; Akins High School

C1
3**AREA STUDY:** N/A**TIA:** Is not required**WATERSHED:** Slaughter Creek**DESIRED DEVELOPMENT ZONE:** Yes**CAPITOL VIEW CORRIDOR:** No**SCENIC ROADWAY:** No**NEIGHBORHOOD ORGANIZATIONS:**

26 – Far South Austin Community Association 627 – Onion Creek Homeowners Association
 742 – Austin Independent School District
 786 – Home Builders Association of Greater Austin
 1037 – Homeless Neighborhood Association 1075 – League of Bicycling Voters
 1113 – Austin Parks Foundation
 1200 – Super Duper Neighborhood Objectors and Appealers Organization
 1224 – Austin Monorail Project 1228 – Sierra Club, Austin Regional Group

SCHOOLS:

Menchaca Elementary School

Paredes Middle School

Akins High School

CASE HISTORIES:

NUMBER	REQUEST	COMMISSION	CITY COUNCIL
C14-2008-0220 – Double Creek Village – 10200- 10614 South IH 35 Service Road Southbound	I-RR; CS to CS- MU	Approved CS-MU-CO with the CO for list of prohibited uses, RC for conditions of the TIA, and Street Deed for r-o- w for the new loop road between FM 1826 and IH 35 is part of TIA approval and required to be dedicated at the time of zoning.	Approved CS-MU-CO with RC for conditions of the TIA and Street Deed for r-o-w for new loop road as ZAP recommended (11-18- 10).
C14-04-0160 – Harrell Tract #5 – 10184 – 10224 South IH-35 Service Road Southbound; 10101 – 10139 Old San Antonio Road	I-RR to CS-MU- CO	To Grant CS-MU-CO with CO prohibiting certain uses and limiting development to 2,000 daily trips	Approved CS-MU-CO as Commission recommended (12-2- 04).
C14-04-0126 – Harrell Tract #4 – 10100-10182 South	I-RR to CS-CO	To Grant CS-CO with CO for list of prohibited uses, RC for	Approved CS-CO as Commission recommended (12-2-

IH-35 Service Road Southbound; 10100 – 10128 Old San Antonio Road		the TIA and establish that the minimum size for a stand-alone restaurant is 300 square feet	04).
C14-04-0125 – Harrell Tract #3 – 10000-10450 South First Street	I-RR to MF-2-CO	To Grant MF-2-CO with the CO for 17 u.p.a. and a RC for the TIA	Approved MF-2-CO with RC as recommended by ZAP (12-2-04).
C14-04-0124 – Harrell Tract #1 -	I-RR to GR-MU-CO for Tract 1A and CS-CO for Tract 1B	To Grant GR-MU-CO for Tract 1A and CS-CO for Tract 1B with the CO for a list of prohibited uses with RC for the TIA and establish that the minimum size for a stand-alone restaurant is 300 square feet	Approved GR-MU-CO for Tract 1A and CS-CO for Tract 1B with RC for the TIA and establish that the minimum size for a stand-alone restaurant is 300 square feet as recommended by ZAP (12-2-04).
C14-02-0052 – Wedding Facility, Catering and Restaurant – 10300 Old San Antonio Road	I-RR to GR-MU-CO	To Grant GR-MU-CO with CO limiting development of the property to bed and breakfast residential, indoor and outdoor entertainment and restaurants, 200 trips per day, height of 35 feet and 50% building coverage. RC specifying types of events and reservation of r-o-w on Old San Antonio Road	Approved GR-MU-CO with RC as Commission recommended (8-22-07).
C14H-01-0104 – Wedding/Catering Facility (Matthew Brown Homestead) – 10140 Old San Antonio Road	I-RR to GR-MU-CO-H for Tract 1; GR-MU-CO for Tract 2	To Grant GR-MU-CO-H for Tract 1; GR-MU-CO for Tract 2, with CO for 35' height, 1,000 trips per day, 50% building coverage, 60% impervious cover, uses limited to bed and breakfast. RC to define the types of gatherings that would occur; r-o-w on Old San Antonio	Approved GR-MU-H-CO for Tract 1; GR-MU-CO for Tract 2, with CO and RC as Commission recommended, with additional permitted uses of indoor and outdoor entertainment, and restaurants except t(11/29/01).

CL/5

		Road	
C14-00-2031 – Stablewood Apartments – Old San Antonio Road	I-RR to MF-2	To Grant MF-2-CO w/CO prohibiting access to Old San Antonio Road, 15' wide vegetative buffer adjoining SF-2 zoned property, and 2,000 trips per day	Approved MF-2-CO as PC recommended (8-17-00).

RELATED CASES:

The subject property was annexed into the City limits on December 31, 1997 and assigned I-RR district zoning. On August 17, 2000, the property was zoned MF-2-CO with the Conditional Overlay prohibiting vehicular access to Old San Antonio Road (and requiring that access shall be from adjacent public streets or through adjacent property), establishing a 15-foot wide vegetative buffer where adjacent to SF-2 zoning, and limiting trips to 2,000 vehicles per day (C14-00-2031).

As shown in Exhibit C, the subject property as well as adjacent surrounding properties were originally part of a 397.46 acre preliminary plan known as the Stablewood at Slaughter Creek Preliminary Plan Revision #1, approved on August 31, 1999 (C8-95-0211.02). The plan included a mix of retail, office/commercial, single family residences, recreation center and open space uses. The portion covering this property provided for 80 single family – standard lot residential lots. The Preliminary Plan included a loop road known as Stablewood Drive extending between the IH-35 frontage road and FM 1826 (in a similar configuration to that proposed with the subject application). This eastern portion of the Stablewood Preliminary Plan did not proceed to the final plat stage, and has expired.

There are no site plan applications on the property.

ABUTTING STREETS:

Name	ROW	Pavement	Classification	Sidewalks	Bike Route	Capital Metro
Old San Antonio Road	56 feet	21.5 feet	Local	No	No	No

CITY COUNCIL DATE: November 4, 2010

ACTION: Approved a Postponement request by Staff to November 18, 2010 (7-0)

November 18, 2010

Approved an Indefinite Postponement request by the Applicant (7-0).

9/6

ORDINANCE READINGS: 1st

2nd

3rd

ORDINANCE NUMBER:

CASE MANAGER: Wendy Rhoades
e-mail: wendy.rhoades@ci.austin.tx.us

PHONE: 974-7719

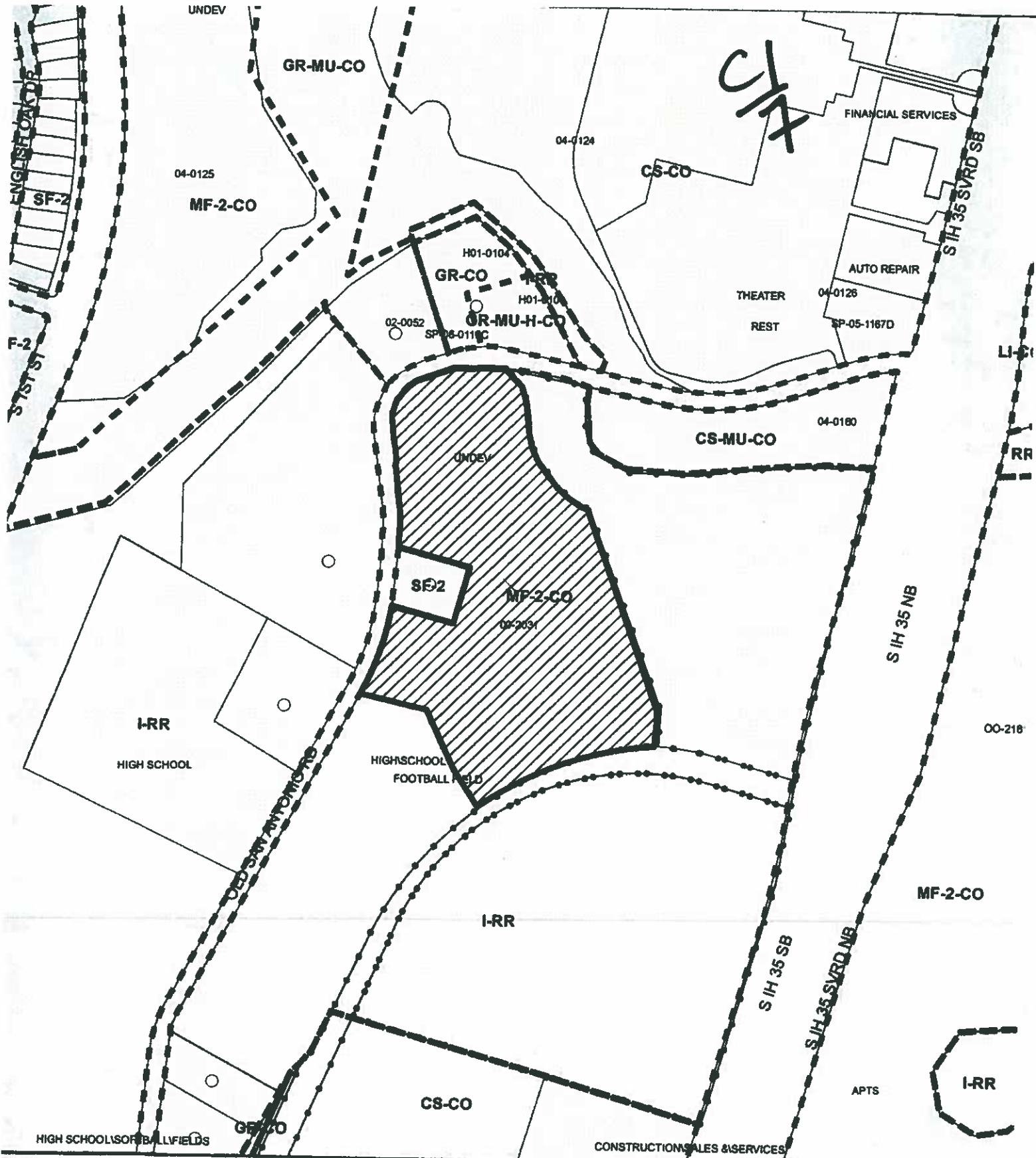

- ZONING**
- SUBJECT TRACT
 - PENDING CASE
 - ZONING BOUNDARY

= 400'

ZONING CASE#: C14-2010-0111
 LOCATION: 10301 OLD SAN ANTONIO RD
 SUBJECT AREA: 18.198 ACRES
 GRID: F 12
 MANAGER: WENDY RHOADES

Exhibit A



This map has been produced by the Communications Technology Management Dept. on behalf of the Planning Development Review Dept for the sole purpose of geographic reference. No warranty is made by



CL
9

ORDINANCE NO. 000817-77

AN ORDINANCE ESTABLISHING INITIAL PERMANENT ZONING AND CHANGING THE ZONING MAP ACCOMPANYING CHAPTER 25-2 OF THE CITY CODE AS FOLLOWS:

AN 18.198 ACRE TRACT OF LAND OUT OF THE STEPHEN F. SLAUGHTER LEAGUE SURVEY NO. 1 AND SANTIAGO DEL VALLE GRANT, FROM INTERIM RURAL RESIDENCE (I-RR) DISTRICT TO MULTI-FAMILY RESIDENCE LOW DENSITY-CONDITIONAL OVERLAY (MF-2-CO) COMBINING DISTRICT, LOCALLY KNOWN AS THE PROPERTY LOCATED ALONG OLD SAN ANTONIO ROAD, IN THE CITY OF AUSTIN, TRAVIS COUNTY, TEXAS.

BE IT ORDAINED BY THE CITY COUNCIL OF THE CITY OF AUSTIN:

PART 1. The zoning map established by Section 25-2-191 of the City Code is amended to change the base district from interim rural residence (I-RR) district to multi-family residence low density-conditional overlay (MF-2-CO) combining district on the property described in File C14-00-2031, as follows:

An 18.198 acre tract of land out of the Stephen F. Slaughter League Survey No. 1 and Santiago del Valle Grant, the tract of land being more particularly described by metes and bounds in Exhibit "A" incorporated into this ordinance, (the "Property")

locally known as the property located along Old San Antonio Road, in the City of Austin, Travis County, Texas, and as more particularly identified in the map attached as Exhibit "B".

PART 2. The Property within the boundaries of the conditional overlay combining district established by this ordinance is subject to the following conditions:

1. There shall be no vehicular access from the Property to Old San Antonio Road. All vehicular access to the Property shall be from other adjacent public streets or through other adjacent property.
2. A site plan or building permit for the Property may not be approved, released, or issued, if the completed development or uses of the Property, considered cumulatively with all existing or previously authorized development and uses, generate traffic that exceeds 2,000 trips per day.

CJ
10

3. A 15-foot wide vegetative buffer shall be provided along the property lines that border the adjacent single family residence district. Improvements permitted on the vegetative buffer zone shall be limited to drainage, underground utility improvements or those improvements that may be otherwise required by the City of Austin or specifically authorized in this ordinance.

Except as specifically restricted under this ordinance, the Property may be developed and used in accordance with the regulations established for the multi-family residence low density (MF-2) base district and other applicable requirements of the City Code.

PART 3. The Council waives the requirements of Section 2-2-3, 2-2-5, and 2-2-7 of the City Code for this ordinance.

PART 4. This ordinance takes effect on August 28, 2000.

PASSED AND APPROVED

August 17, 2000

§
§
§

Kirk Watson

Kirk Watson
Mayor

APPROVED:

Andrew Martin

Andrew Martin
City Attorney

ATTEST:

Shirley A. Brown

Shirley A. Brown
City Clerk

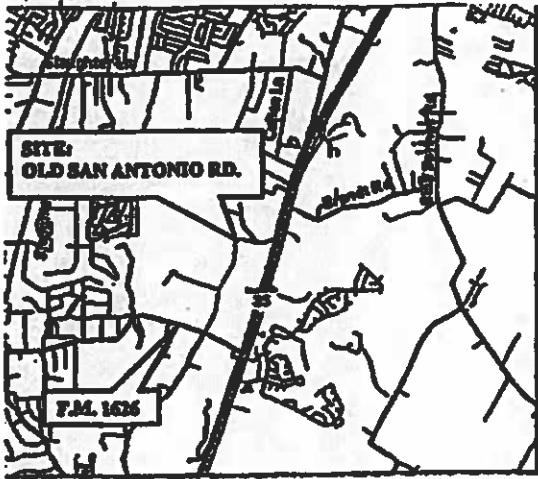

Alle
3

C11

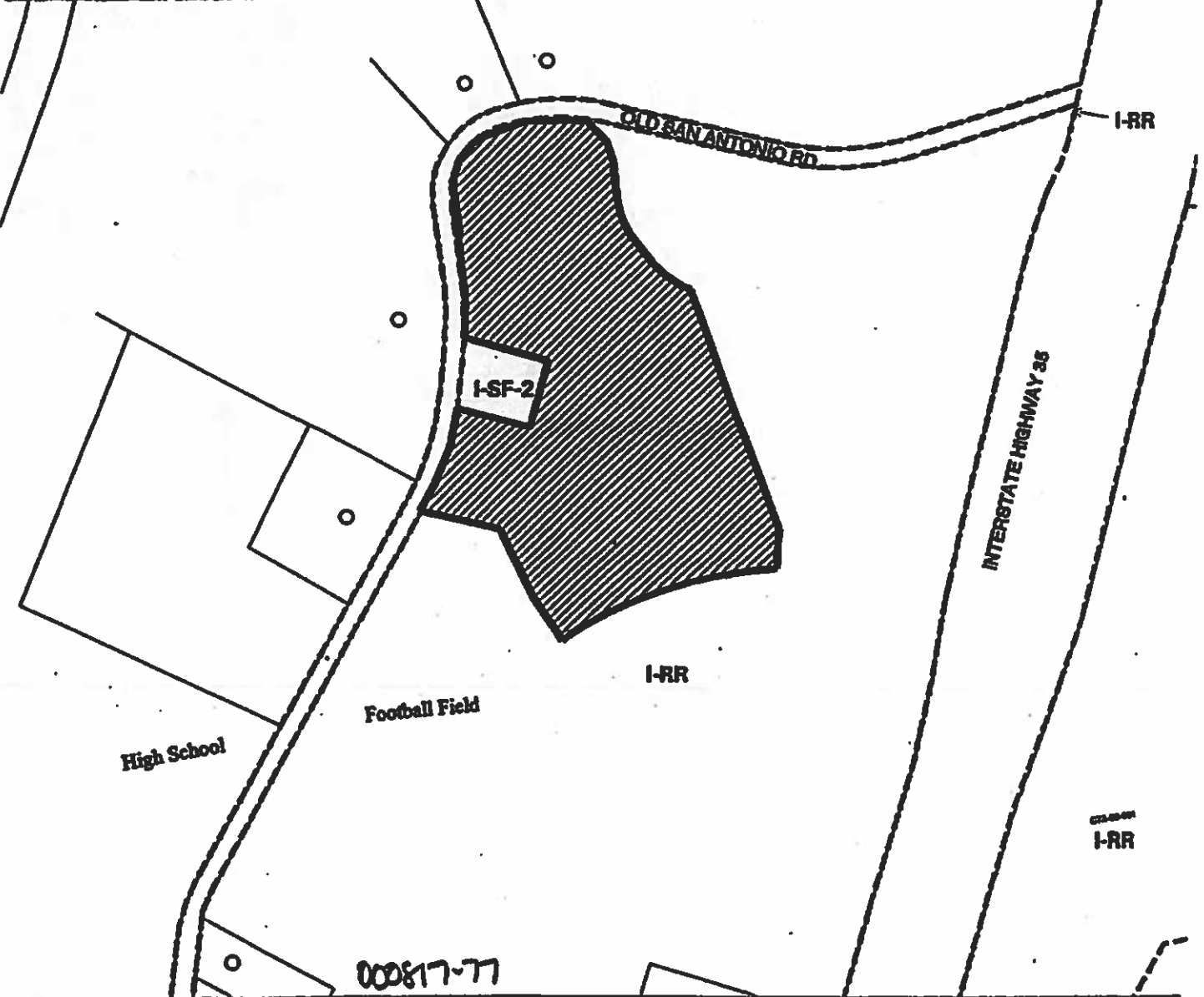

	SUBJECT TRACT		ZONING <i>EXHIBIT B</i>		CITY GRID REFERENCE NUMBER F12
	PENDING CASE			
	ZONING BOUNDARY	-----	CASE #: C14-00-2031	DATE: 00-02	
	CASE MGR: JARRIAGA		ADDRESS: OLD SAN ANTONIO RD.		

[illegible][illegible]

1880
 1881
 1882
 1883
 1884
 1885
 1886
 1887
 1888
 1889
 1890
 1891
 1892
 1893
 1894
 1895
 1896
 1897
 1898
 1899
 1900
 1901
 1902
 1903
 1904
 1905
 1906
 1907
 1908
 1909
 1910
 1911
 1912
 1913
 1914
 1915
 1916
 1917
 1918
 1919
 1920
 1921
 1922
 1923
 1924
 1925
 1926
 1927
 1928
 1929
 1930
 1931
 1932
 1933
 1934
 1935
 1936
 1937
 1938
 1939
 1940
 1941
 1942
 1943
 1944
 1945
 1946
 1947
 1948
 1949
 1950
 1951
 1952
 1953
 1954
 1955
 1956
 1957
 1958
 1959
 1960
 1961
 1962
 1963
 1964
 1965
 1966
 1967
 1968
 1969
 1970
 1971
 1972
 1973
 1974
 1975
 1976
 1977
 1978
 1979
 1980
 1981
 1982
 1983
 1984
 1985
 1986
 1987
 1988
 1989
 1990
 1991
 1992
 1993
 1994
 1995
 1996
 1997
 1998
 1999
 2000
 2001
 2002
 2003
 2004
 2005
 2006
 2007
 2008
 2009
 2010
 2011
 2012
 2013
 2014
 2015
 2016
 2017
 2018
 2019
 2020
 2021
 2022
 2023
 2024
 2025
 2026
 2027
 2028
 2029
 2030
 2031
 2032
 2033
 2034
 2035
 2036
 2037
 2038
 2039
 2040
 2041
 2042
 2043
 2044
 2045
 2046
 2047
 2048
 2049
 2050
 2051
 2052
 2053
 2054
 2055
 2056
 2057
 2058
 2059
 2060
 2061
 2062
 2063
 2064
 2065
 2066
 2067
 2068
 2069
 2070
 2071
 2072
 2073
 2074
 2075
 2076
 2077
 2078
 2079
 2080
 2081
 2082
 2083
 2084
 2085
 2086
 2087
 2088
 2089
 2090
 2091
 2092
 2093
 2094
 2095
 2096
 2097
 2098
 2099
 2100
 2101
 2102
 2103
 2104
 2105
 2106
 2107
 2108
 2109
 2110
 2111
 2112
 2113
 2114
 2115
 2116
 2117
 2118
 2119
 2120
 2121
 2122
 2123
 2124
 2125
 2126
 2127
 2128
 2129
 2130
 2131
 2132
 2133
 2134
 2135
 2136
 2137
 2138
 2139
 2140
 2141
 2142
 2143
 2144
 2145
 2146
 2147
 2148
 2149
 2150
 2151
 2152
 2153
 2154
 2155
 2156
 2157
 2158
 2159
 2160
 2161
 2162
 2163
 2164
 2165
 2166
 2167
 2168
 2169
 2170
 2171
 2172
 2173
 2174
 2175
 2176
 2177
 2178
 2179
 2180
 2181
 2182
 2183
 2184
 2185
 2186
 2187
 2188
 2189
 2190
 2191
 2192
 2193
 2194
 2195
 2196
 2197
 2198
 2199
 2200
 2201
 2202
 2203
 2204
 2205
 2206
 2207
 2208
 2209
 2210
 2211
 2212
 2213
 2214
 2215
 2216
 2217
 2218
 2219
 2220
 2221
 2222
 2223
 2224
 2225
 2226
 2227
 2228
 2229
 2230
 2231
 2232
 2233
 2234
 2235
 2236
 2237
 2238
 2239
 2240
 2241
 2242
 2243
 2244
 2245
 2246
 2247
 2248
 2249
 2250
 2251
 2252
 2253
 2254
 2255
 2256
 2257
 2258
 2259
 2260
 2261
 2262
 2263
 2264
 2265
 2266
 2267
 2268
 2269
 2270
 2271
 2272
 2273
 2274
 2275
 2276
 2277
 2278
 2279
 2280
 2281
 2282
 2283
 2284
 2285
 2286
 2287
 2288
 2289
 2290
 2291
 2292
 2293
 2294
 2295
 2296
 2297
 2298
 2299
 2300
 2301
 2302
 2303
 2304
 2305
 2306
 2307
 2308
 2309
 2310
 2311
 2312
 2313
 2314
 2315
 2316
 2317
 2318
 2319
 2320
 2321
 2322
 2323
 2324
 2325
 2326
 2327
 2328
 2329
 2330
 2331
 2332
 2333
 2334

STABLEWOOD
AT SLAUGHTER CREEK
PRELIMINARY PLAN
C8-95-0211.02

REVISION NO. 1

LAND USE SUMMARY

SINGLE FAMILY	162.28 AC.
TRAILHEAD LOTS	(24 L.L.)
TRAIL LOTS	130.58 AC.
COMMERCIAL	
OPEN SPACE	1.00 AC.
BOULEVARD	9657 AC.
REC. CENTER	2.70 AC.
GREENBELT/	54.31 AC.
W.Q.P./P.U.L.	
TOTAL ACREAGE -	99,146 AC.
TOTAL NO. OF UNITS	946 d.u.

[illegible]

PERSONS	STAY AC.	SINGLE FAMILY	AC. IN AC.
W.P. PUE	36 OF B.C.	ROADS	7 1/2 AC.
CRIMMELL/	OF AC.		
TOTAL	204 1/2 AC.	TOTAL =	17 1/2 AC.

RESEARCH AND ANALYSIS

1	2	3	4	5	6	7	8	9	10	11	12	13	14	15	16	17	18	19	20	21	22	23	24	25	26	27	28	29	30	31	32	33	34	35	36	37	38	39	40	41	42	43	44	45	46	47	48	49	50	51	52	53	54	55	56	57	58	59	60	61	62	63	64	65	66	67	68	69	70	71	72	73	74	75	76	77	78	79	80	81	82	83	84	85	86	87	88	89	90	91	92	93	94	95	96	97	98	99	100	101	102	103	104	105	106	107	108	109	110	111	112	113	114	115	116	117	118	119	120	121	122	123	124	125	126	127	128	129	130	131	132	133	134	135	136	137	138	139	140	141	142	143	144	145	146	147	148	149	150	151	152	153	154	155	156	157	158	159	160	161	162	163	164	165	166	167	168	169	170	171	172	173	174	175	176	177	178	179	180	181	182	183	184	185	186	187	188	189	190	191	192	193	194	195	196	197	198	199	200	201	202	203	204	205	206	207	208	209	210	211	212	213	214	215	216	217	218	219	220	221	222	223	224	225	226	227	228	229	230	231	232	233	234	235	236	237	238	239	240	241	242	243	244	245	246	247	248	249	250	251	252	253	254	255	256	257	258	259	260	261	262	263	264	265	266	267	268	269	270	271	272	273	274	275	276	277	278	279	280	281	282	283	284	285	286	287	288	289	290	291	292	293	294	295	296	297	298	299	300	301	302	303	304	305	306	307	308	309	310	311	312	313	314	315	316	317	318	319	320	321	322	323	324	325	326	327	328	329	330	331	332	333	334	335	336	337	338	339	340	341	342	343	344	345	346	347	348	349	350	351	352	353	354	355	356	357	358	359	360	361	362	363	364	365	366	367	368	369	370	371	372	373	374	375	376	377	378	379	380	381	382	383	384	385	386	387	388	389	390	391	392	393	394	395	396	397	398	399	400	401	402	403	404	405	406	407	408	409	410	411	412	413	414	415	416	417	418	419	420	421	422	423	424	425	426	427	428	429	430	431	432	433	434	435	436	437	438	439	440	441	442	443	444	445	446	447	448	449	450	451	452	453	454	455	456	457	458	459	460	461	462	463	464	465	466	467	468	469	470	471	472	473	474	475	476	477	478	479	480	481	482	483	484	485	486	487	488	489	490	491	492	493	494	495	496	497	498	499	500	501	502	503	504	505	506	507	508	509	510	511	512	513	514	515	516	517	518	519	520	521	522	523	524	525	526	527	528	529	530	531	532	533	534	535	536	537	538	539	540	541	542	543	544	545	546	547	548	549	550	551	552	553	554	555	556	557	558	559	560	561	562	563	564	565	566	567	568	569	570	571	572	573	574	575	576	577	578	579	580	581	582	583	584	585	586	587	588	589	590	591	592	593	594	595	596	597	598	599	600	601	602	603	604	605	606	607	608	609	610	611	612	613	614	615	616	617	618	619	620	621	622	623	624	625	626	627	628	629	630	631	632	633	634	635	636	637	638	639	640	641	642	643	644	645	646	647	648	649	650	651	652	653	654	655	656	657	658	659	660	661	662	663	664	665	666	667	668	669	670	671	672	673	674	675	676	677	678	679	680	681	682	683	684	685	686	687	688	689	690	691	692	693	694	695	696	697	698	699	700	701	702	703	704	705	706	707	708	709	710	711	712	713	714	715	716	717	718	719	720	721	722	723	724	725	726	727	728	729	730	731	732	733	734	735	736	737	738	739	740	741	742	743	744	745	746	747	748	749	750	751	752	753	754	755	756	757	758	759	760	761	762	763	764	765	766	767	768	769	770	771	772	773	774	775	776	777	778	779	780	781	782	783	784	785	786	787	788	789	790	791	792	793	794	795	796	797	798	799	800	801	802	803	804	805	806	807	808	809	810	811	812	813	814	815	816	817	818	819	820	821	822	823	824	825	826	827	828	829	830	831	832	833	834	835	836	837	838	839	840	841	842	843	844	845	846	847	848	849	850	851	852	853	854	855	856	857	858	859	860	861	862	863	864	865	866	867	868	869	870	871	872	873	874	875	876	877	878	879	880	881	882	883	884	885	886	887	888	889	890	891	892	893	894	895	896	897	898	899	900	901	902	903	904	905	906	907	908	909	910	911	912	913	914	915	916	917	918	919	920	921	922	923	924	925	926	927	928	929	930	931	932	933	934	935	936	937	938	939	940	941	942	943	944	945	946	947	948	949	950	951	952	953	954	955	956	957	958	959	960	961	962	963	964	965	966	967	968	969	970	971	972	973	974	975	976	977	978	979	980	981	982	983	984	985	986	987	988	989	990	991	992	993	994	995	996	997	998	999	1000
---	---	---	---	---	---	---	---	---	----	----	----	----	----	----	----	----	----	----	----	----	----	----	----	----	----	----	----	----	----	----	----	----	----	----	----	----	----	----	----	----	----	----	----	----	----	----	----	----	----	----	----	----	----	----	----	----	----	----	----	----	----	----	----	----	----	----	----	----	----	----	----	----	----	----	----	----	----	----	----	----	----	----	----	----	----	----	----	----	----	----	----	----	----	----	----	----	----	----	-----	-----	-----	-----	-----	-----	-----	-----	-----	-----	-----	-----	-----	-----	-----	-----	-----	-----	-----	-----	-----	-----	-----	-----	-----	-----	-----	-----	-----	-----	-----	-----	-----	-----	-----	-----	-----	-----	-----	-----	-----	-----	-----	-----	-----	-----	-----	-----	-----	-----	-----	-----	-----	-----	-----	-----	-----	-----	-----	-----	-----	-----	-----	-----	-----	-----	-----	-----	-----	-----	-----	-----	-----	-----	-----	-----	-----	-----	-----	-----	-----	-----	-----	-----	-----	-----	-----	-----	-----	-----	-----	-----	-----	-----	-----	-----	-----	-----	-----	-----	-----	-----	-----	-----	-----	-----	-----	-----	-----	-----	-----	-----	-----	-----	-----	-----	-----	-----	-----	-----	-----	-----	-----	-----	-----	-----	-----	-----	-----	-----	-----	-----	-----	-----	-----	-----	-----	-----	-----	-----	-----	-----	-----	-----	-----	-----	-----	-----	-----	-----	-----	-----	-----	-----	-----	-----	-----	-----	-----	-----	-----	-----	-----	-----	-----	-----	-----	-----	-----	-----	-----	-----	-----	-----	-----	-----	-----	-----	-----	-----	-----	-----	-----	-----	-----	-----	-----	-----	-----	-----	-----	-----	-----	-----	-----	-----	-----	-----	-----	-----	-----	-----	-----	-----	-----	-----	-----	-----	-----	-----	-----	-----	-----	-----	-----	-----	-----	-----	-----	-----	-----	-----	-----	-----	-----	-----	-----	-----	-----	-----	-----	-----	-----	-----	-----	-----	-----	-----	-----	-----	-----	-----	-----	-----	-----	-----	-----	-----	-----	-----	-----	-----	-----	-----	-----	-----	-----	-----	-----	-----	-----	-----	-----	-----	-----	-----	-----	-----	-----	-----	-----	-----	-----	-----	-----	-----	-----	-----	-----	-----	-----	-----	-----	-----	-----	-----	-----	-----	-----	-----	-----	-----	-----	-----	-----	-----	-----	-----	-----	-----	-----	-----	-----	-----	-----	-----	-----	-----	-----	-----	-----	-----	-----	-----	-----	-----	-----	-----	-----	-----	-----	-----	-----	-----	-----	-----	-----	-----	-----	-----	-----	-----	-----	-----	-----	-----	-----	-----	-----	-----	-----	-----	-----	-----	-----	-----	-----	-----	-----	-----	-----	-----	-----	-----	-----	-----	-----	-----	-----	-----	-----	-----	-----	-----	-----	-----	-----	-----	-----	-----	-----	-----	-----	-----	-----	-----	-----	-----	-----	-----	-----	-----	-----	-----	-----	-----	-----	-----	-----	-----	-----	-----	-----	-----	-----	-----	-----	-----	-----	-----	-----	-----	-----	-----	-----	-----	-----	-----	-----	-----	-----	-----	-----	-----	-----	-----	-----	-----	-----	-----	-----	-----	-----	-----	-----	-----	-----	-----	-----	-----	-----	-----	-----	-----	-----	-----	-----	-----	-----	-----	-----	-----	-----	-----	-----	-----	-----	-----	-----	-----	-----	-----	-----	-----	-----	-----	-----	-----	-----	-----	-----	-----	-----	-----	-----	-----	-----	-----	-----	-----	-----	-----	-----	-----	-----	-----	-----	-----	-----	-----	-----	-----	-----	-----	-----	-----	-----	-----	-----	-----	-----	-----	-----	-----	-----	-----	-----	-----	-----	-----	-----	-----	-----	-----	-----	-----	-----	-----	-----	-----	-----	-----	-----	-----	-----	-----	-----	-----	-----	-----	-----	-----	-----	-----	-----	-----	-----	-----	-----	-----	-----	-----	-----	-----	-----	-----	-----	-----	-----	-----	-----	-----	-----	-----	-----	-----	-----	-----	-----	-----	-----	-----	-----	-----	-----	-----	-----	-----	-----	-----	-----	-----	-----	-----	-----	-----	-----	-----	-----	-----	-----	-----	-----	-----	-----	-----	-----	-----	-----	-----	-----	-----	-----	-----	-----	-----	-----	-----	-----	-----	-----	-----	-----	-----	-----	-----	-----	-----	-----	-----	-----	-----	-----	-----	-----	-----	-----	-----	-----	-----	-----	-----	-----	-----	-----	-----	-----	-----	-----	-----	-----	-----	-----	-----	-----	-----	-----	-----	-----	-----	-----	-----	-----	-----	-----	-----	-----	-----	-----	-----	-----	-----	-----	-----	-----	-----	-----	-----	-----	-----	-----	-----	-----	-----	-----	-----	-----	-----	-----	-----	-----	-----	-----	-----	-----	-----	-----	-----	-----	-----	-----	-----	-----	-----	-----	-----	-----	-----	-----	-----	-----	-----	-----	-----	-----	-----	-----	-----	-----	-----	-----	-----	-----	-----	-----	-----	-----	-----	-----	-----	-----	-----	-----	-----	-----	-----	-----	-----	-----	-----	-----	-----	-----	-----	-----	-----	-----	-----	-----	-----	-----	-----	-----	-----	-----	-----	-----	-----	-----	-----	-----	-----	-----	-----	-----	-----	-----	-----	-----	-----	-----	-----	-----	-----	-----	-----	-----	-----	-----	-----	-----	-----	-----	-----	-----	-----	-----	-----	-----	-----	-----	-----	-----	-----	-----	-----	-----	-----	-----	-----	-----	-----	-----	-----	-----	-----	-----	-----	-----	-----	-----	-----	-----	-----	-----	-----	-----	-----	-----	-----	-----	-----	-----	-----	-----	-----	-----	-----	-----	-----	-----	-----	-----	-----	-----	-----	-----	-----	-----	-----	-----	-----	-----	-----	-----	-----	-----	-----	-----	-----	-----	-----	-----	-----	-----	-----	-----	-----	-----	-----	-----	-----	-----	-----	-----	-----	-----	-----	-----	-----	-----	-----	-----	-----	-----	-----	-----	-----	-----	-----	-----	-----	-----	-----	-----	-----	-----	-----	-----	-----	-----	-----	-----	-----	-----	-----	-----	-----	-----	-----	-----	-----	-----	-----	-----	-----	-----	-----	-----	-----	-----	-----	-----	-----	-----	-----	-----	-----	-----	-----	-----	-----	-----	-----	-----	-----	-----	-----	-----	-----	------



6-28-79
Piscataway
NJ

$$\frac{C1}{12}$$

REZONING
AREA

CL 13

SCA 6:1" = 200'

C8-95-211

MINA/3

REVISED AREA

DEPARTMENT OF THE ARMY

1990

重刊

LEGEND

[illegible]

Abstract

1991

06
07
08

1997-1998

Abstract

Existence

SUMMARY STAFF RECOMMENDATION:

The Staff's recommendation is to deny the Applicant's request to remove the Conditional Overlay that prohibits access to Old San Antonio Road.

BASIS FOR LAND USE RECOMMENDATION (ZONING PRINCIPLES)

1. *The proposed zoning should be consistent with the purpose statement of the district sought.*

The multi-family residence low density (MF-2) district is intended to accommodate multifamily use with a maximum density of 23 units per acre, depending on unit size. This district is appropriate for multifamily residential areas located near single family neighborhoods or in an area for which low density multifamily use is desired.

2. *Zoning changes should promote compatibility with adjacent and nearby uses.*

The Staff has concerns about multifamily residential development taking access to Old San Antonio Road which is a narrow, two-lane roadway and the nearby low water crossing which could create public safety issues in the event of an emergency, and therefore, recommends denial of the Applicant's request to remove the conditional overlay pertaining to vehicular access placed on the tract in 2000. The right-of-way will become available to the subject property, and if the subject tract develops before Double Creek Village, then the owner could build a driveway from the property to the southbound IH 35 service road.

EXISTING CONDITIONS**Site Characteristics**

The site is undeveloped, significantly treed and slopes gently towards Slaughter Creek, to the north. Based on information shown on the expired Preliminary Plan, the 100-year flood plain generally forms the northwest property line along Old San Antonio Road.

Impervious Cover

Within the Slaughter Creek watershed, the maximum impervious cover allowed by the MF-2 zoning district would be 60%, which is based on the more restrictive watershed regulations.

Environmental

The site is not located over the Edwards Aquifer Recharge Zone. The site is in the Desired Development Zone. The site is in the Slaughter Creek Watershed of the Colorado River Basin, which is classified as a Suburban Watershed by Chapter 25-8 of the City's Land Development Code. Under current watershed regulations, development or redevelopment on this site will be subject to the following impervious cover limits:

<i>Development Classification</i>	<i>% of Net Site Area</i>	<i>% with Transfers</i>
Single-Family (minimum lot size 5750 sq. ft.)	50%	60%
Other Single-Family or Duplex	55%	60%
Multifamily	60%	70%
Commercial	80%	90%

According to flood plain maps, there is a floodplain within the project boundary. Based upon the close proximity of flood plain, offsite drainage should be calculated to determine the exact location of the boundaries. No development is permitted in the Critical Water Quality Zone, while impervious cover is limited to 30% in the Water Quality Transition Zone.

Standard landscaping and tree protection will be required in accordance with LDC 25-2 and 25-8 for all development and/or redevelopment.

Numerous trees will likely be impacted with a proposed development associated with this rezoning case. Please be aware that an approved rezoning status does not eliminate a proposed development's requirements to meet the intent of the tree ordinances. If further explanation or specificity is needed, please contact the City Arborist at 974-1876. At this time, site specific information is unavailable regarding other vegetation, areas of steep slope, or other environmental features such as bluffs, springs, canyon rimrock, caves, sinkholes, and wetlands.

Under current watershed regulations, development or redevelopment on this site will be subject to the following water quality control requirements:

- Structural controls: Sedimentation and filtration basins with increased capture volume and 2 year detention.

At this time, no information has been provided as to whether this property has any pre-existing approvals that preempt current water quality or Code requirements.

Transportation

This property has been previously zoned MF-2 with the zoning case #C14-00-2031. The property was subject to the following condition, "There shall be no vehicular access from the Property to Old San Antonio Road. All vehicular access to the Property shall be from adjacent public streets or through adjacent property." Staff had recommended prohibiting access to site from Old San Antonio Road due to its sub-standard condition and flooding hazard.

Staff recommends that the applicant work with the adjacent property owners to the east of this property to take access from future "Stablewood Drive".

A traffic impact analysis was waived for this case because the applicant agreed to limit the intensity and uses for this development. If the zoning is granted, development should be

C14
16

limited through a conditional overlay to less than 2,000 vehicle trips per day. [LDC, 25-6-117]

Water and Wastewater

The landowner intends to serve the site with City of Austin water and wastewater utilities. The landowner, at his own expense, will be responsible for providing any water and wastewater utility improvements, offsite main extensions, utility relocations and or abandonments required by the land use. The water and wastewater utility plan must be reviewed and approved by the Austin Water Utility for compliance with City criteria. All water and wastewater construction must be inspected by the City of Austin. The landowner must pay the City inspection fee with the utility construction. The landowner must pay the tap and impact fee once the landowner makes an application for a City of Austin water and wastewater utility tap permit.

Site Plan and Compatibility Standards

The site is subject to compatibility standards. Along the west and east property line, the following standards apply:

- No structure may be built within 25 feet of the property line.
- No structure in excess of two stories or 30 feet in height may be constructed within 50 feet of the property line.
- No structure in excess of three stories or 40 feet in height may be constructed within 100 feet of the property line.
- No parking or driveways are allowed within 25 feet of the property line.
- In addition, a fence, berm, or dense vegetation must be provided to screen adjoining properties from views of parking, mechanical equipment, storage, and refuse collection.

Additional design regulations will be enforced at the time a site plan is submitted.

Any new development is subject to Subchapter E. Design Standards and Mixed Use.

Additional comments will be made when the site plan is submitted.

PUBLIC HEARING INFORMATION

This zoning/rezoning request will be reviewed and acted upon at two public hearings: before the Land Use Commission and the City Council. Although applicants and/or their agent(s) are expected to attend a public hearing, you are not required to attend. However, if you do attend, you have the opportunity to speak FOR or AGAINST the proposed development or change. You may also contact a neighborhood or environmental organization that has expressed an interest in an application affecting your neighborhood.

During its public hearing, the board or commission may postpone or continue an application's hearing to a later date, or may evaluate the City staff's recommendation and public input forwarding its own recommendation to the City Council. If the board or commission announces a specific date and time for a postponement or continuation that is not later than 60 days from the announcement, no further notice is required.

During its public hearing, the City Council may grant or deny a zoning request, or rezone the land to a less intensive zoning than requested but in no case will it grant a more intensive zoning.

However, in order to allow for mixed use development, the Council may add the MIXED USE (MU) COMBINING DISTRICT to certain commercial districts. The MU Combining District simply allows residential uses in addition to those uses already allowed in the seven commercial zoning districts. As a result, the MU Combining District allows the combination of office, retail, commercial, and residential uses within a single development.

For additional information on the City of Austin's land development process, visit our website:

www.ci.austin.tx.us/development

Written comments must be submitted to the board or commission (or the contact person listed on the notice) before or at a public hearing. Your comments should include the board or commission's name, the scheduled date of the public hearing, and the Case Number and the contact person listed on the notice.

Case Number: C14-2010-0111

Contact: Wendy Rhoades, 512-974-7719

Public Hearing: Oct. 5, 2010, Zoning & Platting Commission

Nov. 4, 2010, City Council

Bick Sheldon, Managing Partner
Your Name (please print) *of Sheldon Stubbards & Associates*

☒ I am in favor
☐ I object

We are the Applicant

Your address(es) affected by this application *10301 Old San Antonio Rd.*

9-30-10

Date

Signature

Daytime Telephone: *210-490-2500*

Comments:

If you use this form to comment, it may be returned to:

City of Austin

Planning & Development Review Department

Wendy Rhoades

P. O. Box 1088

Austin, TX 78767-8810

7/10

Rhoades, WendyCL
18

From: A. Ron Thrower [REDACTED]
Sent: Monday, November 01, 2010 10:45 AM
To: bbaker5@austin.rr.com; Gregory Bourgeois; trabago@austin.rr.com; Sandra Baldrige; prseeger@austin.rr.com; crbanks@hotmail.com; donna.zap@gmail.com
Cc: Rhoades, Wendy
Subject: Items 2 & 3

Commissioners,

I am representing the landowners of the property covered under Item 3 – 10301 Old San Antonio Road. The current ordinance for this property entail a restriction to prohibit access to OSR and all access must be through abutting property. Essentially, the property is landlocked. We had tried to work with the adjoining property owner which had filed the case for Item # 2 – Double Creek Village. The Double Creek property owner was not willing to dedicate right-of-way at the time of their rezoning so that my client could have a legal point to construct access. This is what necessitated the filing of the rezoning on my client's property to address access. Since we filed the case, the Double Creek owners have agreed to dedicate right-of-way with the Double Creek Zoning case which provides us with the legal point of access.

As such, my request is that the dedication of right-of-way for the Double Creek Village zoning case, be specifically read into the record. Provided that this is performed, then we will request an indefinite postponement to the 10301 Old San Antonio Road zoning case and not sign in opposition to the Double Creek Village zoning case and not have it pulled for discussion.

Ron Thrower

Thrower Design

P.O. Box 41957

Austin, Texas 78704

512/476-4456

PUBLIC HEARING INFORMATION

This zoning/rezoning request will be reviewed and acted upon at two public hearings: before the Land Use Commission and the City Council. Although applicants and/or their agent(s) are expected to attend a public hearing, you are not required to attend. However, if you do attend, you have the opportunity to speak FOR or AGAINST the proposed development or change. You may also contact a neighborhood or environmental organization that has expressed an interest in an application affecting your neighborhood.

During its public hearing, the board or commission may postpone or continue an application's hearing to a later date, or may evaluate the City staff's recommendation and public input forwarding its own recommendation to the City Council. If the board or commission announces a specific date and time for a postponement or continuation that is not later than 60 days from the announcement, no further notice is required.

During its public hearing, the City Council may grant or deny a zoning request, or rezone the land to a less intensive zoning than requested but in no case will it grant a more intensive zoning.

However, in order to allow for mixed use development, the Council may add the MIXED USE (MU) COMBINING DISTRICT to certain commercial districts. The MU Combining District simply allows residential uses in addition to those uses already allowed in the seven commercial zoning districts. As a result, the MU Combining District allows the combination of office, retail, commercial, and residential uses within a single development.

For additional information on the City of Austin's land development process, visit our website:

www.ci.austin.tx.us/development

Written comments must be submitted to the board or commission (or the contact person listed on the notice) before or at a public hearing. Your comments should include the board or commission's name, the scheduled date of the public hearing, and the Case Number and the contact person listed on the notice.

Case Number: C14-2010-0111

Contact: Wendy Rhoades, 512-974-7719

Public Hearing: May 3, 2011, Zoning and Platting Commission

Sheldon Stabewood
Your Name (please print) by Rick Sheldon

☒ I am in favor
☐ I object

We are applicant

Your address(es) affected by this application

4-25-11
Date

Signature

Daytime Telephone: 210-490-2500

Comments:

If you use this form to comment, it may be returned to:

City of Austin

Planning & Development Review Department

Wendy Rhoades

P. O. Box 1088

Austin, TX 78767-8810

19/11

Rhoades, Wendy

From: A. Ron Thrower [REDACTED]
Sent: Thursday, April 28, 2011 1:14 PM
To: Rhoades, Wendy
Subject: Stablewood

CI
20

Wendy,

Pursuant to our conversations, please accept this email as a postponement request to June 7, 2011.

Ron Thrower

Thrower Design

P.O. Box 41957
Austin, Texas 78704

CONFIDENTIALITY NOTICE: This communication is intended only for the use of the individual or entity to which it is addressed and may contain information that is privileged, confidential, and exempt from disclosure under applicable law. If you are not the intended recipient, you are notified that any use, dissemination, distribution, or copying of this communication or any attachment is strictly prohibited. In such an event, please contact the sender immediately and delete all copies of this communication and any attachment.

4/28/2011

Rhoades, Wendy

From: A. Ron Thrower [REDACTED]

Sent: Tuesday, June 07, 2011 8:52 AM

To: Rhoades, Wendy

Subject: 10301 Old San Antonio Road

C1
21

Wendy,

Please accept this email as a request to postpone the case for another month to July 5, 2011.

We are still seeking alternative methods for limited access through a site design that requires further study.

Ron Thrower

Thrower Design

P.O. Box 41957
Austin, Texas 78704
512 / 476-4456

CONFIDENTIALITY NOTICE: This communication is intended only for the use of the individual or entity to which it is addressed and may contain information that is privileged, confidential, and exempt from disclosure under applicable law. If you are not the intended recipient, you are notified that any use, dissemination, distribution, or copying of this communication or any attachment is strictly prohibited. In such an event, please contact the sender immediately and delete all copies of this communication and any attachment.

6/7/2011