

C21
1

SUBDIVISION REVIEW SHEET

CASE NO.: C8-2011-0093.0A

Z.A.P. DATE: 8-16-11

SUBDIVISION NAME: Parmer Place Subdivision, Lot 4; Resubdivision

AREA: 1.503

LOT(S): 2

OWNER/APPLICANT: Dessau 38 Partners, Ltd.
(John Lewis)

AGENT: Dessau 38 Partners, Ltd.
(John Lewis)

ADDRESS OF SUBDIVISION: 12315 DESSAU RD

GRIDS: MN32

COUNTY:

WATERSHED: Walnut Creek

JURISDICTION: Full Purpose

EXISTING ZONING:

MUD: N/A

NEIGHBORHOOD PLAN:

PROPOSED LAND USE: Commercial

ADMINISTRATIVE WAIVERS: None

VARIANCES: None

SIDEWALKS: Sidewalks will be provided on both sides of all internal streets and the subdivision side of boundary streets.

DEPARTMENT COMMENTS: The request is for approval of the Parmer Place Subdivision, Lot 4; Resubdivision. The proposed plat is composed of 2 lots on 1.503 acres.

STAFF RECOMMENDATION: The staff recommends disapproval of the plat. This plat does not meet all applicable State and City of Austin LDC requirements.

ZONING AND PLATTING ACTION:

1 KACKING 10626011

24P

C21
2/2

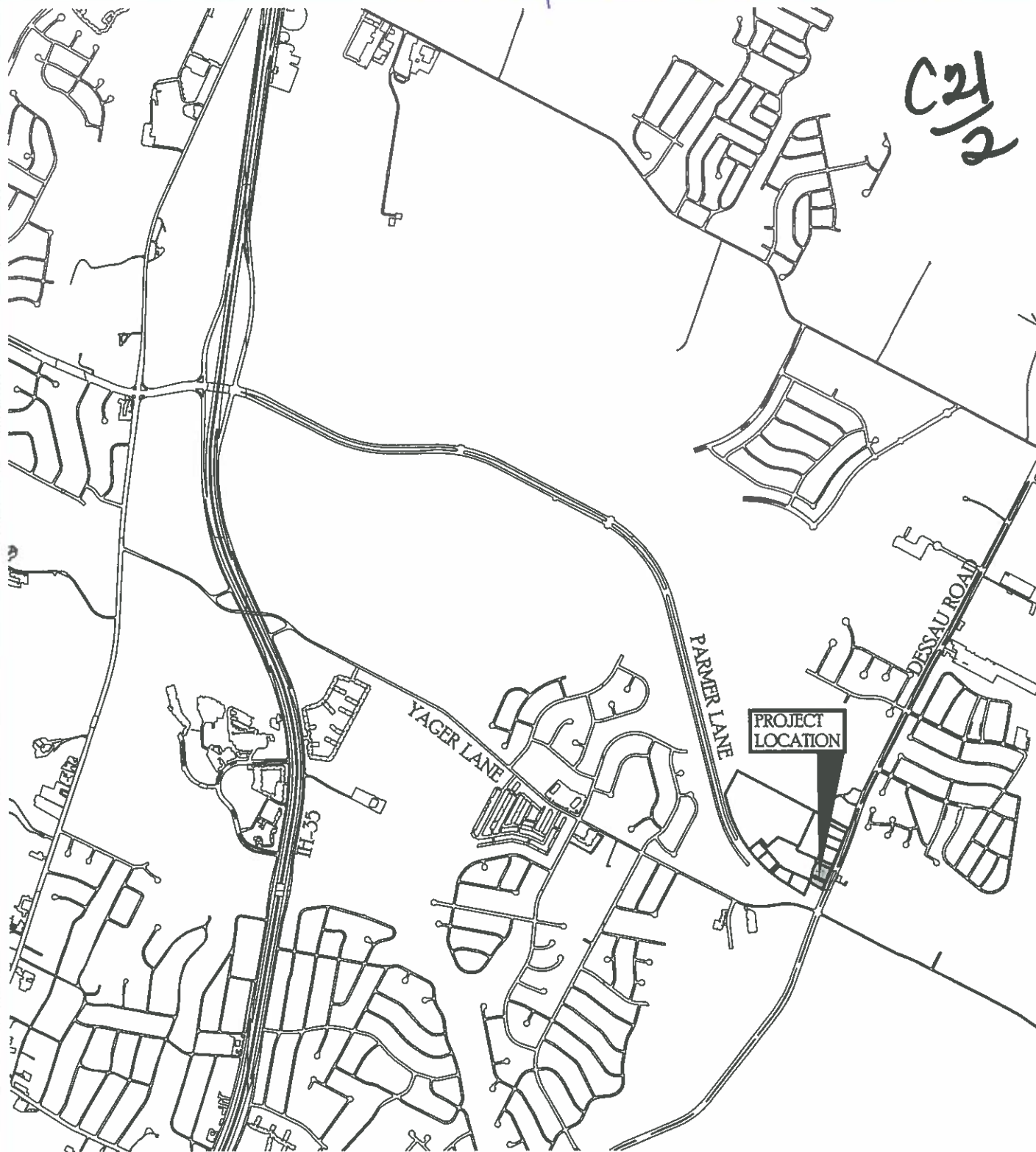

LOCATION MAP



LONGARO & CLARKE
Consulting Engineers

Land Development • Stormwater Management • Water Resources

7501 North Capital of Texas Highway • Building A • Suite 250 Austin, Texas 78731

(512) 306-0228 ~ www.LongaroClarke.com ~ TBPE Reg. No. F-544

