

ORDINANCE NO. _____

AN ORDINANCE REZONING AND CHANGING THE ZONING MAP FOR THE PROPERTY LOCATED AT 1610-1612 MEGHAN LANE FROM FAMILY RESIDENCE (SF-3) DISTRICT AND GENERAL COMMERCIAL SERVICES (CS) DISTRICT TO FAMILY RESIDENCE (SF-3) DISTRICT.

BE IT ORDAINED BY THE CITY COUNCIL OF THE CITY OF AUSTIN:

PART 1. The zoning map established by Section 25-2-191 of the City Code is amended to change the base district from family residence (SF-3) district and general commercial services (CS) district to family residence (SF-3) district on the property described in Zoning Case No. C14-2011-0078, on file at the Planning and Development Review Department, as follows:

Lot 1, P.J. Aboussie Addition, and Lot 2, Alan Tinkle Addition, subdivisions in the City of Austin, Travis County, Texas, according to the maps or plats of record in Plat Book 88, Page 667, and Plat Book 83, Page 132A, respectively, of the Plat Records of Travis County, Texas,

locally known as 1610-1612 Meghan Lane, in the City of Austin, Travis County, Texas, and generally identified in the map attached as Exhibit "A".

PART 2. This ordinance takes effect on _____, 2011.

PASSED AND APPROVED

_____, 2011 § _____
 § _____
 § _____
 Lee Leffingwell
 Mayor

APPROVED: _____ **ATTEST:** _____
 Karen M. Kennard Shirley A. Gentry
 City Attorney City Clerk

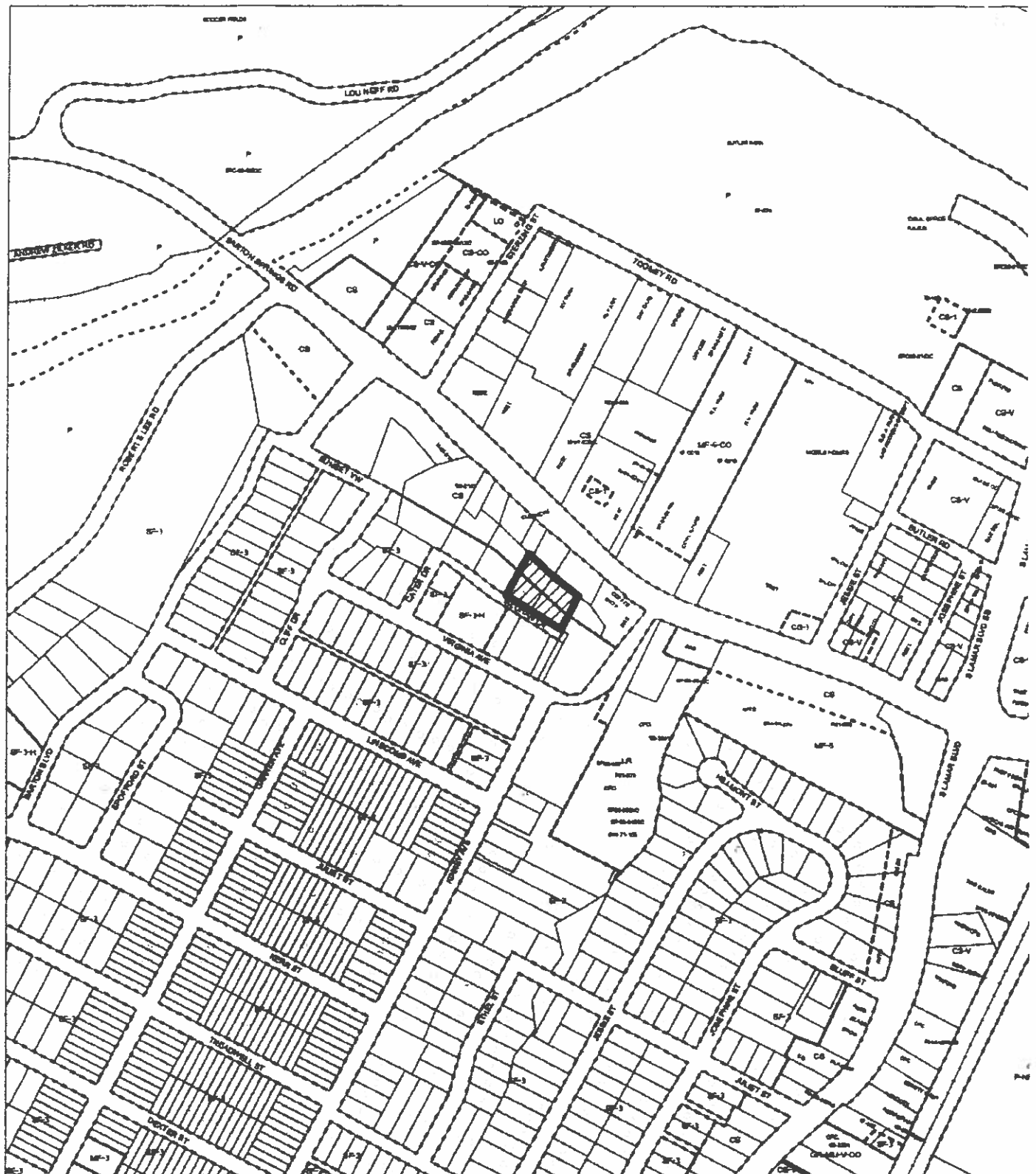

ZONING EXHIBIT A

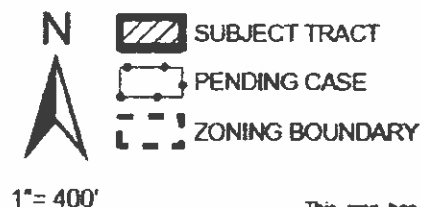

- SUBJECT TRACT
- PENDING CASE
- ZONING BOUNDARY

ZONING CASE#: C14-2011-0078
 LOCATION: 1610-1612 MEGHAN LANE
 SUBJECT AREA: 0.56 ACRES
 GRID: H21 H22
 MANAGER: STEPHEN RYE



This map has been produced by the Communications Technology Management Dept. on behalf of the Planning Development Review Dept. for the sole purpose of geographic reference. No warranty is made by the City of Austin regarding specific accuracy or completeness.