

ORDINANCE NO.

AN ORDINANCE AMENDING ORDINANCE NO. 20030327-12, WHICH ADOPTED THE GOVALLE/JOHNSTON TERRACE COMBINED NEIGHBORHOOD PLAN AS AN ELEMENT OF THE AUSTIN TOMORROW COMPREHENSIVE PLAN, TO CHANGE THE LAND USE DESIGNATION ON THE FUTURE LAND USE MAP FOR PROPERTY LOCATED AT 5702 ½ JAIN LANE.

BE IT ORDAINED BY THE CITY COUNCIL OF THE CITY OF AUSTIN:

PART 1. Ordinance No. 20030327-12 adopted the Govalle/Johnston Terrace Combined Neighborhood Plan as an element of the Austin Tomorrow Comprehensive Plan.

PART 2. Ordinance No. 20030327-12 is amended to change the land use designation from civic use and single family use to recreation and open space use for the property located at 5702 ½ Jain Lane on the future land use map attached as Exhibit "A" and incorporated in this ordinance, and described in File NPA-2011-0016.01 at the Planning and Development Review Department.

PART 3. This ordinance takes effect on _____, 2011.

PASSED AND APPROVED

_____, 2011 § _____
 § _____
 § _____
 Lee Leffingwell
 Mayor

APPROVED: _____
 Karen M. Kennard
 City Attorney

ATTEST: _____
 Shirley A. Gentry
 City Clerk

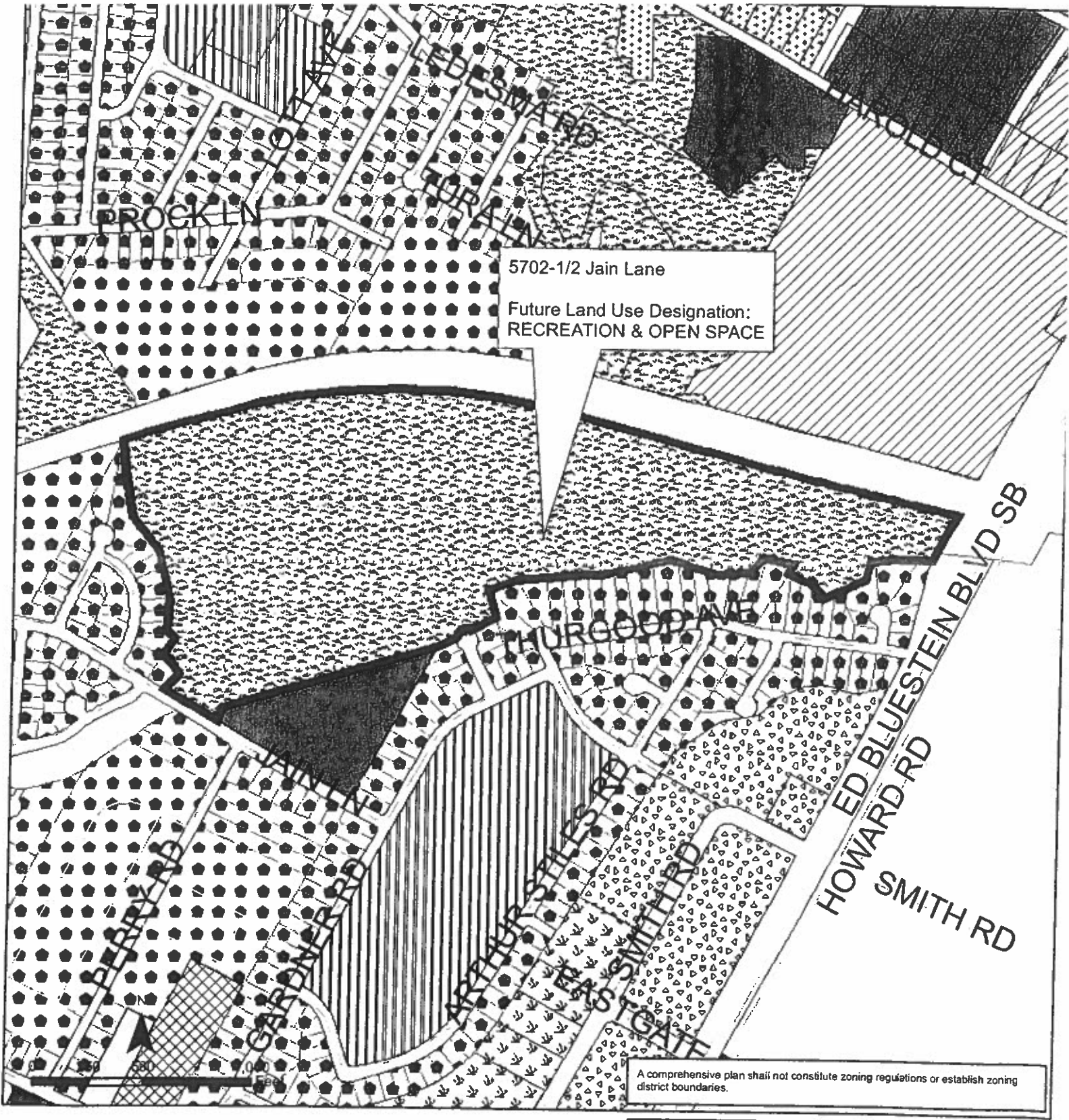

Exhibit A **Govalle/Johnston Terrace Neighborhood Plan** **Amendment NPA-2011-0016.01**

This product is for informational purposes and may not have been prepared for or be suitable for legal, engineering, or surveying purposes. It does not represent an on-the-ground survey and represents only the approximate relative location of property boundaries.

This product has been produced by the Planning and Development Review for the sole purpose of geographic reference. No warranty is made by the City of Austin regarding specific accuracy or completeness.

Future Land Use

- Single-Family
- Higher-Density Single-Family
- Mobile Homes
- Mixed Residential
- Multi-Family
- Commercial
- Mixed Use

- Warehouse/Limited Office
- Office
- Mixed Use/Office
- Industry
- Civic
- Recreation & Open Space
- Transportation