

C18
1

SUBDIVISION REVIEW SHEET

CASE NO.: C8J-2008-0056.MGA

ZAP DATE: November 6, 2012

SUBDIVISION NAME: Pearson Place at Avery Ranch

AREA: 195.563

LOT(S): N/A

OWNER/APPLICANT: Pearson Place at Avery Ranch
(Gary L. Newman)

AGENT: McLean & Howard, LLP
(Jeffrey S. Howard)

ADDRESS OF SUBDIVISION: 13115 Avery Ranch Blvd.

GRIDS: H41, H42

COUNTY: Travis

WATERSHED: South Brushy Creek

JURISDICTION: 2-Mile ETJ

EXISTING ZONING: N/A

MUD: N/A

NEIGHBORHOOD PLAN: N/A

PROPOSED LAND USE: Single Family/Multi-Family

ADMINISTRATIVE WAIVERS:

VARIANCES: None

SIDEWALKS: Sidewalks will be provided on both sides of all internal streets and the subdivision side of boundary streets.

DEPARTMENT COMMENTS: The request is for approval of the Pearson Place at Avery Ranch. The proposed plat is composed of N/A lots on 195.563 acres.

STAFF RECOMMENDATION: The staff recommends disapproval of the plat. This plat does not meet all applicable State and City of Austin LDC requirements.

PLANNING COMMISSION / ZONING AND PLATTING ACTION:

PEARSON PLACE AT AVERY RANCH C8J-2008-0056.MGA

Legend

-  Lot Lines
-  Streets
-  Building Footprints
-  Named Creeks
-  Lakes and Rivers
-  Parks
-  County

C18/2

Neighborhood Planning Status

NON-NEIGHBORHOOD

FUTURE PLANNING AREA

PLANNING UNDERWAY

PLAN APPROVED

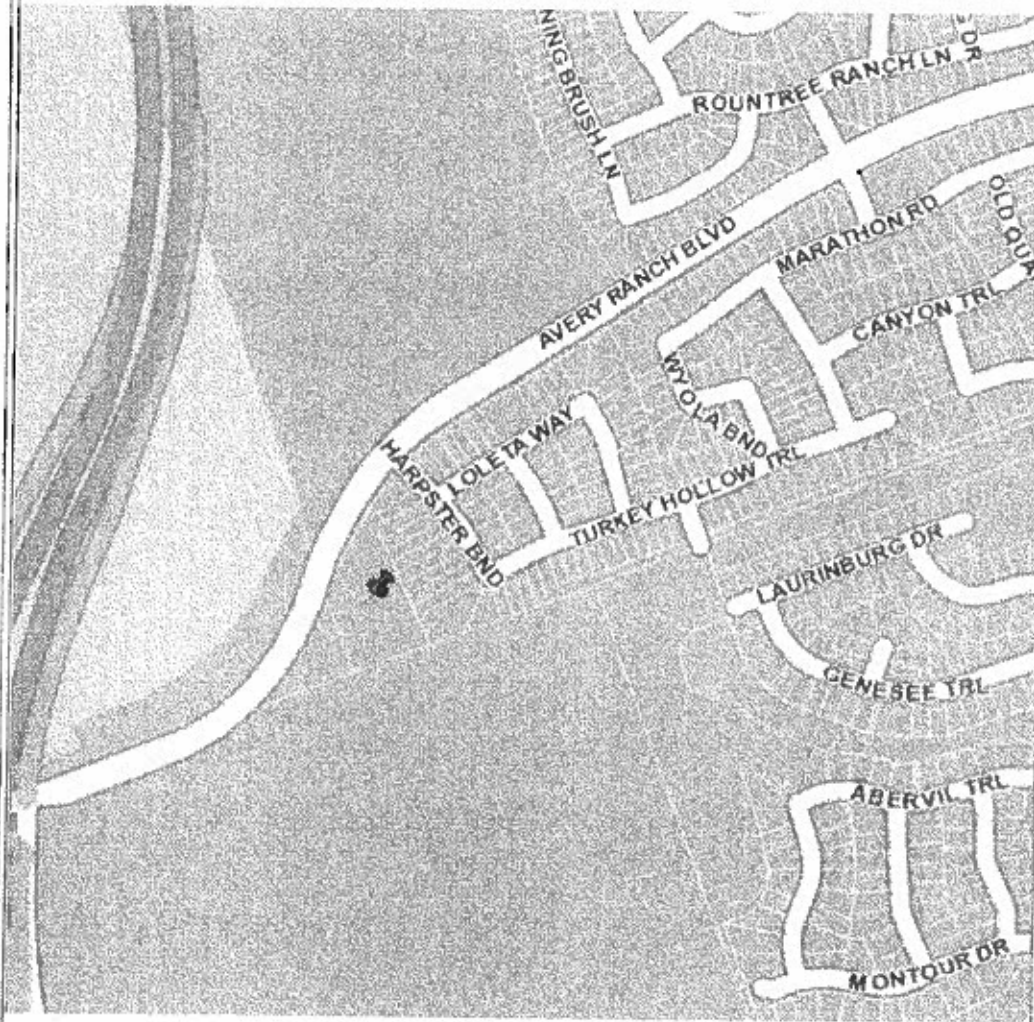

THIS PRODUCT IS FOR INFORMATIONAL PURPOSES AND MAY NOT HAVE BEEN PREPARED FOR OR BE SUITABLE FOR LEGAL, ENGINEERING, OR SURVEYING PURPOSES. IT DOES NOT REPRESENT AN ON-THE-GROUND SURVEY AND REPRESENTS ONLY THE APPROXIMATE RELATIVE LOCATION OF PROPERTY BOUNDARIES. THIS PRODUCT HAS BEEN PRODUCED BY THE CITY OF AUSTIN FOR THE SOLE PURPOSE OF GEOGRAPHIC REFERENCE. NO WARRANTY IS MADE BY THE CITY OF AUSTIN REGARDING SPECIFIC ACCURACY OR COMPLETENESS.