

**HISTORIC LANDMARK COMMISSION
JANUARY 28, 2013
NATIONAL REGISTER HISTORIC DISTRICT
NRD-2012-0131
Zilker Park
2201 Barton Springs Road
(Robert E. Lee Ballfields)**

PROPOSAL

Repair masonry dug-out benches, remove fencing in front benches, and replace the existing fencing on the backstop.

PROJECT SPECIFICATIONS

The applicant proposes to make the following repairs to the building per the attached documentation:

- Repair the existing rubble stone masonry dug-out benches referencing National Park Service Brief #2: Repointing Mortar Joints in Historic Masonry Buildings.
- Remove the section of fencing that currently blocks the dug-out benches, documenting their location and design with photographs and a measured site plan.
- Replace the fencing on the galvanized iron frame backstop with an appropriate fencing material.

STANDARDS FOR REVIEW

The existing property is contributing to the Zilker Park National Register Historic District. Applicable general design review guidelines state:

- The distinguishing original qualities or character of a property and its environment shall not be destroyed. Removal or alteration of any historic material or distinctive architectural features should be avoided.
- All properties shall be recognized as products of their own time. Alterations which have no historical basis and which seek to create an earlier appearance shall be discouraged.
- Changes which have taken place in the course of time may have acquired significance in their own right, and shall be recognized and respected.
- Distinctive stylistic features or examples of skilled craftsmanship which characterize a property shall be treated with sensitivity.
- Deteriorated architectural features shall be repaired rather than replaced whenever possible. In the event replacement is necessary, the new material should match the material being replaced in composition, design, color, texture, and other visual qualities. Repair or replacement of missing architectural features should be based on accurate duplications of features, substantiated by historical, physical, or pictorial evidence.
- Contemporary design for alterations and additions to existing properties are appropriate when such alterations and additions do not destroy significant historic, architectural, or cultural material and are compatible with the size, scale, color, material, and character of the property, neighborhood, or environment.

- Whenever, possible, new additions or alterations to structures shall be done in such a manner that if such additions or alterations were to be removed in the future, the essential form and integrity of the structure would not be impaired.
- Reconstruction of a part or all of a property shall be undertaken only when such work is essential to reproduce a significant missing feature in a historic district, and documentation exists to ensure an accurate reproduction of the original.

The proposed work meets the applicable standards for rehabilitation by repairing deteriorated features, in the case of the masonry repairs, and replacing materials that are either beyond repair or that do not have historical significance, in the case of the existing back-stop fencing material.

The removal of the existing fences in front of the dug-out benches is acceptable since they are significantly deteriorated and do not function for the current use of the site. However, carefully documenting their location, appearance and materials allows for their reinstallation in the future.

COMMITTEE RECOMMENDATIONS

Restore the benches and rehabilitate the back stop with appropriate fencing materials. Removal of the fence barriers in front of the benches is acceptable; however their location and design should be carefully documented on a measured site plan and with photographs.

STAFF RECOMMENDATION

Release the permit per the proposed design with the recommendation that Historic Preservation Office staff review final specifications for masonry repairs and fence material.

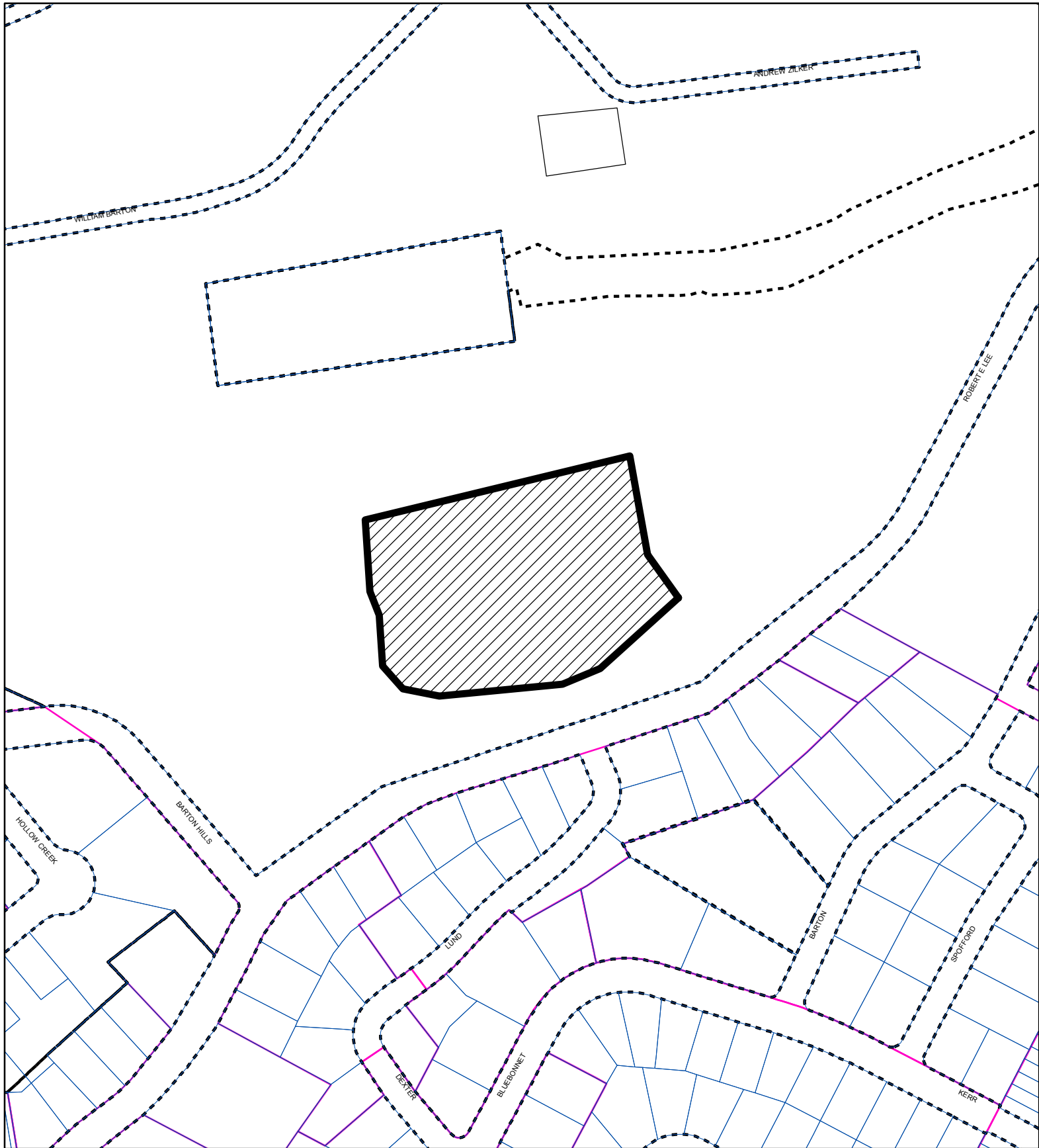

SUBJECT TRACT



ZONING BOUNDARY

CASE#: NRD-2012-0131
LOCATION: 2201 Barton Springs Road



This product is for informational purposes and may not have been prepared for or be suitable for legal, engineering, or surveying purposes. It does not represent an on-the-ground survey and represents only the approximate relative location of property boundaries.

This product has been produced by the Planning and Development Review Department for the sole purpose of geographic reference. No warranty is made by the City of Austin regarding specific accuracy or completeness.



TO: Alyson McGee, Deputy Historic Preservation Officer

FROM: Kim McKnight, Cultural Resource Specialist and Project Coordinator

DATE: November 27, 2012

SUBJECT: Rehabilitation of Rbt E. Lee Ballfields

CC: Charles Vaclavik
Marty Stump

The City of Austin Parks and Recreation Department requests that the Historic Preservation Office and Landmark Commission consider the attached National Register permit application to rehabilitate the c. 1920s ballfield sites along Robert E. Lee. which contribute to the 1997 Zilker Park National Register District.

There are two c. 1920s ballfields, each comprising two rubble stone masonry dugout benches and a galvanized iron pipe frame backstop. Currently, the fencing is a mix of woven wire and chain link fencing. Remnants of chicken wire fencing can be seen hanging from the top wire of the backstop canopy.

The scope of work includes the repair of the rubble stone masonry dug-out benches referencing National Park Service Brief #2: Repointing Mortar Joints in Historic Masonry Buildings. Further, the section of fencing that currently blocks the dug-out benches will be removed and the fencing on the backstop will be replaced on the existing galvanized iron frame.

Research shows that the historic fencing material used on City of Austin ballfields has ranged from chicken wire, used in the 1920s through the 1940s, to chain link, which appears in the 1950s. PARD proposed to use chain link as the replacement material and may use a woven wire fencing for the upper canopy portion of the backstop.

A map and current photographs are included in this memo. Historic photos of these particular ballfields could not be located, however, historic photographs of other Austin ballfields are included for reference.



Zilker Metropolitan Park: Robert E. Lee Ballfields

27 November 2012 KM

This product is for informational purposes and may not have been prepared for or be suitable for legal, engineering, or surveying purposes. It does not represent an on-the-ground survey and represents only the approximate relative location of property boundaries. This product has been produced by the Parks and Recreation Department for the sole purpose of geographic reference. No warranty is made by the City of Austin regarding specific accuracy or completeness.

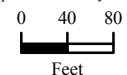



Robert E. Lee Ballfields



Robert E. Lee Ballfields



Robert E. Lee Ballfields



Baseball, undated



Baseball, 1939



Baseball, c. 1940s



Major City League Softball, 1942



1956 ball game at Meadowbrook Housing



Baseball, 1968