

C 21 / 1

**SUBDIVISION REVIEW SHEET**

**CASE NO.:** C8J-2013-0060.0A

**Z.A.P. DATE:** 4-16-13

**SUBDIVISION NAME:** Barton Valley Subdivision Lot 2; Resubdivision

**AREA:** 5.2774

**LOT(S):** 2

**OWNER/APPLICANT:** Andrew & Carmel Wakefield

**AGENT:** Aupperle Company  
(Bruce Aupperle)

**ADDRESS OF SUBDIVISION:** 802 CRYSTAL CREEK DR

**GRIDS:** MC25

**WATERSHED:** Barton Creek

**JURISDICTION:** 2 mile ETJ

**EXISTING ZONING:**

**MUD:** N/A

**NEIGHBORHOOD PLAN:**

**PROPOSED LAND USE:** SF

**ADMINISTRATIVE WAIVERS:** None

**VARIANCES:** None

**SIDEWALKS:** Sidewalks will be provided on both sides of all internal streets and the subdivision side of boundary streets.

**DEPARTMENT COMMENTS:** The request is for approval of the Barton Valley Subdivision Lot 2; Resubdivision. The proposed plat is composed of 2 lots on 5.2774 acres.

**STAFF RECOMMENDATION:** The staff recommends disapproval of the plat. This plat does not meet all applicable State and City of Austin LDC requirements.

**ZONING AND PLATTING ACTION:**

ZAP  
#10920402

Location Map C21  
2

552

Directions Made Easy  
www.mapsco.com

CONTINUED ON MAP 522

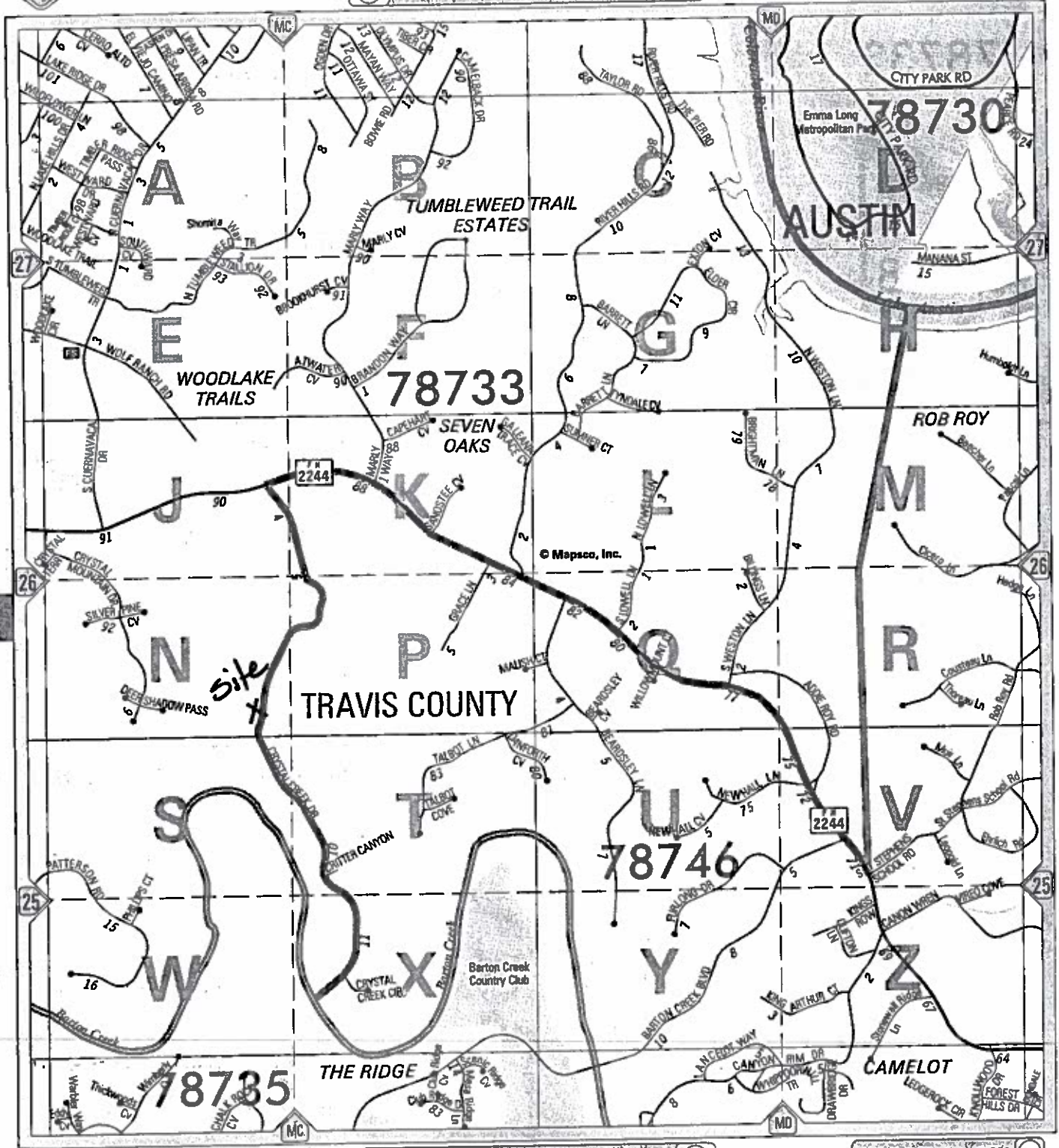

CONTINUED ON MAP 551

CONTINUED ON MAP 582

CONTINUED ON MAP 553



COPYRIGHT 1993, 2009 by MAPSCO INC. - ALL RIGHTS RESERVED

