

DATE of SUBMISSION:



Application for Certificate of Appropriateness for a City Landmark or Local Historic District

Adopted December 2012

Permit Information	
For Office Use Only	BP- _____ PR- _____ C14H/LHD - _____
	Property Name or LHD: _____ Contributing/Non-contributing
	<input type="checkbox"/> RELEASE PERMIT <input type="checkbox"/> DO NOT RELEASE PERMIT <input type="checkbox"/> HLC REVIEW _____ FEE PAID: \$ _____
	HISTORIC PRESERVATION OFFICE _____ DATE: _____
Property Information	
Address: Mayfield Park, 3505 W 35th Street, Austin TX 78703	
Scope of Work	
Erosion Control and Wall Stabilization	
Applicant	
Name: Kim McKnight, MSHP, Project Coordinator & Cultural Resource Specialist	
Address: 919 W. 28 1/2 Street	
City/Zip: Austin, TX 78703	
Phone: 512/974-9478	
Email: kim.mcknight@austintexas.gov	
Owner	
Name: Jeff Larsen, Parks Grounds Manager, Parks and Recreation Dept.	
Address: 12138 North Lamar Blvd.	
City/Zip: Austin, TX 78753	
Phone: 512/974-9593	
Email: jeff.larsen@austintexas.gov	
Architect or Contractor Information	
Company: _____	
Address: _____	
City/Zip: _____	
Phone: _____	

 _____ Owner's Signature	4/26/13 _____ Date	 _____ Applicant's Signature	4/29/13 _____ Date
--------------------------------	--------------------------	------------------------------------	--------------------------



CO'DESIGN

1200 YAUPON VALLEY RD.
AUSTIN TX 78746
Ph: 512-423-1298
Fx: 512-328-5231

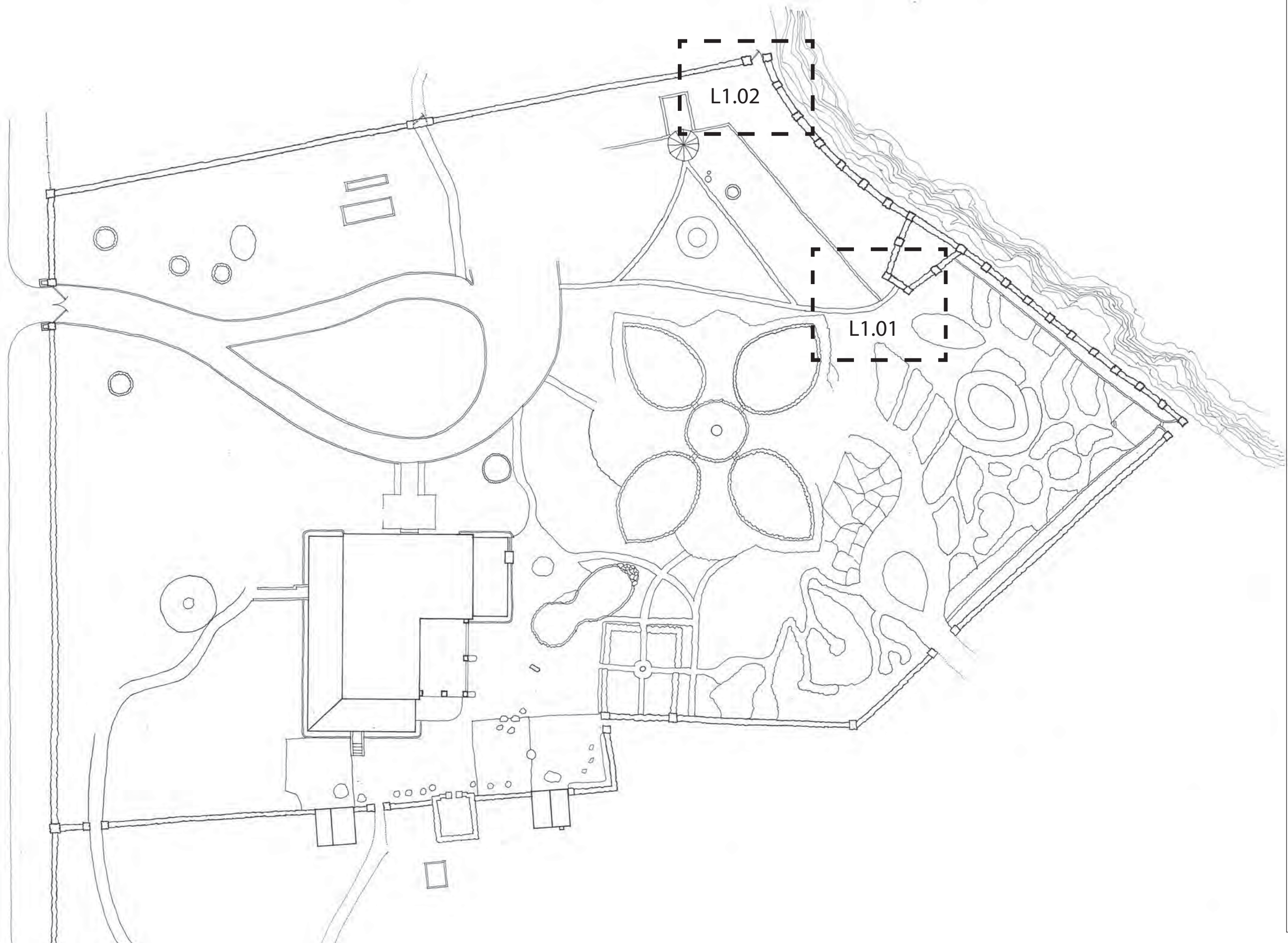

Mayfield Park
Erosion Control &
Wall Stabilization
Plan Overview

L1.00

3/21/13

Notes:

1. Plan sketch is approximate. Contractor to verify layout in field with Landscape Architect.

2. Refer to L2.00 for photographic documentation of existing conditions

Existing stone path at pond.

Steel edge step with 6" riser, 1/4" thick plate steel, primed and painted black; stake in place with 15" stakes at 2'-0" o.c. or as needed to secure steel. If tree roots are encountered consult with Landscape Architect for steel layout adjustments prior to installation.

Existing Multi-trunk Live Oak tree. Protect tree roots do not cut. Fill only. Maximum coverage above roots shall be 3-4" of soil above tree roots.

Existing Palm tree. Protect tree roots do not cut. Fill only.

Limestone flagstone stepping stones, 2-3" thick, sawn top and bottom, ranging in dimension from 2'-3'. No pieces smaller than 2' in any dimension. Remove existing field stones to provide for 1" sand setting bed for flagstone. Stone color should be a gray similar to existing stone on site.

Note: Use excavated field stones removed to install flagstone to repair wall.

Plant Berkley Sedge in between flagstone stepping stones. 4" pots at 8" on center.

Existing wall to be repaired to match historic condition. (approximately 47' of wall at 9"-15" height). Verify extent of work and wall heights in field with Landscape Architect. Contractor to provide stone and mortar samples for Landscapes Architects review prior to installation.

Pocket plant Berkley Sedge in between flagstone stepping stones. 4" pots at 8" on center.

Existing planting bed

Existing Red Oak tree. Protect tree roots do not cut. Fill only. Maximum soil coverage above roots shall be 3"-4".

Existing planting bed

Existing planting bed

Existing walls and arch



1200 YAUPON VALLEY RD.
AUSTIN TX 78746
Ph: 512-423-1298
Fx: 512-328-5231

Mayfield Park
Erosion Control &
Wall Stabilization
Plan Sketch

SCALE: 1/4"=1'

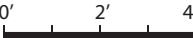

L1.01

3/21/13

Notes:

1. Plan sketch is approximate. Contractor to verify layout in field with Landscape Architect.
2. Refer to L2.00 for photographic documentation of existing conditions

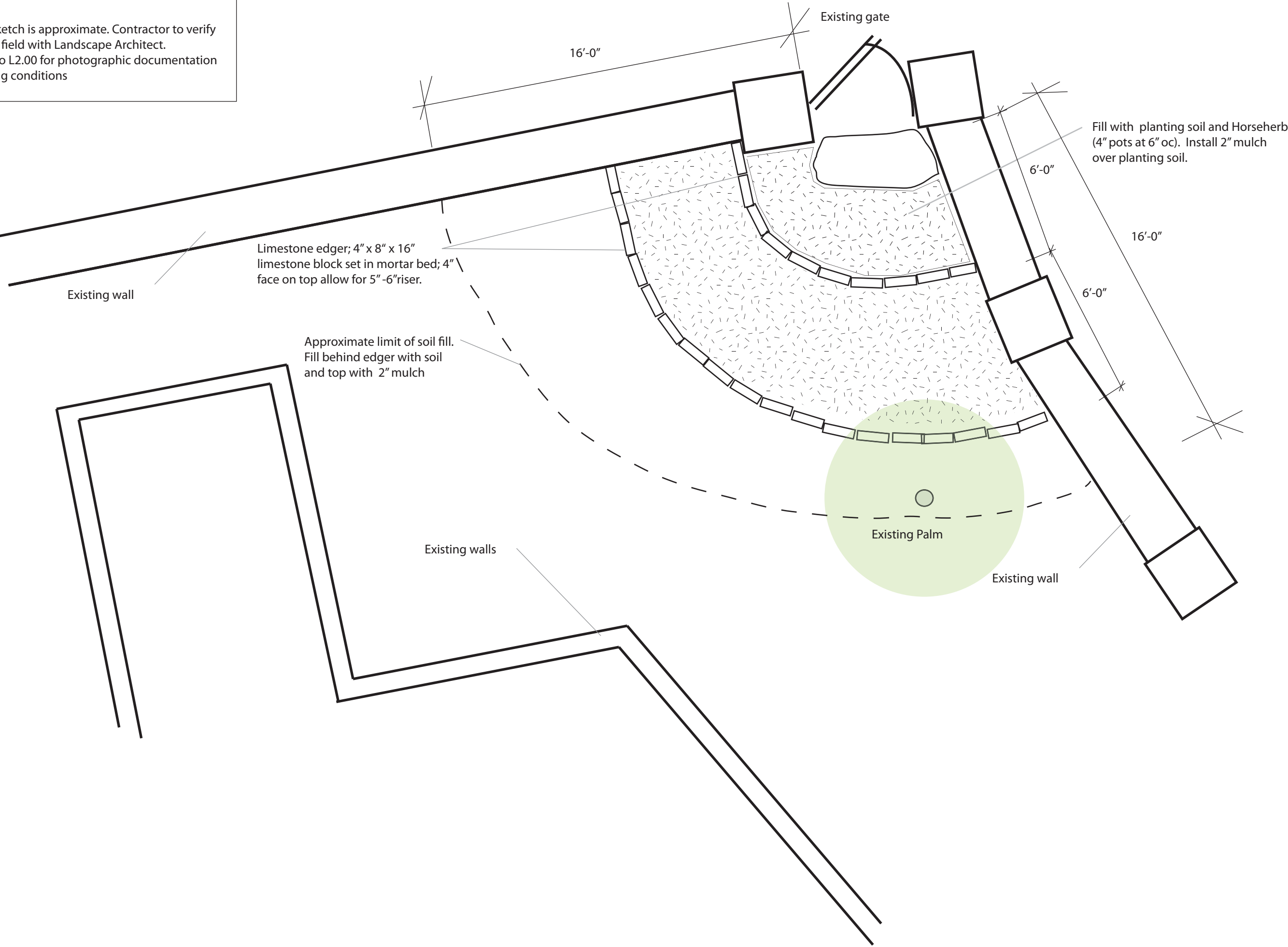



View facing West from Arch: erosion exposing stones and rock subgrade



View facing North from Arch of stone wall remnants requiring reconstruction to prevent further site erosion



View facing East toward Arch-- erosion exposing stones and depositing soil into archway/overlook area



Close-up of wall remnants requiring reconstruction to prevent further site erosion



Close-up of existing wall in historic condition. Wall reconstruction to match



View facing North toward NE Gate -- erosion exposing irrigation pipes, roots, and depositing soil beyond gate



View facing East toward NE Gate -- erosion exposing irrigation pipes, roots, and depositing soil beyond gate