

4/1

## SUBDIVISION REVIEW SHEET

**CASE NO.:** C8-2013-0072.0A

**ZAP DATE:** May 7, 2013

**SUBDIVISION NAME:** Lot 1, Block A of the Presidio Phase 1 Subdivision

**AREA:** 14.1

**LOT(S):** 1

**OWNER/APPLICANT:** Sonmar of Phoenix, LLC  
(Jordan Scott)

**AGENT:** Bury & Partners, Inc.  
(Megan Wanek)

**ADDRESS OF SUBDIVISION:** Lakeline Mall Drive

**GRIDS:** G40

**COUNTY:** Travis

**WATERSHED:** Lake Creek

**JURISDICTION:** Full-Purpose

**EXISTING ZONING:** N/A

**MUD:** N/A

**NEIGHBORHOOD PLAN:** N/A

**PROPOSED LAND USE:** PUD

**ADMINISTRATIVE WAIVERS:**

**VARIANCES:** None

**SIDEWALKS:** Sidewalks will be provided on both sides of all internal streets and the subdivision side of boundary streets.

**DEPARTMENT COMMENTS:** The request is for approval of the Lot 1, Block A of the Presidio Phase 1 Subdivision. The proposed plat is composed of 1 lots on 14.1 acres.

**STAFF RECOMMENDATION:** The staff recommends disapproval of the plat. This plat does not meet all applicable State and City of Austin LDC requirements.

**PLANNING COMMISSION / ZONING AND PLATTING ACTION:**

CL/s

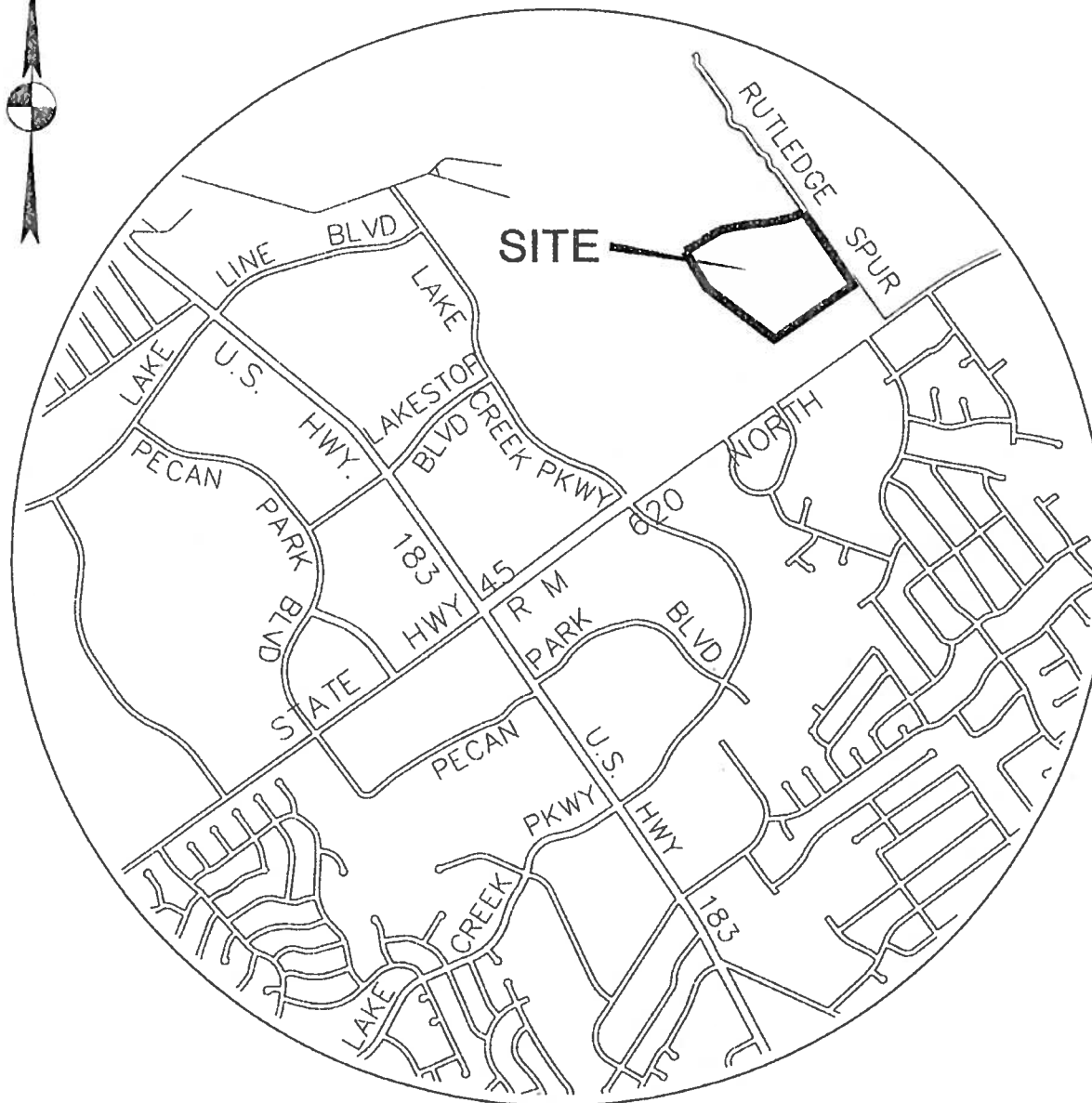

**SITE LOCATION MAP**

N.T.S.

Zap  
TR # 10978709

**Bury+Partners**

221 West Sixth Street, Suite 600  
Austin, Texas 78701  
Tel. (512)328-0011 Fax (512)328-0325  
TBPE Registration Number F-1048  
Bury+Partners, Inc. ©Copyright 2013

**PRESIDIO  
LAKELINE MALL BLVD. AT LYNDBURST**

**STREETLIGHTS RESIDENTIAL**

**SITE LOCATION MAP**

DATE: 03/21/2013

SCALE: NTS

DRAWN BY: SBH

FILE:

PROJECT No. 109883.10009