

APPLICANT: BFI WASTE SERVICES OF TEXAS, LP dba
REPUBLIC SERVICES OF AUSTIN
LEE KUHN, GENERAL MANAGER
3424 FM 973, DEL VALLE, TX 78617
TEL. NO. (512) 247-5647



C-1.	COVER SHEET
C-2.	GENERAL NOTES
C-3.	PROPERTY MAP
C-4.	EXISTING CONDITIONS AND SLOPE MAP
C-5.	EROSION & SEDIMENTATION CONTROL PLAN
C-6.	SITE PLAN
C-7.	SEQUENCE OF GRADING ACTIVITIES
C-8.	EXISTING DRAINAGE CONDITION
C-9.	PROPOSED DRAINAGE CONDITION
C-10.	CHANNEL PROFILES/DETAILS
C-11.	DRIVEWAY DETAILS
C-12.	POND DETAILS
C-13.	CULVERT DETAILS
C-14.	DETAILS
C-15.	CUT AND FILL EXHIBIT
L-1.	LANDSCAPE MASTER PLAN AND TREE LIST
L-2.	LANDSCAPE PLAN (1 OF 3)
L-3.	LANDSCAPE PLAN (2 OF 3)
L-4.	LANDSCAPE PLAN (3 OF 3)
L-5.	LANDSCAPE NOTES AND DETAILS
CEF-1.	C.E.F. MITIGATION PLAN

A LAND USE COMMISSION VARIANCE TO SECTION 25-8-341 OF THE COA LAND DEVELOPMENT CODE, FOR CUT AT DEPTHS FROM _____, TO _____, HAS BEEN APPROVED FOR THIS SITE BY THE ZONING AND PLATTING COMMISSION ON _____.

THE SITE IS COMPOSED OF 2 LOTS/TRACTS. IT HAS BEEN APPROVED AS ONE COHESIVE DEVELOPMENT. IF PORTIONS OF THE LOTS/TRACTS ARE SOLD, APPLICATION FOR SUBDIVISION AND SITE PLAN APPROVAL MAY BE REQUIRED.

THIS SITE SHALL BE DESIGNED, CONSTRUCTED, AND MAINTAINED IN CONFORMANCE WITH CHAPTER 25-8 OF THE CITY OF AUSTIN LAND DEVELOPMENT CODE AND CHAPTERS 64 AND 82 OF THE TRAVIS COUNTY CODE.

ENGINEER:

208 Wild Basin Rd • Suite A-240 • Austin TX 78746
(512) 329-0006 • (877)-365-2324
www.cerwin.com

LAND STRATEGIES INC.

PAUL INDIAN & ASSOCIATES
 1000 WEST 10TH AVENUE
 SUITE 1000
 DENVER, CO 80202
 (303) 733-1111
 FAX (303) 733-1112

CIVIL & ENVIRONMENTAL CONSULTANTS, INC.

WATERSHED PROTECTION & DEVELOPMENT REVIEW

SP-2012-0382D

SITE PLAN NO.

TRAVIS COUNTY TRANSPORTATION AND NATURAL RESOURCES	DATE
--	------

12-1602

DEVELOPMENT PERMIT NO.

BOTH LOTS ASSOCIATED WITH THE AUSTIN OPERATIONS CENTER HAVE BEEN DETERMINED TO BE LEGAL LOTS BY THE CITY OF AUSTIN AND ARE EXEMPT FROM PLATTING REQUIREMENTS. SEE LAND STATUS DETERMINATIONS C81-2012-0005 AND C81-2012-0154.

RELEASE OF THIS APPLICATION DOES NOT CONSTITUTE A VERIFICATION OF ALL DATA, INFORMATION AND CALCULATIONS SUPPLIED BY THE APPLICANT. THE ENGINEER OF RECORD IS SOLELY RESPONSIBLE FOR THE COMPLETENESS, ACCURACY AND ADEQUACY OF THEIR SUBMITTAL, WHETHER OR NOT THE APPLICATION IS REVIEWED FOR CODE COMPLIANCE BY CITY ENGINEERS.

THIS SITE IS NOT LOCATED OVER THE EDWARDS AQUIFER RECHARGE ZONE.

THERE ARE NO WATER OR WASTEWATER IMPROVEMENTS PROPOSED AS PART OF THIS PROJECT.

APPROVAL OF THESE PLANS BY THE CITY OF AUSTIN INDICATES COMPLIANCE WITH APPLICABLE CITY REGULATIONS ONLY. APPROVAL BY OTHER GOVERNMENTAL ENTITIES MAY BE REQUIRED PRIOR TO THE START OF CONSTRUCTION. THE APPLICANT IS RESPONSIBLE FOR DETERMINING WHAT ADDITIONAL APPROVALS MAY BE NECESSARY.

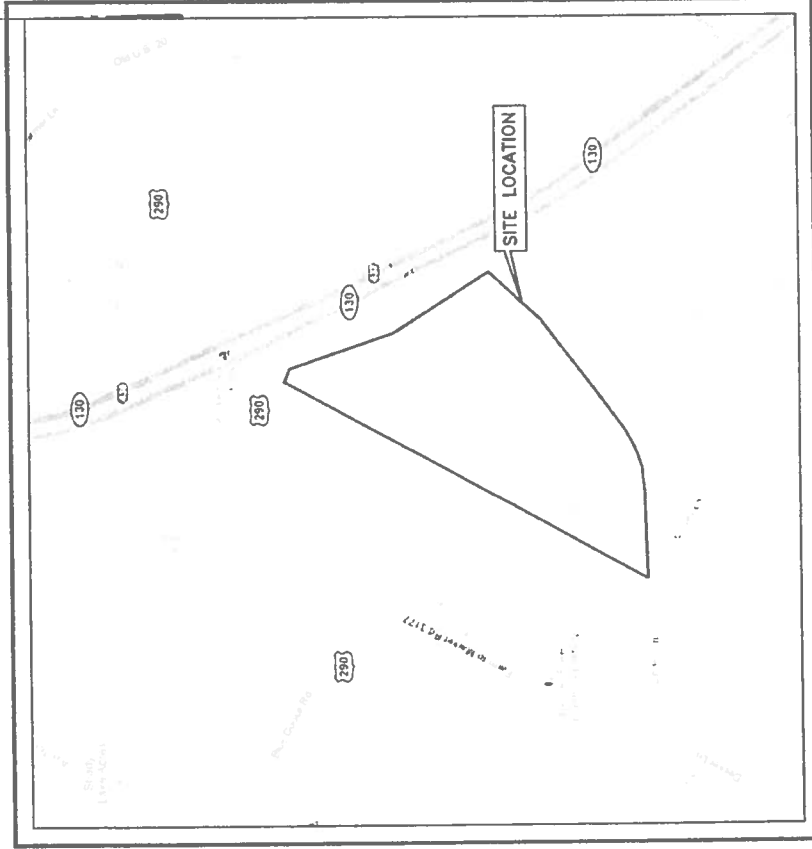

PROJECT LOCATION MAP
(A PORTION OF THIS SITE IS WITHIN THE 100 YR FLOODPLAIN AS PER
FEMA FIRM MAP NO. 48453C0480H, DATED 26 SEPTEMBER 2008, FOR TRAVIS COUNTY, TEXAS)
(NOT SUBJECT TO COMPATIBILITY STANDARDS)

[illegible]

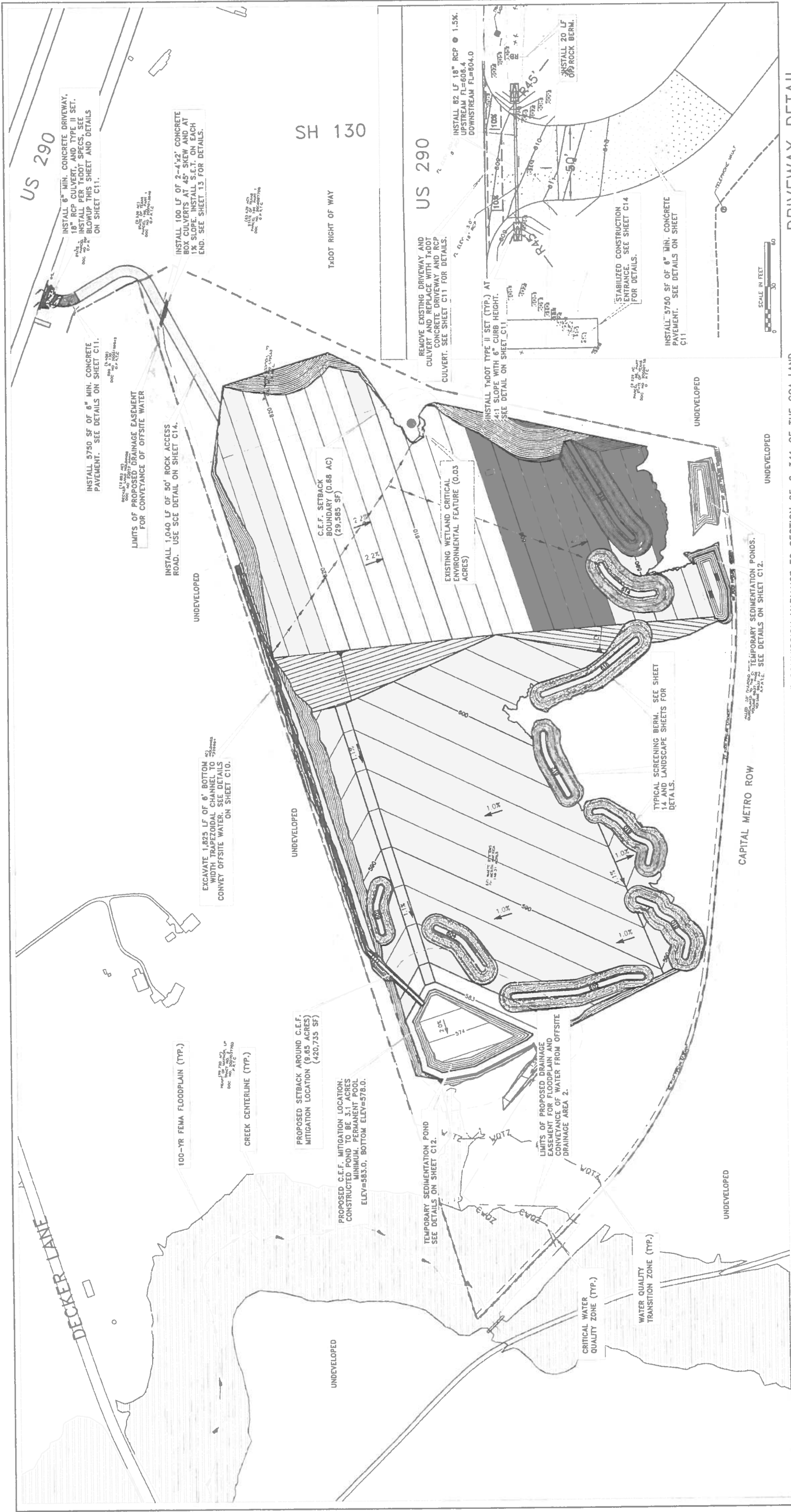

- NOTES:
1. ONSITE TOPOGRAPHIC SURVEY MAPPED BY FIRMATEX DATED 10/17/11.
 2. OFFSITE TOPOGRAPHIC DATA PROVIDED BY CITY OF AUSTIN GIS DATED 02/2003.
 3. FEMA FLOODPLAIN INFORMATION PROVIDED BY CITY OF AUSTIN GIS.
 4. SEE DIVERSION DKE DETAIL ON SHEET C14.
 5. SEE SHEET C12 FOR POND DETAILS.
 6. SEE SHEET C11 FOR TRAFFIC CONTROL DETAILS.

LEGEND

EXISTING CONTOURS	PROPOSED CONTOURS
PROPOSED CONCRETE DRIVEWAY	PROPOSED ROCK DRIVE
DIVERSION Dikes	PROPERTY BOUNDARY
100-YR FEMA FLOODPLAIN	



A LAND USE COMMISSION VARIANCE TO SECTION 25-8-341 OF THE COA LAND DEVELOPMENT CODE, FOR CUT AT DEPTHS FROM ' TO ' HAS BEEN APPROVED FOR THIS SITE BY THE ZONING AND PLATTING COMMISSION ON

A LAND USE COMMISSION VARIANCE TO SECTION 25-8-342 OF THE COA LAND DEVELOPMENT CODE, FOR FILL AT DEPTHS FROM ' TO ' HAS BEEN APPROVED FOR THIS SITE BY THE ZONING AND PLATTING COMMISSION ON

DRIVEWAY DETAIL

DRIVEWAY PERMIT 010-12-33236-09 WAS ISSUED BY TDDOT ON APRIL 4, 2012 FOR THE PROPOSED DRIVEWAY.

Civil & Environmental Consultants, Inc.
Texas Registered Engineering Firm F 36
208 Wild Bassi Rd • Suite A-240 • Austin, TX 78746
(512) 302-0006 • (877) 305-2324
www.ccec.com



RECYCLING CENTER GRADING PLAN

10001 E US 290 HWY

REPUBLIC SERVICES, INC.
REPUBLIC SERVICES OF AUSTIN
2424 FM 973
AUSTIN, TX 78617

SITE PLAN

FILE NAME: C6-SITE PLAN.dwg	JOB NUMBER: 111-784	Sheet C6
CHECKED BY: AWM	DESIGNED BY: AWM	
DRAWN BY: BEO	REVISED BY: AWM	
SCALE: 1" = 200'	DATE: 03/13/2013	6 of 21