

C8/1

**ZONING AND PLATTING COMMISSION SITE PLAN
EXTENSION REVIEW SHEET**

CASE NUMBER: SP-93-0419D(XT2) **ZAP COMMISSION DATE:** August 6, 2013

PROJECT NAME: Westlake Bible Church. – LUC Site Plan Extension

ADDRESS: 9300 FM 2244

AREA: 74.94 acres

WATERSHED: Lake Austin (Watersupply Rural, DWPZ)

JURISDICTION: 2-Mile ETJ

APPLICANT: Coats, Rose, Yale, Ryman & Lee
(John M. Joseph)
901 S. Mopac Expy, Bldg 1, Suite 500
Austin, Texas 78703
(512) 469-7987

AGENT: Urban Design Group
Don Sansom
3660 Stoneridge Rd
Austin, Texas 78746
(512) 347-0040

EXISTING ZONING: 2-Mile ETJ

PROPOSED DEVELOPMENT: The site has been developed with over 50% of its total proposed improvements for a religious assembly campus, including religious assembly, educational, and administrative structures; infrastructure; and parking. The approval of this extension will allow the build-out of the rest of the proposed campus.

STAFF RECOMMENDATION: The applicant has requested a 25-year extension. Staff recommends a ten-year extension, as is customary for religious uses, to August 30, 2023. Staff previously granted this site plan an administrative 1-year extension from August 30, 2012 to August 30, 2013.

The applicant has included a letter explaining details of the efforts made toward obtaining a building permit; this is included in this backup.

25-5-63(C) Extension of released site plan by the Land Use Commission: "the Land Use Commission may extend the expiration date of a released site plan beyond the date established by this chapter if the Land Use Commission determines that the request complies with the requirements for extension by the director under 25-5-62 (*Extension of Released Site Plan by Director*)."

25-5-62(C)(1)

(C) The director may extend the expiration date of a released administrative site plan one time for a period of one year if the director determines that there is good cause for the requested extension; and

“ (1) the director determines that:

- (a) the site plan substantially complies with the requirements that apply to a new application for site plan approval;
- (b) the applicant filed the original application for site plan approval with the good faith expectation that the site plan would be constructed;
- (c) the applicant constructed at least one structure shown on the original site plan that is suitable for permanent occupancy; or
- (d) the applicant has constructed a significant portion of the infrastructure required for development of the original site plan; and”

ZONING AND PLATTING COMMISSION ACTION: The Zoning and Platting Commission approved a 15-year phasing extension to this project on July 22, 1997.

CASE MANAGER: Christine Barton-Holmes, LEED AP
Christine.barton-holmes@austintexas.gov

Telephone: 974-2788

PREVIOUS APPROVALS: The site plan was granted a one year administratively approved extension from August 30, 2012 to August 30, 2013.

PROJECT INFORMATION: 74.94 acres

EXIST. ZONING: NA – 2-Mile ETJ

MAX. BLDG. COVERAGE : NA

MAX. IMPERV. CVRG.: 50%

PROP. BLDG CVRG: 142,990 sq. ft. (18%)

PROP. IMP. CVRG.: 732,104 sq. ft (22%)

A COMPARISON OF THE APPROVED PROJECT WITH CURRENT REGULATIONS:

WATERSHED ORDINANCE: This project complies with current watershed regulations. .

SUMMARY COMMENTS ON SITE PLAN:

LAND USE: The site is within the 2-Mile ETJ

ENVIRONMENTAL: All environmental comments have been cleared.

TRANSPORTATION: All transportation comments have been cleared.

SURROUNDING CONDITIONS:

Zoning/ Land Use

North: 2-Mile ETJ (single-family residential)

South: 2-Mile ETJ (single-family residential, meeting/assembly, & government services)

East: 2-Mile ETJ (single-family residential)

West: 2-Mile ETJ (agricultural)

<u>STREET:</u>	<u>R.O.W.</u>	<u>SURFACING</u>	<u>CLASSIFICATION</u>
FM 2244	avg 200'	90'	Major Arterial

NEIGHBORHOOD ORGANIZATION:

Lake Austin Collective

Super Duper Neighborhood Objectors and Appealers Organization

Austin Monorail Project

Sierra Club, Austin Regional Group

The Real Estate Council of Austin, Inc

Save Our Springs Alliance

City of Rollingwood

C8/3

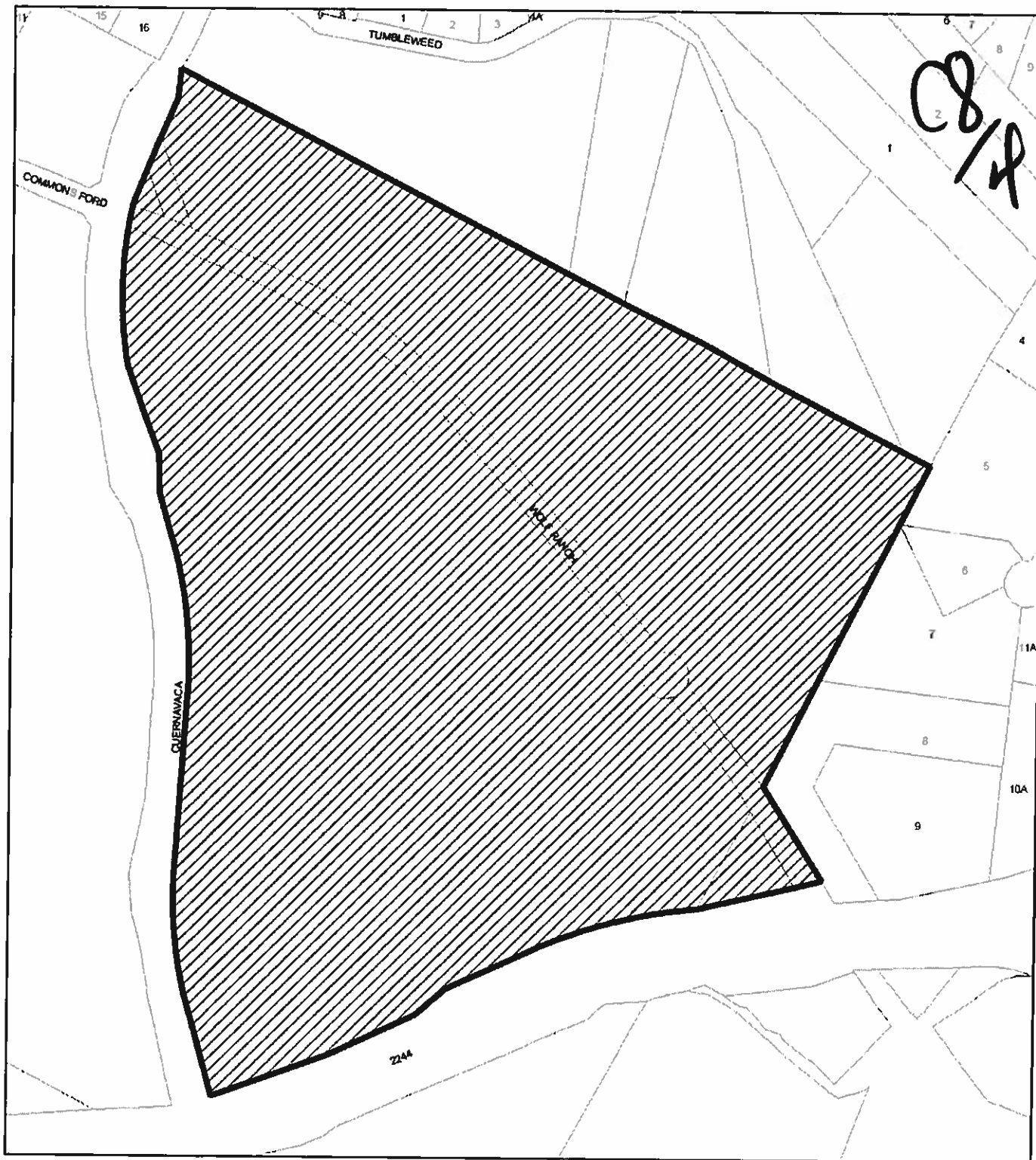

Subject Tract



Base Map

CASE#: SP-93-0419D(XT2)
ADDRESS: 9300 FM 2244 Road



This product is for informational purposes and may not have been prepared for or be suitable for legal, engineering, or surveying purposes. It does not represent an on-the-ground survey and represents only the approximate relative location of property boundaries.

This product has been produced by the Planning and Development Review Department for the sole purpose of geographic reference. No warranty is made by the City of Austin regarding specific accuracy or completeness.

WESTLAKE BIBLE CHURCH
(9238 FM ROAD 2244)

SITE DEVELOPMENT PERMIT

74.94 ACRES OF THE JEWELL E. WOLFE ESTATE
FREDRICH C. PECHT SURVEY NO. 593, ABSTRACT NO. 634
TRAVIS COUNTY, TEXAS
IDENTIFIED AS A LEGAL LOT BY THE CITY OF AUSTIN, IN A LEGAL LOT DETERMINATION.

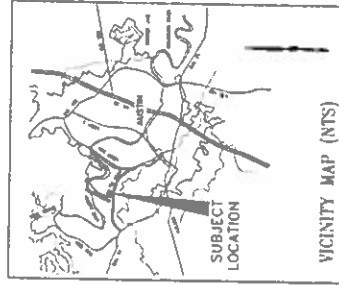
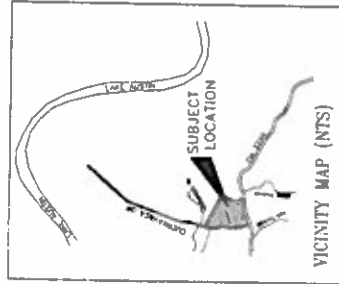

SUBMITTED FOR APPROVAL BY

RECORDED PROFESSIONAL ENGINEER

APPROVED BY: Maxwell DATE: 8/31/94

FOR TRAVIS COUNTY DEPARTMENT OF PLANNING AND DEVELOPMENT

SP - 23 - 0419 D
SITE PLAN/DEVELOPMENT PERMIT NUMBER

APPROVED BY: 8394 DATE

FOR TRAVIS COUNTY

NO CONSTRUCTION SHALL OCCUR ON THIS PERMIT

EMBRACE OF A TRAVIS COUNTY DEVELOPMENT PERMIT

PLANS RECOMMENDS MINIMUM FROM SECTION 5-40-009
THAT THE CITY OF AUSTIN BE NOTIFIED IN WRITING OF ANY
STORMWATER DETENTION FUND ADVANCE APPROVED BY
PLANNING COMMISSION ON 5-3-94

THIS PLAN IS SUBJECT TO THE INTEGRATED FLOOD MANAGEMENT PLAN AS
RECORDED IN VOLUME 106 OF THE DEED RECORDS OF TRAVIS COUNTY.

NO.	DATE	REVISION	BY	CHKD.
1	8/31/94	1	Maxwell	
2	8/31/94	2	Maxwell	
3	8/31/94	3	Maxwell	
4	8/31/94	4	Maxwell	
5	8/31/94	5	Maxwell	
6	8/31/94	6	Maxwell	
7	8/31/94	7	Maxwell	
8	8/31/94	8	Maxwell	
9	8/31/94	9	Maxwell	
10	8/31/94	10	Maxwell	
11	8/31/94	11	Maxwell	
12	8/31/94	12	Maxwell	
13	8/31/94	13	Maxwell	
14	8/31/94	14	Maxwell	
15	8/31/94	15	Maxwell	
16	8/31/94	16	Maxwell	
17	8/31/94	17	Maxwell	
18	8/31/94	18	Maxwell	
19	8/31/94	19	Maxwell	
20	8/31/94	20	Maxwell	
21	8/31/94	21	Maxwell	
22	8/31/94	22	Maxwell	
23	8/31/94	23	Maxwell	
24	8/31/94	24	Maxwell	
25	8/31/94	25	Maxwell	
26	8/31/94	26	Maxwell	
27	8/31/94	27	Maxwell	
28	8/31/94	28	Maxwell	
29	8/31/94	29	Maxwell	
30	8/31/94	30	Maxwell	
31	8/31/94	31	Maxwell	
32	8/31/94	32	Maxwell	
33	8/31/94	33	Maxwell	
34	8/31/94	34	Maxwell	
35	8/31/94	35	Maxwell	
36	8/31/94	36	Maxwell	
37	8/31/94	37	Maxwell	
38	8/31/94	38	Maxwell	
39	8/31/94	39	Maxwell	
40	8/31/94	40	Maxwell	
41	8/31/94	41	Maxwell	
42	8/31/94	42	Maxwell	
43	8/31/94	43	Maxwell	
44	8/31/94	44	Maxwell	
45	8/31/94	45	Maxwell	
46	8/31/94	46	Maxwell	
47	8/31/94	47	Maxwell	
48	8/31/94	48	Maxwell	
49	8/31/94	49	Maxwell	
50	8/31/94	50	Maxwell	
51	8/31/94	51	Maxwell	
52	8/31/94	52	Maxwell	
53	8/31/94	53	Maxwell	
54	8/31/94	54	Maxwell	
55	8/31/94	55	Maxwell	
56	8/31/94	56	Maxwell	
57	8/31/94	57	Maxwell	
58	8/31/94	58	Maxwell	
59	8/31/94	59	Maxwell	
60	8/31/94	60	Maxwell	
61	8/31/94	61	Maxwell	
62	8/31/94	62	Maxwell	
63	8/31/94	63	Maxwell	
64	8/31/94	64	Maxwell	
65	8/31/94	65	Maxwell	
66	8/31/94	66	Maxwell	
67	8/31/94	67	Maxwell	
68	8/31/94	68	Maxwell	
69	8/31/94	69	Maxwell	
70	8/31/94	70	Maxwell	
71	8/31/94	71	Maxwell	
72	8/31/94	72	Maxwell	
73	8/31/94	73	Maxwell	
74	8/31/94	74	Maxwell	
75	8/31/94	75	Maxwell	
76	8/31/94	76	Maxwell	
77	8/31/94	77	Maxwell	
78	8/31/94	78	Maxwell	
79	8/31/94	79	Maxwell	
80	8/31/94	80	Maxwell	
81	8/31/94	81	Maxwell	
82	8/31/94	82	Maxwell	
83	8/31/94	83	Maxwell	
84	8/31/94	84	Maxwell	
85	8/31/94	85	Maxwell	
86	8/31/94	86	Maxwell	
87	8/31/94	87	Maxwell	
88	8/31/94	88	Maxwell	
89	8/31/94	89	Maxwell	
90	8/31/94	90	Maxwell	
91	8/31/94	91	Maxwell	
92	8/31/94	92	Maxwell	
93	8/31/94	93	Maxwell	
94	8/31/94	94	Maxwell	
95	8/31/94	95	Maxwell	
96	8/31/94	96	Maxwell	
97	8/31/94	97	Maxwell	
98	8/31/94	98	Maxwell	
99	8/31/94	99	Maxwell	
100	8/31/94	100	Maxwell	

SHEET INDEX

- 1 COVER SHEET
- 2 SITE PLAN
- 3 SLOPE MAP
- 4 OVERALL DRAINAGE MAP
- 5 FLOODPLAIN MAP
- 6 SITE GRADING PLAN
- 7 SITE DRAINAGE PLAN
- 8 STORM SEWER PLAN
- 9 POND LOCATIONS AND SLOPE MAP
- 10 WATER QUALITY POND AND DETAILS
- 11 WATER QUALITY POND AND DETAILS
- 12 EROSION/SEDIMENTATION CONTROL PLAN
- 13 GENERAL NOTES AND DETAILS

REVISIONS
DATE
BY
REASON
DATE
BY
REASON

REVISIONS
DATE
BY
REASON
DATE
BY
REASON

VINCENT GERARD & ASSOCIATES
LAND PLANNING CONSULTANTS
102 WESTLAKE DR. SUITE 100, AUSTIN, TEXAS
(512) 328-2883

UTLMANN & HARRIS, INC.
CONSULTING ENGINEERS
102 WESTLAKE DRIVE, SUITE 100, AUSTIN, TEXAS 78748
(512) 378-2186

8/5

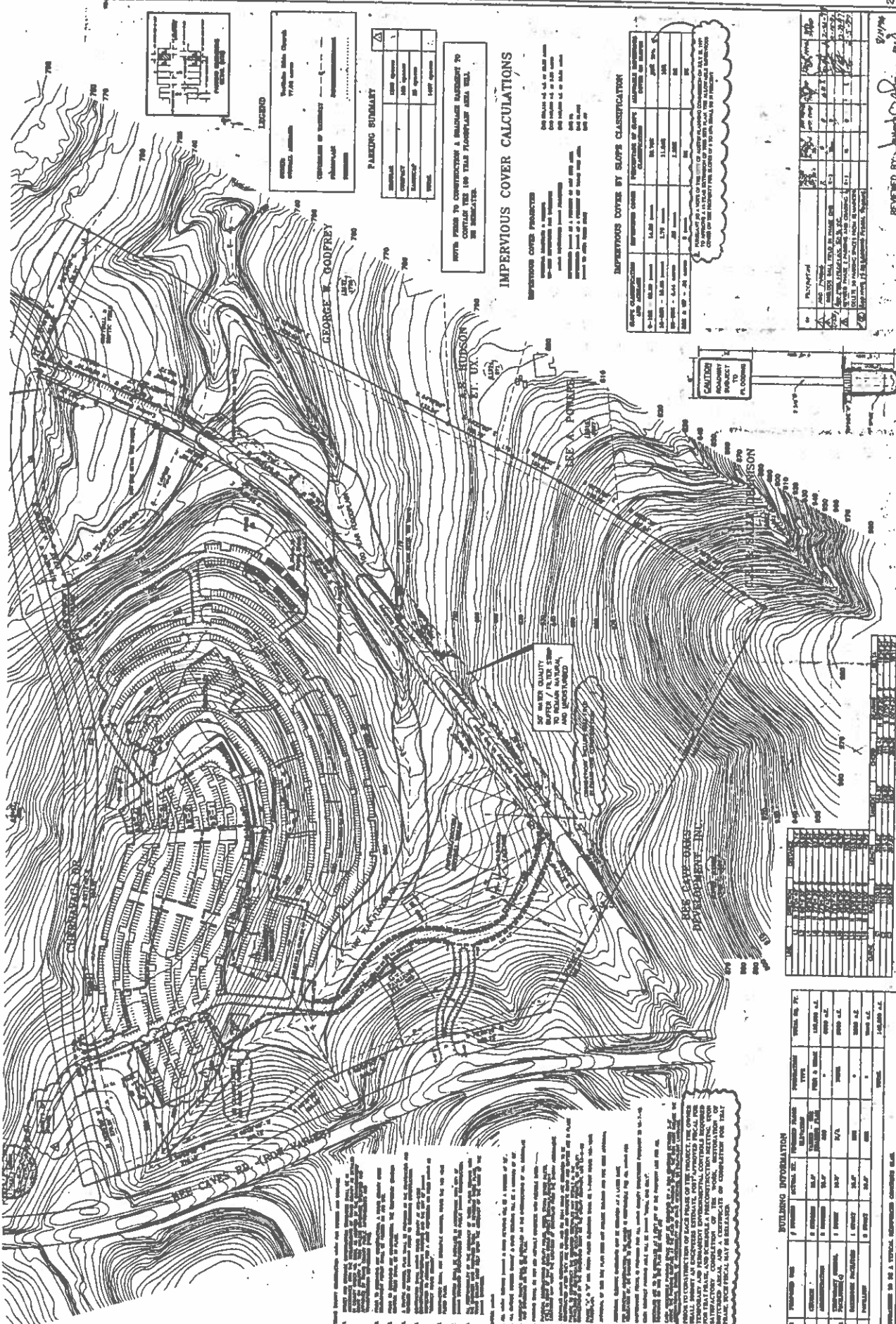
$\frac{C8}{6}$ 

PARKING SUMMARY		DATE	TIME
START	END		
START	END		
START	END		
START	END		

IMPERVIOUS COVER CALCULATIONS

TELEPHONE COVER PROTECTORS
Protects telephone & answers
up-to-100 messages for telephone
— with answering from 2000
minutes — 1st & 2nd
minutes — 1st & 2nd
minutes — 1st & 2nd
minutes — 1st & 2nd

[illegible]

IMPERVIOUS COVER BY SLOPE CLASSIFICATION

NO	PLANTING	DATE PLANTED	PLANT	NO.	DATE	PLANT	NO.	DATE	PLANT	NO.	DATE
1	PLANTING	1/1/19	PLANT	1	1/1/19	PLANT	1	1/1/19	PLANT	1	1/1/19
2	PLANTING	1/1/19	PLANT	2	1/1/19	PLANT	2	1/1/19	PLANT	2	1/1/19
3	PLANTING	1/1/19	PLANT	3	1/1/19	PLANT	3	1/1/19	PLANT	3	1/1/19
4	PLANTING	1/1/19	PLANT	4	1/1/19	PLANT	4	1/1/19	PLANT	4	1/1/19
5	PLANTING	1/1/19	PLANT	5	1/1/19	PLANT	5	1/1/19	PLANT	5	1/1/19
6	PLANTING	1/1/19	PLANT	6	1/1/19	PLANT	6	1/1/19	PLANT	6	1/1/19
7	PLANTING	1/1/19	PLANT	7	1/1/19	PLANT	7	1/1/19	PLANT	7	1/1/19
8	PLANTING	1/1/19	PLANT	8	1/1/19	PLANT	8	1/1/19	PLANT	8	1/1/19
9	PLANTING	1/1/19	PLANT	9	1/1/19	PLANT	9	1/1/19	PLANT	9	1/1/19
10	PLANTING	1/1/19	PLANT	10	1/1/19	PLANT	10	1/1/19	PLANT	10	1/1/19

REVIEWED BY: James C. Simpson
FOR THE DIRECTOR OF DEPARTMENT OF
1072

[illegible]

• **PROCESSES TO SET A TARGETED REVENUE GOALING PLAN**

COATS | ROSE

A Professional Corporation

C8
/x

JOHN M. JOSEPH

jmjoseph@coatsrose.com
Direct Dial
512.541.3593

April 5, 2013

Via Hand Delivery

Mr. Greg Guernsey
Planning and Development Review Department
505 Barton Springs Rd., 5th Floor
Austin, Texas 78704

Re: Request for Extension of Site Plan; Austin Ridge Bible Church (previously known as Westlake Bible Church) Site Plan; SP-93-0419D

Dear Mr. Guernsey:

This law firm represents Austin Ridge Bible Church, the owner of the property that is the subject of City of Austin Site Plan, Case Number SP-93-0419D ("Site Plan"), the cover sheet of which is attached for your convenience. This site plan was issued August 31, 1994 and on July 22, 1997, was extended by action of the Planning Commission to August 31, 2012. On December 21, 2012, the City of Austin approved a one-year administrative extension. The subject tract is located wholly in Travis County and the extra-territorial jurisdiction of the City of Austin.

I am writing to request to the Land Use Commission, pursuant to Section 25-5-63 of the City of Austin Land Development Code, for a 25-year extension of the Site Plan. Since the site plan approval, more than 50% of the improvements in that extended site plan have been completed and are occupied. Please see the attached colored sketch, which identifies the completed portions of the site improvements. Economic conditions have impacted Austin Ridge's ability to complete the balance of the improvements depicted in the Site Plan. Our client has made good faith and commercially reasonable efforts to achieve all of the goals of its project, and has not abandoned, and does not intend to abandon, its project. As you are aware, churches do not use the same mechanisms as developers for the financing of infrastructure. They often rely on charitable contributions and fund raising to generate funds for development projects. Therefore, we appreciate your anticipated support of the extension request as our client continues to diligently pursue completion of the Site Plan.

Barton Oaks Plaza, 901 South MoPac Expressway, Building 1 Suite 500, Austin, Texas 78746

Phone: 512-469-7987 Fax: 512-469-9408

Web: www.coatsrose.com

HOUSTON | CLEAR LAKE | AUSTIN | DALLAS | SAN ANTONIO | NEW ORLEANS
1765261.1/012232.000001

SCANNED

April 5, 2013
Page 2

08/8

Thank you for your immediate attention to this matter. If you need additional information, please contact me.

Sincerely,



John M. Joseph

cc: Pastor Bixby, Austin Ridge Bible Church
Don Sansum, Project Engineer

Attachment

SCANNED



08/19

October 1, 2012

Michael Simmons-Smith
Planning and Development Review Department
City of Austin
P.O. Box 1088
Austin, Texas 78767

Re: Westlake Bible Church
9238 Bee Cave Road (RM 2244)
COA File No. SP-93-0419D
Site Plan Extension Request - Engineer's Summary Letter
UDG Project No. 06-425.013

Dear Michael:

As the design engineer for the Westlake Bible Church, I have prepared this letter in accordance with the City of Austin's site plan requirements to describe the proposed development of the Church's property at 9238 Bee Cave Road.

Description of the Property

The Westlake Bible Church property consists of 77.1 acres and is located within the Lake Austin Watershed and the City of Austin's 2-mile Extraterritorial Jurisdiction (ETJ).

Description of Applicable Watershed Protection Regulations

The development of the property is subject to the City of Austin's Lake Austin Watershed Ordinance (See attached Chapter 245 Determination dated August 31, 2012).

Description of the Proposed Development of the Property

Existing Development

The Church has constructed religious assembly, education and administrative buildings; parking and drives; drainage and utility infrastructure; and recreational facilities on the property in accordance with its overall site plan (City of Austin File No. SP 93 0419D). The completed facilities (identified on the attached exhibit) represent more than 50% of the total proposed improvements.

Proposed Development

The Church proposes to continue the construction of the religious assembly and support buildings; parking and drives; drainage and utility infrastructure; and recreational facilities on the property as depicted on its overall site plan. As has been its practice since initiating construction in 1994, the Church will construct the remaining facilities in phases based on its needs and funding. In accordance with the City's requirements, the Church will continue to submit to the City for review and approval detailed construction plans identifying the limits of construction, temporary erosion controls, and permanent stabilization procedures for each subsequent phase.

WBC, Eng Summary Letter for Site Plan Extension Application, 10-01-12

Urban Design Group
3660 Stoneridge Road • Suite E101 • Austin • Texas • Tel. 512 347-0040 • Fax. 512 347-1311

SCANNED

C8
10

Description of Drainage Facilities

Existing Drainage Facilities

The Church submitted construction plans in 2008 to the City of Austin for a combination detention/wet pond to meet the City's requirements for stormwater detention and water quality controls for the entire site in lieu of the multiple sedimentation/filtration ponds shown on the Church's original site plan. In 2009, following the City's review and approval of the plans, the Church constructed the pond and a drainage channel for this purpose. The facilities have functioned since that time in accordance with the City's drainage criteria and water quality control requirements to: 1) result in no identifiable negative impact on downstream flooding; and 2) protect the natural and traditional character of the land and waterways.

Proposed Drainage Facilities

Subsequent building phases will include the construction of additional drainage facilities, consisting of inlets, swales and pipes, to collect and convey storm flows to the Church's combination detention/wet pond. These facilities will be included in the construction drawings for each phase submitted to the City for review and approval.

I hereby certify that this letter is correct and the accompanying plans for the Westlake Bible Church site plan are complete and in compliance with the applicable provisions of the City of Austin Land Development Code.

URBAN DESIGN GROUP

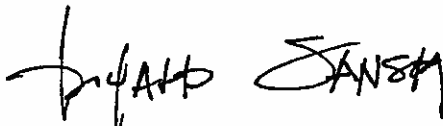
Donald Sansom, P.E.

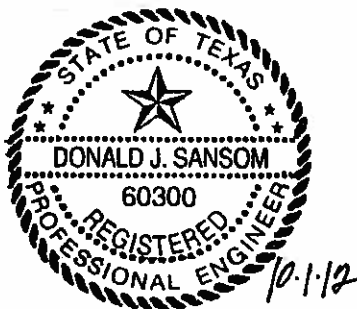

Attachments:

- Westlake Bible Church – Chapter 245 Determination issued by the City of Austin, August 31, 2012
- Westlake Bible Church – Overall Site Plan Exhibit

SCANNED

INTERESTED PARTY INFORMATION

Interested parties are specifically defined in section 25-1-131 of the City Code. To view the Code on-line, go to this link:
http://www.amlegal.com/austin_tx/.

Besides the applicant or owner listed in an application, a person can become an interested party if they communicate an interest to the City through the case manager and if they satisfy at least one of the following criteria: 1) they occupy a primary residence that is within 500 feet of the site of the proposed development; 2) they are the record owner of property within 500 feet of the site of the proposed development; or 3) they are an officer of an environmental or neighborhood organization that has an interest in the site of the proposed development or whose declared boundaries are within 500 feet of the site of the proposed development.

If a person satisfies the criteria to become an interested party, they must communicate an interest by either delivering a written statement to the Land Use Commission conducting the hearing or appearing and speaking for the record at the public hearing. A person may also provide a written statement to the Case Manager or by making telephone contact with the Case Manager. The communication must: 1) generally identify the issues of concern; 2) include the person's name, telephone phone number, and mailing address; and 3) if the communication is by telephone, be confirmed in writing.

Written comments concerning the site plan application may be submitted to the case manager on this form. Comments on a separate form should include the case number and the contact person listed on the notice.

Case Number: SP-93-0419D(XT2)

Contact: Christine Barton-Holmes, 512-974-2788 or
Rosemary Ramos, 512-974-2784

☒ I meet the requirements for and request to be an interested party

CHICK KOBELAN 512-328-1680

Name (please print)

ATWATER CIRCLE AUSTIN TX 78733 Telephone number

LOT 3 BLOCK B SEVEN CAYS SEC 2 PHS 2

Address(es) affected by this application (Street, City, ZIP Code)

8525 CALERA DRIVE AUSTIN TX 78735

Mailing address (Street, City, ZIP Code)

Signature

Date

Comments: MY LOT ADJAINS THIS

PROPERTY

Mail comment forms to:

City of Austin

Planning and Development Review Department

Attn: Christine Barton-Holmes

P. O. Box 1088

Austin, TX 78767-1088

8
11

INTERESTED PARTY INFORMATION

Interested parties are specifically defined in section 25-1-131 of the City Code. To view the Code on-line, go to this link:
http://www.amlegal.com/austin_tx/.

Besides the applicant or owner listed in an application, a person can become an interested party if they communicate an interest to the City through the case manager and if they satisfy at least one of the following criteria: 1) they occupy a primary residence that is within 500 feet of the site of the proposed development; 2) they are the record owner of property within 500 feet of the site of the proposed development; or 3) they are an officer of an environmental or neighborhood organization that has an interest in the site of the proposed development or whose declared boundaries are within 500 feet of the site of the proposed development.

If a person satisfies the criteria to become an interested party, they must communicate an interest by either delivering a written statement to the Land Use Commission conducting the hearing or appearing and speaking for the record at the public hearing. A person may also provide a written statement to the Case Manager or by making telephone contact with the Case Manager. The communication must: 1) generally identify the issues of concern; 2) include the person's name, telephone phone number, and mailing address; and 3) if the communication is by telephone, be confirmed in writing.

Written comments concerning the site plan application may be submitted to the case manager on this form. Comments on a separate form should include the case number and the contact person listed on the notice.

Case Number: SP-93-0419D(XT2)

Contact: Christine Barton-Holmes, 512-974-2788 or
Rosemary Ramos, 512-974-2784

☒ I meet the requirements for and request to be an interested party

Name (please print) SALLY DENNISON Telephone number 512/263-9608

149 N. Tomblewood Trl, Austin, 78733
Address(es) affected by this application (Street, City, ZIP Code)

Same

Mailing address (Street, City, ZIP Code)

Sally Dennison 4/30/2013
Signature Date

Comments: I'm concerned about lights
at night, noise (especially on Sunday
mornings), and trespassers from
community parks.

Mail comment forms to:

City of Austin

Planning and Development Review Department

Attn: Christine Barton-Holmes

P. O. Box 1088

Austin, TX 78767-1088

C8
12