

DATE of SUBMISSION: 8/27/2013



# Application for Certificate of Appropriateness for a City Landmark or Local Historic District

Adopted December 2012

 RECEIVED  
 AUG 26 2013  
 01072013
**Permit Information**

For Office Use Only	BP- _____ PR- _____ C14H/LHD - _____
	Property Name or LHD: _____ Contributing/Non-contributing _____
	<input type="checkbox"/> RELEASE PERMIT <input type="checkbox"/> DO NOT RELEASE PERMIT <input type="checkbox"/> HLC REVIEW _____         FEE PAID: \$ <u>Waived</u>
	HISTORIC PRESERVATION OFFICE _____ DATE: _____

**Property Information**

Address: 2310 San Gabriel Street, Austin, Texas 78705

**Scope of Work**

Over the years the limestone walks leading to the front and back of the house have become uneven and unsafe. The plan is to remove the existing and historical limestone, number and save the stones. A sound foundation will be prepared and then the saved stones will be replaced in the order in which they were originally laid.

**Applicant**

Name: The National Society of The Colonial Dames of America in the State of Texas

Address: 2310 San Gabriel Street

City/Zip: Austin, TX 78705

Phone: Contact: Victoria Bradshaw, President of the Society at 214-384-1180 or Shella Brenner, Chm. Grants Commit

Email: vpirwin@sbcglobal.net or brennercom@att.net

**Owner**

Name: The National Society of The Colonial Dames of America in the State of Texas

Address: 2310 San Gabriel Street

City/Zip: Austin, TX 78705

Phone: Contact: Victoria Bradshaw, President of the Society at 214-384-1180 or Shella Brenner, Chm. Grants Commit

Email: vpirwin@sbcglobal.net or brennercom@att.net

**Architect or Contractor Information**

Company: Carolyn Kelley, ASLA

Address: 2905 Oak Crest Avenue

City/Zip: Austin, TX 78704

Phone: 512-445-0431

Victoria Bradshaw (Mrs. Maxwell E.) 8/22/13     
 Victoria Bradshaw (Mrs. Maxwell E.) 8/22/13  
 Owner's Signature      Date      Applicant's Signature      Date

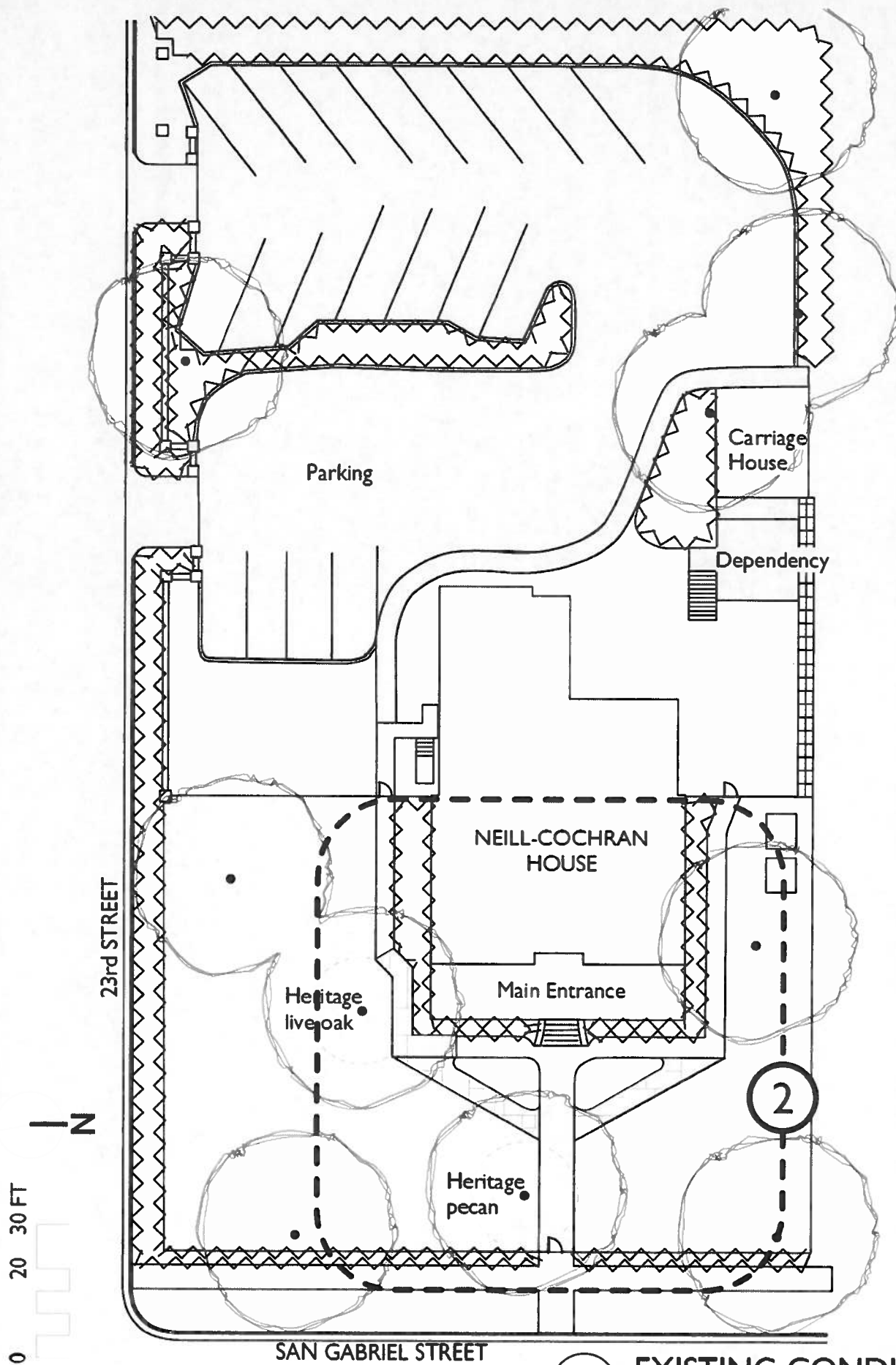

**EXISTING CONDITIONS**  
Scale: 1" = 30 ft

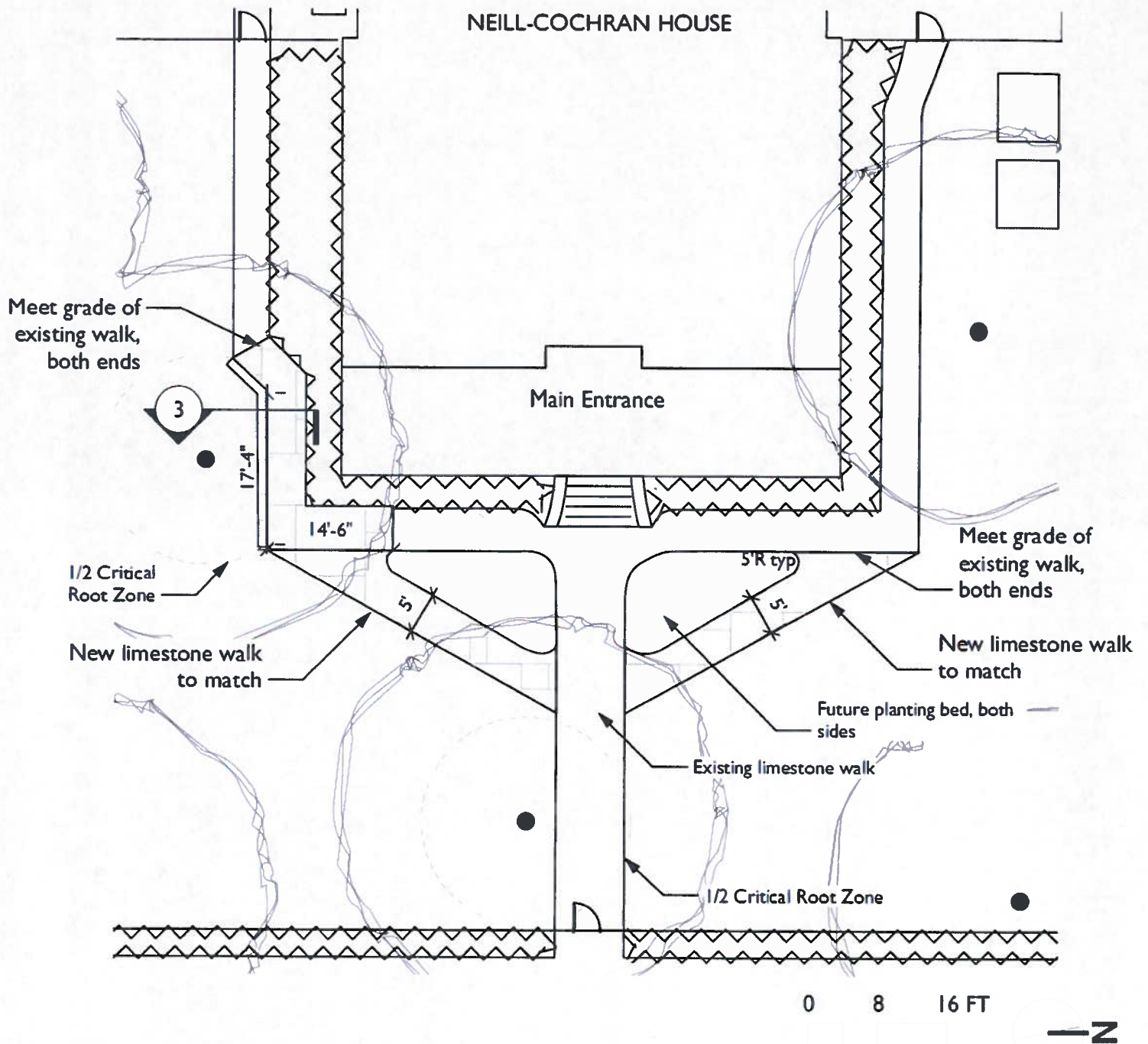

7-28-2013

Carolyn Kelley, ASLA  
Landscape Architect

512.445.0431  
512.857.1342 fax  
carolyn@clda.net



2 LANDSCAPE PLAN  
Scale: 1/16" = 1'-0"



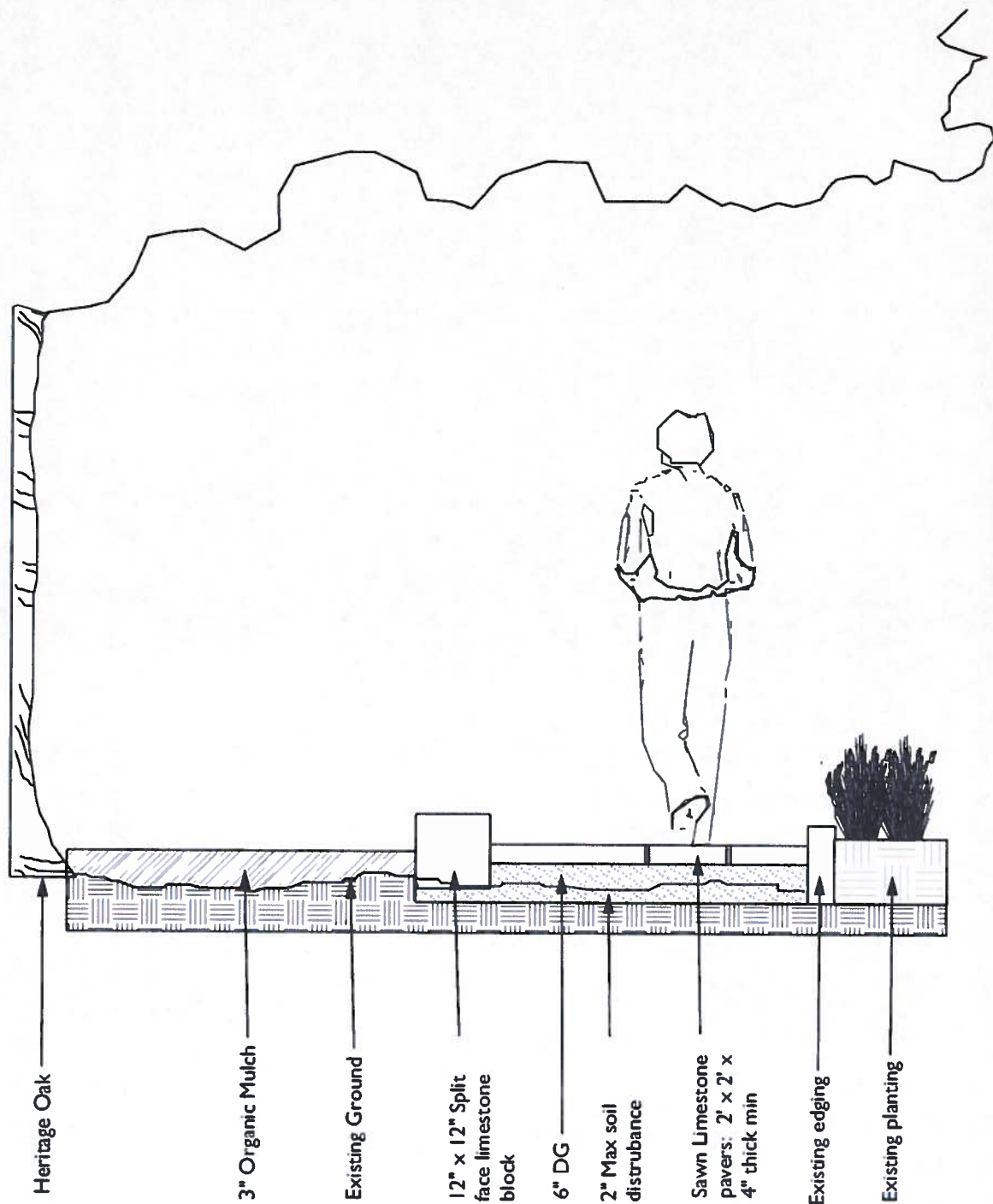

7-28-2013

Carolyn Kelley, ASLA  
Landscape Architect

512.445.0431  
512.857.1342 fax  
carolyn@ckla.net



3

## WALK DETAIL

Scale: 1/2" = 1'-0"

**DESCRIPTION OF PROJECT**  
**NATIONAL SOCIETY OF THE COLONIAL DAMES OF AMERICA IN THE STATE OF TEXAS**  
**NEILL-COCHRAN HOUSE/SIDEWALK RESTORATION AND IMPROVEMENTS**

In 2010, the Neill-Cochran House began an extensive renovation to the interior and exterior of the home to stabilize the home and increase the use of the home for rentals, seminars and educational programs. Beginning with a foundation excavation and stabilization, lintel replacements, exterior stone and interior structure preservation, the property is now significantly increasing its rentals for events and now needs to address installing a safer, increased compliant stone walkway/sidewalk around the side and front of the structure. This has now become a priority. The original sidewalk is now over 100 years old and in need of replacement, not only from a liability standpoint, but also to enhance the property's ease of access to visitors. Although the house is currently compliant with Texas Accessibility Standards by having the required "Accessible Route," to a building entry (the parking lot path to a wheelchair lift at the building addition entrance, the front walks will require the removal and re-set of stone so that no vertical rise shall exceed  $\frac{1}{4}$ ".

As much of the original stone as possible will try to be salvaged but a great deal of new stone will be required to ensure the safety of the surface level for those walking around the property. Since the property is a designated landmark with heritage trees on the property, much care will be taken to ensure the integrity of the trees while installing pathways to resemble the original. Carolyn Kelly, an Austin landscape architect, has agreed to donate her time to design the walkway in keeping with the original style, while also incorporating the pathways into a master plan to create a Victorian garden much like the one that existed in the late 1800s and early 1900s. The first phase of the project is the stone sidewalk.

In keeping with the requirements of the Austin Convention & Visitors Bureau Heritage Grant program, we have included the addition of an etched or inlaid metal stone at the joining of the pathways to commemorate the contribution by the ACVB should the this grant request be accepted.

As this home is an Abner Cook in its truest form, it is important to protect this home while also making it more accessible for the general public and continue to increase event revenue potential.

**TOURISM JUSTIFICATION**  
**NATIONAL SOCIETY OF THE COLONIAL DAMES OF AMERICA IN THE STATE OF TEXAS**  
**NEILL-COCHRAN HOUSE/SIDEWALK RESTORATION AND IMPROVEMENTS**

The National Society of the Colonial Dames of America in the State of Texas (NSCDA-TX) was established in 1898. The NSCDA actively promotes the national heritage of the United States through historic preservation, patriotic service and educational projects. The NSCDA-TX purchased the Neill-Cochran House in 1958. This historic property has served as the headquarters for the organization's statewide initiative for over 50 years. Located near the University of Texas campus, the house officially opened as a public museum in 1962 after collecting significant period furnishings and other historic and cultural objects, which formed the basis for its current humanities collection.

Additional activities of the NSCDA-TX members include an annual scholarship to a Texas graduate student studying American history; annual sponsorship of an essay writing contest for high school students to attend a one-week workshop seminar in Washington, D.C.; and a scholarship for a Native American to attend nursing school. Society members also organize and sponsor annual flag programs, attend naturalization ceremonies to greet new citizens and promote broader recognition of the Bill of Rights Day. Additionally, NSCDA-TX also assists with the publication of historically significant books, the preservation of paintings, manuscripts and buildings connected with the early history of the United States, Texas and Austin.

In 2012, the Neill-Cochran received 3,975 visitors, not including event attendees and scholars and researchers who access the archives maintained at the house. The house is open five days-a-week, currently has two employees and 39 active volunteers.

Since it's official opening to the public in 1962, the home has provided "Austinites" and visitors to Austin an example of Cook's interpretation of Greek Revival style, a venue for events, educational programs such as the "Modern Times" lecture series and access for scholars and researchers to historical documents that are being archived at the house. Recently, the home has provided preservation architects working on the reconstruction of the Governor's Mansion, a true sense of what the mansion would have looked like in the mid-1800s as the Neill-Cochran is the same footprint as the Mansion prior to the fire – only 10% smaller.

In the attached Sponsorship Book for 2013, you will find some interesting historic references to the home, references to previous occupants and prior uses of the home.

The organization is actively involved in promoting Austin and other sites throughout the area. A visitor's board includes brochures from most major venues, activities and promotional materials for other historical organizations.













