

HISTORIC LANDMARK COMMISSION
NOVEMBER 18, 2013
DEMOLITION AND RELOCATION PERMITS
HDP-2013-0811
800 BOULDIN AVENUE

PROPOSAL

Demolish a ca. 1956 duplex.

ARCHITECTURE

Two-story, rectangular-plan, side-gabled, frame duplex with a partial-width double-level inset porch on plain, square wood posts and with a plain railing; the ground floor has a stone veneer; single and paired 1:1 fenestration; standing-seam metal roof.

RESEARCH

The duplex was built in 1956 by Phillip A. Carlson, a local developer; J. Preston and Ethel Riddle are listed as the occupants of unit "B" and the owners in the 1958 city directory, the first time the address appears, however, in later directories, the Riddles are listed as renters. The duplex had a relatively high turnover rate – after the Riddles' occupancy for approximately 8 years, the next longest tenancy was that of Raymond and Joyce Mitchell, who lived here through the 1970s. Raymond Mitchell was an engineering aide for the U.S. Geological Survey. Other tenants have included a television repairman, the office manager for an oral surgeon's office, and employees of Page-Southerland-Page.

STAFF COMMENTS

The house does not appear in any City survey.

STAFF RECOMMENDATION

Release the permit after completion of a City documentation package consisting of photographs of all elevations, a dimensioned sketch plan, and a narrative history for archiving at the Austin History Center. The house has neither the architectural nor the historical significance to warrant individual designation as a historic landmark.

LOCATION MAP

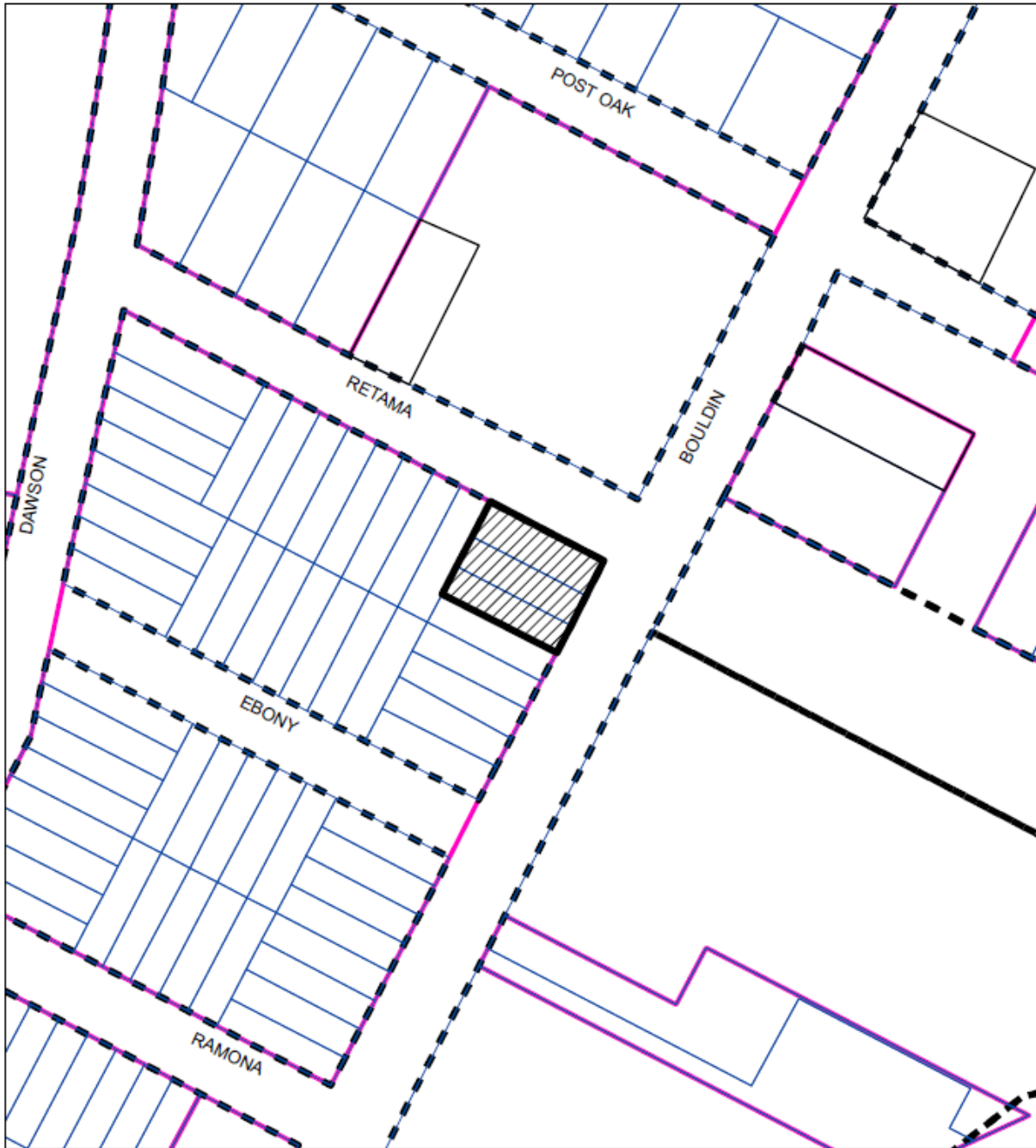

SUBJECT TRACT
ZONING BOUNDARY

CASE#: HDP-2013-0811
LOCATION: 800 Bouldin Avenue



This product is for informational purposes and may not have been prepared for or be suitable for legal, engineering, or surveying purposes. It does not represent an on-the-ground survey and represents only the approximate relative location of property boundaries.

This product has been produced by the Planning and Development Review Department for the sole purpose of geographic reference. No warranty is made by the City of Austin regarding specific accuracy or completeness.

800 Bouldin Avenue
ca. 1956



OCCUPANCY HISTORY 800 Bouldin Avenue

City Directory Research, Austin History Center
By City Historic Preservation Office
October, 2013

- | | | |
|---------|----|---|
| 1992 | A: | Frank Logan, renter
No occupation listed |
| | B: | David Zuefeldt, renter
No occupation listed |
| 1985-86 | A: | J. David and Susan Ashton, renters
Engineer, Page-Southerland-Page, architects and engineers, 606 West Avenue. |
| | B: | Pam Kelley, renter
Executive assistant, Page-Southerland-Page, architects and engineers, 606 West Avenue. |
| 1981 | A: | No return |
| | B: | No return |
| 1977 | A: | Mary P. Bender, renter
Widow, Thomas Bender
Office manager, Fricke, Fason & Cunningham, oral surgeons, 1301 W. 38 th Street. |
| | B: | Raymond N. and Joyce Mitchell, owners |

Hydraulic technician, U.S. Geological Survey

- 1973 A: Joseph and Barbara Abet, renters
No occupation listed
NOTE: The directory indicates that Joseph and Barbara Abet were new residents at this address.
B: Raymond N. and Joyce Mitchell, owners
Engineering aide, U.S. Geological Survey
- 1968 A: Travis A. and Cheryl Koehler, renters
No occupation listed
B: Fred and Lois Dailey, renters
Television repairman
- 1962 A: Thomas and Susie Seekatz, owners
Proprietor (with Roy E. Seekatz), Capitol Laundry and Dry Cleaning,
Barton Springs Road.
B: J.P. and Ethel E. Riddle, renters
No occupation listed
- 1959 A: Louie M. and Janet White, renters
Accountant, Telephone Company
B: J.P. and Ethel E. Riddle, renters
No occupation listed
- 1958 A: R.H. and Edith Butler, renters
No occupation listed
B: J.P. and Ethel E. Riddle, owners
No occupation listed
- 1957 The address is not listed in the directory.

Phillip A. Carlson 800 A-B Bouldin Ave.
113 7, 8 & N 21' of 6 3
Arboles Est.
2 sty. duplex with Att. Carport
62630 1-11-55 \$12,000.00
Logan Melton 10

Building permit to Phillip A. Carlson for the construction of the duplex (1955) but it could be a typographical error – all other data points to a 1956 construction date.

WATER SERVICE PERMIT
Austin, Texas

E No. 9774
INDEXED

Received of LOGAN MELTON Date 3-16-56
 Address 800 BOULDER AVE APT. D
 Amount TWENTY & NO/100 \$ 20
 Plumber ACME PLOG Size of Tap 3/4"

Date of Connection 3-3-56
 Size of Tap Made _____
 Size Service Made _____
 Size Main Tapped _____
 From Front Prop. Line to Curb Cock _____
 From Prop. Line to Curb Cock _____
 Location of Meter _____
 Type of Box _____
 Depth of Main in St. _____
 Depth of Service Line _____
 From Curb Cock to Tap on Main _____
 Checked by Engr. Dept. 5-11-56/aw

No. Fittings	Size
Corp. Cock	
Elbow	
St. Elbow	
Bushing	
Reducer	
Pipe	
Lead Comp.	
Nipples	
Union	
Plug	
Tee	
Stop	
Box	
Lid	
Valves	
Job No.	
Req. No.	

CHANGED TO 60' MAIN AND RENEWED SERVICE WITH 3/4" COPPER ON 700 - 5244

5-11-56/aw

Water service permit for this address (1956)

SANITARY SEWER SERVICE PERMIT
Austin, Texas

No. 36691

Received of None Date 3-16-56
 Address 800 Boulder Ave.
 Amount _____ \$ _____
 Builder or Owner Logan Milton Plumber _____
 Lot 7.8 N.W. 21' of 6 Block 3 Subdivision Acubides lot. Plat No. 113

Date of Connection 4-12-56
 By City 2' N/S/L
 By Plumber _____
 Checked By Lurcker
 Size Main 6" Depth 4'
 Main Assign. 10' E/E E
 Stub Depth _____ Prop. Line 2'
 Stub Location _____
 Book No. B-1009
 Paving Cut _____ No. _____

No. Fittings	Size	Price
39' Pipe	6" Conc.	8.58
Pipe		
Wyes		
1 Bends		1.10
Reducers		
Plugs		
Sand		
Gravel		
Remix		
Stoppers		
1 - <u>Overage</u> <u>for Trench</u>		5.00
10 lbs Other <u>Carriage</u> <u>1 lb each</u>		8.00
1 - <u>Taps</u>		.75
Labor: <u>48 hrs</u>		59.04
<u>1 da.</u>		1.90
		79.87

Sewer service permit for this address (1956)

BIOGRAPHICAL NOTES

J.P[reston] and Ethel E. Riddle (ca. 1956 – ca. 1965)

John P[reston]. and Ethel E. Riddle appear in the 1940 U.S. Census as the renters of a house at 1909 Eva Street in Austin. John P. Riddle was then 56, had been born in Texas, and was a mason employed in building construction. Ethel E. Riddle was then 53, had been born in Texas, and had no occupation listed. With them lived their two children: Emma Lou, 18, a café waitress; and J.P., 15. Both had been born in Texas. In addition, Louis Riddle, 32, and his wife, Catherine, 29, also lived in the house. Louis Riddle was a laborer at the City water plant; Catherine Riddle was a cook at the city hospital. Both had been born in Texas.

JOHN PRESTON RIDDLE

John Preston Riddle, 83, of 905 Retama, died Monday night in a local hospital. A 20-year resident of Austin, Riddle was a retired farmer. He was a member of Congress Avenue Baptist Church.

Survivors include his wife, Mrs. Ethel Riddle of Austin; four daughters, Mrs. Nancy Carlson of Austin, Mrs. Aleene Heallen of Houston, Mrs. Emma Lou Stanley of Nevada, Mrs. Ethel Marie Goldsburg of El Paso; two sons, Hulon Riddle of Roswell, New Mexico, and J. P. Riddle of Richardson; three sisters, Mrs. Sarah Close of Long Beach, Calif., Mrs. Mattie Kirchoff of Santa Monica, Calif., Mrs. Pearl Prichett of Lockney; and two brothers, Paul Riddle of Coleman and Charlie Riddle of Damascus, Ark.

Funeral will be Wednesday at 5 p.m. in the Chapel of the Wilke-Clay Funeral Home with Rev. Gordon Bays of Congress Avenue Baptist Church officiating.

Pallbearers will be David Heallen, James R. Amelang, Phillip Carlson, John George, and G. L. Anderson and John Caldemore.

Burial will be in Oak Hill Cemetery.

Obituary of J.P. Riddle
Austin American, August 9, 1967

Ethel Riddle

Ethel Riddle, age 99, of Austin, passed away Saturday.

Mrs. Riddle was preceded in death by her husband and one son, Hulon Riddle.

Survivors include: son, J.P. Riddle, Richardson; daughters, Nancy Carlson, Austin, Aleene Heallen, Houston, Emma Lou Starley, Reno, Nevada,

Ethel Marie Eubanks, TRC, New Mexico; two sisters, Luella Abmas, Myrtle Hall, both of Austin; ten grandchildren; numerous great-grandchildren and great-great-grandchildren.

Visitation, 7:00 PM till 8:00 PM, Monday at Wilke-Amey-Clay Funeral Home. Graveside services 10:30 AM, Tuesday. Burial, Austin Memorial Park, with Reverend Chester Jones officiating.

Services under the direction of Wilke-Amey-Clay Funeral Home.

~~Small Text~~

Obituary of Ethel Riddle
Austin American-Statesman, July 20, 1987