

## Late Backup

ORDINANCE NO. \_\_\_\_\_

1 AN ORDINANCE AMENDING ORDINANCE NO. 040826-056, WHICH  
2 ADOPTED THE CENTAL AUSTIN COMBINED NEIGHBORHOOD PLAN AS  
3 AN ELEMENT OF THE IMAGINE AUSTIN COMPREHENSIVE PLAN, TO  
4 CHANGE THE LAND USE DESIGNATION ON THE FUTURE LAND USE MAP  
5 FOR PROPERTY LOCATED AT 710 EAST 41<sup>ST</sup> STREET.

6  
7 BE IT ORDAINED BY THE CITY COUNCIL OF THE CITY OF AUSTIN:

8  
9 PART 1. Ordinance No. 040826-056 adopted the Central Austin Combined  
10 Neighborhood Plan as an element of the Imagine Austin Comprehensive Plan.

11 PART 2. Ordinance No. 040826-056 is amended to change the land use designation  
12 from civic use to mixed use for the portion of the property located at 710 East 41<sup>st</sup> Street  
13 and identified as Tracts 1, 1a and 2 on the future land use map attached as Exhibit "A"  
14 and incorporated in this ordinance, and described in File NPA-2013-0019.01 at the  
15 Planning and Development Review Department.

16 PART 3. This ordinance takes effect on \_\_\_\_\_, 2014.

17 PASSED AND APPROVED

§

§

\_\_\_\_\_, 2014 §

22 Lee Leffingwell  
23 Mayor

24  
25  
26 APPROVED:

27 Karen M. Kennard  
28 City Attorney

ATTEST: \_\_\_\_\_

Jannette S. Goodall  
City Clerk

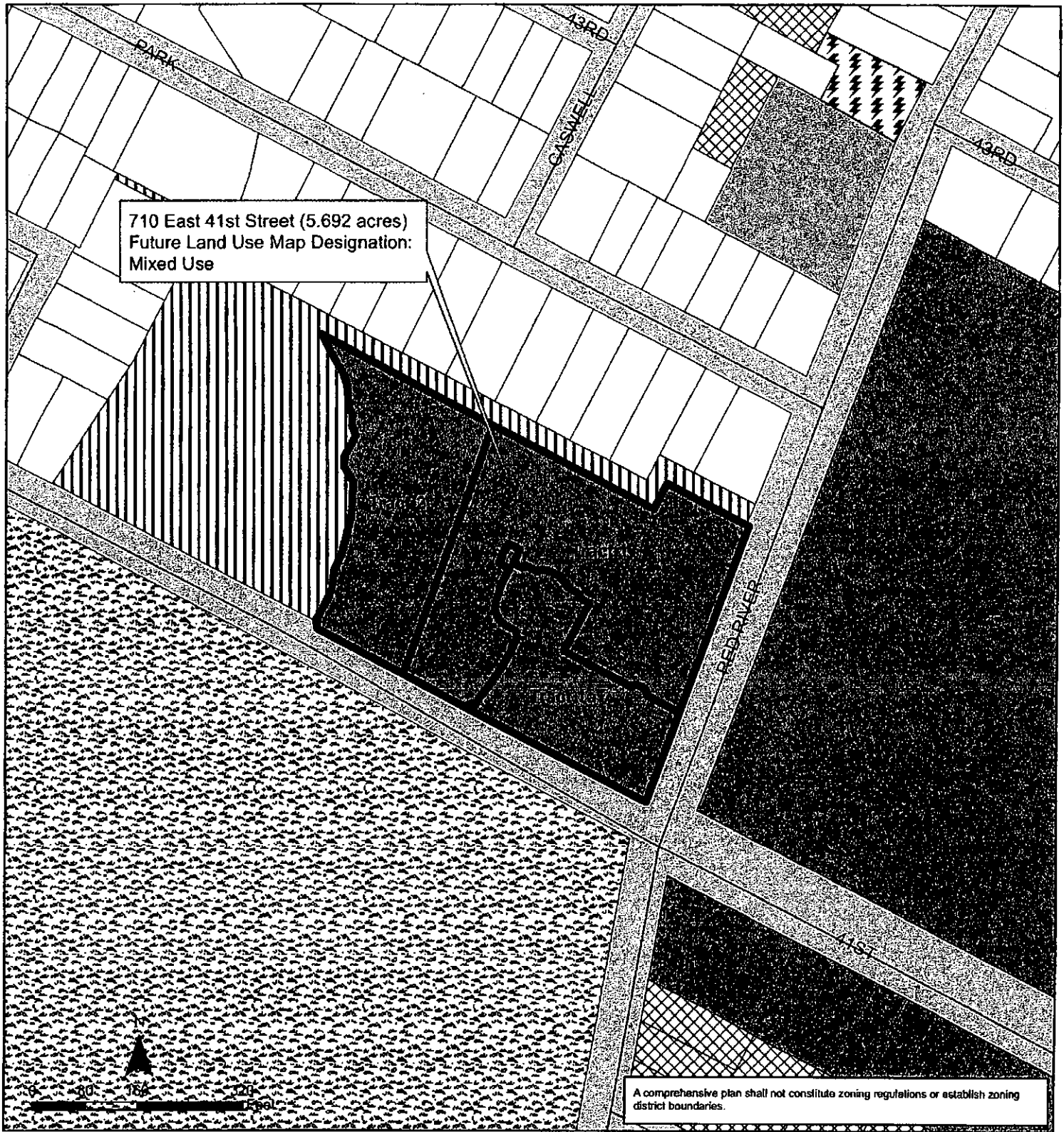

## Central Austin Combined Neighborhood Planning Area NPA-2013-0019.01

### "Exhibit A"

This product is for informational purposes and may not have been prepared for or be suitable for legal, engineering, or surveying purposes. It does not represent an on-the-ground survey and represents only the approximate relative location of property boundaries.

This product has been produced by the Planning and Development Review for the sole purpose of geographic reference. No warranty is made by the City of Austin regarding specific accuracy or completeness.



City of Austin  
Planning and Development Review Department  
Created on 11/20/2013. by: meredithm

### Future Land Use

	Single-Family		Mixed Use/Office
	Multi-Family		Civic
	Neighborhood Mixed Use		Recreation & Open Space
	Mixed Use		Transportation