

TOWN LAKE METROPOLITAN PARK

Auditorium Shores Improvements - Off-Leash Area

Waterfront Planning Advisory

MARCH 10, 2014



OVERALL CONTEXT AERIAL

AUDITORIUM SHORES IMPROVEMENTS - Off-Leash Area

MARCH 10, 2014

The information shown is based on the best information available and is subject to change without notice.



OVERALL SITE PLAN

AUDITORIUM SHORES IMPROVEMENTS - Off-Leash Area

MARCH 10, 2014

The information shown is based on the best information available and is subject to change without notice.

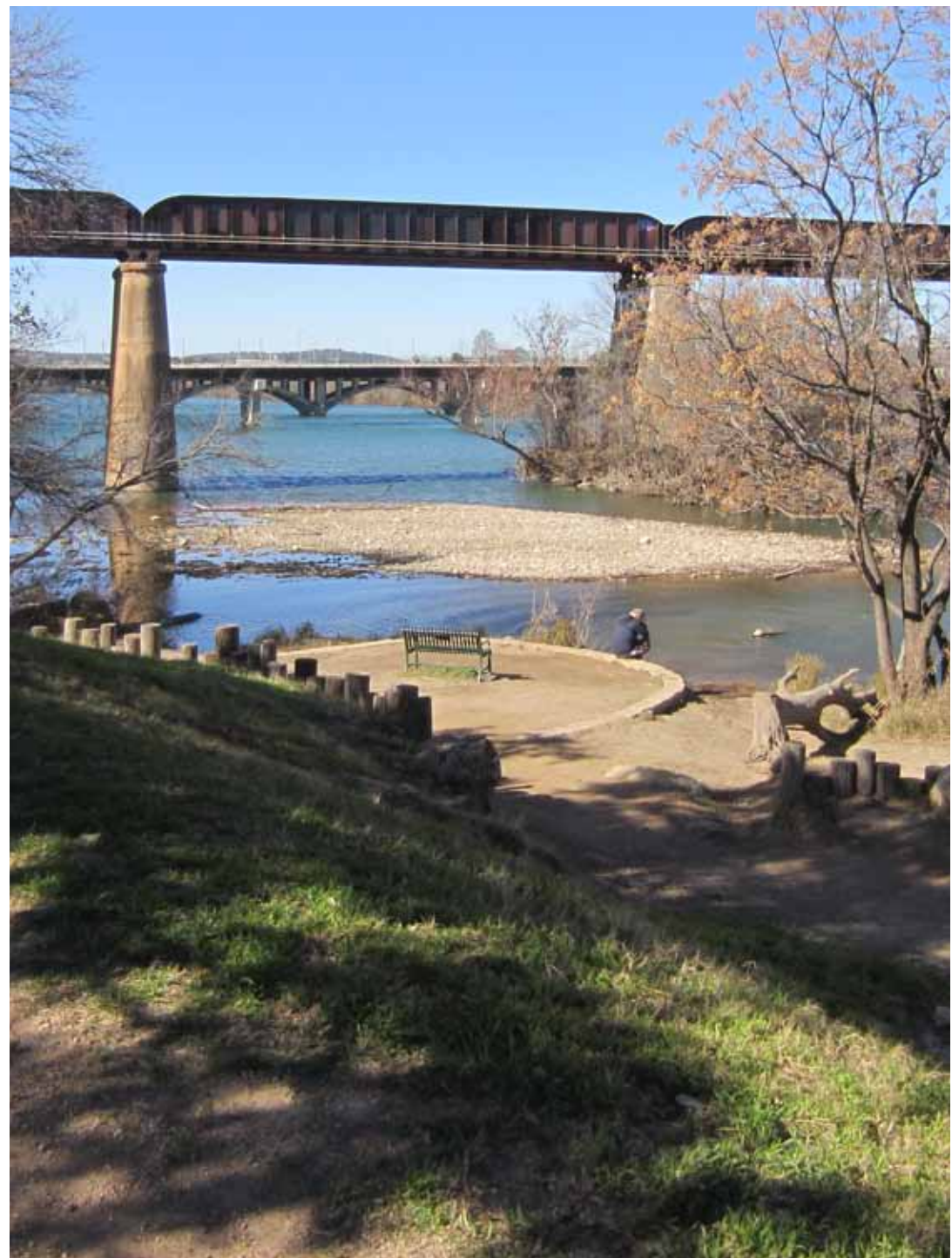
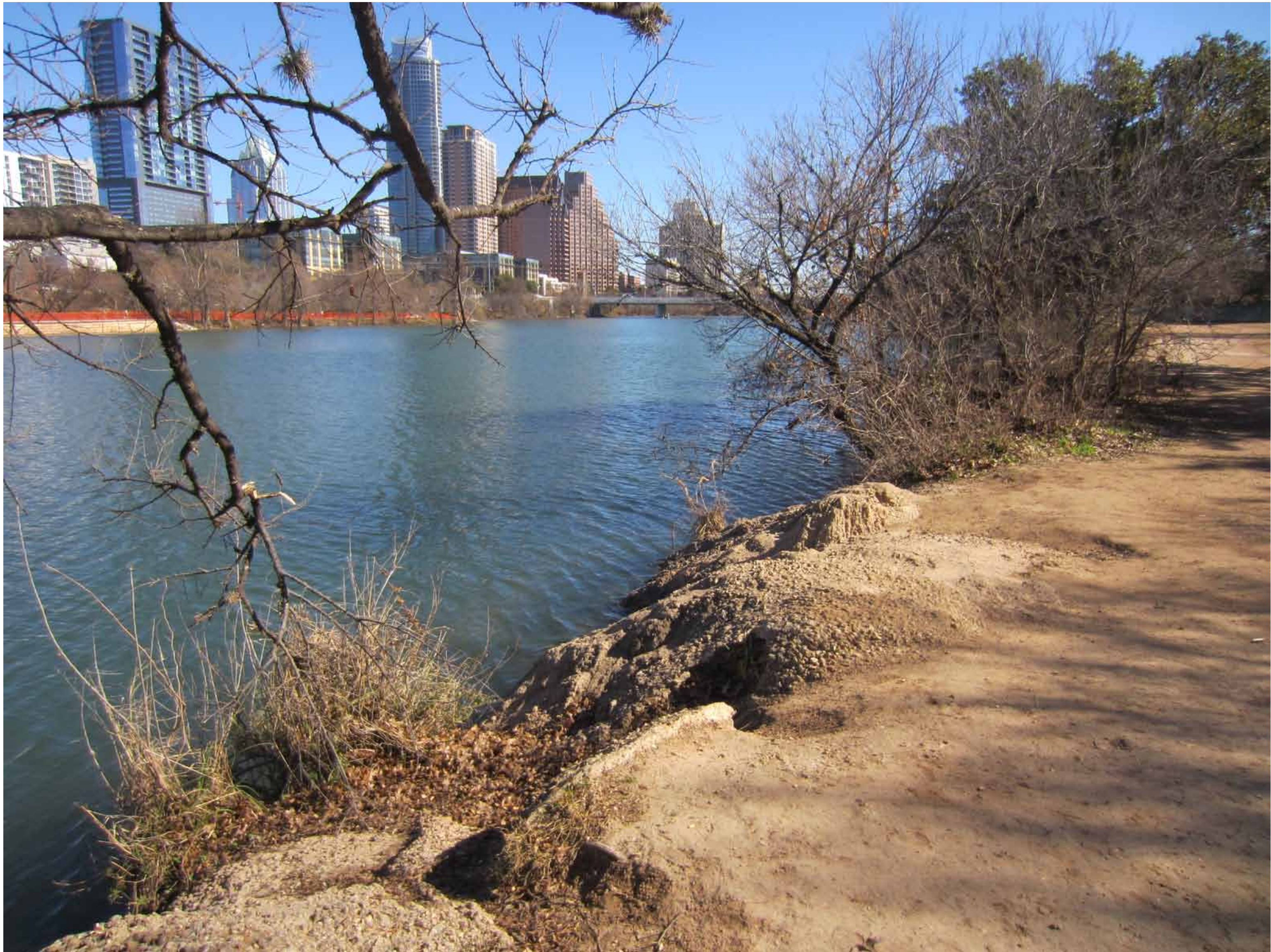

OFF-LEASH AREA EXISTING CONDITIONS

AUDITORIUM SHORES IMPROVEMENTS - Off-Leash Area

MARCH 10, 2014

The information shown is based on the best information available and is subject to change without notice.

PROJECT AMENITIES

- 4.7 Acres of open space
- Approx. 860 LF unobstructed run areas
- Approx. 215 LF unobstructed water access



REVISED OFF-LEASH AREA SCHEMATIC - 4.7 ACRES

AUDITORIUM SHORES IMPROVEMENTS - Off-Leash Area

MARCH 10, 2014

The information shown is based on the best information available and is subject to change without notice.

LADY BIRD
LAKE

ELEVATION - Split Rail Barrier Fence Option (N.T.S.)



ELEVATION - Cable Barrier Fence Option (N.T.S.)

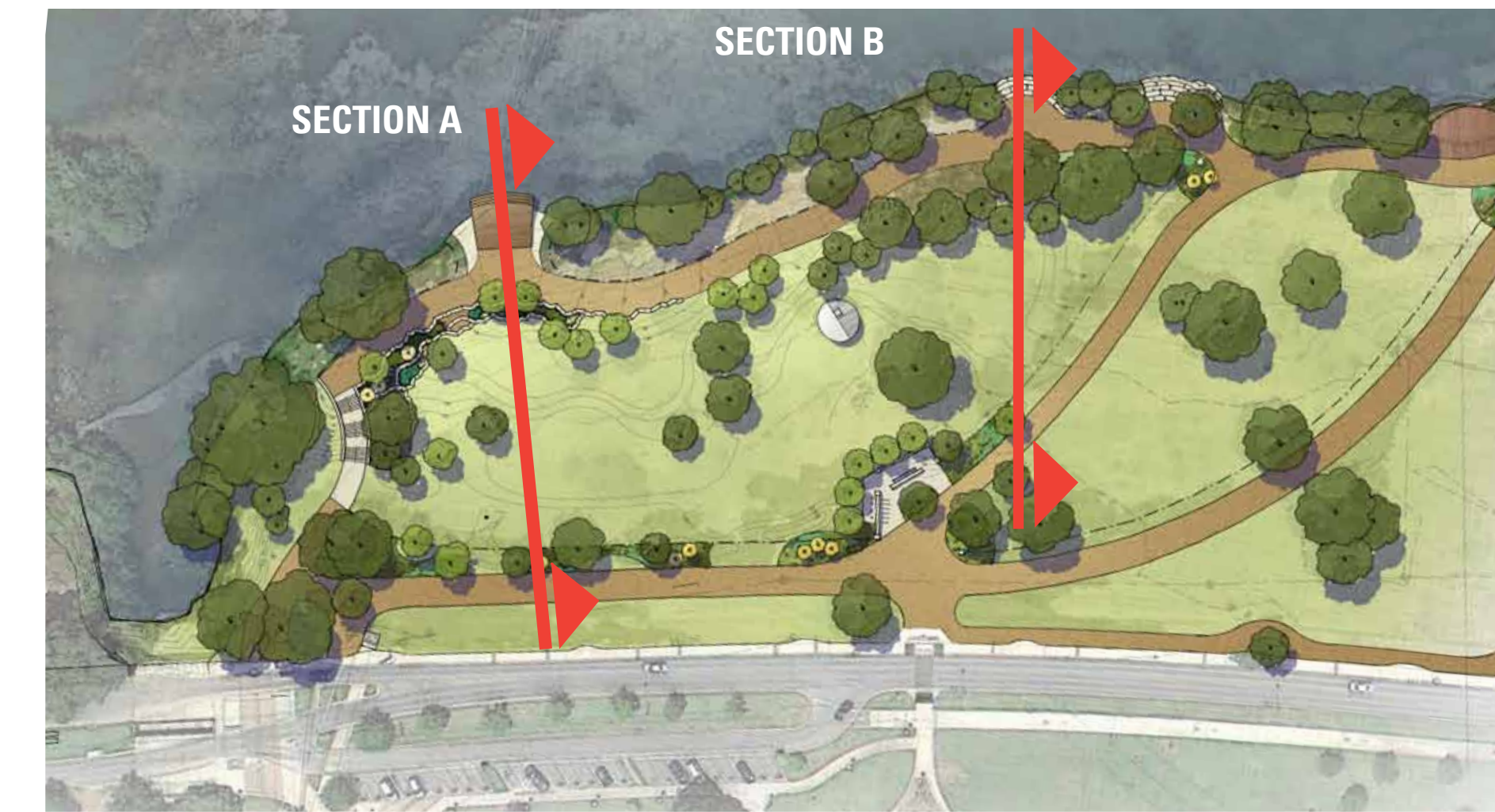

D.G
TRAIL

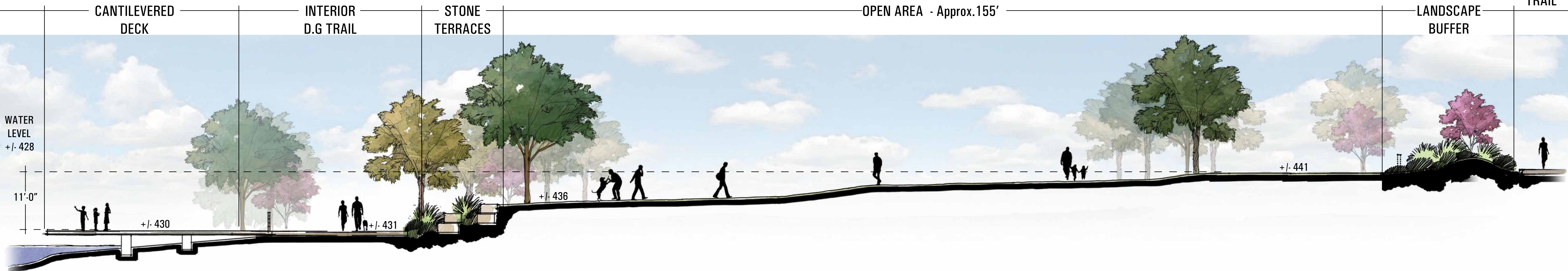

SECTION A

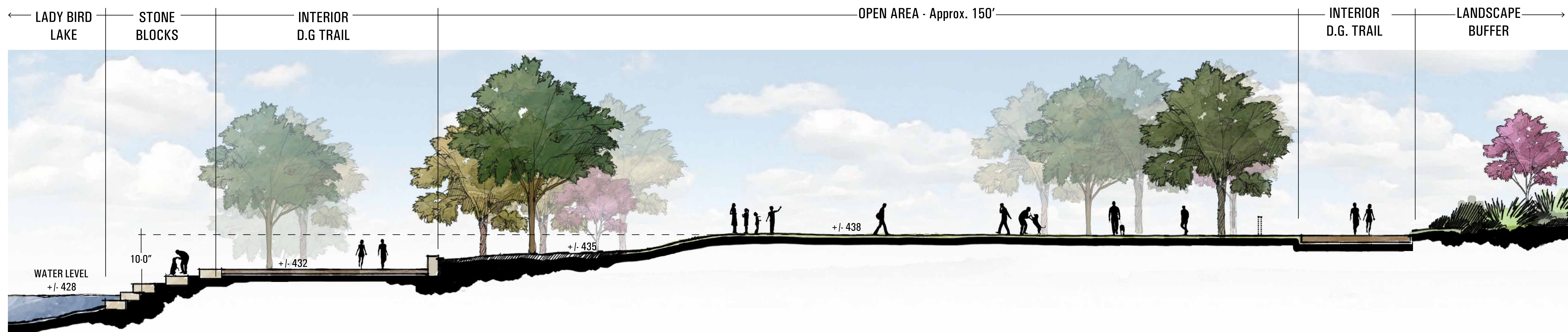

SITE SECTIONS

AUDITORIUM SHORES IMPROVEMENTS - Off-Leash Area

MARCH 10, 2014

The information shown is based on the best information available and is subject to change without notice.



FUTURE PARK AMENITIES

AUDITORIUM SHORES IMPROVEMENTS - Off-Leash Area

MARCH 10, 2014

The information shown is based on the best information available and is subject to change without notice.



QUESTIONS?

Waterfront Planning Advisory

FEBRUARY 25, 2014