

C15-2014-0028

Travis CAD - Map of Property ID 379078 for Year 2013



Property Details

Account

Property ID: 379078
Geo ID: 0268130303
Type: Real

Legal Description: LOT 2 BLK A HIDDEN ESTATES PHS 2

Location

Situs Address: 3707 HIDDEN ESTATES DR TX 78727
Neighborhood: VT544
Mapsc0: 466A
Jurisdictions: 0A, 01, 02, 03, 21, 68

Owner

Owner Name: LEPORE DANIEL H & LYNN P
Mailing Address: , 3707 HIDDEN ESTATES DR, , AUSTIN, TX 78727-1828

Property

Appraised Value: \$641,478.00

<http://propaccess.traviscad.org/Map/View/Map/1/379078/2013>

powered by
PropertyACCESS
www.trucanautomation.com

Map Disclaimer: This tax map was compiled solely for the use of TCAD. Areas depicted by these digital products are approximate, and are not necessarily accurate to mapping, surveying or engineering standards. Conclusions drawn from this information are the responsibility of the user. The TCAD makes no claims, promises or guarantees about the accuracy, completeness or adequacy of this information and expressly disclaims liability for any errors and omissions. The mapped data does not constitute a legal document.

C15-2014-0028

PLOT VIEW with trees - 3707 Hidden Estates Drive

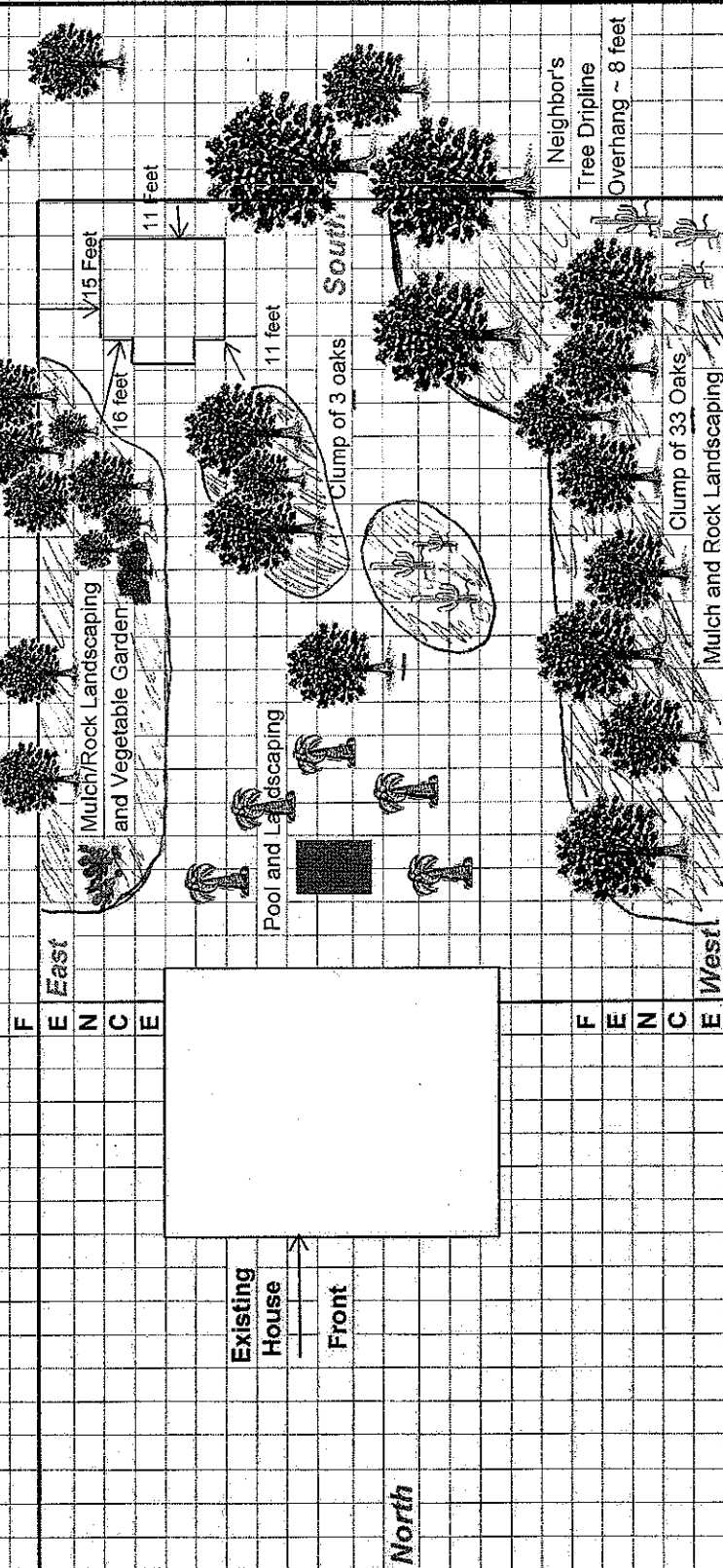

Oak trees existing when purchased. Palm, crepe myrtle and cactus planted after.
 Tree diameter ranges from 17 inches to 39 inches, height ranges from 20 to 45 feet.
 Neighbors tree dripline overhangs about 8 feet on south end of fence.

46 Oak Trees Total on 3707 Hidden Estates

Work Shed

Plot View

Date: 4/1/2014

Drawn by: DHL

Rev: 1