

**HISTORIC LANDMARK COMMISSION
APRIL 28, 2014
DEMOLITION AND RELOCATION PERMITS
HDP-2014-0274
2904 ENFIELD ROAD**

PROPOSAL

Demolish a ca. 1946 house.

ARCHITECTURE

One-story, L-plan, solid brick house with a hipped roof and wraparound ledge; single and paired 1:1 fenestration.

RESEARCH

The house was built in 1946 by Ollie E. and Lena Bybee, who moved here from their home on Palma Plaza. Ollie Bybee was a druggist, who later went to work at the Davis Tavern on E. 6th Street, and became a substation manager for Capitol Laundry and Cleaning. Lena Bybee died in 1952; Ollie Bybee moved out of the house shortly thereafter. In the 1950s, the house was then owned and occupied by Joseph A. and Ruth Hannan; he worked for Mutual Savings Institution. After his death, Ruth continued to live in the house until around 1960. From then on, the house was owned by Thomas W. and Gerda McKern. Tom McKern was a native of Canada, and grew up in Milwaukee, Wisconsin, where his father was an anthropologist for a museum. Tom became a professor of anthropology at the University of Texas, divorced Gerda in Las Vegas in 1968, and died in Canada in 1974. Gerda McKern continued to live in the house; she was an administrative assistant for the University of Texas.

STAFF COMMENTS

The house is beyond the bounds of any City survey.

STAFF RECOMMENDATION

Release the permit upon completion of a City of Austin Documentation Package, consisting of photographs of all elevations, a dimensioned sketch plan, and a narrative history, for archiving at the Austin History Center. The house has neither the architectural nor the historical significance to warrant individual designation as a historic landmark.

LOCATION MAP

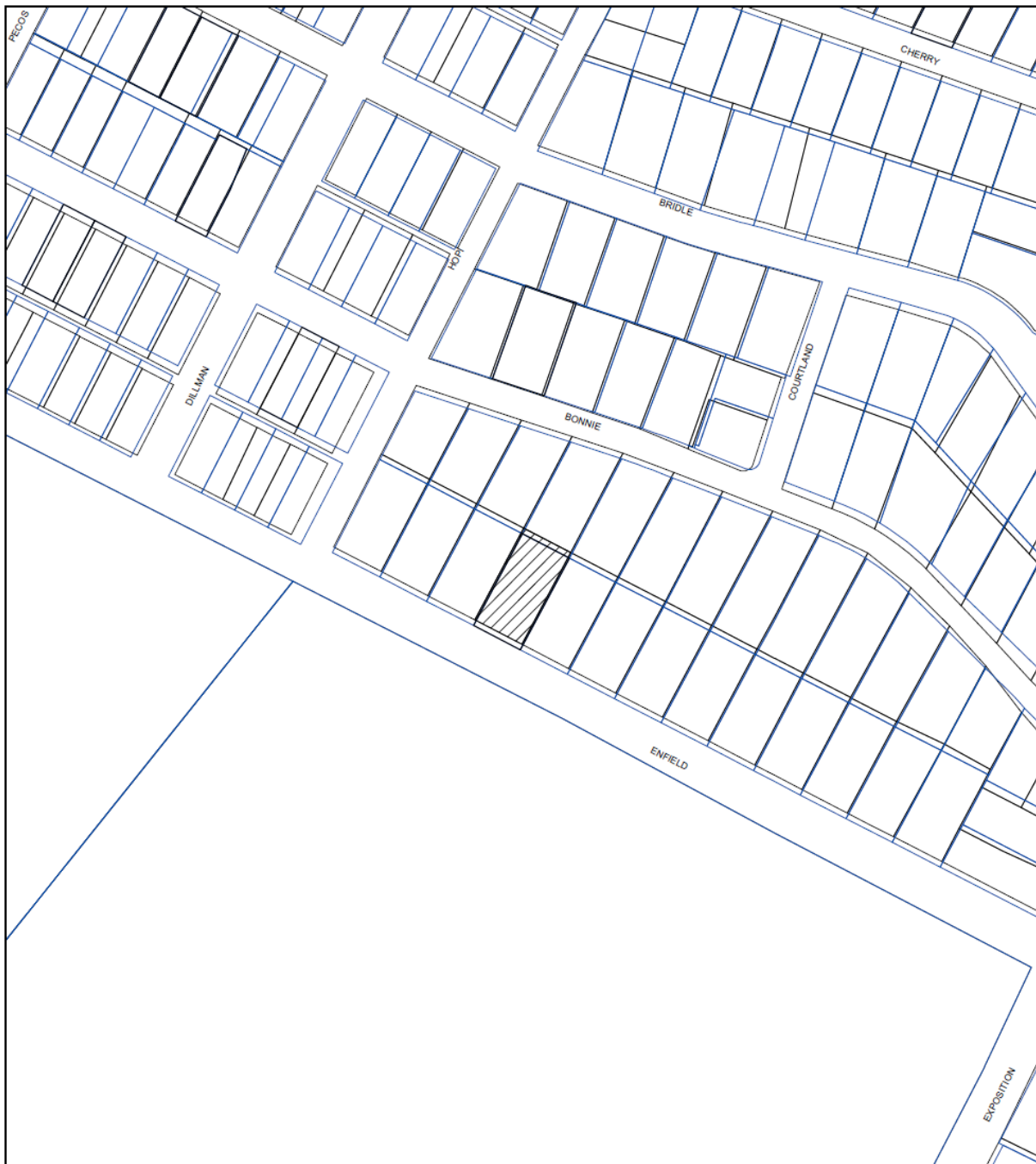

SUBJECT TRACT

ZONING BOUNDARY

CASE#: HDP-2014-0274
LOCATION: 2904 Enfield Road

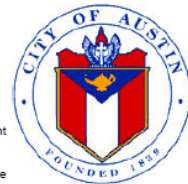

This product is for informational purposes and may not have been prepared for or be suitable for legal, engineering, or surveying purposes. It does not represent an on-the-ground survey and represents only the approximate relative location of property boundaries.

This product has been produced by the Planning and Development Review Department for the sole purpose of geographic reference. No warranty is made by the City of Austin regarding specific accuracy or completeness.

2904 Enfield Road
ca. 1946



OCCUPANCY HISTORY 2904 Enfield Road

City Directory Research, Austin History Center
By City Historic Preservation Office
April, 2014

- | | |
|---------|---|
| 1992 | Gerda F. McKern, owner
Administrative assistant, University of Texas |
| 1985-86 | Gerda F. McKern, owner
Administrative assistant, University of Texas |
| 1981 | Gerda F. McKern, owner
Administrative assistant, University of Texas |
| 1977 | Gerda F. McKern, owner
Administrative assistant, University of Texas
Also listed is Joan McKern, a student at the University of Texas. |
| 1973 | Gerda F. McKern, owner
Administrative assistant, University of Texas
Also listed is Scott McKern, a student. |
| 1968 | Thomas W. and Gerda McKern, owners
Thomas: Professor, University of Texas
Gerda: Administrative assistant, University of Texas
Also listed are Patrick McKern, a student, and Scott McKern, no occupation stated. |
| 1962 | Thomas W. and Gerda McKern, owners
Professor, University of Texas |
| 1959 | Ruth C. Hannan, owner
Widow, J.A. Hannan
Clerk, Mutual Savings Institution, 1005 Congress Avenue.
Also listed is Joseph Hannan, a public relations man for Allyn & Bacon (not listed in the directory)
NOTE: Thomas McKern (no wife listed) lived at 2307 W. 12 th Street; he was an assistant professor at the University of Texas. |
| 1955 | Joseph A. and Ruth C. Hannan, owners
Employed by Mutual Savings Institution, 1005 Congress Avenue. |
| 1952 | Ollie E. and Lena Bybee, owners
Sub-station manager, Capitol Laundry and Cleaning (several locations) |
| 1949 | Ollie E. and Lena Bybee, owners
No occupation listed |
| 1947 | Ollie E. and Lena Bybee, owners
Attendant, Davis Tavern, All popular brands of beer and wine, sandwiches, cigars and cigarettes, "Where Good Fellows Get Together", 131 E. 6 th Street. |

1944-45 The address is not listed in the directory.
 NOTE: Ollie and Lena Bybee are listed at 1625 Palma Plaza, he was a druggist.

BIOGRAPHICAL NOTES:

Ollie E. and Lena Bybee (ca. 1946 – ca. 1953)

Ollie and Lena Bybee appear in the 1940 U.S. Census as the owners of the house at 1625 Palma Plaza, which was worth \$6,000. Ollie Bybee was then 55, had been born in Arkansas, and had no occupation listed. Lena Bybee was then 53, had been born in Texas, and had no occupation listed. They had a son, Frank, 35, who was the manager of Bybee's Drug Store. In addition, Lena's sister, Bess Oliver, a 40-year old Texas-born stenographer for railroad attorneys, lived with them. In 1930, according to the U.S. Census report, Ollie and Lena Bybee were living in Mexia, Texas, where Ollie was a radio dealer. They had no children living with them.

Lena Bybee died in 1952; Ollie E. Bybee died in Austin July 29, 1970, but there was no obituary in the Austin newspapers.

Thomas W. and Gerda McKern (ca. 1960 -)

Thomas W. McKern appears as the 9-year old son of Will and Clara McKern of Milwaukee, Wisconsin in the 1930 U.S. Census. Will McKern had been born in Washington, and was the curator of a public museum. Thomas W. McKern was the oldest of their 2 children. He had been born in British Columbia, Canada. The 1940 U.S. Census shows 19-year old Tom McKern living with his parents in Milwaukee; he had no occupation listed, but his father was a museum anthropologist. Tom McKern died in New Westminster, British Columbia September 13, 1974.

Thomas and Gerda McKern were divorced in Clark County (Las Vegas), Nevada June 3, 1968.



Gerda Marie Furumo "Jeff" McKern Gerda Marie Furumo "Jeff" McKern died February 14th, 2013 of old age. Born in Appleton, Wisconsin in 1920, one of five children, all deceased; Torsten, Joan, Norbert and Jackson. She left lots of Nephews and Nieces, Friends and Children; Scott, Patrick and Joan, 2 Great Daughters-in-Law; Lynn and Leah. After Wisconsin, California and the East Coast, she and her family settled in Austin, Texas in 1958. As a faculty wife (her husband taught Anthropology at U.T.), she was very involved with the International Hospitality House, who hosted many foreign students in her home. Also, a prominent member of the Pan American Round Table and the Zilker Garden Club. She worked for 20 years at the College of Education at U.T., she had a great love for life (a cancer survivor of 50 years) and everything was an adventure. Her love of travel took her the Pyramids of Mexico, sunset at the northern Grand Canyon, cross-country skiing at the base of the Teton Mountains, sand storms in Colorado, 'Fire Fall' in Yosemite, the museums of Europe, beachcombing and birding on the Texas Coast. Her house was open to all, her livingroom, an open forum for discussion, ideas, food and drink. A great swimmer, photographer and reader, challenging, witty funny, liberal, difficult, an optimist. She will be missed. Our thanks to Dr. Mark Levy, Dr. Terreson and Darby, the great folks at Grace Hospice of Austin, Sara Jo, Kathleen and the Tucker family. A Memorial Service will be held in October in Port Aransas, Texas. Instead of flowers, contributions to Safe Place or Animal Trustees of Austin would be appreciated.

Obituary of Gerda McKern
 Austin American-Statesman, February 17, 2013

O.. E. Bybee

2904 Enfield Road

144

4

Westenfield "A"

Brick (solid) residence - one story

29090 2-14-46

\$8,000.00

Owner

5

Building permit to O.E. Bybee for the construction of the house (1946)

WATER SERVICE PERMIT

Austin, Texas

No. 211318

Received of O. E. BYBEE **INDEXED** Date 7-25-45

Address 2904 ENFIELD RD

Amount TWO AND 50/100 \$ 2.50

Plumber ? Size of Tap 1/2

Date of Connection	<u>7-25-45</u>	No. Fittings	1	Curb Cock	1/2	Elbow		St. Elbow		Bushing	1	Reducer	1	Pipe	2	Lead Comp.	1	Nipples	1	Union		Plug	1	Stop	1	Box	1	Lid	1	Valves		Job No.		Req. No.	
Size of Tap Made	<u>3/4</u>																																		
Size Service Made	<u>3/4</u>																																		
Size Main Tapped	<u>2"</u>																																		
From Front Prop. Line to Curb Cock	<u>8'</u>																																		
From Prop. Line to Curb Cock	<u>4'</u>																																		
Location of Meter	<u>CURBLINE</u>																																		
Type of Box	<u>LOCK</u>																																		
Depth of Main in St.	<u>18"</u>																																		
Depth of Service Line	<u>18"</u>																																		
From Curb Cock to Tap on Main	<u>2'</u>																																		
Checked by Engr. Dept.	<u>M. R. 8-17-45</u>																																		

INDEXED DOUGLAS

Water service permit to O.E. Bybee for this address (1945)

Receipt No. 4980

Application for Sewer Connection

N^o 19523AAustin, Texas, 8-18- 1945

To the Superintendent of Sanitary Sewer Division, City of Austin, Texas.

Sir:—

I hereby make application for sewer connection and instructions on premises owned by

O. E. Bybee at 2904 Enfield Rd. Street,further described as Lot 4 Block 144 Outlot 144 Division 144
subdivision Westenfield #1 Plat 144, which is to be used as a ResIn this place there are to be installed 5 fixtures. Plumbing Permit No. 20446

I agree to pay the City of Austin, the regular ordinance charge.

8-20-45
orDepth at Prop. Line 3'-5 1/2" at Main Respectfully,Sub-~~Out~~ } 2'-E of W L L
Connected } (Location)Date 9-31-45By CorringtonA. A. A. Plumbing Co.NOTE: Connection Instructions sewer in Enfield Road 15 ft deepB1538ODS

Sewer connection application by O.E. Bybee for this address (1945)