

ZONING CHANGE REVIEW SHEET

CASE NUMBER: C14H-2014-0002

HLC DATE:

May 19, 2014

PC DATE:

APPLICANT: Historic Landmark Commission

HISTORIC NAME: Barton-Keaton House

WATERSHED: Shoal Creek

ADDRESS OF PROPOSED ZONING CHANGE: 3006 Glenview Avenue

ZONING FROM: SF-3-NP to SF-3-H-NP

SUMMARY STAFF RECOMMENDATION: Staff **does not recommend** the proposed zoning change from single family residence, neighborhood plan (SF-3-NP) combining district to single family residence – Historic Landmark – neighborhood plan (SF-3-H-NP) combining district zoning.

QUALIFICATIONS FOR LANDMARK DESIGNATION:

Architecture – the house has minimal traditional styling.

Historical associations – the house was occupied by a financial manager for the State Highway Department, a veterinarian, and a retired professor from East Texas State College.

HISTORIC LANDMARK COMMISSION ACTION: April 28, 2014: Initiated the historic zoning case. Vote: 7-0.

PLANNING COMMISSION ACTION:

DEPARTMENT COMMENTS: The house is beyond the bounds of the Comprehensive Cultural Resources Survey (1984).

CITY COUNCIL DATE:

ACTION:

ORDINANCE READINGS: 1ST 2ND 3RD

ORDINANCE NUMBER:

CASE MANAGER: Steve Sadowsky

PHONE: 974-6454

NEIGHBORHOOD ORGANIZATION: Bryker Woods Neighborhood Association.

BASIS FOR RECOMMENDATION:

Architecture:

One-story, rectangular-plan, side-gabled frame house with minimal traditional styling; single Colonial Revival-styled windows with 8:8 configurations in the front, and 6:6 elsewhere; flat-roofed, partial-width, independent porch.

Historical Associations:

The house was built in 1938 by Mrs. Coleman Gay; the first occupants of the house were renters, James T. (Jim Tom) and Hallie Barton, who moved here from 806 W. 34th Street. Jim Tom Barton was the finance manager for the State Highway Planning Survey, a program that State Highway Director DeWitt Greer put into place during the Depression years of the 1930s

to plan Texas highways once funds became available, allowing Texas to plan its highway system and build highways faster than most other states. The Bartons lived here until around 1943. Dr. Martin McBride, and his wife, Dora, rented this house in the mid-1940s. Dr. McBride was a veterinarian who had his own clinic on the Dallas Highway. Eugene B. and Jeanette Guthrie are shown as the owners of the house in the late 1940s; he was a fiscal officer for the State Unemployment Compensation Commission. Around 1950, the house was purchased by Leslie D. and Inez T. Keaton, who lived here for the rest of their lives. Leslie D. Keaton had been a professor at East Texas State College in Commerce, before retiring to Austin. He was employed by the City Tax Assessor and Collector's Office for several years while living in Austin, but for the most part, he and Inez lived out their retirement years in this house. After his death in 1972, Inez continued to live in the house for a few more years. She died in San Antonio in 1979; there was no obituary in the Austin newspapers. The house was owned by a lawyer, David A. Sheppard, in the late 1970s, and then was a rental unit through the early 1990s.

PARCEL NO.: 0118010504

LEGAL DESCRIPTION: N 55 FT OF LOT 3 BLK 7 BRYKERWOODS B

ESTIMATED ANNUAL TAX ABATEMENT: \$5,059 (owner-occupied); city portion: \$1,417.

APPRAISED VALUE: \$467,571

PRESENT USE: Single-family residential

CONDITION: Excellent

PRESENT OWNERS:

Chase C. Hamilton
3006 Glenview Avenue
Austin, Texas 78703

DATE BUILT: ca. 1938

ALTERATIONS/ADDITIONS: None apparent.

ORIGINAL OWNER(S): Mrs. Coleman Gay (1938)

OTHER HISTORICAL DESIGNATIONS: Contributing to the Old West Austin National Register Historic District (Bryker Woods).

Chase and Andrea Hamilton
3006 Glenview Avenue
Austin, Texas 78703
Phone: (512) 391-8262
E-mail: CHamilton@rrsfirm.com

May 15, 2014

Via Email: steve.sadowsky@austintexas.gov

Mr. Steve Sadowsky
Historic Preservation Officer
City of Austin, Texas

Re: 3006 Glenview Avenue Austin, TX 78703 - Application for Demolition Permit

Dear Mr. Sadowsky:

My wife and I are the owners of the property at 3006 Glenview Avenue, Austin, TX 78703 (the "Property"). Please consider this our written objection to any change in zoning on the Property. Thank you for including this in the packet you submit to the Historic Landmark Commission in anticipation of our hearing on May 19, 2014.

Regards,



Chase C. Hamilton

Andrea Hamilton

cc: Tori Haase (tori.haase@austintexas.gov)

LOCATION MAP

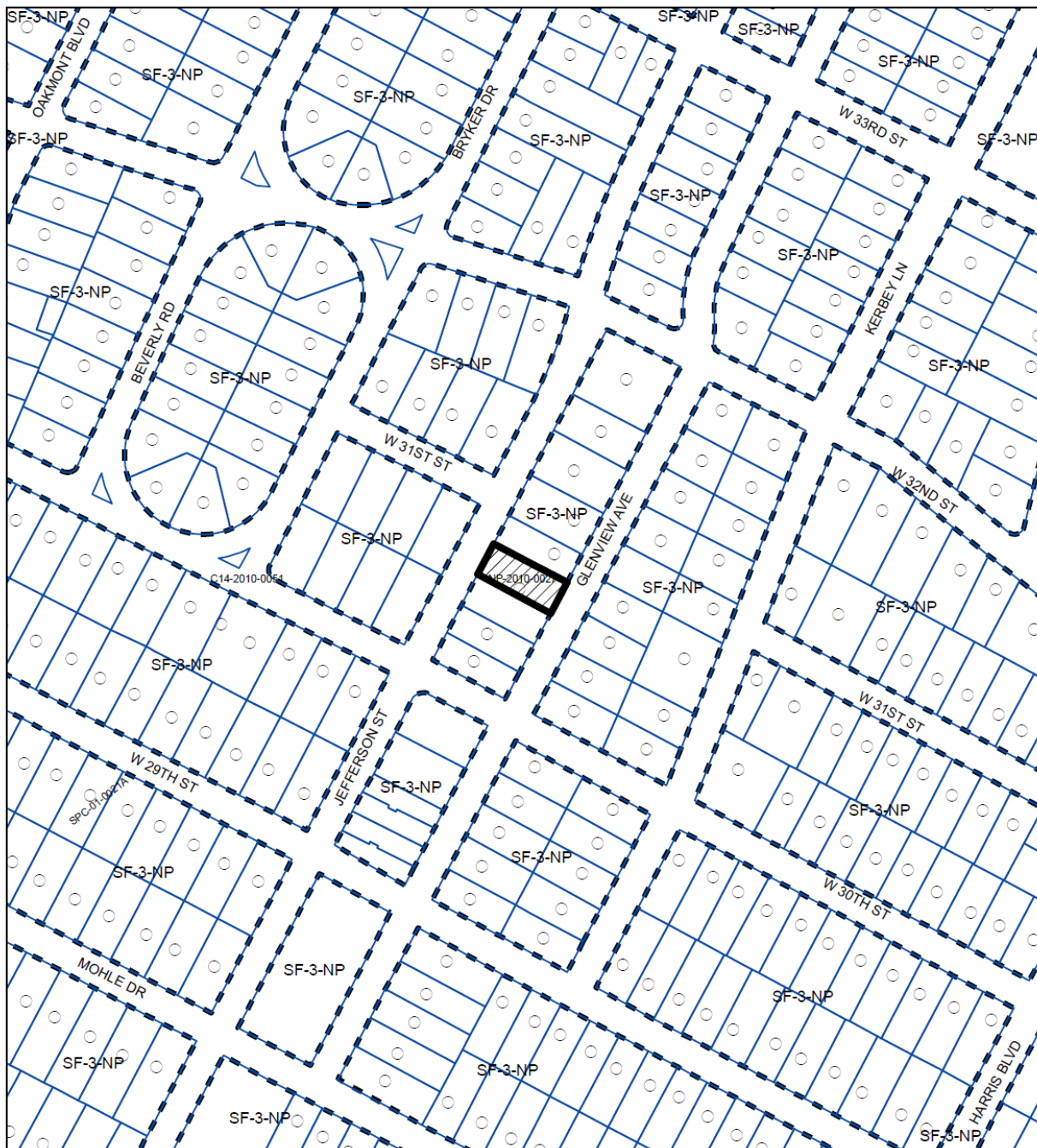

1" = 200'



SUBJECT TRACT



PENDING CASE



ZONING BOUNDARY

HISTORIC ZONING

ZONING CASE#: C14H-2014-0002

This product is for informational purposes and may not have been prepared for or be suitable for legal, engineering, or surveying purposes. It does not represent an on-the-ground survey and represents only the approximate relative location of property boundaries.

This product has been produced by CTM for the sole purpose of geographic reference. No warranty is made by the City of Austin regarding specific accuracy or completeness.



3006 Glenview Avenue
ca. 1938



OCCUPANCY HISTORY
3006 Glenview Avenue

City Directory Research, Austin History Center
By City Historic Preservation Office
May, 2014

- | | |
|---------|---|
| 1992 | John Edmonson, renter
No occupation listed
NOTE: The directory indicates that John Edmonson was a new resident at this address. |
| 1985-86 | James C. Susman, renter
No occupation listed |
| 1981 | Robert A. Dennison, III, renter
Lawyer, 825 W. 24 th Street
NOTE: The directory indicates that Robert A. Dennison, III was a new resident at this address. |
| 1977 | David A. and Susan D. Sheppard, owners
Lawyer, 314 W. 11 th Street |

1973	Inez T. Keaton, owner Widow, Leslie D. Keaton Retired
1968	Leslie D. and Inez T. Keaton, owners Retired
1962	Leslie D. and Inez T. Keaton, owners No occupation listed
1959	Leslie D. and Inez T. Keaton, owners No occupation listed
1955	Leslie D. and Inez T. Keaton, owners Employed by the City Tax Assessor and Collector
1952	Leslie D. and Inez T. Keaton, owners Vocational director
1949	Vacant NOTE: Leslie D. and Inez T. Keaton are not listed in the directory.
1947	Eugene B. and Jeanette Guthrie, owners Fiscal officer, State Unemployment Compensation Commission NOTE: Martin and Dora McBride are listed at 2904 Oakhurst Avenue; he was a veterinarian with his clinic at his house.
1944-45	Dr. Martin and Dora T. McBride, renters Proprietor, Austin Veterinary Hospital, 5200 Dallas Highway.
1941	James T. and Hallie O. Barton, renters Financial manager, State Highway Department
1939	James T. and Hallie O. Barton, renters Division manager, State Highway Department
1937	The address is not listed in the directory. NOTE: James T. and Hallie Barton are listed at 806 W. 34 th Street; he was the finance manager for the State Highway Planning Survey.

BIOGRAPHICAL NOTES:

James T. (Jim Tom) and Hallie O. Barton (ca. 1938 – ca. 1943)

The 1940 U.S. Census shows Jim T. and Hallie O. Barton as the renters of this house. Jim T. Barton was then 29, had been born in Texas, and was a financial manager for the Highway Department. Hallie O. Barton was then 28, had been born in Texas, and had no occupation listed. They had no children listed in the census report. The 1930 U.S. Census shows Jim Barton as a 19-year old farm laborer in Victoria County, Texas. He was single. He was born in Decatur, Texas in 1910, and had lived in Wichita Falls in the mid-1930s.

Jim Tom Barton

Jim Tom Barton, age 78, of Austin, dies Sunday. Born in 1910 in Decatur, Texas. He was the son of Henry W. and Pearl Perrin Barton.

After graduating from high school and Junior college in Wichita Falls, he operated a retail milk route in Wichita Falls for a year, then enrolled at Southern Methodist University, receiving a Bachelor of Commerce Degree. The following year, he worked as a tool dresser on a spudder drilling rig, and as a teacher in a consolidated country high school. He enrolled in the graduate school of business at the University of Texas, and received his M.B.A. degree the following June. During the year, he won the heavyweight boxing championship.

Mr. Barton was given a job as research assistant in the newly formed Bureau of Municipal Research, a job which he held about two and a half years. He was the author of several monographs that were published by the University.

In 1936 he got a job, not easy at that time, as financial manager of the Highway Planning Survey, which he held for five years until he entered the Navy.

The most important thing he did in those five years was to marry Haille Elizabeth Orr, a Phi Beta Kappa from Llano.

He served in several naval stations during World War II, including 14 months on the island of Guam. He retired as commander.

Mr. Barton then joined with Elbert L. Wade and George H. Marsh and formed Wade, Barton and Marsh, Certified Public Accountants. After 21 years the firm was merged with a national firm. He retired after 30 years in public accounting, and devoted his time to writing and working with investments.

Survivors include his wife, Hallie Orr Barton, Austin; son, Thomas O. Barton, Austin; daughter, Betty Worthington, Houston; brother, Henry Will Barton, Wichita Falls; daughter-in-law, Lydia Wommack Barton, Austin; son-in-law, Ed Worthington, Houston; granddaughters, Webber, Mary Wommack, Perrin Barton, and Brennan Worthington.

Services were held at 3:00 PM, Monday at Episcopal Church of the Good Shepherd, with Reverend Ray Whitfield officiating. Burial, Oakwood Cemetery.

Pallbearers were Howard Barr, Herb Gentry, Will Wilson, Louis Sutherland, Dr. Rex Carter, and H. Ray Northrup.

Memorial contributions may be made to Episcopal Church of the Good Shepherd.

Arrangements by Weed-Corley Funeral Home, 3125 N. Lamar. 452-8811.

Obituary of Jim Tom Barton
Austin American-Statesman, December 13, 1988



Hallie Elizabeth Orr Barton

Hallie Elizabeth Orr Barton, age 90, of Austin, Texas, died December 5, 2001, at Westminster Manor Health Care Center of health problems associated with Alzheimer's Disease.

Hallie was born on August 9, 1911, in Houston, Texas, at the home of her grandparents, and was raised in Llano, Texas, by her parents, Bess and Wilkin Orr. After graduating from Llano High School in 1927 at age 16 as the valedictorian, she attended Sweet Briar College in Amherst, Virginia, for two years, and then graduated, Phi Beta Kappa, from the University of Texas in 1931.

After working several years for Texas Gulf Sulfur Company in Point Sulfur, Louisiana, and the University of Texas at Austin, she married her husband of over fifty years, Jim Tom Barton, who originally was from Decatur, Texas.

Jim Tom preceded Hallie in death in December of 1988.

Hallie is survived by her two children, Elizabeth Barton Worthington and Thomas Orr Barton; by four grandchildren, Brennan Elizabeth Worthington, Webster Orr Barton, Mary Wommack Barton, and Perrin Elizabeth Barton; and by her daughter-in-law, Lydia Wommack Barton. She also is survived by her dear friends of the "Sewing Club," Jean Reed Southerland, Margaret Pressler Barr, Elizabeth Marsh, Ellen Steck Carter and Anna Fe Peterson.

She was a very active member of the Episcopal Church of the Good Shepherd where she taught Sunday School for many years and served on various committees and service groups. Hallie also served on the governing boards of a number of charitable organizations, including The Settlement Home, of which she served as chairman.

Hallie loved music, animals, helping other people and spending time with her family and friends. She traveled extensively with her family, especially after Jim Tom's retirement.

Services will be held on December 8, 2001, at 2:00 p.m., at the Episcopal Church of the Good Shepherd. Burial will be at Oakwood Cemetery following the service.

Honorary pallbearers are Howard R. Barr and Will R. Wilson, Sr. The pallbearers are Patton G. Lochridge, Edmund Peter Pincoffs, II, James A. Bridges, Will R. Wilson, Jr., Brian S. Greig and Robert Clarke Heidrick.

Memorial contributions may be made to the Episcopal Church of the Good Shepherd, St. Andrew's Episcopal School, The Settlement Home or the Alzheimer's Association of Austin.

Arrangements by Weed-Corley-Fish Funeral Home, 3125 N. Lamar, Austin, TX 78705 - (512) 452-8811.

Obituary of Hallie O. Barton
Austin American-Statesman, December 7, 2001

Martin and Dora T. McBride (ca. 1943 – ca. 1946)

Martin McBride

Martin McBride, descendant of a pioneer, Greenville, Hunt County family, died August 2, 1996, in Austin. Born October 24, 1914, he earned a Bachelor of Science and a Doctor of Veterinary Medicine Degree from Texas A&M University, and a Master of Public Health from Tulane University. He was a charter member and first treasurer of the Texas Aggie Band Association. He was retired from the City of Houston Health Department. Following a career that included private practice with large and small animals, he participated in public health programs in Texas and in Louisiana, especially with the Screw-worm Eradication Project and those programs concerned with brucellosis and tuberculosis.

He is survived by wife of 56 years, Dora Tucker McBride; two sons, Scott Martin McBride of San Antonio, and Michael Warren McBride of Houston; a daughter, Mary Jane McBride Moran, her husband Dr. William Moran, and two grandchildren, Cory Patrick Moran and Megan Scott Moran, all of Austin; nephews, W. Martin McBride of Los Osos, California, and Kevin R. McBride of Burlington, Vermont, Herbert Sharp of Austin; a special cousin, W.W. McRae of Norfolk, Virginia; and a special godson, George Jay Johnson of Santa Fe, New Mexico and Dallas.

Thanks are extended to Dr. R.V. Murray, Dr. Thomas Daniel, Dr. Frank Mazza, and to Guy McGowen and his staff at Elderly Care Services of Austin.

Services will be Sunday, August 3, 1996, at 2:00 p.m., at All Saints Episcopal Church, where Dr. McBride had served as vestryman. Officiating will be The Reverend James Williams and The Reverend Charles Sumners of Beeville.

Pallbearers are George Jay Johnson, Martin S. Kermacy, Dr. Robert B. Morrison, Fred Sackett, Herbert Sharp and Dr. Quintin Smith.

Memorial contributions may be made to the SPCA of Houston and to The Children's Home of Austin, or to the charity of choice.

Arrangements by Weed-Corley-Fish Funeral Home, 3125 N. Lamar, 452-8811.

Obituary of Martin McBride
Austin American-Statesman, August 4, 1996



Dora T. McBride

Dora T. McBride, a pioneer in the field of Child Care Licensing work and innovator in regards to childrens' mental health, passed away in Austin on May 7, 2005 at the age of 88.

Her professional career included Texas Department of Public Welfare, Edna Gladney Home, Meridell Achievement Center and the Texas Research Institute of Mental Sciences. Honors include Social Worker of The Year by the Houston Chapter of the National Association of Social Workers (NASW), the 1979 Outstanding Social Worker of the Year by the State of Texas NASW Group, Community Service Award by the Mental Health Association in 1981, and the State of Texas Governor's Award for Volunteer Services. She was one of the organizers, board members and officer of a Houston based advocacy group for children in treatment originally known as CAN DO IT! (Now called ChildBuilders). Volunteer organizations include: United Way, Austin, Houston chapters of the Junior League, American Red Cross, and local & state Mental Health Associations, Austin's Helping Hand Home for Children.

She was preceded in death by her husband, Martin McBride. She was the loving mother of two sons, Scott and Michael McBride, and one daughter, Mary Jane Moran. She adored her grandchildren, Cory Moran and Megan Moran.

Visitation will be held on Tuesday, May 10, 2005, at Weed-Corley-Fish Funeral Home, from 6:00 -8:00 p.m. with services at St. David's Episcopal Church on Wednesday, May 11, 2005, at 3:00 p.m. Interment will be held at Glenwood Cemetery in Houston, Texas.

Memorials may be made to a charity of your choice.

Memorials and guestbook online at wcfish.com.

Obituary of Dora McBride
Austin American-Statesman, May 10, 2005

Leslie D. and Inez T. Keaton (ca. 1950 – ca. 1975)

Leslie D. and Inez T. Keaton appear in the 1940 U.S. Census for Commerce, Texas. Leslie D. Keaton was then 59, had been born in Tennessee, and was a teacher at the State College.

Inez T. Keaton was then 45, had been born in Tennessee, and had no occupation listed. They had a daughter, Peggy, 13, who had been born in Texas. The 1930 U.S. Census shows the Keatons owning their home in Commerce, Texas; Leslie D. Keaton was listed as a teacher at the State Teacher's College.

LESLIE D. KEATON

Leslie D. Keaton, 3006 Glenview, died in a local hospital Monday. Keaton was a professor at East Texas State University at Commerce for many years before his retirement in 1953. He had been a resident of Austin since his retirement and a member of the University Baptist Church.

He is survived by his wife, Mrs. Inez T. Keaton; a daughter, Mrs. Peggy Curtice of San Antonio; and two grandsons.

Graveside services will be 10 a.m. Wednesday at Austin Memorial Park, Dr. Bill Glover officiating; services are under the direction of the Weed-Corley Funeral Home.

Memorial contributions may be made to Father Flanagan's Boys' Home at Boys Town, Neb.

Obituary of Leslie D. Keaton
Austin American-Statesman, March 28, 1972

Connect. Charge \$ # 342 N^o 14647A
 Application for Sewer Connection.

Austin, Texas, 7/28 1938

To the Superintendent of Sewer and Public Improvements,
 City of Austin, Texas

Sir:—

I hereby make application for sewer connection and instructions
 on premises owned by Mrs Coleman Gay
 at 3006 Glenview Street,
 further described as lot 3, block 7, outlot _____,
 subdivision Brykerwoods B, division _____, plat 61,
 which is to be used as a Res

In this place there are to be installed 4 fixtures.

I agree to pay the City Sewer Department the regular ordinance
 charge.

2 DEEP Respectfully,

AT-PL

Jno Waltinger
Bar

Stub Out

Connected 9-19 1938

Size of Main 6 inches.

Size of Service 4 inches.

4 Feet Deep in ST

Feet from Property Line

27 Feet from Curb Line

Inspected by Boatright

Connection made by Huby
10206

Con 8-

S of N

PL

13-12-27

Sewer connection application by Mrs. Coleman Gay for this address (1938)

Houses in the 3000 - 3100 blocks of Glenview Avenue





