

**HISTORIC LANDMARK COMMISSION
DECEMBER 15, 2014
DEMOLITION AND RELOCATION PERMITS
HDP-2014-1025
2500 GALEWOOD PLACE**

PROPOSAL

Demolish a ca. 1950 house.

ARCHITECTURE

Two-story, roughly rectangular-plan, side-gabled frame house with a stone-veneered first story on the principal block, and ashlar-coursed concrete on the first floor of the garage block; recessed entryway; cantilevered second story; single and paired 6:6 fenestration, with a triple set of windows in the front façade to the right of the recessed entry.

RESEARCH

The house was built in 1950 by Tom Graham, a son of Murray Graham, the developer of Enfield, West Enfield, and Tarrytown. Tom Graham was a book-keeper and accountant for the Enfield Realty and Home Building Company, he later became more active in the real estate aspect of the family businesses, and eventually branched out into insurance with other family members, forming the Enfield Agency, all located in offices at the Tarrytown Shopping Center on Exposition Boulevard.

STAFF COMMENTS

The house does not appear in any City survey.

STAFF RECOMMENDATION

Encourage re-use and rehabilitation, but if that is not feasible, then release the permit upon completion of a City of Austin Documentation Package, consisting of photographs of all elevations, a dimensioned sketch plan, and a narrative history, for archiving at the Austin History Center.

LOCATION MAP

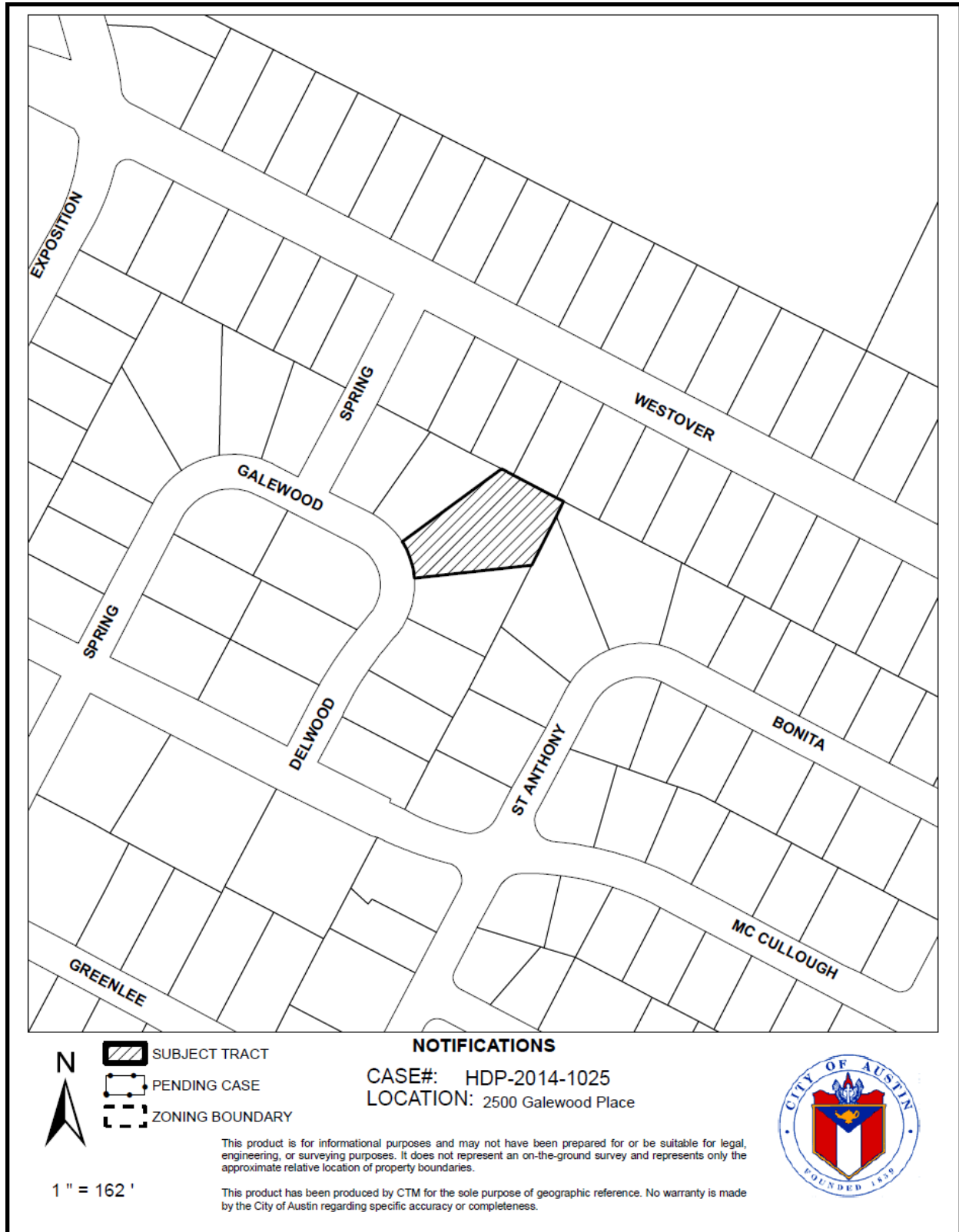

2500 Galewood Place
ca. 1950



OCCUPANCY HISTORY
2500 Galewood Place

City Directory Research, Austin History Center
By City Historic Preservation Office
December, 2014

1992	Malcolm S. and Jill W. Graham, owners Accountant, State Department of Commerce
1985-86	Malcolm S. and Jill W. Graham, owners Director, Finance Department, State law Center
1980	Malcolm S. and Jill Graham, owners Accountant
1976	Thomas A. and Mary B. Graham, owners Proprietor, Enfield Realty and Home Building Company
1971	Thomas A. and Mary B. Graham, owners Proprietor, Enfield Realty and Home Building Company
1966	Thomas A. and Mary B. Graham, owners Proprietor, Enfield Realty and Home Building Company
1960	Thomas A. and Mary B. Graham, owners Proprietor, Enfield Realty and Home Building Company

- 1957 Thomas A. and Mary B. Graham, owners
Proprietor (with Paul C. Crusemann), Enfield Agency, insurance,; and proprietor (with Mrs. Margaret G. and Paul C. Crusemann, and R. Niles Graham), Enfield Realty and Home Building Company, real estate, both at 2415 Exposition Boulevard.
- 1955 Thomas A. and Mary B. Graham, owners
Proprietor, Enfield Realty and Home Building Company
- 1953 Thomas A. and Mary Graham, owners
Proprietor (with Carl Lundgren), Graham, Lundgren & Company, insurance, 2415-B Exposition Boulevard, and (with Mrs. M.G. Crusemann, and R. Niles Graham), Enfield Realty and Home Building Company, Tarrytown Shopping Center, 2415 Exposition Boulevard; secretary-treasurer, Westenfield Development Company, Inc. (Mrs. Margaret G. Crusemann, president, R. Niles Graham, vice-president), Tarrytown Shopping Center, 2415 Exposition Boulevard.
- 1952 Thomas A.G. and Mary B. Graham, owners
Secretary-treasurer, Enfield Realty and Home Building Company (Mrs. Margaret G. Crusemann, president; R. Niles Graham, vice-president), Tarrytown Shopping Center, 2415 Exposition Boulevard.
- 1949 The street is not listed in the directory.
NOTE: Thomas A. and Mary B. Graham are listed at 2102 Bowman Avenue; he was the secretary-treasurer of the Enfield Realty and Home Building Company, R. Niles Graham, vice-president), Tarrytown Shopping Center, 2415 Exposition Boulevard.

BIOGRAPHICAL NOTES:

Thomas A. and Mary Graham (ca. 1950 – ca. 1979)

The 1940 U.S. Census shows Thomas A. Graham as the 27-year old son of R. Niles and Anita G. Graham, who owned their home at 6 Niles Road. Thomas A. Graham was single, and listed as a book-keeper for the Enfield Realty Company; his father, R. Niles Graham, was the head of the Enfield Realty Company, a real estate development firm.

Thomas A. Graham

Thomas A. Graham, 71,
of Austin died Saturday.

He was a retired Real State Developer, Past Senior Warden of Good Shepherd Episcopal Church, Past President of Austin School Board, Past President of Austin Board of Realtors, and Past President of Westenfield Development Company. Mr. Graham was born in Austin and was from a pioneer Austin family and the great-grandson of former Governor E. M. Pease and of Walter Tips.

He was the husband of Mary Bland Graham of Austin; father of Malcolm Graham of Austin, and Nancy Graham of Denver, Colorado; grandfather of Stephen Thomas Graham, and Kaitlin Graham of Austin; brother of Marshall P. Graham of Corpus Christi, and Julie Harman of Austin.

Funeral services will be held at 11:00 AM Monday at Good Shepherd Episcopal Church, with Reverend Canon Samuel N. Baxter officiating. Interment will be in Austin Memorial Park.

Memorial contributions may be made to a favorite charity. Arrangements by Cook-Walden Funeral Home.

Obituary of Tom Graham
Austin American-Statesman, July 10, 1983

Mary Bland Graham

Mary Bland Graham died peacefully at Christopher House on January 1, 2002.

She was born to Bland and Mary Savannah Smith in Bonham, Texas, March 4, 1916. She attended Randolph Macon Woman's College in Lynchburg, Virginia, and graduated from the University of Texas in 1938. She was married to Thomas A. Graham of Austin in 1940. Mary Bland was a charter member of the Episcopal Church of the Good Shepherd and remained an active member for over 50 years. Over the years, she was active in many organizations including the Austin Stitchery Guild, the Junior League of Austin, and Delta Delta Delta Alumnae Group.

She was preceded in death by her husband, Thomas A. Graham; her son, Thomas Stephen Graham; and her brother, Nunnelee Smith.

Survivors include, her son Malcolm Graham and his wife Jill of Austin; her daughter, Nancy Oelz and her husband David Oelz of Littleton, Colorado; her grandson, Stephen Graham and his wife Andrea Schokker of Warrior's Mark, Pennsylvania; her granddaughters, Kaitlin Graham of Austin and Emily Oelz of Littleton, Colorado; and her brother, John W. Smith and his wife Addlyn of Tyler, Texas.

The family wishes to express our thanks to Hospices of Austin and caregivers from Girling Health Services and Home Remedy for providing care and comfort during her final illness.

In lieu of flowers, contributions may be made to the Episcopal Church of the Good Shepherd or to Hospice Austin.

Services will be held at Good Shepherd Episcopal Church at 10:30 a.m. on Monday, January 21, 2002.

The family will be at home at 2500 Galewood Place after the services. Interment will be in Austin Memorial Park Cemetery.

Arrangements by Weed-Corley-Fish Funeral Home, 3125 N. Lamar, 452-8811.

Obituary of Mary Bland Graham
Austin American-Statesman, January 21, 2002

Tom Graham

2500 Galewood Road

170

14

Tarrytown Oaks #2

Stone veneer and frame residence with
gar. attach.
45203 6-28-50 \$20,000.00

W. W. Huff

11

Building permit to Tom Graham for the construction of the house (1950)

See Sub. B-5344 14

WATER SERVICE PERMIT
Austin, Texas.

INDEXED No. 6620

Received of TOM GRAHAM Date 7-7-50

Address 2500 GALEWOOD PL.

Amount TWENTY AND NO. 00 \$ 20.00

Plumber M. PLUMB Size of Tap 3/4"

Date of Connection 7-12-50

Size of Tap Made _____

Size Service Made _____

Size Main Tapped _____

From Front Prop. Line to Curb Cock 7.5'

From Prop. Line to Curb Cock _____

Location of Meter 2500

Type of Box wood

Depth of Main in St. _____

Depth of Service Line _____

From Curb Cock to Tap on Main _____

Checked by Engr. Dept. 50 RW

No. Fittings	Size
2	Curb Cock 3/4" G.R.V.
1	Elbow 3/4" "
1	St. Elbow 3/4" "
	Bushing
	Reducer
	Pipe
1	Lead Comp 3/4" x 5"
1	Nipples 3/4" "
1	Union 3/4" "
1	Plug 3/4" "
1	Tee 3/4" "
1	Stop 3/4" "
1	Box 3/4" "
1	Lid 3/4" "
	Valves
	Job No. <u>W-523-502</u>
	P. No. <u>N. 1011</u>

INDEXED

Water service permit to Tom Graham for this house (1950)

Receipt No. 14803 ^{Put in 6" Stub to be used for next lot} Application for Sewer Connection No. 26368

W.O. 1268 - S323 - Austin, Texas, 7-9-50

To the Superintendent of Sanitary Sewer Division, City of Austin, Texas.

Sir:—

I hereby make application for sewer connection and instructions on premises owned by Tom Graham at 2500 Salawood Street, further described as Lot 4 Block Outlot Division subdivision Tarrytown Oaks #1 Plat 70, which is to be used as a Res In this place there are to be installed 11 fixtures. Plumbing Permit No. 39684 I agree to pay the City of Austin, the regular ordinance charge.

Depth at Prop. Line 2'

Respectfully,

Stub Out } 2' E. OF W. L. L.
Connection (Location)

Date 10-9-50

By Agustin Ramirez

NOTE: Connection Instruction 6" Sewer in St to be connected
at West lot line with 6" Stub

A 2104

Sewer connection application by Tom Graham for this house (1950)