

**HISTORIC LANDMARK COMMISSION  
MARCH 23, 2015  
DEMOLITION AND RELOCATION PERMITS  
HDP-2015-0062 AND -0063  
1601 SINGLETON AVENUE AND 2502 E. 16<sup>TH</sup> STREET**

**PROPOSAL**

---

Demolish a ca. 1959 house (1601 Singleton Avenue) and a ca. 1954 house (2502 E. 16<sup>th</sup> Street).

**ARCHITECTURE**

---

The house at 2502 E. 16<sup>th</sup> Street is a one-story, rectangular-plan, hipped-roof, stuccoed frame house with a partial-width, partially-inset porch on ornamental metal posts; single and paired 1:1 fenestration, with a plate glass picture window next to the principal entry on the porch with single-light casements on each side.

The house at 1601 Singleton Avenue is a one-story, L-plan, house (possibly a Jim Walter Home) with synthetic siding, paired aluminum windows, and brick veneer wainscoting.

**RESEARCH**

---

The house at 2502 E. 16<sup>th</sup> Street was built in 1954 by Theodore R. Moore, a plasterer, who lived here for the rest of his life. Moore died at the age of 107 in 2013. He had obtained a building and sewer service permit for this address in 1951, but it does not appear that he built the house until 1954, when the water service permit for this address was issued. In city directories prior to 1955, he is listed as living on Comal Street.

The house at 1601 Singleton Avenue was built in 1959 by M.D. Hall as an investment property. The renters included a retire couple who lived here until the mid-1970s, and a bus driver for the Austin Independent School District.

**STAFF COMMENTS**

---

Neither house appears in any City survey.

**STAFF RECOMMENDATION**

---

Encourage rehabilitation of the house at 2502 E. 16<sup>th</sup> Street; although it has little historical or architectural merit, it is typical of the size and scale of the neighborhood, and should be retained if possible. If rehabilitation is not feasible, the staff recommends release of the permits upon completion of a City of Austin Documentation Package for the house at 2502 E. 16<sup>th</sup> Street. Neither house has the architectural nor the historical significance to warrant individual landmark designation.

## LOCATION MAP

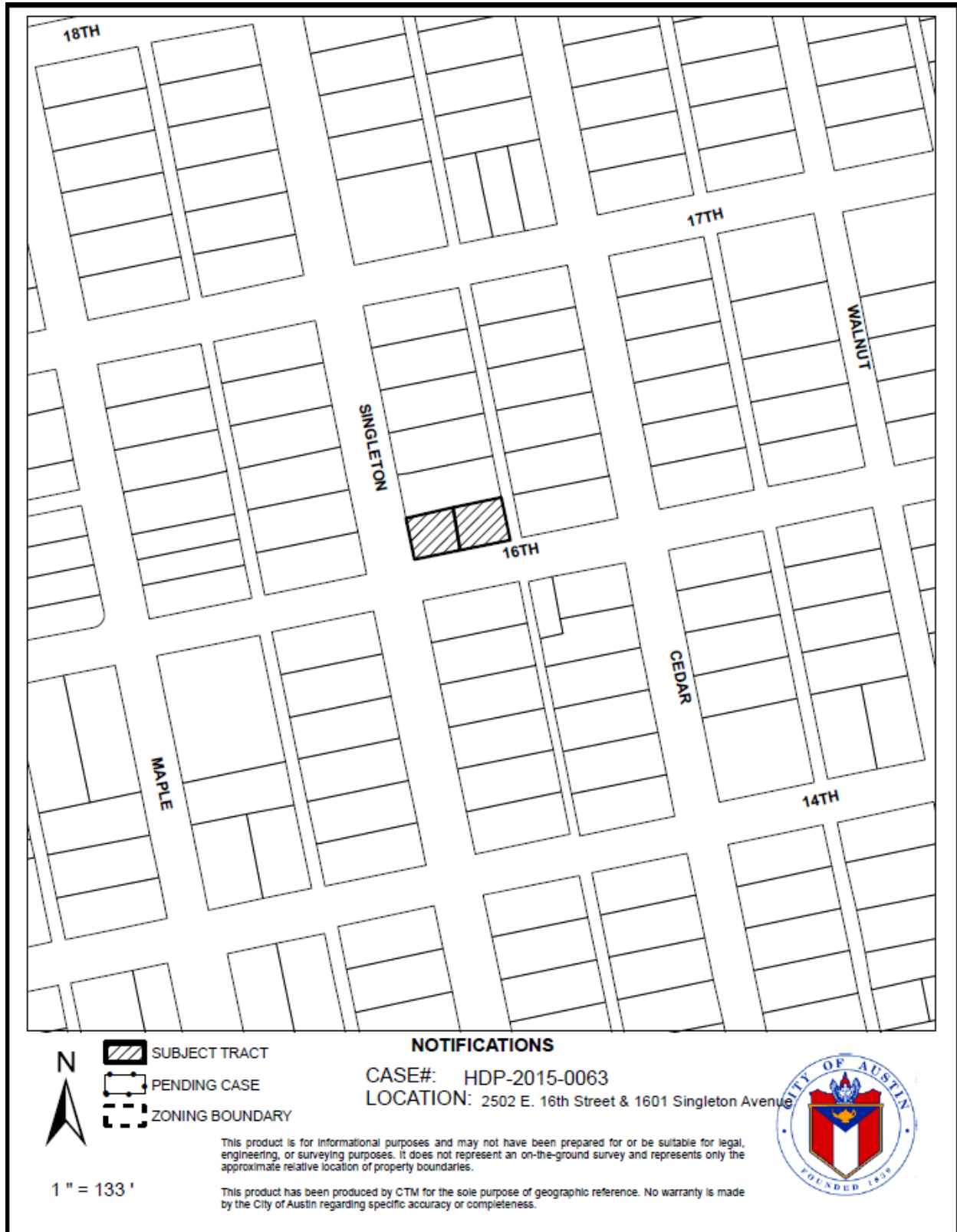

2502 E. 16<sup>th</sup> Street  
ca. 1954



## OCCUPANCY HISTORY 2502 E. 16<sup>th</sup> Street

City Directory Research, Austin History Center  
By City Historic Preservation Office  
February, 2015

1992	Theodore R. Moore, owner Retired
1985-86	Theodore R. Moore, owner Retired
1981	Theodore R. Moore, owner Retired
1977	Theodore R. Moore, owner Plasterer
1973	Theodore R. Moore, owner Plasterer
1968	Theodore R. Moore, owner Plasterer
1962	Theodore R. and Esther Moore, owners Plasterer

- 1959 Theodore R. and Esther Moore, owners  
Plasterer
- 1955 The address is not listed in the directory.  
NOTE: Theodore R. Moore (no wife listed) lived at 1187 Comal Street; he had  
no occupation listed.

**BIOGRAPHICAL NOTES:****Theodore R. Moore (ca. 19**

Theodore Moore and his brother, James Moore, appear in the 1940 U.S. Census as the renters of the house at 1187 Comal Street in Austin. Theodore Moore was 30, had been born in Texas, and was a construction laborer. James Moore was 24, had been born in Texas, and was a construction laborer. Theodore Moore is listed as married, but his wife is not listed with him in the census report.

**MOORE, Theodore, 107, retired business owner, of Austin, died Friday. Visitation 6 p.m. Thursday, Austin-Peel & Son Funeral Home. Services 2 p.m. Friday, Mount Zion Baptist Church. Burial Evergreen Cemetery. Arrangements by A Life Celebration By Franklin, Taylor.**

Obituary of Theodore R. Moore  
Austin American-Statesman, February 11, 2013

Theodore R. Moore		2502 East 16th St.	
38	7	10	32 B
Glenwood			
Frame residence.			
47718 3-7-51		\$2500.00	
Owner			

5

Building permit to Theodore R. Moore for the construction of this house (1951)

7  
10328

# WATER SERVICE PERMIT

Austin, Texas

E No. 1037

Received of THEODORE MOORE Date 5-20-54

Address 2502 E 16th

Amount TWENTY AND NO/100 \$20.00

Plumber SELF (PL-26945) Size of Tap 3/4"

Date of Connection <u>6-4-54</u>	No. Fittings	Size
Size of Tap Made <u>3/4"</u>	1 Curb Cock	3/4"
Size Service Made <u>3/4"</u>	1 Elbow	3/4"
Size Main Tapped <u>6"</u>	1 St. Elbow	6"
From Front Prop. Line to Curb Cock <u>7.5'</u>	Bushing	
From <u>N</u> Prop. Line to Curb Cock <u>2'</u>	Reducer	
Location of Meter <u>Curb</u>	28' Pipe	3/4"
Type of Box <u>Iron</u>	Lead Comp.	
Depth of Main in St. <u>24"</u>	Nipples	
Depth of Service Line <u>24"</u>	Union	
From Curb Cock to Tap on Main <u>28'</u>	Plug	
Checked by Engr. Dept. <u>7-6-54 P.H.</u>	1 Tee	
	1 Stop	
	1 Box	
	1 Lid	
	Valves	
	Job No. <u>2-3-102</u>	
	Req. No. <u>2-3-102</u>	

INDEXED

Water service permit to Theodore Moore for this house (1954)

1601 Singleton Avenue  
ca. 1959



## OCCUPANCY HISTORY

### 1601 Singleton Avenue

City Directory Research, Austin History Center  
 By City Historic Preservation Office  
 February, 2015

- |         |   |
|---------|---|
| 1992    | Walter McDonald, renter<br>Bus driver, AISD   |
| 1985-86 | Ira and Johnnie Anderson, renters<br>No occupation listed<br>NOTE: The directory indicates that Ira and Johnnie Anderson were new residents at this address.  |
| 1981    | Lester Robert, renter<br>Employed by the Lone Star Meat Company (not listed in the directory)<br>NOTE: The directory indicates that Lester Robert was a new resident at this address.   |
| 1977    | Dorothy A. Martin, renter<br>No occupation listed<br>NOTE: The directory indicates that Dorothy A. Martin was a new resident at this address.   |
| 1973    | Herman and Ida E. Grier, renters<br>Retired   |
| 1968    | Herman and Ida E. Grier, renters<br>Retired   |
| 1962    | Herman and Ida E. Grier, renters<br>Retired   |
| 1959    | The address is not listed in the directory.<br>NOTE: Herman and Ida E. Grier are not listed in the directory.<br>NOTE: The 1954 city directory shows Herman and Ida Grier at 1909 E. 16 <sup>th</sup> Street; he was employed at Bergstrom Air Force Base. Herman Grier died in Harris County, Texas in 1984. |



W. 57.67 x 58.0 97  
 382-1011-15-22

# WATER SERVICE PERMIT

Austin, Texas

EJ No 25258

Received of M. D. HALL Date 5-15-57  
 Address 1601 SINGLETON  
 Amount TWENTY TWO \$ 20.00  
 Plumber Patterson Size of Tap 7/8"

Date of Connection 11-3-59  
 Size of Tap Made 3/4"  
 Size Service Made 3/4"  
 Size Main Tapped 6" L.F.  
 From Front Prop. Line to Curb Cock 7.25'  
 From NO Prop. Line to Curb Cock 25'  
 Location of Meter CURB  
 Type of Box ROUND-  
 Depth of Main in St. 3'  
 Depth of Service Line 3'  
 From Curb Cock to Tap on Main 30'  
 Checked by Engr. Dept. 12-7-59

No. Fittings	Size	Material
32	Pipe	3/4" 10' 10'
1	Curb Cock	3/4"
	Cop. to Iron ell	
	Cop. to Cop. ell	
	Cop. to Iron Coupling	
	Cop. to Cop. Coupling	
1	Angle Stop	3/4"
	Stop	
	Bushing	
	Nipples	
	Service Clamp	
	Valve	
1	Meter Box	ROUND-
1	Lock Lid	"
1	Drain Tile	"
1	Drain Tile Lid	"
	Stop & Drain	
	Job No.	W. 323.200.502
	Foreman	W. 323.200.502

INDEXED

Water service permit for this address (1959)

# SANITARY SEWER SERVICE PERMIT

Austin, Texas

No 32639

Received of M. D. HALL Date 9-15-59  
 Address 1601 SINGLETON ST.  
 Amount TWENTY FIVE \$ 25.00  
 Builder or Owner W. 57.67 x 58.0 97 Plumber Patterson  
 Lot 97 Block 38-2 Subdivision 1011-15-22 Plat No. 38-2

Date of Connection 10-29-59  
 By City 55-E. & F. P. L. of Singleton  
 By Plumber Robert Martinez  
 Checked By Robert Martinez  
 Size Main 6" Depth 2'  
 Main Assign. to the 10' 10' F. L. L.  
 Stub Depth 2' Prop. Line 2'  
 Stub Location to the 10' 10' F. L. L.  
 Book No. A-1108  
 Paving Cut 10-1-59 No. 27

No. Fittings	Size	Price
6	Pipe	15.00
	Pipe	15.00
	Wyes	
	Bends	
	Reducers	
	Plugs	
	Sand	10
	Gravel	
	Remix	
	Stoppers	
	Castings	
	Other	
	Labor	8.00
	Druck	10.00
	Total	10.80

Sewer service permit for this address (1959)