

**HISTORIC LANDMARK COMMISSION
APRIL 27, 2015
DEMOLITION AND RELOCATION PERMITS
HDP-2015-0302
1300 WALNUT AVENUE**

PROPOSAL

Demolish a ca. 1913 house.

ARCHITECTURE

One-story, rectangular-plan, hipped-roof frame cottage with board-and-batten siding and a partial-width inset porch on non-historic, plain, square wood posts and a non-historic railing; single and paired fenestration with a combination of pane configurations, including 1:1 and 6:6. The photograph of the house from the 2000 Chestnut Neighborhood Historic Resources Survey shows that the house had turned wood porch posts and no railing at that time.

RESEARCH

The house appears to have been built around 1913 by Pearl and Carrie Reynolds, who lived here until around 1915. Pearl Reynolds was a salesman for Isaac Bledsoe, a dealer in pianos and other musical instruments, with a store on Congress Avenue. Pearl Reynolds grew up in Marble Falls, where earlier census reports show that he had been a dealer in musical instruments there. By 1920, the Reynolds family was living on a farm in Eastland County, Texas, but returned to Austin by 1930. Pearl Reynolds operated a filling station in 1930, and was a book-keeper for a retail grocery store in 1940. He died in 1946.

The house was vacant until around 1921, when it was owned and occupied by an African-American couple, Robert and Melvina Marshall. Little is known about the Marshalls; they lived here until around 1923, when they moved to a house on E. 16th Street. A series of African-American families then rented the house through the 1930s. Dowd and Janie Fowler rented the house in the early 1930s, and then purchased the house around 1940. They lived here for the rest of their lives. Dowd Fowler was raised in Manor, Texas, where he farmed cotton. They were still living in rural Travis County through the early 1930s, when they moved into Austin, and this house. After moving into Austin, Dowd Fowler had a variety of jobs, including a laborer, and as a yard man for a private family. The Fowlers had 7 children, one of whom, Dowd, Jr., eventually inherited this house and lived here until the early 1990s.

STAFF COMMENTS

The house is listed as a medium priority for preservation in the Chestnut Neighborhood Historic Resources Survey (2000).

STAFF RECOMMENDATION

Postpone to May 18, 2015 to better evaluate alternatives to demolition. This is a 100+ year old house that retains a relatively high degree of integrity, and every alternative to demolition should be carefully considered by the applicant and the Commission before releasing the permit. If the Commission does decide to release the permit, then staff recommends completion of a City of Austin Documentation Package, consisting of photographs of all elevations, a dimensioned sketch plan, and a narrative history, for archiving at the Austin History Center, prior to release of the permit.

LOCATION MAP

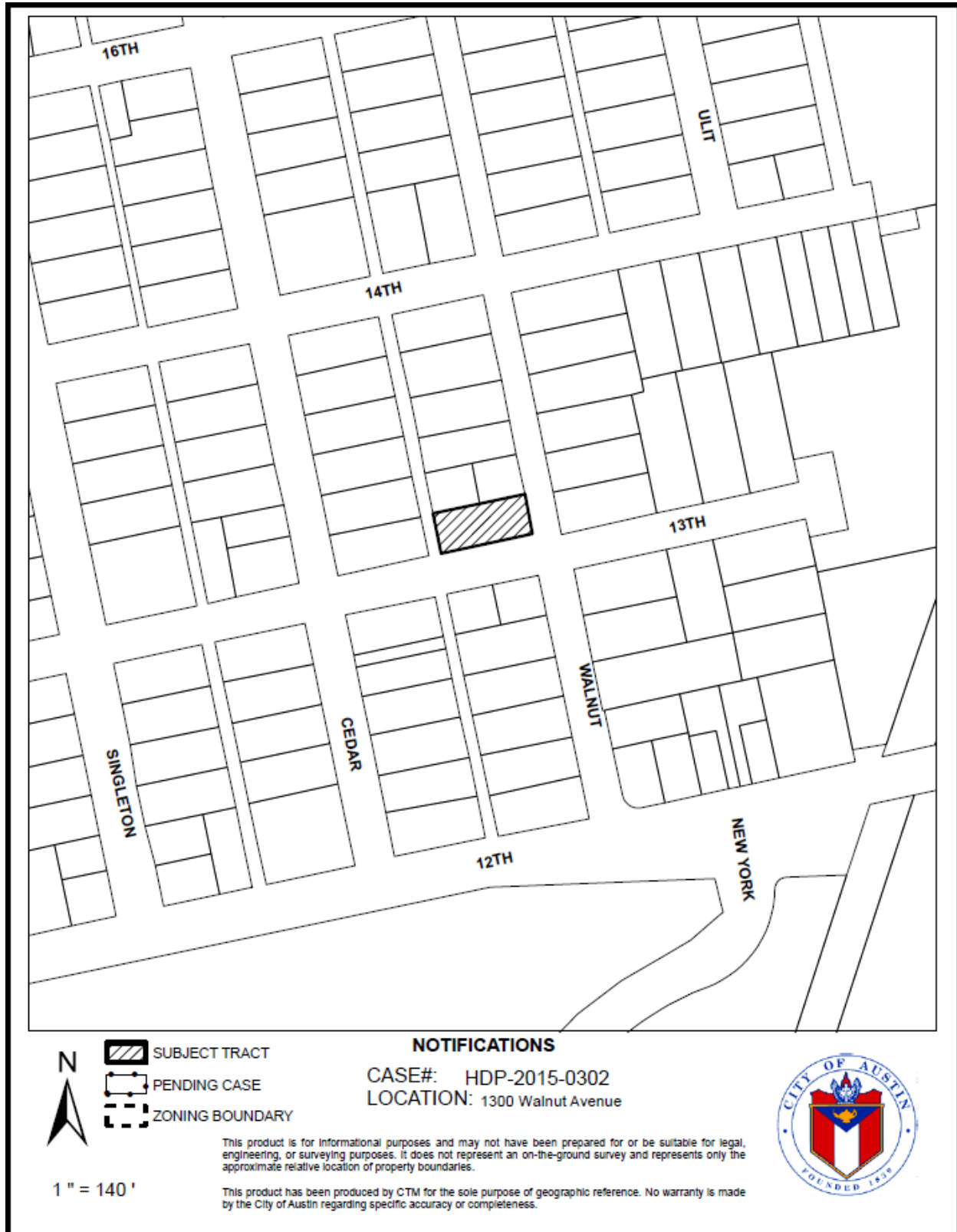

1300 Walnut Avenue
ca. 1913



OCCUPANCY HISTORY 1300 Walnut Avenue

City Directory Research, Austin History Center
By City Historic Preservation Office
April, 2015

1992	Dowd and Carolyn Fowler, Jr., owners Retired
1985-86	Dowd Fowler, Jr., owner Employed by the State Board of Control
1981	Dowd Fowler, Jr, owner No occupation listed
1977	Dowd Fowler, Jr. (not listed as owner) No occupation listed
1973	Dowd Fowler, owner Retired
1968	Dowd Fowler, owner

	Retired
1962	Dowd Fowler, owner No occupation listed
1959	Dowd and Jane Fowler, owners No occupation listed
1955	Dowd and Jane Fowler, owners Laborer
1952	Dowd and Jane Fowler, owners Laborer
1949	Dowd and Jane Fowler, owners Laborer
1947	Dowd and Jane Fowler, owners No occupation listed Also listed are Dowd and Lillian Fowler, Jr.; he was a porter.
1944-45	Dowd and Jane Fowler, owners Yardman
1941	Dowd and Jane Fowler, owners Laborer
1939	Dowd and Janie Fowler, renters Laborer
1937	Dowd and Janie Fowler, renters No occupation listed
1935	Dowd and Janie Fowler, renters No occupation listed
	Edward and Octavia Houston, renters No occupation listed
1932-33	Dowd and Janie Fowler, renters No occupation listed
1930-31	Joseph and Missouri Hunter (colored), renters No occupation listed NOTE: Dowd and Janie Fowler are not listed in the directory.
1929	Mizmaud D. Johnson (colored), renter No occupation listed
1927	Lawrence and Ella Harris (colored), renters No occupation listed
1924	Matthew R. and Lula Smith (colored), renters No occupation listed

NOTE: Robert and Melvina Marshall are listed at 2201 E. 16th Street; he had no occupation shown.

- 1922 Robert and Melvina Marshall (colored), owners
No occupation listed
- 1920 Vacant
NOTE: Robert and Melvina Marshall are not listed in the directory.
- 1918 Vacant
- 1916 Vacant
NOTE: Pearl G. Reynolds is listed at 1207 Willow Street; he was a grocer at 1900 E. 12th Street. With him lived his son, Foy, a clerk in his grocery store.
- 1914 Pearl G. Reynolds
Salesman, Isaac Bledsoe, wholesale and retail pianos, player pianos, and organs, dealer and breeder in horses and mules, 821-23 Congress Avenue.
- 1912-13 The address is not listed in the directory.
NOTE: Pearl Reynolds is listed as a traveling salesman for Isaac Bledsoe; he lived on RFD Route 1, 3 miles northeast of the city.

BIOGRAPHICAL NOTES:

Pearl G. and Carrie Reynolds (ca. 1913 – ca. 1915)

According to his 1918 World War I draft registration card, Pearl Grover Reynolds was born June 24, 1876, and lived at 304 E. 18th Street in Austin. He was a music dealer. He was of medium height and build, had blue eyes and light hair. At the time of his death on October 8, 1946, he was living at 3714 Post Road in Austin. He had been born in Marble Falls, Texas, and was retired.

The 1900 U.S. Census shows Pearl and Carrie Reynolds living in Marble Falls, Texas, with their son, Foy. Pearl was 22, had been born in Texas, and was a dealer of musical instruments; Carrie was 22, had been born in Arkansas, and had no occupation listed. Their son, Foy, was 1. The 1910 U.S. Census shows Pearl G. and Carrie Reynolds living at 708 E. 18th [?] Street in Austin. He was a piano salesman. Their children were son Foy, 11; daughter Zola, 9; son Willie, 7; daughter Pearl, 5; and son Earl, 4. In 1920, the family was living on a rented farm in Eastland County, Texas. P.G. Reynolds was a 43-year old farmer; Carrie was 41. Their children were Foy, 21, a farm hand; Zola, 19; Willie, 17, a farm hand; Pearl, 15; Earl, 13; Harrel, 12; Donald, 10; Richard, 8; and Jack, 4. By 1930, according to the U.S. Census, the family had returned to Austin. Pearl and Carrie Reynolds were living in an un-numbered house on Evergreen Street in Austin. Both were 52; P.G. Reynolds was the proprietor of a filling station. Carrie Reynolds had no occupation listed. They had 4 sons: Harold, 21, an auto mechanic; Donald, 18, a helper at a filling station; Richard, 16; and Jack, 14. All the boys had been born in Texas. The 1940 U.S. Census shows Pearl and Carrie Reynolds living in Precinct 5 of Travis County, where they owned a house worth \$500. Pearl Reynolds was a 63-year old book-keeper for a retail grocery store. With them lived a son, Earl, 33, who had no occupation listed; and Carrie Reynolds' mother, Georgia Scott, an 88-year old Georgia-born widow with no occupation listed. Next door lived their son, Jack, and his wife, Willie Mae. Jack Reynolds was a 24-year old rock mason.

According to the Find A Grave website, Pearl and Carrie Reynolds had 7 children: Foy E. Reynolds (1898-1931), William Wright Reynolds (1902-1970), Earl Reynolds, (1908-1945),

Harold Wayne Reynolds (1909-1973), Donald C. Reynolds (1911-1960), Marvin Richard Reynolds (1914-1981), and Jack Reynolds (1916-1989).

P. G. REYNOLDS

P. G. Reynolds, 70, died at his home, 3714 San Antonio Highway, Tuesday night. He is survived by his wife, one daughter, Mrs. Zola Haynie of Houston; six sons, William, Jack and Harold Reynolds of Austin, Richard Reynolds of Houston, Donald Reynolds of Kansas City, Kas., and Bob Reynolds of Los Angeles, Calif.; one sister, Mrs. Laura SoRelle of Houston; and two brothers, Melvin Reynolds of Austin and Allen Reynolds of Houston. The body is at the Cook Funeral Home pending completion of funeral arrangements.

Obituary of Pearl G. Reynolds
Austin American, October 9, 1946

P. G. REYNOLDS

Funeral services for P. G. Reynolds will be held at the Cook Funeral Home Thursday at 3 p. m. with the Rev. E. L. Sparks officiating. Burial will be in Memorial Park. Pallbearers will be Herman West, Murray West, Tommy Stevens, James Snowden, J. B. Branton and Bryant Barnard.

Funeral notice for Pearl G. Reynolds
Austin American, October 10, 1946

MRS. CARRIE REYNOLDS

Mrs. Carrie Gertrude Reynolds died in Austin Sunday. She was the widow of the late P. G. Reynolds.

She is survived by a daughter, Mrs. Zola Haynie of Houston; five sons, P. F. Reynolds of Dallas, M. R. Reynolds of Houston and W. W. Reynolds, H. W. Reynolds and J. B. Reynolds, all of Austin; two sisters, Mrs. Ollie Whitehead of Georgetown and Mrs. Will Messer of Austin and five brothers, George Scott, Fount Scott and Tom Scott, all of Austin, Ben Scott of Terrell, and Pome Scott of Georgetown.

Funeral services will be held Tuesday at 11 a.m. at Cook Funeral Home with the Rev. A. D. Eberhart officiating. Burial will be in Memorial Park.

Obituary of Carrie Reynolds
Austin American, April 3, 1961

Dowd and Janie Fowler (ca. 1931 - 1993)

The 1940 U.S. Census shows McDowd [sic] and Jane Fowler as the renters of this house. Dowd Fowler was 53, had been born in Texas, and did yard work for a private home. Jane Fowler was 50, had been born in Texas, and had no occupation listed. They had 5 children: Henson, 22, a waiter for a fraternity house; Tyree, 20, Maurice, 16, McDowd [sic], Jr., 14, and Mary K., 10.

Dowd and Janie Fowler appear in the 1920 U.S. Census as the renters of a house on a farm in rural Travis County. Dowd Fowler was 35, had been born in Texas and was a farmer. Janie Fowler was 30, had been born in Texas and had no occupation listed. They had 5 children: Mollie, 10; Norma, 8; Emma, 7; Narvell, 4; and H.S., 2. With them lived Edward Houston, 19, who is noted as a brother, and was a farm laborer. The 1930 U.S. Census shows Dowd and Janie Fowler living on a rented farm in Precinct 2 of Travis County. Dowd Fowler is listed at 41 years old; Janie at 38. Their children were Emma, 17; Merrill, 15; Hence, 12; Tyree, 10; Maurice, 6; Dowd, Jr., 4, and Mary K., 4 months. Dowd Fowler is listed as a cotton farmer. No other family member had an occupation listed.

According to his 1918 World War I draft registration card, Dowd Fowler was born June 4, 1886, and lived in Manor, Texas. He was a farmer and was married to Janie Fowler. He was tall and slender.

Jane Fowler died June 17, 1960 in Travis County. Her death certificate showed that she was a housewife. Dowd Fowler, Jr. died in Pomona, California in 1993.

MRS. JANE G. FOWLER

Funeral services for Mrs. Jane G. Fowler, who died at her residence 1310 Walnut Avenue, will be held at David Chapel Missionary Baptist Church Tuesday at 2:30 p.m. with Rev. W. T. Brown officiating. Burial will be in Evergreen Cemetery under the direction of Fuller Hecser Sheffield Funeral Service.

Pallbearers will be from Beacon Light Lodge 388 AF and AM.

Honorary pallbearers will be Rose of Sharon Chapter 277, the Deaconess Board and Austin Camp No. 3 American Woodmen.

Survivors include a husband, Dowd Fowler of Austin; three daughters, Mrs. Emma Walker of Austin; Mrs. Lorena Routt of Cleveland, Ohio; Mrs. Mary Kathan Shaw of San Fernando, Calif.; five sons, Melvin, Tyree, Maurice and Dowd Fowler Jr. all of Austin; Hence Fowler of San Antonio; one sister, Mrs. Annie Harvey of Austin; two brothers, Willis and Lonnie Black of Austin; 28 grandchildren, 10 great-grandchildren.

Obituary of Jane Fowler
Austin American, June 21, 1960

FOWLER, Mr. Dowd, 92, 13090 Walnut Ave., died Tuesday. Services 4 p.m. Monday at David Chapel Baptist Church. Burial, Evergreen Cemetery. Survivors: sons, Dowd Fowler, Hence Fowler, both of Austin; daughters, Emma Walker of Austin, Lorene (Stine) Routt of Cleveland, Ohio, Mary Shaw of Sylmar, Calif.; brothers, Ed Huston, Oliver Huston, Gus Huston, all of Austin; sisters, Octavia Black, Bertha Dickerson, Inez Rus-

sell, all of Austin; 19 grandchildren, 45 great-grandchildren. (Fuller-Sheffield)

Obituary of Dowd Fowler

Austin American-Statesman, September 10, 1978

~~Connection Charge \$~~ #625

No 15023 ✓

Application for Sewer Connection.

Austin, Texas, 11/24

1938

To the Superintendent of Sewer and Public Improvements,
City of Austin, Texas

Sir:—

I hereby make application for sewer connection and instructions
on premises owned by J. S. Brown

at 1300 Walnut Ave Street,

further described as lot 6, block 17, outlot 33,

subdivision Glennwood, division, plat 37,which is to be used as a Res

In this place there are to be installed 1 fixtures.

I agree to pay the City Sewer Department the regular ordinance
charge.

DEEP Respectfully,

ATP2

Stub Out

Connected 12-6 1938

Size of Main 6 inches.

Size of Service 4 inches.

Feet Deep

8 Feet from Property Line

Feet from Curb Line

Inspected by ProctorConnection made by W. Brown

10536

Permit Pk

OK 12-2-38

Com 24-21

of S.L.L.

A-11.7

Sewer connection application by J.S. Brown for this address (1938)