

**HISTORIC LANDMARK COMMISSION
APRIL 27, 2015
DEMOLITION AND RELOCATION PERMITS
HDP-2015-0304
2111 GARDEN STREET**

PROPOSAL

Demolish a ca. 1940 house.

ARCHITECTURE

One-story, rectangular-plan, side-gabled frame house with a central, partial-width, clipped front-gabled, independent porch; single 1:1 fenestration; ornamental metal porch posts and railings.

RESEARCH

The house was built over the winter of 1939-1940; Mary Aleman is the name on the building and utility permits; she was the daughter of Jesse (Jesus) and Josephine (Josefa) Aleman, who were the first owners and occupants of the house. Both Jesus and Josefa Aleman were born in Mexico; Jesus immigrated to the United States in 1902, Josefa in 1911. Jesus Aleman worked as a farm laborer in Del Valle for many years before moving into Austin, where he worked as a laborer for the City Street Department, and later for Dezendorf Marble Company. The Aleman family lived here until around 1946, when they moved to 2004 Willow Street, and rented this house out. However, by 1948, Jesus and Josefa's son, Manuel, was listed as the owner and occupant of the house. Manuel was an upholsterer.

Around 1960, the house was sold to Dora Ramos, a widow, who later opened Dora's Tavern on E. 6th Street (where the Shangri-La is now).

STAFF COMMENTS

The house does not appear in any City survey.

STAFF RECOMMENDATION

Encourage rehabilitation over demolition, and adaptive re-use if feasible; otherwise release the permit upon the completion of a City of Austin Documentation Package, consisting of photographs of all elevations, a dimensioned sketch plan, and a narrative history, for archiving at the Austin History Center.

LOCATION MAP

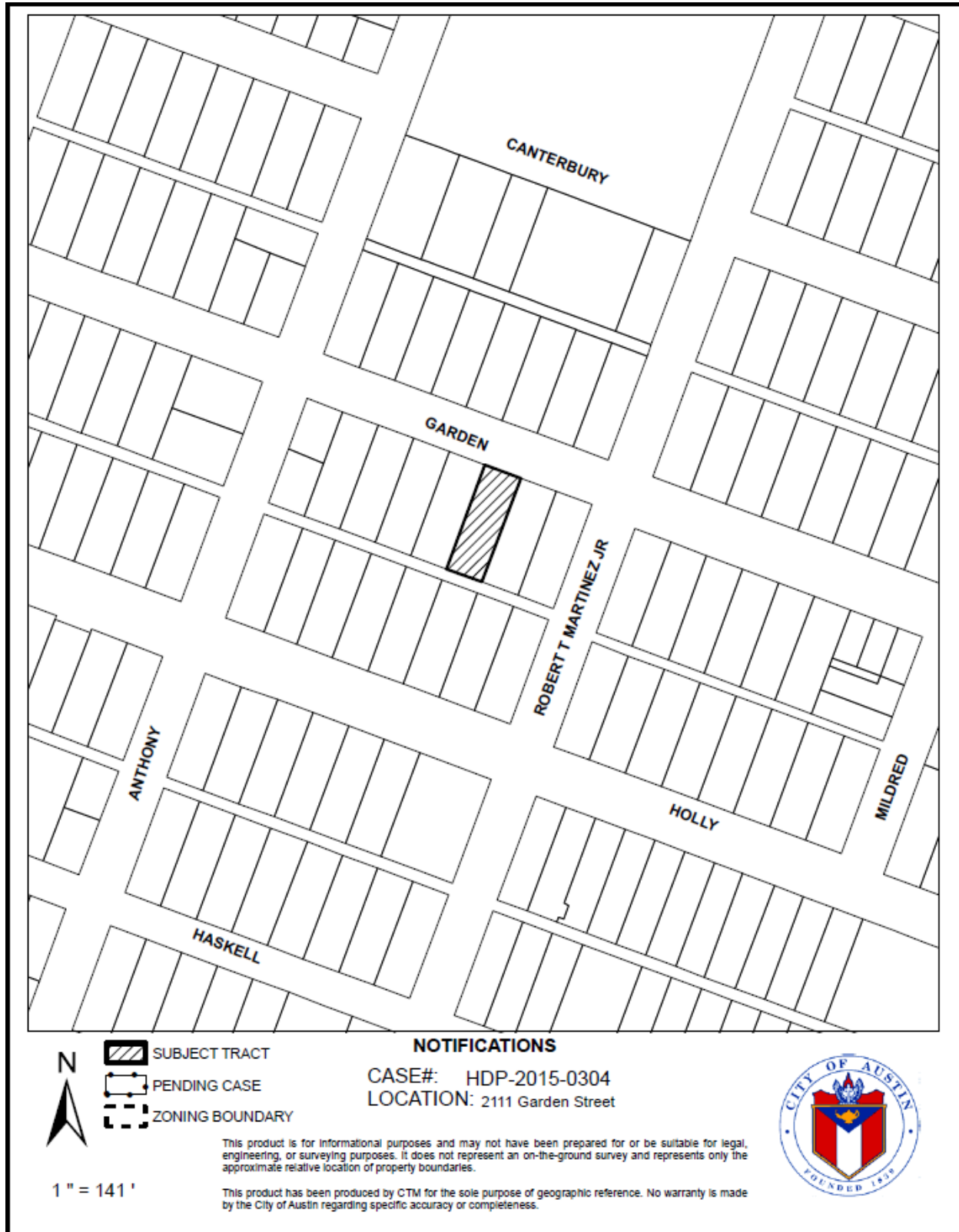

2111 Garden Street
ca. 1940



OCCUPANCY HISTORY 2111 Garden Street

City Directory Research, Austin History Center
By City Historic Preservation Office
April, 2015

1992	Dora C. Ramos, owner Retired
1985-86	Dora C. Ramos, owner Proprietor, Dora's Tavern, 1016 E. 6 th Street.
1981	Dora C. Ramos, owner Proprietor, Dora's Tavern, 1016 E. 6 th Street.
1977	Dora C. Ramos, owner Widow, Joe Ramos Proprietor, Dora's Tavern, 1016 E. 6 th Street.
1973	Dora C. Ramos, owner Widow, Joe Ramos Proprietor, Dora's Tavern, 1016 E. 6 th Street.

- 1968 Dora C. Ramos, owner
Widow, Joe Ramos
Proprietor, Dora's Tavern, 1016 E. 6th Street.
NOTE: The site of Dora's Tavern is now the Shangri-La Bar at the corner of 6th and Medina Streets.
- 1962 Dora C. Ramos, owner
No occupation listed
- 1959 Manuel and Phyllis Aleman, owners
Upholsterer, Austin Industries, furniture, 4311 S. Congress Avenue.
NOTE: Neither Joe nor Dora Ramos are listed in the directory.
- 1955 Phyllis Aleman, renter
No occupation listed
NOTE: Manuel Aleman is not listed in the directory.
NOTE: Joe and Teodora Ramos are listed at 300 Gonzales Street; he was a butcher at the Municipal Abattoir.
- 1952 Manuel and Phyllis Aleman, owners
Upholsterer
- 1949 Manuel and Phyllis Aleman, owners
Helper, Economy Furniture, upholstering, 5100 E. 5th Street.
- 1947 John and Mary Ledesma, renters
Laborer
NOTE: Jesse and Josephine Aleman are listed at 2004 Willow Street; he was a marble cutter. With them lived Manuel Aleman; he was an upholsterer.
- 1944-45 Jesse and Josephine Aleman, owners
Rock worker
- 1941 Jesse and Josephine Aleman, renters
Laborer
Also listed are Jesus Aleman, a laborer for Dezendorf Marble Company, 3000 E. 17th Street; and Manuel Aleman, a dishwasher at the Blue Bird Ice Cream and Sandwich Shop, 1307 Congress Avenue.
- 1940 The address is not listed in the directory. Jesse (Jesus) and Josephine Aleman are listed at 1509 E. 3rd Street; he was a laborer.

BIOGRAPHICAL NOTES

Jesse (Jesus) and Josephine Aleman (ca. 1940 – ca. 1946)

Manuel and Phyllis Aleman (ca. 1948 – ca. 1960)

Jesse and Josephine Aleman appear in the 1940 U.S. Census as the owners of this house, which was worth \$1,200 (\$200 more than the houses on either side of it at 2109 and 2113 Garden Street). Jesse Aleman was 40, had been born in Mexico, and was a laborer for a marble company. Josephine Aleman was 38, had been born in Mexico, and had no occupation listed. They had 6 children: Mary, 21, a housekeeper for a private family; Josephine, 17; Manuel, 15; Janie, 11; Jesse, 9; and Alice, 5. All of the children had been born in Texas. The 1930 U.S. Census shows Jesus and Josephine Aleman as the renters of the house at 1421 E. 2nd Street in Austin. He was a laborer for the city Street Department. Their children were Marie [Mary in the

1940 census], 12; Fannie, 10 (not listed with them in the 1940 census); Josephine, 8; Manuel, 6; and Juanita [listed as Janie in the 1940 census], 3. The 1930 U.S. Census reveals that Jesus Aleman had immigrated to the United States in 1902; Josephine Aleman had immigrated in 1911. His World War I draft registration card shows that he was a farm laborer in Del Valle in 1918; he was listed as an alien.

Manuel Aleman was born February 18, 1925 in Del Valle. His birth certificate shows that he was the 4th child of Jesus Aleman and Josefa Ruiz Aleman, who were living in Del Valle at that time. Jesus Aleman had been born in Mexico and was a farmer; Josefa Aleman had been born in Mexico and was a housewife.

ALEMAN, Mrs. Josefa, 80,
of 2004 Willow St., died
Saturday. Rosary will be 8
p.m. Sunday in Mission
Funeral Home Chapel and
requiem mass will be 10 a.m.
Monday in Cristo Rey Catholic
Church.
Survivors include her
husband, Jesus Aleman; a son,
Manuel Aleman; six
daughters, Mrs. Eugenia Gil,
Mrs. Mary Ledesma, Mrs.
Josephine Flores, Mrs. Janie
Rodriguez, Mrs. Jessica
Degollado, and Mrs. Alice
Villegas; a brother, Eulogio
Ruiz, and a sister, Mrs.
Senona Gonzales, all of
Austin; 31 grandchildren and
18 great-grandchildren.

Obituary of Josefa (Josephine) Aleman
 Austin American-Statesman, April 14, 1974

Jesus Aleman

Jesus Aleman, age 100, a resident of Austin, was called to his eternal home, Wednesday, January 4, 1994.

My soul Thou keepest, who never sleepest, 'mid gloom the deepest. There's light above; Thine eyes behold me, Thine arms enfold me; Thy word has told me. That God is love.

He is survived by son, Manuel Aleman and wife, Phyllis; daughters, Eugenia Gil and husband, Narciso Gil, Josephine Flores and husband, Chench, Janie Rodriguez and husband, Francisco, Jessica Garcia and husband, Feliciano, Alice Villegas and husband, Emilio; son-in-law, Johnny Ledesma, all of Austin; 31 grandchildren; 47 great-grandchildren; 11 great-great-grandchildren.

He was preceded in death by his wife, Josefa Aleman; daughter, Mary A. Ledesma; son, Pedro Aleman.

A Rosary service will be recited Thursday, 7:30 PM, at Mission Funeral Home. A funeral Mass will be held Friday, 2:00 PM at Cristo Rey Catholic Church. Reverend Father Michael Laltrello OMF Conv. will be principal celebrant. Interment will follow in Austin Memorial Cemetery.

Serving as pallbearers are grandsons, Victor Ledesma, James Ramirez, Jesse Gil, Frank Rodriguez Jr., Ricky Aleman, Arthur Degollado, and Clifton Villegas.

Honorary pallbearers will be grandsons.

In lieu of floral offerings, donations may be made to Cristo Rey Church, 474-6376.

Arrangements by Mission Funeral Home, 476-4355.

Obituary of Jesus (Jesse) Aleman
Austin American-Statesman, January 6, 1994

ALEMAN, Manuel

Age 89, of Austin, passed away March 13, 2014. Service March 16, 7 p.m. at Weed-Corley- Fish Chapel South Congress, Austin, TX.

Obituary of Manuel Aleman
Austin American-Statesman, March 15, 2014

Man Accused In Gun Attack

City police accused a 41-year-old man Monday of using the butt end of a rifle to hospitalize a 43-year-old woman.

The man was arrested by officers investigating an attack on Mrs. Dora Ramos of 2111 Garden Street, taken to Brackenridge Hospital early Monday for treatment of possible skull fracture.

Witnesses told Patrolman Harold Moe that during an argument the man grabbed up a .22 caliber rifle and struck Mrs. Ramos on the head with the butt end of the weapon.

The suspect was booked at city jail to face charges of aggravated assault.

News story on an attack on Dora Ramos
Austin Statesman, July 27, 1964

Mary Aleman

2111 Garden St.

19

-

F

3

-

Driving Park Addn.

box res. & box gar.

298n - 12-13-39

4

Building permit to Mary Aleman for the construction of this house (1939)

WATER SERVICE PERMIT
Austin, Texas

No. 14868

INDEXED

Date Dec 13, 1939

Received of Mary Aleman

Address 2411 Garden St.

Amount Two and 50/100 --- \$ 2.50

Plumber Croisdale Size of Tap 1/2

Date of Connection 12-27-39

Size of Tap Made 1/4

Size Service Made 1/4

Size Main Tapped 8" CI 2"

From Front Prop. Line to Curb Cock 11'

From 6' Prop. Line to Curb Cock 15'

Location of Meter CURB

Type of Box 1/4" x 1/4"

Depth of Main in St.

Depth of Service Line

From Curb Cock to Tap on Main

Checked by Engr. Dept. 1-5-40 LE

INDEXED

Water service permit to Mary Aleman for this house (1939)

Changed to 8" main on 701-3774

No. Fittings	Size.
Curb Cock	
Elbow	
St. Elbow	
1 Bushing 2 1/2" x 1 1/2"	✓
1 Reducer 2 1/2" x 1 1/2"	✓
Pipe	
Lead Comp.	
Nipples	
Union	
Plug	
1 Tee 2 1/2" x 1 1/2"	✓
1 Stop 2 1/2"	✓
Box	
Lid	
Valves	
Job No. 6397-12/15	
Req. No. 425584	

BENSON

Connection Charge # 1846 No. 16407B
 APPLICATION FOR SEWER CONNECTION.
 Austin, Texas, 12-13 1939
 To the Superintendent of Sewer and Public Improvements,
 City of Austin, Texas
 Sir:—
 I hereby make application for sewer connection and instructions
 on premises owned by Mary Aleman
 at 2111 Garden Street,
 further described as lot 3, block F, outlot _____,
 subdivision Driving Park, division _____, plat 19,
 which is to be used as a Res
 In this place there are to be installed 4 fixtures.
 I agree to pay the City Sewer Department the regular ordinance
 charge.
 3' DEEP Respectfully, A. B. Crossland
 AT - PL Stub Out
 Connected 1 - 25 19 40 Permit Pd. 12-13-39
 Size of Main 4 inches. 1-22-40
 Size of Service 4 inches. OV
9 Feet Deep Alley
 Feet from Property Line Con 31-1E
 Feet from Curb Line of 22-40
 Inspected by Boatright
 Connection made by Hutch A-241
12710 Sewer in alley L.H.P.

Application for a sewer connection by Mary Aleman for this house (1939)

Jesus Aleman

2111 Garden Street

19

3

F

38

0

Driving Park

Repair residence.

43689 2-25-50

\$116.00

Owner

None

12-2-71-126412-Ysidora Ramos frm addn to exist res and
remodel 90 sq.ft. *Ok*

replacing permit # 126412 - 6-4-73 136481

Frame addn. to res. and remodel

Building permit to Jesus Aleman to repair the house (1950) and to Ysidora Ramos for a frame
addition (1973)

The foundation was repaired in 2009; siding was repaired or replaced in 2010.