

**HISTORIC LANDMARK COMMISSION
MAY 18, 2015
DEMOLITION AND RELOCATION PERMITS
HDP-2015-0354
5311 ROOSEVELT AVENUE**

PROPOSAL

Demolish a ca. 1950 house.

ARCHITECTURE

One-story, roughly rectangular-plan, hipped-roof stone-veneered house with a hipped-roof independent porch on ornamental metal supports; picture window to the left of the front door; single 6:6 fenestration elsewhere.

RESEARCH

The house was built in 1950 by J.V. Walden. The first owners and occupants were Dudley and Maxine Walden, who lived here until around 1952. Dudley Walden was a clerk for a wholesale grocery company. From around 1952 to around 1957, the house was owned and occupied by Monroe and Thelma Walden. Monroe Walden was a school custodian and later a school bus driver. The house then became a rental unit. Tenants included a pilot for an oil operator in the late 1950s and early 1960s, a department manager for Reynolds-Penland, a men's clothing store, and employees of the University of Texas.

STAFF COMMENTS

The house is beyond the bounds of any City survey.

STAFF RECOMMENDATION

Postpone to June 22, 2015 to evaluate alternatives to demolition. While the house lacks the historical significance to warrant individual designation as a historic landmark, it is in scale with the neighborhood and represents an example of 1950s vernacular style with its cut stone veneer.

LOCATION MAP

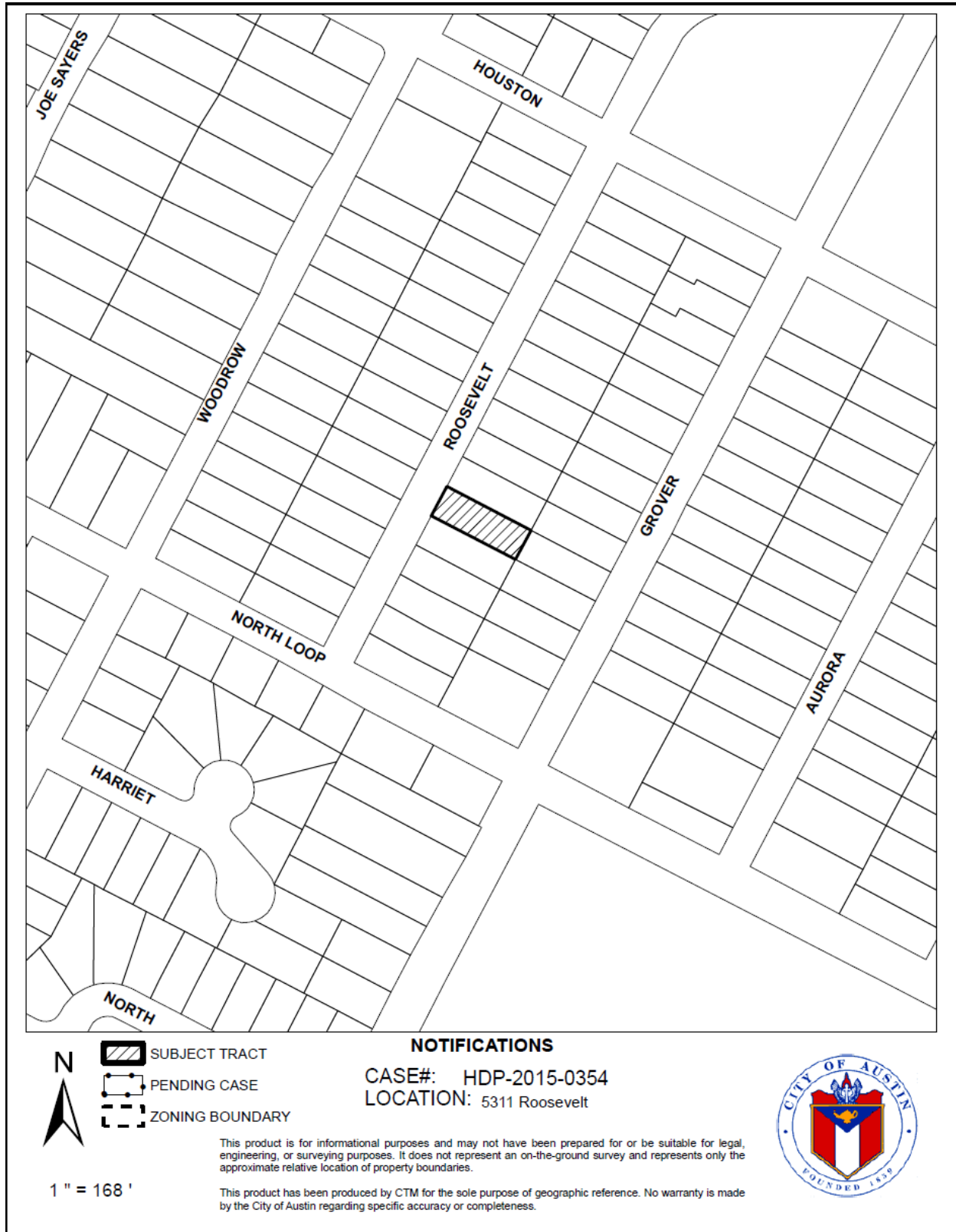

Steve-

That was our first option, but after consulting with our architect and builder, we concluded that the house was too debilitated and it would not be cost effective to keep any portion of the house. The previous owner was a hoarder, smoker, and had multiple cats causing substantial damage to the interior. It is a complete gut job and to rehab the existing structure, with an addition, would result in an inferior product. So to make a short answer rather long, we will not be able to utilize any of the existing structure. If there is anything that you need from me to help expedite this process let me know. It would be greatly appreciated. Thanks!

Michael Singletary

On May 13, 2015, at 9:49 AM, Sadowsky, Steve <Steve.Sadowsky@austintexas.gov> wrote:

Michael:

I understand your situation. Is there any way that the existing house could be incorporated into your proposal for the site, like with a rear addition? We are not opposing development of the property, but would like to see if there is a way to accomplish adaptive re-use of the existing house along with your plans for new construction.

*Steve Sadowsky
Historic Preservation Officer
City of Austin, Texas
974-6454*

5311 Roosevelt Avenue
ca. 1950



OCCUPANCY HISTORY 5311 Roosevelt Avenue

City Directory Research, Austin History Center
By City Historic Preservation Office
May, 2015

1992	M.D. Walden, renter No occupation listed
1985-86	Vacant
1981	John S. and Susan Pustejovsky, renters John: Assistant instructor, University of Texas Susan: Library assistant, University of Texas
1977	Thomas E. and Janet Eden, renters Employed by the public schools NOTE: The directory indicates that Thomas E. and Janet Eden were new residents at this address.
1973	Danny J. and Mary Cole, renters Department manager, Reynolds-Penland, men's and boy's clothing, 721 Congress Avenue and Highland Mall.
1968	John B. Payne, renter No occupation listed
1962	Robert D. and Lula Whitley, renters Pilot, J. Sidney Wheless, Jr., oil operator, 502 Scarbrough Building. NOTE: J. Sidney Wheless, Jr. lived in Kerrville, Texas. NOTE: Robert D. Whitley is believed to have died in Corpus Christi in 1993.
1959	Robert D. and Lula Whitley, renters Pilot, J. Sidney Wheless, Jr., oil operator, 503 Scarbrough Building. NOTE: J. Sidney Wheless, Jr. lived at 1804 Vista Lane. NOTE: Monroe D. Walden is listed as a driver for Maplewood School; he lived at 2707 Pegram Avenue. Thelma Walden is not listed in the directory.
1955	Monroe D. and Thelma Walden, owners Custodian, public schools NOTE: Robert D. and Lula Whitley are listed in Brownsville, Texas, where he was employed by Border Aircraft.
1953	Monroe D. and Thelma L. Walden, owners Employed by Casis Elementary School NOTE: Dudley L. Walden is listed as a salesman for Gugenheim-Goldsmith, a wholesale grocery business, but had no residential address listed in the directory. Maxine L. Walden is listed as a clerk for the State Bureau of Identification and Records, and lived at 616 St. Johns.
1952	Dudley L. and Maxine Walden, owners Clerk, Schuhmacher Company, wholesale groceries, 400 San Antonio Street.

NOTE: Monroe and Elma [?] Walden are listed at 3708 Crawford Avenue; he was a custodian.

1949

The address is not listed in the directory.

NOTE: Dudley and Maxine Walden are listed at 5402 Grover Avenue; he was a clerk at the Rosedale Grocery, 4902 Burnet Road.

NOTE: Monroe Walden is not listed in the directory.

BIOGRAPHICAL NOTES

Dudley L. and Maxine Walden (ca. 1950 – ca. 1952)

Dudley L. Walden appears in the 1940 U.S. Census as the 14-year old nephew of Arthur and Margaret Walden, who owned their home in Justice Precinct 4 of Travis County. Dudley Walden was born in Texas and had no occupation listed. His uncle, Arthur Walden, was a farmer. Dudley's father, Claude H. Walden was a 46-year old Texas-born widower, is listed as a farm laborer. Dudley had a younger brother, Kenneth.

Dudley L. Walden

Dudley L. Walden, age 74, passed away at his home September 21, 1999.

He is survived by his wife, Betty; daughter, Deborah Clark and husband, Ted; grandsons, Michael, Greg and Wesley, of Cordele, Georgia; son, Jimmy Walden; granddaughters, Amy and Jennifer, of Georgia; and brother, Kenneth Walden and wife, Carleeta, of Austin.

Dudley worked with his long time friend, L.O. Guerrero at his wholesale Produce Co. before retirement in 1983, due to his health. He loved people and life, and will be missed dearly by family and friends.

A graveside service will be held at 2:00 p.m. on Thursday, September 23, 1999, at Forest Oaks Memorial Park, officiated by his close friend, Pastor Irving Raymond.

Arrangements by Wilke-Clay-Fish Funeral Home, 2620 S. Congress, 4421446.

Obituary of Dudley L. Walden
Austin American-Statesman, September 23, 1999

Monroe D. and Thelma Walden (ca. 1952 – ca. 1957)

Monroe D. and Thelma L. Walden appear in the 1940 U.S. Census as the owners of a home in Justice Precinct 4, Travis County. Monroe D. Walden was 33, had been born in Texas, and was a farmer. Thelma L. Walden was 26, had been born in Texas, and had no occupation listed. They had 3 daughters: Margie, 8; Dana M., 2; and Bessie L., 4 months. The girls had all been

born in Texas. Also at the house was a hired hand, Andrew A. Blackshear, a 48-year old divorced man who had been born in Texas, and was listed as a farm laborer.

Monroe D. Walden

Monroe D. Walden, age 76, of Austin, passed away Tuesday in an Austin nursing home.

He was born July 1, 1906 in Travis County and had been a lifelong resident of Austin. He was employed by the Austin Public School System and was a member of St. Andrews Presbyterian Church.

Funeral services will be held 2:00 PM Thursday in the Palm Valley Lutheran Church in Round Rock, Dr. James Rigby and Pastor Oliver Berglund officiating. Burial will be in the Palm Valley Cemetery.

Survivors are his wife, Mrs. Thelma Walden of Austin; three daughters, Miss Margie Walden, Austin, Mrs. Bess Hester and Mrs. Dana Noren, both of Round Rock; four grandchildren.

Arrangements under the direction of Condra Funeral Home, Round Rock.

Obituary of Monroe Walden
Austin American-Statesman, February 24, 1983

Thelma Lee Walden Obituary



Thelma Lee Walden Thelma Lee Walden, 99, of Round Rock, Texas, passed away on December 4, 2012. She was born on February 10, 1913, in Austin, Texas, to George and Maudie (Lookingbill) King. Mrs. Walden was preceded in death by her husband, Monroe D. Walden. She is survived by her daughters, Dana Noren and husband Morris, Bess Hester, and Margie Walden all of Round Rock; grandchildren, Douglas Noren and wife Debbie; Brian Hester and wife Cheryl; Pamela O'Neal and husband Paul Mickelson; Carla Strother and husband Tony; great granddaughters, Kaycie, Kaytlin, and McKenzie Moore; Alina and Zara Mickelson; Tristan Hester; great grandson, Colin Hester; and numerous nieces and nephews. Viewing will be at 1:00 p.m. with funeral services at 2:00 p.m. Saturday, December 8, 2012 at Palm Valley Lutheran Church, Round Rock, Texas. Interment will immediately follow in the church cemetery. In lieu of flowers, donations in memory of Thelma Walden may be made to Palm Valley Lutheran Church.

Obituary of Thelma Walden
 Austin American-Statesman, December 7, 2012

J. V. Walden 5311 Roosevelt Ave.
 200 29 1 - -
 Walling Place

Cutstone veneer residence and carport
 attached.
 43164 1-23-50 \$5000.00

Owner

5

Building permit to J.V. Walden for the construction of this house (1950)

lot 29
Blk 1

WATER SERVICE PERMIT C No. ²⁰⁰ 5614
 Austin, Texas

Received of J.V. WALDEN Date 3-20-50
 Address 5311
5313 ROOSEVELT
 Amount TWENTY + NO. 100 \$ 20.00
 Plumber FREY Size of Tap 3/4"

Date of Connection 3-23-50

No. Fittings	Size	
1	Curb Cock	5/8"
2	Elbow	3/4" copy -
	St. Elbow	
	Bushing	
	Reducer	
	Pipe	
	Lead Comp.	
	Nipples	
	Union	
	Plug	
	Tee	
1	Box	1" 4 1/2"
	Lid	
	Valves	
	Job No.	22-323-50
	P. q. No.	419222k

Size Main Tapped _____
 From Front Prop. Line to Curb Cock 2.5
 From Prop. Line to Curb Cock _____
 Location of Meter on 22
 Type of Box low
 Depth of Main in St. _____
 Depth of Service Line _____
 From Curb Cock to Tap on Main _____
 Checked by Engr. Dept. Apr 4-10-50

INDEXED

Water service permit to J.V. Walden for this address (1950)

26x2 - *Paving out*
 Receipt No. 14165 Application for Sewer Connection No. 42773A

M.O. 1155323
 Austin, Texas, 4-14- 1950

To the Superintendent of Sanitary Sewer Division, City of Austin, Texas.

Sir:—

I hereby make application for sewer connection and instructions on premises owned by J.V. Walden at 5311 Roadcrest Ave Street,
 further described as Lot 2829 Block 1 Outlot — Division —
 subdivision Northrop Terrace Plate 200 which is to be used as a Res.
 In this place there are to be installed 5 fixtures. Plumbing Permit No. 37671
 I agree to pay the City of Austin, the regular ordinance charge.

Depth at Prop. Line 3'

4' at main 4-17-50
 Respectfully,

~~Sub-Conn~~ Connected } 18' S of NLL
 (Location)

Date 5-24-50

By Severy

NOTE: Connection Instruction

6' Dia in St ± 4' Delg
Main 12.5' E of RR (Rock) A. 2032

Sewer connection application by J.V. Walden for this address (1950)