

EXHIBIT A

C7a-2015-0008

Area to be annexed.

(Approximately 263 acres of land out of the Mariguita Castro Survey No. 50, Abstract No. 160 in Travis County, Texas)

(Howard Subdivision, Cantarra Section IIB-1, Cantarra Section IIB-2 and Cantarra Section IIIA) (Unplatted Land)

(Portions of East Howard Lane)

LEGAL DESCRIPTION

LEGAL DESCRIPTION FOR TEN TRACTS OF LAND, THE TRACT HEREINAFTER DESCRIBED AS TRACT ONE CONTAINING APPROXIMATELY 30.330 ACRES OF LAND OUT OF THE MARIGUITA CASTRO SURVEY NO. 50, ABSTRACT NO. 160 IN TRAVIS COUNTY, TEXAS, THE TRACT HEREINAFTER DESCRIBED AS TRACT TWO CONTAINING APPROXIMATELY 27.530 ACRES OF LAND OUT OF THE MARIGUITA CASTRO SURVEY NO. 50, ABSTRACT NO. 160 IN TRAVIS COUNTY, TEXAS, THE TRACT HEREINAFTER DESCRIBED AS TRACT THREE CONTAINING APPROXIMATELY 119.389 ACRES OF LAND OUT OF THE MARIGUITA CASTRO SURVEY NO. 50, ABSTRACT NO. 160 IN TRAVIS COUNTY, TEXAS, THE TRACT HEREINAFTER DESCRIBED AS TRACT FOUR CONTAINING APPROXIMATELY 48.812 ACRES OF LAND OUT OF THE MARIGUITA CASTRO SURVEY NO. 50, ABSTRACT NO. 160 IN TRAVIS COUNTY, TEXAS, THE TRACT HEREINAFTER DESCRIBED AS TRACT FIVE CONTAINING APPROXIMATELY 10.00 ACRES OF LAND OUT OF THE MARIGUITA CASTRO SURVEY NO. 50, ABSTRACT NO. 160 IN TRAVIS COUNTY, TEXAS, THE TRACT HEREINAFTER DESCRIBED AS TRACT SIX CONTAINING APPROXIMATELY 6.160 ACRES OF LAND OUT OF THE MARIGUITA CASTRO SURVEY NO. 50, ABSTRACT NO. 160 IN TRAVIS COUNTY, TEXAS, THE TRACT HEREINAFTER DESCRIBED AS TRACT SEVEN CONTAINING APPROXIMATELY 6.535 ACRES OF LAND OUT OF THE MARIGUITA CASTRO SURVEY NO. 50, ABSTRACT NO. 160 IN TRAVIS COUNTY, TEXAS, THE TRACT HEREINAFTER DESCRIBED AS TRACT EIGHT CONTAINING APPROXIMATELY 8.952 ACRES OF LAND OUT OF THE MARIGUITA CASTRO SURVEY NO. 50,

ABSTRACT NO. 160 IN TRAVIS COUNTY, TEXAS, THE TRACT HEREINAFTER DESCRIBED AS TRACT NINE CONTAINING APPROXIMATELY 3 ACRES OF LAND OUT OF THE MARIGUITA CASTRO SURVEY NO. 50, ABSTRACT NO. 160 IN TRAVIS COUNTY, TEXAS AND THE TRACT HEREINAFTER DESCRIBED AS TRACT TEN CONTAINING APPROXIMATELY 1.8 ACRES OF LAND OUT OF THE MARIGUITA CASTRO SURVEY NO. 50, ABSTRACT NO. 160 IN TRAVIS COUNTY, TEXAS; OF WHICH APPROXIMATELY 263 ACRES OF LAND ARE TO BE MADE PART OF THE CITY OF AUSTIN, SAID APPROXIMATELY 263 ACRES BEING MORE PARTICULARLY DESCRIBED AS FOLLOWS:

TRACT ONE

BEING approximately 30.330 acres being a portion of Cantarra Revised Preliminary Plan (Case No. C8J-05-0236.03) and being the remaining portion of that called 43.025 acre tract of land conveyed to Cantarra Ventures, Ltd. By Special Warranty Deed recorded in Document No. 2008063044 of the Official Public Records of Travis County, Texas.

TRACT TWO

BEING approximately 27.530 acres being a portion of Cantarra Revised Preliminary Plan (Case No. C8J-05-0236.03) and being the remaining portion of that called 36.482 acre tract of land conveyed to Continental Homes of Texas, L.P. by Special Warranty Deed recorded in Document No. 2015028069 of the Official Public Records of Travis County, Texas.

TRACT THREE

BEING approximately 119.389 acres being a portion of Cantarra Revised Preliminary Plan (Case No. C8J-05-0236.03) and being all of that called 119.389 acre tract of land conveyed to Continental Homes of Texas, L.P. by Special Warranty Deed recorded in Document No. 2015028058 of the Official Public Records of Travis County, Texas.

TRACT FOUR

BEING all of approximately 48.812 acres of land as shown on a Preliminary Plan for Cantarra II (Case No. C8J-2014-0138) and being the remaining portion of a called 49.81 acre tract of land conveyed to Ada M. Ellison by Special Warranty Deed recorded in Volume

11688, Page 462 of the Real Property Records of Travis County, Texas.

TRACT FIVE

BEING approximately 10.00 acres of land known as Howard Subdivision, a subdivision of record in Document No. 201400065 of the Official Public Records of Travis County, Texas. Said Howard Subdivision to be vacated and replatted as Howard Subdivision Replat (Case No. C8J-2015-0117.0A).

TRACT SIX

BEING approximately 6.160 acres of land known as Cantarra Section IIB-1, a subdivision of record in Document No. 201400293 of the Official Public Records of Travis County, Texas.

TRACT SEVEN

BEING approximately 6.535 acres of land known as Cantarra Section IIB-2, a subdivision of record in Document No. 201400294 of the Official Public Records of Travis County, Texas.

TRACT EIGHT

BEING approximately 8.952 acres of land known as Cantarra Section IIIA, a subdivision of record in Document No. 201500162 of the Official Public Records of Travis County, Texas.

TRACT NINE

BEING approximately 3 acres being that portion of East Howard Lane bounded on the west by the southerly prolongation of the westerly line of said 30.330 acre tract to a point on the southerly right-of-way line of East Howard Lane and bounded on the east by the southerly prolongation of the westerly right-of-way line of Cantarra Drive as shown and dedicated by plat for Cantarra Section One, a subdivision of record in Document No. 200800024 of the Official Public Records of Travis County, Texas, same being the present corporate limit line of the City of Austin as adopted by Ordinance No. 20071206-016 (Case No. C7a-07-024), to a point on the southerly right-of-way line of East Howard Lane.

TRACT TEN

BEING approximately 1.8 acres being that portion of East Howard Lane bounded on the west by the southerly prolongation of the westerly line of said Ada M. Ellison 49.81 acre tract, same being the present corporate limit line of the City of Austin as adopted by Ordinance No. 20071206-016 (Case No. C7a-07-024), to a point on the southerly right-of-way line of East Howard Lane and bounded on the east by the southerly prolongation of the easterly line of said Ada M. Ellison 49.81 acre tract to a point on the southerly right-of-way line of East Howard Lane.

"This document was prepared under 22 TAC 663.21, does not reflect the results of an on the ground survey, and is not to be used to convey or establish interests in real property except those rights and interests implied or established by the creation or reconfiguration of the boundary of the political subdivision for which it was prepared".

LEGAL DESCRIPTION: Mary P. Hawkins
09-17-2015

Mary P. Hawkins 10-20-15



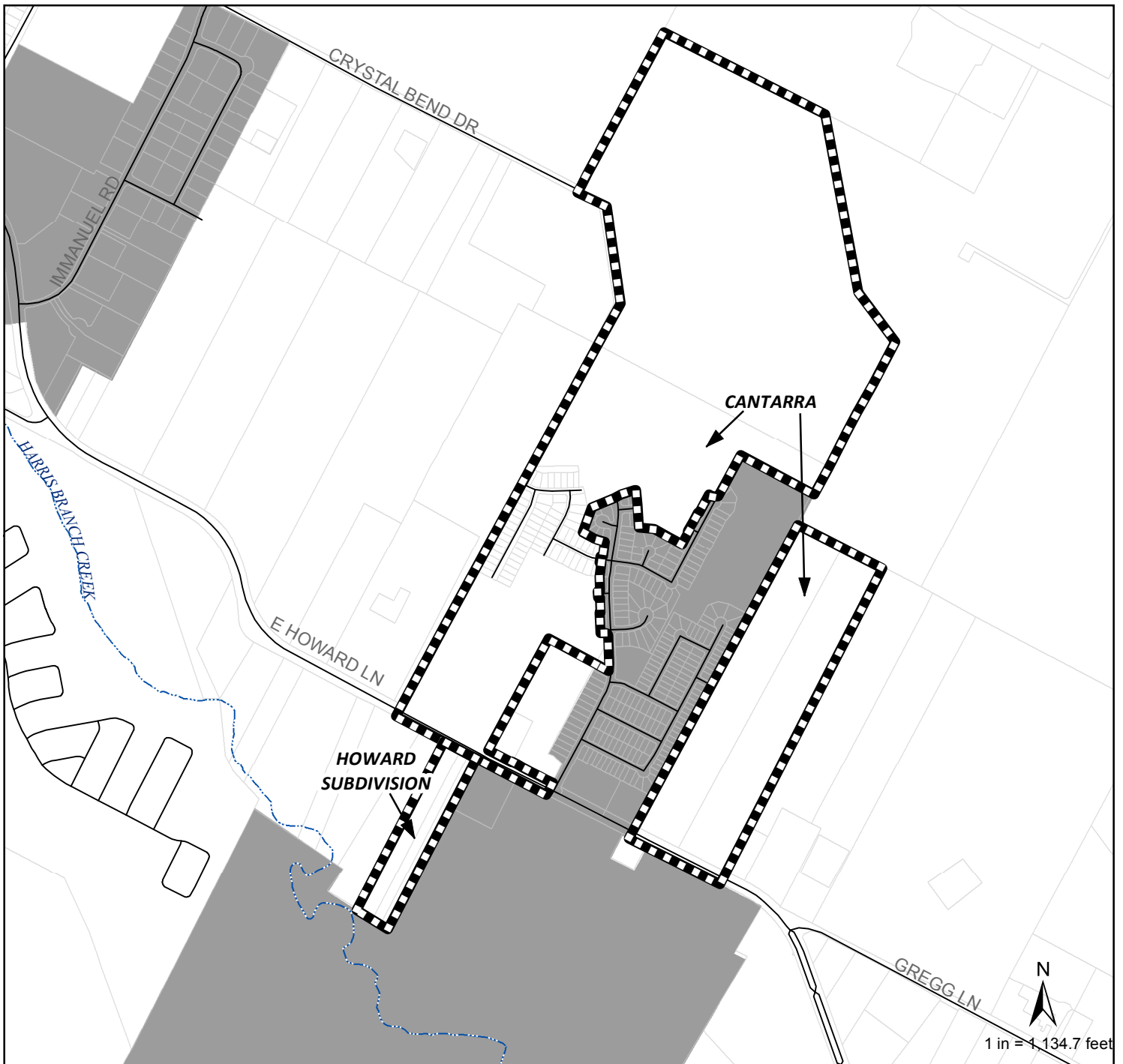

APPROVED: Mary P. Hawkins, RPLS No. 4433
Quality Management Division
Department of Public Works
City of Austin

REFERENCES

Austin Grid Q-32, Q-33 & Q-34
TCAD MAPS 2-5131, 2-5141 & 2-5941





Cantarra/Howard Subdivision Annexation Area

-  Cantarra/Howard Subdivision Annexation Area
-  Parcels
-  Streets
-  Major Creeks

This product has been produced by the Planning and Zoning Department for the sole purpose of geographic reference. No warranty is made by the City of Austin regarding specific accuracy or completeness. All data by City of Austin except where otherwise indicated.

Austin Jurisdiction

-  Austin Full Purpose
-  Austin Limited Purpose
-  Austin ETJ

This product is for informational purposes and may not have been prepared for or be suitable for legal, engineering, or surveying purposes. It does not represent an on-the-ground survey and represents only the approximate relative location of property boundaries.

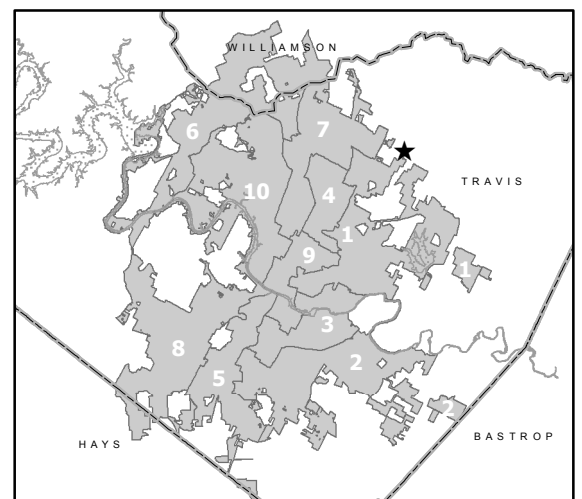

City of Austin
Planning and Zoning Department
August 21, 2015

**Cantarra/Howard Subdivision Area in
Relation to 2015 Austin City Council Districts**