

EXHIBIT A

C7a-2015-0010

Area to be annexed.

(Approximately 165 acres of land out of the Patterson Moore Survey No. 84, Abstract No. 563, the Alexander Eanes Survey, Abstract No. 270 and the John L. Bray Survey No. 72, Abstract No. 74 in Travis County, Texas)

(Unplatted Land)

(Portion of Lost Creek Boulevard)

LEGAL DESCRIPTION

LEGAL DESCRIPTION FOR TWO TRACTS OF LAND, THE TRACT HEREINAFTER DESCRIBED AS TRACT ONE CONTAINING APPROXIMATELY 163.97 ACRES OF LAND OUT OF THE PATTERSON MOORE SURVEY NO. 84, ABSTRACT NO. 563, THE ALEXANDER EANES SURVEY, ABSTRACT NO. 270 AND THE JOHN L. BRAY SURVEY NO. 72, ABSTRACT NO. 74 IN TRAVIS COUNTY, TEXAS AND THE TRACT HEREINAFTER DESCRIBED AS TRACT TWO CONTAINING APPROXIMATELY 0.8 ACRE OUT OF THE JOHN L. BRAY SURVEY NO. 72, ABSTRACT NO. 74; OF WHICH APPROXIMATELY 165 ACRES OF LAND ARE TO BE MADE PART OF THE CITY OF AUSTIN, SAID APPROXIMATELY 165 ACRES BEING MORE PARTICULARLY DESCRIBED AS FOLLOWS:

TRACT ONE

BEING approximately 163.97 acres of land out of that called 174.56 acre tract of land conveyed to Hill Country Golf, Inc. by Deed Without Warranty recorded in Document No. 2011179843 of the Official Public Records of Travis County, Texas, save and except that called 10.59 acre tract of land described as part of the Lost Creek Municipal Utility District by Amended and Restated Strategic Partnership Agreement Between the City of Austin and Lost Creek Municipal Utility District as adopted by City of Austin Ordinance No. 20130606-028

TRACT TWO

BEING approximately 0.8 acre of land being that portion of Lost Creek Boulevard bounded on the east by southerly prolongation of the common line of said 174.56 acre tract and The Valley at Lost Creek, a subdivision of record in Book 76, Page 312 of the Plat

Records of Travis County, Texas to the southerly right-of-way line of Lost Creek Boulevard and bounded on the west by the southerly prolongation of the common line of said 174.56 acre tract and a called 30.029 acre tract of land referred to as Parcel 19, Tract II by General Warranty Deed recorded in Volume 11706, Page 447 of the Real Property Records of Travis County, Texas to a point on the southerly right-of-way line of Lost Creek Boulevard.

"This document was prepared under 22 TAC 663.21, does not reflect the results of an on the ground survey, and is not to be used to convey or establish interests in real property except those rights and interests implied or established by the creation or reconfiguration of the boundary of the political subdivision for which it was prepared".

LEGAL DESCRIPTION: Mary P. Hawkins
09-17-2015

Mary P. Hawkins 10-21-15



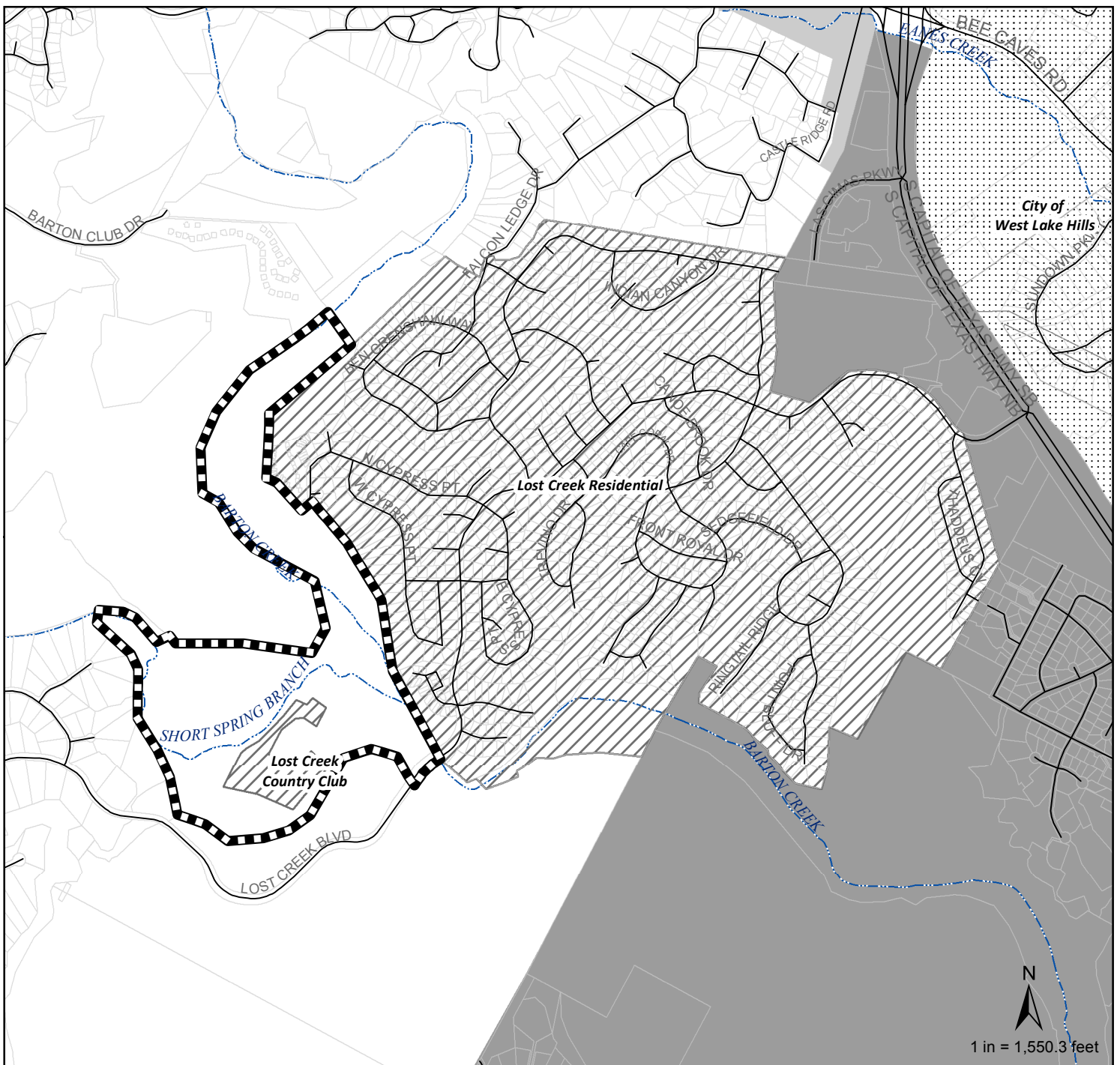

APPROVED: Mary P. Hawkins, RPLS No. 4433
Quality Management Division
Department of Public Works
City of Austin

REFERENCES





Austin Grid C-23, D-22, D-23 & D-24
TCAD MAPS 1-0237 & 1-1037



Lost Creek Connector Piece Annexation Area

-  Lost Creek Connector Piece Annexation Area
-  Lost Creek MUD
-  Parcels
-  Streets
-  Major Creeks

Jurisdictions

-  Austin Full Purpose
-  Austin Limited Purpose
-  Austin ETJ
-  Other City or ETJ

This product has been produced by the Planning and Zoning Department for the sole purpose of geographic reference. No warranty is made by the City of Austin regarding specific accuracy or completeness. All data by City of Austin except where otherwise indicated.

This product is for informational purposes and may not have been prepared for or be suitable for legal, engineering, or surveying purposes. It does not represent an on-the-ground survey and represents only the approximate relative location of property boundaries.

