

EXHIBIT A

C7a-2015-0012

Area to be annexed.

(Approximately 83 acres of land out of the John T. Smith Survey No. 154, Abstract No. 733, the John E. Linn Survey No. 454, Abstract No. 494, the Henry Bond Survey No. 51, Abstract No. 103 and the Green McCoy Survey No. 29, Abstract No. 514 in Travis County, Texas)

(Walden Oaks)

(Unplatted Land)

(Portion of Old Lampasas Trail)

LEGAL DESCRIPTION

LEGAL DESCRIPTION FOR SIX TRACTS OF LAND, THE TRACT HEREINAFTER DESCRIBED AS TRACT ONE CONTAINING APPROXIMATELY 23.378 ACRES OF LAND OUT OF THE JOHN T. SMITH SURVEY NO. 154, ABSTRACT NO. 733 AND THE JOHN E. LINN SURVEY NO. 454, ABSTRACT NO. 494 IN TRAVIS COUNTY, TEXAS, THE TRACT HEREINAFTER DESCRIBED AS TRACT TWO CONTAINING APPROXIMATELY 11.04 ACRES OF LAND OUT OF THE HENRY BOND SURVEY NO. 51, ABSTRACT NO. 103 AND THE GREEN MCCOY SURVEY NO. 29, ABSTRACT NO. 514 IN TRAVIS COUNTY, TEXAS, THE TRACT HEREINAFTER DESCRIBED AS TRACT THREE CONTAINING APPROXIMATELY 10.800 ACRES OF LAND OUT OF THE GREEN MCCOY SURVEY NO. 29, ABSTRACT NO. 514 IN TRAVIS COUNTY, TEXAS, THE TRACT HEREINAFTER DESCRIBED AS TRACT FOUR CONTAINING APPROXIMATELY 2.409 ACRES OF LAND OUT OF THE GREEN MCCOY SURVEY NO. 29, ABSTRACT NO. 514 IN TRAVIS COUNTY, TEXAS, THE TRACT HEREINAFTER DESCRIBED AS TRACT FIVE CONTAINING APPROXIMATELY 29.870 ACRES OUT OF THE JOHN E. LINN SURVEY NO. 454, ABSTRACT NO. 494 AND THE HENRY BOND SURVEY NO. 51, ABSTRACT NO. 103 IN TRAVIS COUNTY, TEXAS AND THE TRACT HEREINAFTER DESCRIBED AS TRACT SIX CONTAINING APPROXIMATELY 5.6 ACRES OF LAND OUT OF THE JOHN T. SMITH SURVEY NO. 154, ABSTRACT NO. 733, THE JOHN E. LINN SURVEY NO. 454, ABSTRACT NO. 494, THE HENRY BOND SURVEY NO. 51, ABSTRACT NO. 103 AND

THE GREEN MCCOY SURVEY NO. 29, ABSTRACT NO. 514
IN TRAVIS COUNTY, TEXAS; OF WHICH APPROXIMATELY
83 ACRES OF LAND ARE TO BE MADE PART OF THE
CITY OF AUSTIN, SAID APPROXIMATELY 83 ACRES
BEING MORE PARTICULARLY DESCRIBED AS FOLLOWS:

TRACT ONE

BEING all of that called 23.378 acre tract of land conveyed to Elias F. Meyer, Jr. and Betty B. Meyer by Warranty Deed recorded in Document No. 2000020491 of the Official Public Records of Travis County, Texas.

TRACT TWO

BEING all of that called 11.04 acre tract of land conveyed to William Gene Sanchez, Jr., Rachel Marie Sanchez and Elizabeth A. Peka by Special Warranty Deed recorded in Document No. 2012120774 of the Official Public Records of Travis County, Texas.

TRACT THREE

BEING all of that called 10.800 acre tract of land conveyed to Hallmark Baptist Church by Volume 11103, Page 1718 of the Real Property Records of Travis County, Texas.

TRACT FOUR

BEING all of that called 2.409 acre tract of land conveyed to Pedernales Electric Cooperative, Inc. by Warranty Deed recorded in Volume 7745, Page 722 of the Deed Records of Travis County, Texas.

TRACT FIVE

BEING approximately 29.870 acres of land known as Walden Oaks, a subdivision of record in Book 90, Pages 343-345 of the Plat Records of Travis County, Texas.

TRACT SIX

BEING approximately 5.6 acres of land being that portion of Old Lampasas Trail, bounded on the west by its western terminus, same being the eastern terminus of Pickfair Drive and bounded on the east by the northerly prolongation of the common line of said Pedernales Electric Cooperative, Inc. 2.409 acre tract and Lot 20,

Block A, Bull Creek Ranch, a subdivision of record in Document No. 200200227 of the Official Public Records of Travis County, Texas to the northerly right-of-way line of Old Lampasas Trail.

"This document was prepared under 22 TAC 663.21, does not reflect the results of an on the ground survey, and is not to be used to convey or establish interests in real property except those rights and interests implied or established by the creation or reconfiguration of the boundary of the political subdivision for which it was prepared".

LEGAL DESCRIPTION: Mary P. Hawkins
09-18-2015

Mary P. Hawkins 10-21-15

APPROVED: Mary P. Hawkins, RPLS No. 4433
Quality Management Division
Department of Public Works
City of Austin

REFERENCES

Austin Grid F-35
TCAD MAPS 1-5918 & 1-5927

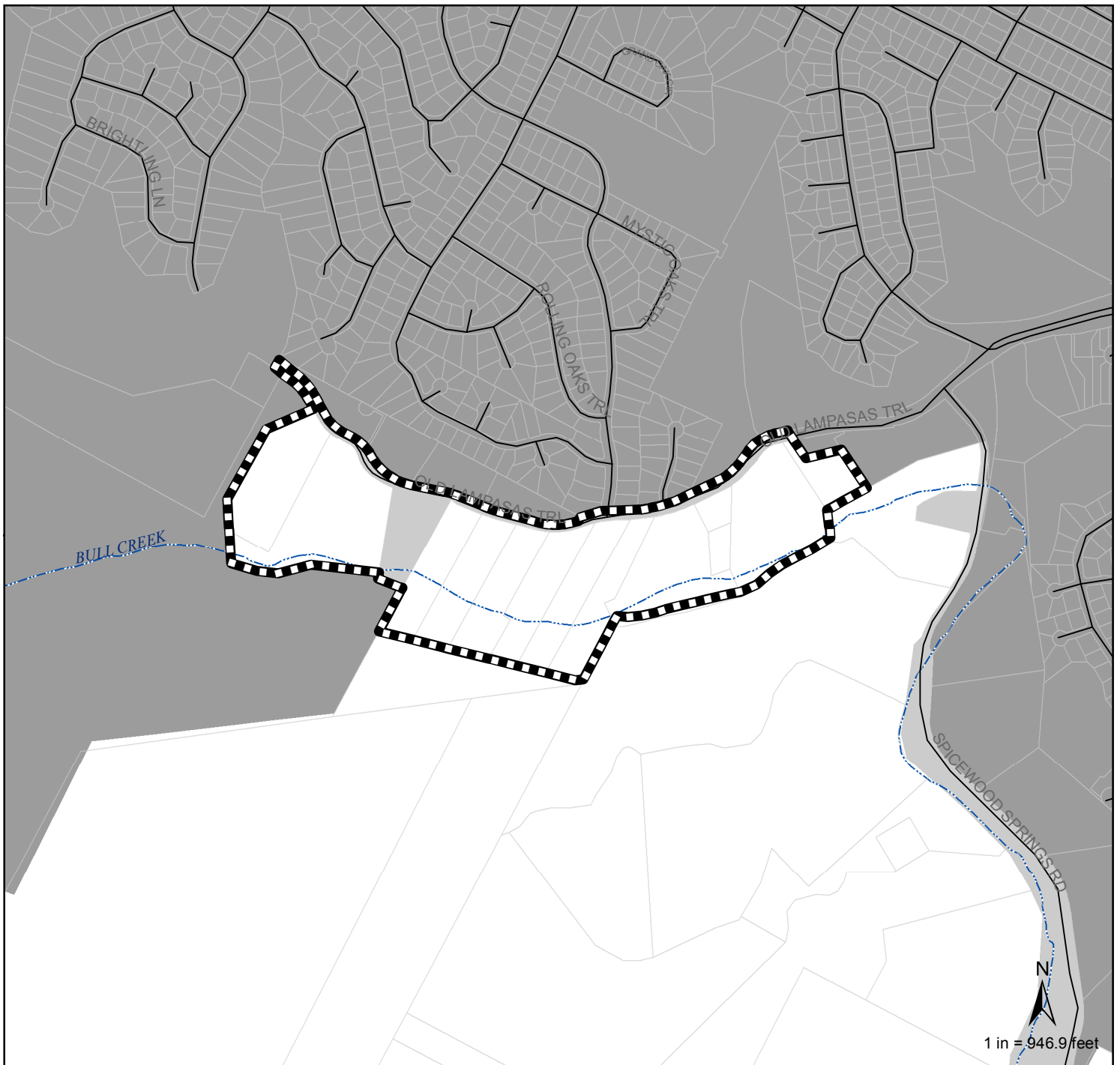

Old Lampasas Trail Annexation Area

 Old Lampasas Trail Annexation Area

 Parcels

 Streets

 Major Creeks

This product has been produced by the Planning and Zoning Department for the sole purpose of geographic reference. No warranty is made by the City of Austin regarding specific accuracy or completeness. All data by City of Austin except where otherwise indicated.

Austin Jurisdiction

 Austin Full Purpose

 Austin Limited Purpose

 Austin ETJ

This product is for informational purposes and may not have been prepared for or be suitable for legal, engineering, or surveying purposes. It does not represent an on-the-ground survey and represents only the approximate relative location of property boundaries.

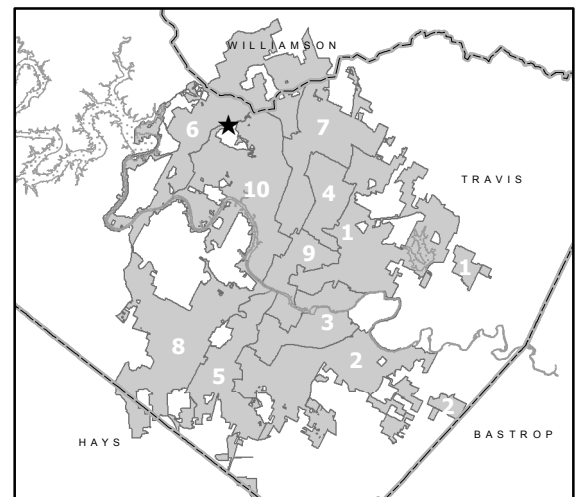

**Old Lampasas Trail Area in Relation to
2015 Austin City Council Districts**



City of Austin
Planning and Zoning Department
August 21, 2015