

SUBDIVISION REVIEW SHEET**CASE NO.:** C8-2015-0153.0A**P.C. DATE:** December 8, 2015**SUBDIVISION NAME:** Austin Mall Lot 4; Resubdivision**AREA:** 17.28**LOT(S):** 4**OWNER/APPLICANT:** Austin Community College District (Richard M. Rhodes, PHD)**AGENT:** Bury Inc. (Craig M. Chonko)**ADDRESS OF SUBDIVISION:** 5901 Airport Blvd.**GRIDS:** K27**COUNTY:** Travis**WATERSHED:** Tannehill Branch / Waller Creek**JURISDICTION:** Full-Purpose**EXISTING ZONING:** CS-MU-V-NP**MUD:** N/A**NEIGHBORHOOD PLAN:** Brentwood/Highland Plan Combining District**PROPOSED LAND USE:** Commercial**VARIANCES:** None**SIDEWALKS:** Sidewalks are required.**DEPARTMENT COMMENTS:** The request is for approval of the Austin Mall Lot 4; Resubdivision. The proposed plat is composed of 4 lots on 17.28 acres.**STAFF RECOMMENDATION:** The staff recommends approval of the plat. This plat now meets all applicable State and City of Austin LDC requirements.**PLANNING COMMISSION ACTION:****CASE MANAGER:** David Wahlgren**PHONE:** (512) 974-6455Email address: david.wahlgren@austintexas.gov

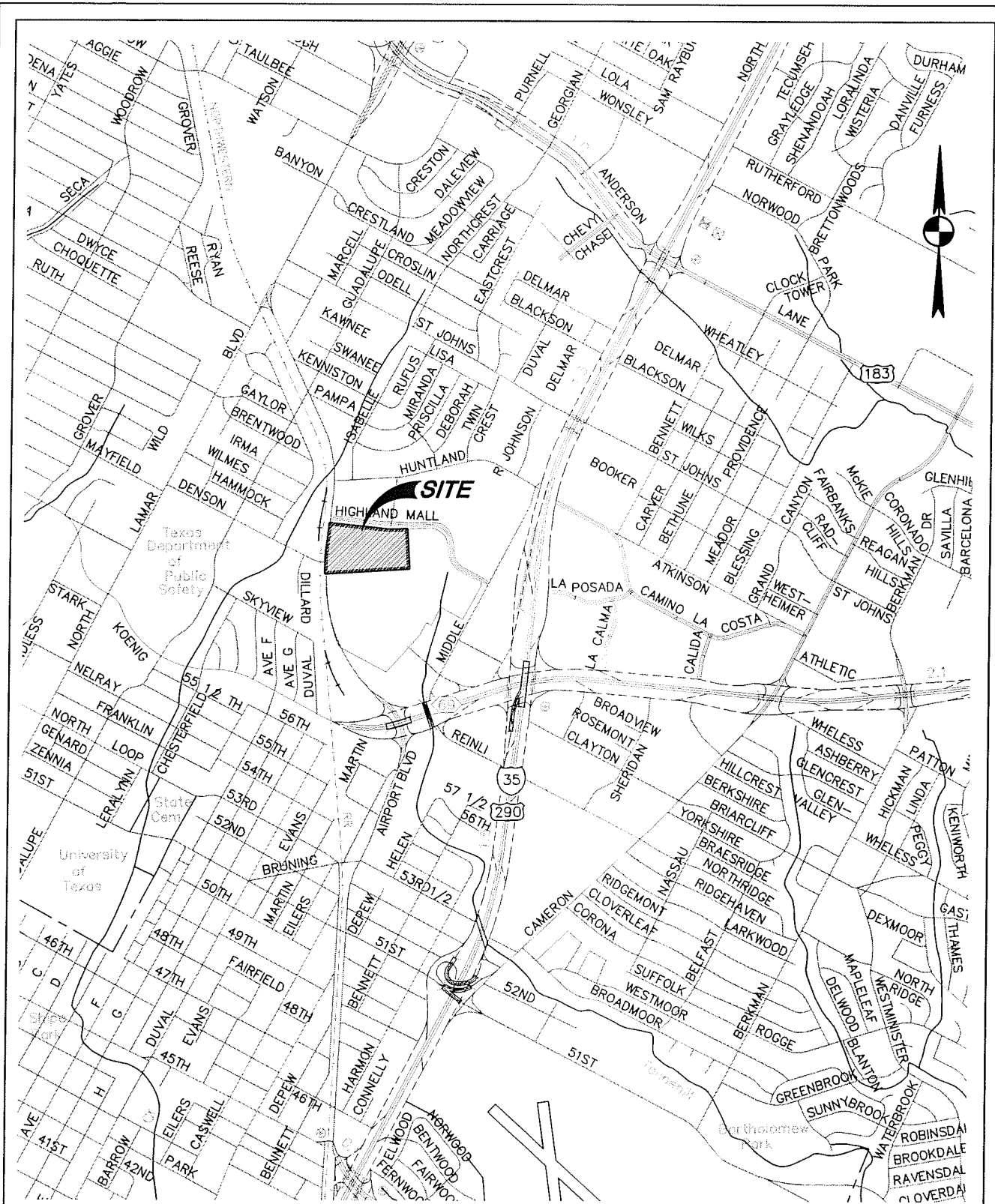

BURY

221 West Sixth Street, Suite 600
Austin, Texas 78701
Tel. (512) 328-0011 Fax (512) 328-0325
TBPE # F-1048 TBPLS # F-10107500
Copyright © 2015

HIGHLAND DEVELOPMENT LOTS - 4
AIRPORT BLVD., AUSTIN, TEXAS

REDLEAF PROPERTIES

SITE LOCATION
MAP

DATE: APRIL 24, 2015

SCALE:

1:2000

DRAWN BY: BIL/JEB

FILE

103017004-MAP.DWG

PROJECT No.

R0103017-10004

[illegible]

VICINITY MA

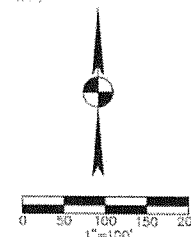

LOT 1, BLOCK A
JOHNS COMMERCIAL
SECTION ONE
BLOCK 16, PAGE 50

LOT 1, BLOCK B
JOHN COMMERCIAL
SECTION ONE
BOOK 15, PAGE 50

LOT 3
SERVICE MERCHANDISE
SUBDIVISION
BOOK 92,
PAGES 63-64

LOT 4
SERVICE MERCHANDISE SUBDIVISION
BOOK 92, PAGES 63-64

LOT 5-B
RESUBDIVISION OF LOT 5
AUSTIN MALL
BOOK 51, PAGE 9

30 CRANFORD ESTATE
VOLUME 48, PAGE 112
VOLUME 35, PAGE 8
VOLUME 58, PAGE 48
VOLUME 231, PAGE 248

AIRPORT BOULEVARD
(120' R.O.W.)

LOT 4A
4.291 ACRES

HIGHLAND CAMPUS DRIVE
S21°25'01"W 842.33'

WILL DAVIS DRIVE
(PRIVATE)

LOT 4C
8.747 ACRES

LOT 4D
.583 ACRES

LOT 3E
RESUBDIVISION OF
LOTS 3A, 3B-1,
3C-1, 3D, 6A-2 AND
6B-2 AUSTIN MALL
BOOK 77, PAGES 60-61

SPR 29 44 W 345 54
DENSON DRIVE (PRIVATE)

LOT 4B
0.661 ACRE

LOT 3E
ON OF LOTS 3A, 3B,
D, 5A-2 AND 5B-2
USTIN MALL
77, PAGES 60-61

LINE TABLE		
NO.	BEARING	DISTANCE
11	S 74° 45' E	82.4

RESUBDIVISION OF LOT 4
AUSTIN MALL

A 4 LOT SUBDIVISION
CONSISTING OF 17.282 ACRES

DATE: OCTOBER 2015

BURY

221 West Sixth Street, Suite 800
Austin, Texas 78701
Tel. (512) 328-6815 Fax (512) 328-0325
TDD: (512) 328-6815 TDD: (512) 328-0325
Copyright © 2015

LEGEND

- 1/2" IRON ROD FOUND (UNLESS NOTED)
 - 1/2" IRON ROD WITH "BURY" CAP SET
 - ⊗ "X" FOUND IN CONCRETE
 - △ 1/2" IRON ROD WITH "BURY" CAP SET
 - ▲ 1/2" IRON ROD WITH "BURY" CAP SET
- * * * * * SIDEWALK

BEARING BASIS NOTE:

THE BASIS OF BEARINGS IS REFERENCED TO THE TEXAS COORDINATE SYSTEM, CENTRAL ZONE, NAD 83(93) BY LINKING THE CITY OF AUSTIN GPS CONTROL MONUMENTS AS FOLLOWS:

CURVE TABLE

NO.	LENGTH	RADIUS	DELTA	CHORD BEARING	CHORD LENGTH
C1	112.82'	682.75'	9°28'04"	S89°47'49"E	112.82'
C2	384.13'	2804.79'	7°14'03"	N02°20'38"E	384.13'
C3	24.03'	15.00'	91°57'02"	N65°03'45"E	25.55'
C4	82.31'	2806.20'	1°45'07"	S00°32'58"E	82.31'
C5	85.16'	2813.66'	1°01'17"	S00°58'06"E	85.16'
C6	201.47'	2803.48'	1°21'34"	S03°45'06"E	221.41'

SHEET
1
OF 2