

ORDINANCE NO. 20151217-079

AN ORDINANCE ANNEXING, FOR FULL PURPOSES, ADDITIONAL TERRITORY ADJACENT TO THE CITY LIMITS OF THE CITY OF AUSTIN REFERRED TO AS THE "CANTARRA/HOWARD SUBDIVISION" ANNEXATION AREA, CONSISTING OF APPROXIMATELY 263 ACRES OF LAND IN NORTHEASTERN TRAVIS COUNTY, TEXAS; AND APPROVING A SERVICE PLAN.

BE IT ORDAINED BY THE CITY COUNCIL OF THE CITY OF AUSTIN:

PART 1. The Council finds that:

- (A) Notice of the two public hearings concerning annexation of the territory described in Exhibit A was published in a newspaper of general circulation in the City of Austin and in the area to be annexed, and on the City of Austin website.
- (B) The public hearings were held on October 1, 2015 and October 15, 2015, at the Austin City Hall, 301 West 2nd Street, Austin, Texas.
- (C) The public hearings were concluded after providing an opportunity for all persons present to be heard with respect to the proposed annexation. A proposed Service Plan was made available and explained at the public hearings required by law.
- (D) The annexation, for full purposes, of the territory described in Exhibit A serves the interest of the current and future residents of the City of Austin.
- (E) All procedural requirements imposed by State Law for the full purpose annexation of the territory described in Exhibit A have been met.
- (F) Construction of subdivision infrastructure within the approved Cantarra Preliminary Plan (C8J-05-0236) has begun in compliance with Travis County regulations.
- (G) The Council wishes to allow an alternative fiscal method for plats within the approved Cantarra Preliminary Plan (C8J-05-0236) to facilitate proper subdivision and development of these tracts.

PART 2. The present boundary limits of the City are amended to include the following territory which is within the extra territorial jurisdiction and adjacent to the city

limits of the City of Austin in Travis County, Texas and which is annexed into the City for full purposes:

Approximately 263 acres of land located in northeastern Travis County north of Howard Lane approximately 700 feet east of the intersection of Howard Lane and Cantarra Drive and also north and south of Howard Lane immediately west of the intersection of Howard Lane and Cantarra Drive, being more particularly described in Exhibit A.

PART 3. The Service Plan attached as Exhibit B is approved as the Service Plan for the area.

PART 4. The City Council declares that its purpose is to annex to the City of Austin each part of the area described in Exhibit A as provided in this ordinance, whether any other part of the described area is effectively annexed to the City. If this ordinance is held invalid as to part of the area annexed to the City of Austin, the invalidity does not affect the effectiveness of this ordinance as to the remainder of the area.

If any area or lands included within the description of the area set out in Exhibit A are: (1) presently part of and included within the general limits of the City of Austin; (2) presently part of and included within the limits of any other city, town or village; or (3) are not within the jurisdiction of the City of Austin to annex, then that area is excluded and excepted from the area annexed.

PART 5. Council allows the use of alternative fiscal provisions outlined in Section 82.401(e) Travis County Development Regulations for the completion of the project defined as the approved Cantarra Preliminary Plan Austin Case No. C8J-05-0236.

PART 6. This ordinance takes effect on December 28, 2015.

PASSED AND APPROVED

_____, December 17, 2015

APPROVED:

Anne L. Morgan
City Attorney

§
§
§

Steve Adler
Mayor

ATTEST:



Jannette S. Goodall
City Clerk

EXHIBIT A

C7a-2015-0008

Area to be annexed.

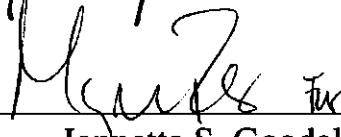
(Approximately 263 acres of land out of the Mariguita Castro Survey No. 50, Abstract No. 160 in Travis County, Texas)

(Howard Subdivision, Cantarra Section IIB-1, Cantarra Section IIB-2 and Cantarra Section IIIA)

(Unplatted Land)

(Portions of East Howard Lane)

LEGAL DESCRIPTION

LEGAL DESCRIPTION FOR TEN TRACTS OF LAND, THE TRACT HEREINAFTER DESCRIBED AS TRACT ONE CONTAINING APPROXIMATELY 30.330 ACRES OF LAND OUT OF THE MARIGUITA CASTRO SURVEY NO. 50, ABSTRACT NO. 160 IN TRAVIS COUNTY, TEXAS, THE TRACT HEREINAFTER DESCRIBED AS TRACT TWO CONTAINING APPROXIMATELY 27.530 ACRES OF LAND OUT OF THE MARIGUITA CASTRO SURVEY NO. 50, ABSTRACT NO. 160 IN TRAVIS COUNTY, TEXAS, THE TRACT HEREINAFTER DESCRIBED AS TRACT THREE CONTAINING APPROXIMATELY 119.389 ACRES OF LAND OUT OF THE MARIGUITA CASTRO SURVEY NO. 50, ABSTRACT NO. 160 IN TRAVIS COUNTY, TEXAS, THE TRACT HEREINAFTER DESCRIBED AS TRACT FOUR CONTAINING APPROXIMATELY 48.812 ACRES OF LAND OUT OF THE MARIGUITA CASTRO SURVEY NO. 50, ABSTRACT NO. 160 IN TRAVIS COUNTY, TEXAS, THE TRACT HEREINAFTER DESCRIBED AS TRACT FIVE CONTAINING APPROXIMATELY 10.00 ACRES OF LAND OUT OF THE MARIGUITA CASTRO SURVEY NO. 50, ABSTRACT NO. 160 IN TRAVIS COUNTY, TEXAS, THE TRACT HEREINAFTER DESCRIBED AS TRACT SIX CONTAINING APPROXIMATELY 6.160 ACRES OF LAND OUT OF THE MARIGUITA CASTRO SURVEY NO. 50, ABSTRACT NO. 160 IN TRAVIS COUNTY, TEXAS, THE TRACT HEREINAFTER DESCRIBED AS TRACT SEVEN CONTAINING APPROXIMATELY 6.535 ACRES OF LAND OUT OF THE MARIGUITA CASTRO SURVEY NO. 50, ABSTRACT NO. 160 IN TRAVIS COUNTY, TEXAS, THE TRACT HEREINAFTER DESCRIBED AS TRACT EIGHT CONTAINING APPROXIMATELY 8.952 ACRES OF LAND OUT OF THE MARIGUITA CASTRO SURVEY NO. 50,

ABSTRACT NO. 160 IN TRAVIS COUNTY, TEXAS, THE TRACT HEREINAFTER DESCRIBED AS TRACT NINE CONTAINING APPROXIMATELY 3 ACRES OF LAND OUT OF THE MARIGUITA CASTRO SURVEY NO. 50, ABSTRACT NO. 160 IN TRAVIS COUNTY, TEXAS AND THE TRACT HEREINAFTER DESCRIBED AS TRACT TEN CONTAINING APPROXIMATELY 1.8 ACRES OF LAND OUT OF THE MARIGUITA CASTRO SURVEY NO. 50, ABSTRACT NO. 160 IN TRAVIS COUNTY, TEXAS; OF WHICH APPROXIMATELY 263 ACRES OF LAND ARE TO BE MADE PART OF THE CITY OF AUSTIN, SAID APPROXIMATELY 263 ACRES BEING MORE PARTICULARLY DESCRIBED AS FOLLOWS:

TRACT ONE

BEING approximately 30.330 acres being a portion of Cantarra Revised Preliminary Plan (Case No. C8J-05-0236.03) and being the remaining portion of that called 43.025 acre tract of land conveyed to Cantarra Ventures, Ltd. By Special Warranty Deed recorded in Document No. 2008063044 of the Official Public Records of Travis County, Texas.

TRACT TWO

BEING approximately 27.530 acres being a portion of Cantarra Revised Preliminary Plan (Case No. C8J-05-0236.03) and being the remaining portion of that called 36.482 acre tract of land conveyed to Continental Homes of Texas, L.P. by Special Warranty Deed recorded in Document No. 2015028069 of the Official Public Records of Travis County, Texas.

TRACT THREE

BEING approximately 119.389 acres being a portion of Cantarra Revised Preliminary Plan (Case No. C8J-05-0236.03) and being all of that called 119.389 acre tract of land conveyed to Continental Homes of Texas, L.P. by Special Warranty Deed recorded in Document No. 2015028058 of the Official Public Records of Travis County, Texas.

TRACT FOUR

BEING all of approximately 48.812 acres of land as shown on a Preliminary Plan for Cantarra II (Case No. C8J-2014-0138) and being the remaining portion of a called 49.81 acre tract of land conveyed to Ada M. Ellison by Special Warranty Deed recorded in Volume

11688, Page 462 of the Real Property Records of Travis County, Texas.

TRACT FIVE

BEING approximately 10.00 acres of land known as Howard Subdivision, a subdivision of record in Document No. 201400065 of the Official Public Records of Travis County, Texas. Said Howard Subdivision to be vacated and replatted as Howard Subdivision Replat (Case No. C8J-2015-0117.0A).

TRACT SIX

BEING approximately 6.160 acres of land known as Cantarra Section IIB-1, a subdivision of record in Document No. 201400293 of the Official Public Records of Travis County, Texas.

TRACT SEVEN

BEING approximately 6.535 acres of land known as Cantarra Section IIB-2, a subdivision of record in Document No. 201400294 of the Official Public Records of Travis County, Texas.

TRACT EIGHT

BEING approximately 8.952 acres of land known as Cantarra Section IIIA, a subdivision of record in Document No. 201500162 of the Official Public Records of Travis County, Texas.

TRACT NINE

BEING approximately 3 acres being that portion of East Howard Lane bounded on the west by the southerly prolongation of the westerly line of said 30.330 acre tract to a point on the southerly right-of-way line of East Howard Lane and bounded on the east by the southerly prolongation of the westerly right-of-way line of Cantarra Drive as shown and dedicated by plat for Cantarra Section One, a subdivision of record in Document No. 200800024 of the Official Public Records of Travis County, Texas, same being the present corporate limit line of the City of Austin as adopted by Ordinance No. 20071206-016 (Case No. C7a-07-024), to a point on the southerly right-of-way line of East Howard Lane.

TRACT TEN

BEING approximately 1.8 acres being that portion of East Howard Lane bounded on the west by the southerly prolongation of the westerly line of said Ada M. Ellison 49.81 acre tract, same being the present corporate limit line of the City of Austin as adopted by Ordinance No. 20071206-016 (Case No. C7a-07-024), to a point on the southerly right-of-way line of East Howard Lane and bounded on the east by the southerly prolongation of the easterly line of said Ada M. Ellison 49.81 acre tract to a point on the southerly right-of-way line of East Howard Lane.

"This document was prepared under 22 TAC 663.21, does not reflect the results of an on the ground survey, and is not to be used to convey or establish interests in real property except those rights and interests implied or established by the creation or reconfiguration of the boundary of the political subdivision for which it was prepared".

LEGAL DESCRIPTION: Mary P. Hawkins
09-17-2015

Mary P. Hawkins 10-20-15



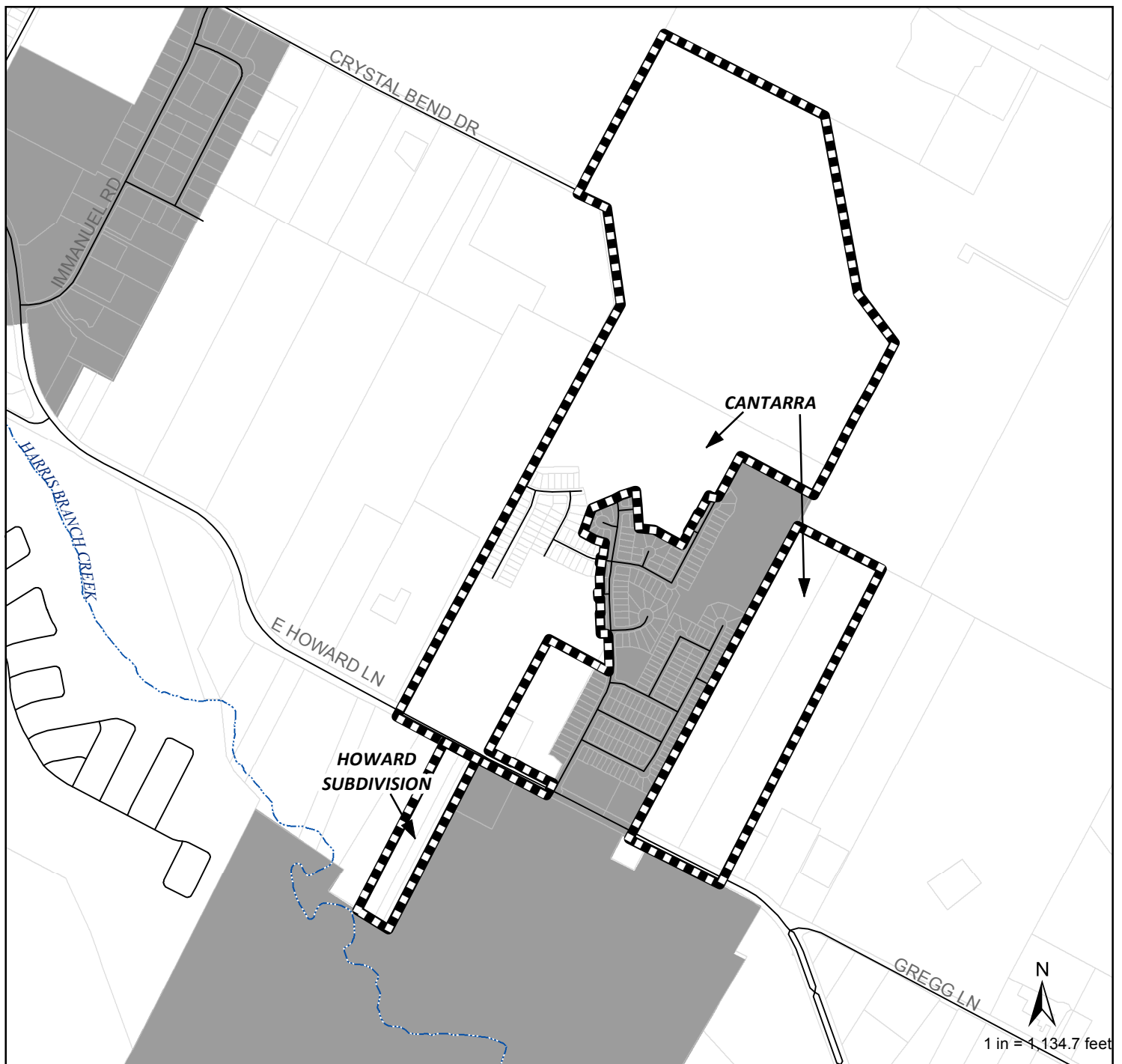

APPROVED: Mary P. Hawkins, RPLS No. 4433
Quality Management Division
Department of Public Works
City of Austin

REFERENCES

Austin Grid Q-32, Q-33 & Q-34
TCAD MAPS 2-5131, 2-5141 & 2-5941





Cantarra/Howard Subdivision Annexation Area

-  Cantarra/Howard Subdivision Annexation Area
-  Parcels
-  Streets
-  Major Creeks

This product has been produced by the Planning and Zoning Department for the sole purpose of geographic reference. No warranty is made by the City of Austin regarding specific accuracy or completeness. All data by City of Austin except where otherwise indicated.

Austin Jurisdiction

-  Austin Full Purpose
-  Austin Limited Purpose
-  Austin ETJ

This product is for informational purposes and may not have been prepared for or be suitable for legal, engineering, or surveying purposes. It does not represent an on-the-ground survey and represents only the approximate relative location of property boundaries.

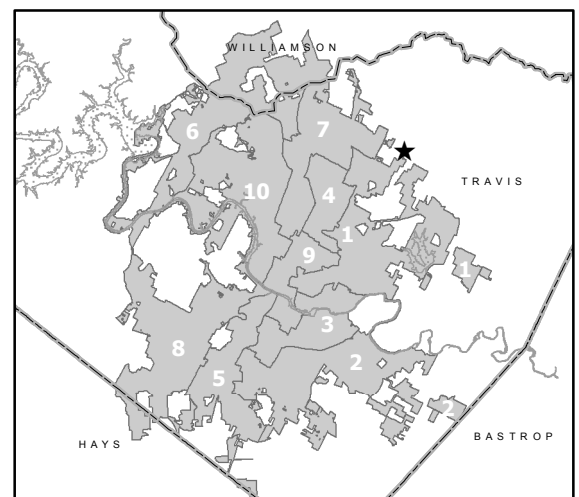

**Cantarra/Howard Subdivision Area in
Relation to 2015 Austin City Council Districts**



City of Austin
Planning and Zoning Department
August 21, 2015

EXHIBIT B



CITY OF AUSTIN ANNEXATION SERVICE PLAN

Case Name: Cantarra/Howard Subdivision
Case Number: C7a-2015-0008
Date: September 9, 2015

INTRODUCTION

This Service Plan ("Plan") is made by the City of Austin, Texas ("City") pursuant to Chapter 43 of the Texas Local Government Code. This Plan relates to the annexation to the City of land ("annexation area") known as the Cantarra/Howard Subdivision annexation area. The annexation area includes approximately 263 acres in Travis County north of Howard Lane approximately 700 feet east of the intersection of Howard Lane and Cantarra Drive and also north and south of Howard Lane immediately west of the intersection of Howard Lane and Cantarra Drive. This area is currently in the city's extraterritorial jurisdiction and is adjacent to the city's full purpose jurisdiction along Howard Lane and adjacent to the developed sections of the Cantarra subdivision. Future land uses include 272 small lot single family homes in the remaining sections of the Cantarra subdivision and the commercial/mixed uses in the proposed Howard Subdivision (C8J-2015-0117.0A) south of Howard Lane as indicated on the subdivision case currently in review.

The annexation area is described by metes and bounds in Exhibit A, which is attached to the annexation ordinance of which this Plan is a part. The annexation area is also shown on the map in Exhibit A.

EFFECTIVE TERM

This Plan shall be in effect for a ten-year period commencing on the effective date of the annexation, unless otherwise stated in this Plan. Renewal of the Plan shall be at the option of the City. Such option may be exercised by the adoption of an ordinance by the City Council, which refers to this Plan and specifically renews this Plan for a stated period of time.

INTENT

It is the intent of the City of Austin that services under this Plan shall provide full municipal services as required and defined by the Texas Local Government Code.

The City reserves the right guaranteed to it by the Texas Local Government Code, to amend this Plan if the City Council determines that changed conditions or subsequent occurrence or any other legally sufficient circumstances exist under the Local Government Code, or other Texas laws to make this Plan unworkable or obsolete or unlawful.

SERVICE COMPONENTS

In general this Plan includes three service components: (1) the Early Action Program, (2) Additional Services, and (3) a Capital Improvement Program.

As used in this Plan, providing services includes having services provided by any method or means by which the City extends municipal services to any other area of the City. This may include causing or allowing private utilities, governmental entities and other public service organizations to provide such services by contract, in whole or in part, as allowed by law. It may also include separate agreements with associations or similar entities.

1. EARLY ACTION PROGRAM

The following services will be provided in the annexation area commencing on the effective date of the annexation, unless otherwise noted.

- a. Police Protection. The Austin Police Department ("APD") will provide protection and law enforcement services in the annexation area. These services include:
 - normal patrols and responses;
 - handling of complaints and incident reports; and
 - special units, such as, traffic enforcement, criminal investigations, narcotics, gang suppression, and special weapons and tactics team.
- b. Fire Protection. The Austin Fire Department ("AFD") will provide emergency and fire prevention services in the annexation area. These services include:
 - fire suppression and rescue;
 - emergency medical services first response for Austin/Travis County Emergency Medical Services Department on life threatening medical emergencies;
 - hazardous materials mitigation and regulation;
 - emergency prevention and public education efforts;
 - dive rescue;
 - technical rescue;
 - aircraft/rescue/firefighting;
 - construction plan review;
 - inspections; and

- rescue/hazardous materials unit.

AFD serves as the first responder on life threatening emergencies for Austin/Travis County EMS. All AFD personnel are certified at an Emergency Medical Technician (“EMT”) level or higher. All engines (pumpers), ladder trucks, and rescue units carry Automatic External Defibrillators for use with heart attack victims.

- c. Emergency Medical Service. The City of Austin/Travis County Emergency Medical Services (“EMS”) Department will provide emergency medical services in the annexation area.

Austin/Travis County EMS will provide the following emergency and safety services to the annexation area:

- medical 911 communications including dispatch, pre-arrival first aid instructions and coordination of other public safety support agencies;
- emergency Advanced Life Support (ALS) ambulance response, treatment and transport;
- medical rescue services; and
- medical support during large scale emergency events.

Austin/Travis County EMS is a mobile service provider, with units constantly moving throughout the system area. An ambulance is frequently dispatched from a location outside the station.

The Austin Fire Department will provide emergency medical first response to all patients in a life-threatening situation. All Austin Fire Department personnel are certified at the Emergency Medical Technician (EMT) level or higher and assist EMS personnel providing patient care.

- d. Solid Waste Collection. The Austin Resource Recovery Department will provide services in the annexation area. Services will be provided by City personnel or by solid waste service providers under contract with the City. Services currently provided in the City for single family residences, including duplex, triplex and fourplex dwelling units, include:

- trash collection – scheduled curbside cart collection based on a bundled services rate structure;
- recycling collection – scheduled curbside cart collection of recyclables in accordance with the City’s recycling program;
- yard trimmings collection – scheduled residential collection of yard trimmings and small brush clippings in kraft paper yard bags or reusable containers; and
- bulk and brush collection – scheduled curbside collection of large brush and large bulk items.

Commercial trash collection service for businesses must be provided by a licensed private service provider.

At this time there are no residential customers in the annexation area.

- e. Maintenance of Water and Wastewater Facilities. Water and wastewater service will be provided to areas that are not within the certificated service area of another utility through existing facilities located within, near, or adjacent to the area. The facilities will be maintained and operated by the City's Austin Water Utility as governed by standard policies and procedures, and under the provisions of the enclosed City service extension policy.
- f. Maintenance of Roads and Streets, Including Street Lighting. The Public Works Department will maintain public streets over which the City has jurisdiction. These services include:
- emergency pavement repair;
 - ice and snow monitoring of major thoroughfares;
 - street maintenance activities including crack seal, sealcoat, slurry seal, and preventative maintenance overlay; and
 - repair maintenance operations of public streets on an as-needed basis including pothole repair, filling depressions (level up), spot surface replacement, spot full-depth repair, and utility cut repairs.

As streets in the area are dedicated and accepted for maintenance they will be included in the City's preventative maintenance program. Preventative maintenance projects are prioritized on a City-wide basis and scheduled based on a variety of factors, including surface condition (distresses), rideability (smoothness), age, traffic volume, functional classification, and available funding.

If necessary, the Transportation Department will also provide regulatory signage services in the annexation area. Traffic signal, stop, and all other regulatory studies are conducted in conjunction with growth of traffic volumes. All regulatory signs and signals are installed when warranted following an engineering study. Faded, vandalized, or missing signs are replaced as needed. "CALL BACK" service provided 24 hours a day, 365 days a year for emergency repair of critical regulatory signs.

Street lighting will be maintained in accordance with the City of Austin ordinances, Austin Energy criteria and state law.

- g. Maintenance of Parks, Playgrounds, and Swimming Pools. At this time there are no public recreation facilities in the annexation area.

Recreational facilities and area amenities, including parks, pools, and medians, that are privately owned, maintained, or operated will be unaffected by the annexation.

- h. Maintenance of Any Other Publicly-Owned Facility, Building, or Service. Should the City acquire any other facilities, buildings, or services necessary for municipal services located within the annexation area, an appropriate City department will provide maintenance services for them.

2. ADDITIONAL SERVICES

Certain services, in addition to the above services, will be provided within the annexation area. They are as follows:

- a. Watershed Protection. The Watershed Protection Department will provide drainage maintenance services in the annexation area. Drainage planning and maintenance are fee-based services. Services currently provided by the department, in accordance with and as limited by applicable codes, laws, ordinances and special agreements, include:
 - water quality protection;
 - watershed protection master planning for flood hazard mitigation, streambank restoration and erosion control, and water quality protection;
 - flood hazard mitigation;
 - streambank restoration and erosion management; and
 - infrastructure and waterway maintenance.
- b. Planning and Development Review. The Planning and Zoning Department and the Development Services Department will provide comprehensive planning, land development and building review and inspection services in accordance with and as limited by applicable codes, laws, ordinances and special agreements.
- c. Code Compliance. In order to attain compliance with City codes regarding land use regulations and the maintenance of structures, the Austin Code Department will provide education, cooperation, enforcement and abatement relating to code violations.
- d. Library. Upon annexation residents may utilize all Austin Public Library facilities.
- e. Public Health, Social, and Environmental Health Services. Upon annexation, the following services will be available from the Austin/Travis County Health and Human Services Department:
 - investigation of public health related complaints including foodborne illness, recreational water quality and public swimming pools and spas;
 - enforcement of the City's smoking in public places ordinance and the minor's access to tobacco ordinance;
 - inspection of food establishments, child care facilities;
 - investigation of reported elevated blood lead levels in children;
 - animal services including leash law and rabies control; and
 - rodent and vector control consultation.
- f. Austin Energy. Austin Energy will continue to provide electric utility service to all areas which the City is authorized to serve by the Public Utility Commission of Texas.

- g. Clean Community Services. The Austin Resource Recovery Department will provide clean community services in the annexed area. Services currently provided in the City include:
- street and boulevard sweeping;
 - litter collection and abatement;
 - household hazardous waste drop-off;
 - Austin reuse and recycling centers;
 - dead animal collection; and
 - zero waste program development.
- h. Other Services. All other City Departments with jurisdiction in the area will provide services according to City policy and procedure.

3. CAPITAL IMPROVEMENTS PROGRAM

The City will initiate the construction of capital improvements necessary for providing municipal services for the annexation area as necessary.

Each component of the Capital Improvement Program is subject to the City providing the related service directly. In the event that the related service is provided through a contract service provider, the capital improvement may not be constructed or acquired by the City but may be provided by the contract provider. The City may also lease buildings in lieu of construction of any necessary buildings.

- a. Police Protection. No capital improvements are necessary at this time to provide police services.
- b. Fire Protection. No capital improvements are necessary at this time to provide fire services.
- c. Emergency Medical Service. No capital improvements are necessary at this time to provide EMS services.
- d. Solid Waste Collection. No capital improvements are necessary at this time to provide solid waste collection services.
- e. Water and Wastewater Facilities. No capital improvements are necessary at this time to provide water and wastewater services.

Water and wastewater services to new development and subdivisions will be provided according to the standard policies and procedures of the Austin Water Utility, which may require the developer of a new subdivision or site plan to install new water and wastewater infrastructure or replace existing water and wastewater infrastructure. The extension of water and sewer service will be provided in accordance with the enclosed water and wastewater service extension policy.

- f. Roads and Streets. No road or street related capital improvements are necessary at this time. In general, the City will acquire control of all public roads and jurisdiction in, over and under all public roads and public streets within the annexation area upon annexation. Future extensions of roads or streets and future installation of related facilities, such as traffic control devices, will be governed by the City's standard policies and procedures.
- g. Parks, Playgrounds and Swimming Pools. No capital improvements are necessary at this time to provide services.
- h. Watershed Protection. No capital improvements are necessary at this time to provide services.
- i. Street Lighting. No capital improvements are necessary at this time to provide services. Street lighting in new and existing subdivisions will be installed and maintained in accordance with the applicable standard policies and procedures.
- j. Other Publicly Owned Facilities, Building or Services: Additional Services. In general, other City functions and services, and the additional services described above can be provided for the annexation area by using existing capital improvements. Additional capital improvements are not necessary to provide City services.
- k. Capital Improvements Planning. The annexation area will be included with other territory in connection with planning for new or expanded facilities, functions, and services.

AMENDMENT: GOVERNING LAW

This Plan may not be amended or repealed except as provided by the Texas Local Government Code or other controlling law. Neither changes in the methods or means of implementing any part of the service programs nor changes in the responsibilities of the various departments of the City shall constitute amendments to this Plan, and the City reserves the right to make such changes. This Plan is subject to and shall be interpreted in accordance with the Constitution and laws of the United States of America and the State of Texas, the Texas Local Government Code, and the orders, rules and regulations of governmental bodies and officers having jurisdiction.

FORCE MAJEURE

In case of an emergency, such as Force Majeure as that term is defined in this Plan, in which the City is forced to temporarily divert its personnel and resources away from the annexation area for humanitarian purposes or protection of the general public, the City obligates itself to take all reasonable measures to restore services to the annexation area of the level described in this Plan as soon as possible. Force Majeure shall include, but not be limited to, acts of God, acts of the public enemy, war, blockages, insurrection, riots, epidemics, landslides, lightning, earthquakes, fires, storms, floods, washouts, droughts, tornadoes, hurricanes, arrest and restraint of government, explosions, collisions and other inability of the City, whether similar to those

enumerated or otherwise, which is not within the control of the City. Unavailability or shortage of funds shall not constitute Force Majeure for purposes of this Plan.

SUMMARY OF THE WATER AND WASTEWATER UTILITY SERVICE EXTENSION POLICY

The following information is a summary of the Austin Water Service Extension Policy, as set out in Chapters 25-1 through 25-5 and 25-9 of the Austin City Code, in conformance with the Texas Local Government Code requirement that the Plan have a summary of the service extension policy.

Water and wastewater service is only provided to lots that have been properly subdivided and platted or are a legal lot. For property that is required by subdivision regulations to construct water or wastewater facilities connecting to the City system, funding and construction of those facilities will remain the responsibility of the developer. If the specific undeveloped property does not have City water or wastewater service fronting the property, the owner may make an application for an extension of service to the Director of Austin Water for review. If the Director determines that adequate capacity is available, or will be, and if the project does not include City cost participation, and if the proposed facilities are a logical extension of the City's water and wastewater system and the requested extension otherwise meets the requirements of Chapter 25-9, the extension size, capacity, and routing may be approved by the Director for funding and construction by the developer.

If the City requires oversizing of the proposed facilities, with City Council approval, the City may reimburse the developer for the City's proportionate share of the cost of constructing certain facilities. The actual calculation of the cost participation amounts, including limits and the schedules for the payments, are included in the Land Development Code.

For lots served by an existing well or septic system that have water or wastewater lines within 100 feet of the lot at the time of annexation, the owner will not be required to pay the impact fees if a tap permit is obtained by the property owner on or before the second anniversary of the date of annexation. For lots served by an existing well or septic system that do not have water or wastewater lines within 100 feet of the lot, the owner will not be required to pay the impact fees if a tap permit is obtained by the property owner on or before the second anniversary of the date of acceptance of the water or sewer line to within 100 feet of their lot. In either case the owner will still be required to pay other applicable connection fees.

As long as a property is using a septic system, the property owner remains responsible for the operation and maintenance of the septic system. If the septic system fails before the City sewer service is extended to the property, the property owner must repair the system. Under certain circumstances the Austin/Travis County Health and Human Services Department may require connection to the City sewer facilities.

This policy is set by the City Council and can be amended in the future by ordinance.