



Building B - Northwest Elevation Perspective



FIELD INSPECTION REQUIRED

Prior to performing any bidding, new construction, and/or repairs, general contractor shall visit the site, inspect all existing conditions, and report any discrepancies to the architect.

GREEN PASTURES

811 W. LIVE OAK ST., AUSTIN, TX 78704

PHASE 2

DATE	ISSUED FOR
12.23.15	HLC SUBMITTAL

COPYRIGHT © 2015
Clayton & Little Architects

PROJECT NUMBER: 1531

PERSPECTIVE

A7.1



FIELD INSPECTION REQUIRED

Prior to performing any bidding, new construction, and/or repairs, general contractor shall visit the site, inspect all existing conditions, and report any discrepancies to the architect.



View of Building A site from historic building

GREEN PASTURES

811 W. LIVE OAK ST., AUSTIN, TX 78704

PHASE 2

DATE	ISSUED FOR
12.23.15	HLC SUBMITTAL

COPYRIGHT © 2016
Clayton & Little Architects
PROJECT NUMBER: 1531

EXISTING CONDITIONS



View of proposed Building A from historic building



FIELD INSPECTION REQUIRED

Prior to performing any bidding, new construction, and/or repairs, general contractor shall visit the site, inspect all existing conditions, and report any discrepancies to the architect.

GREEN PASTURES

811 W. LIVE OAK ST., AUSTIN, TX 78704

PHASE 2

DATE	ISSUED FOR
12.23.15	HLC SUBMITTAL

COPYRIGHT © 2016
Clayton & Little Architects
PROJECT NUMBER: 1531

PROPOSED



View of Building B site from drive

Architects
Clayton&Little

1001 East 8th Street
Austin, Texas 78702
512 477 1727
www.claytonandlittle.com

FIELD INSPECTION REQUIRED
Prior to performing any bidding, new construction, and/or repairs, general contractor shall visit the site, inspect all existing conditions, and report any discrepancies to the architect.

GREEN PASTURES

811 W. LIVE OAK ST., AUSTIN, TX 78704

PHASE 2	
DATE	ISSUED FOR
12.23.15	HLC SUBMITTAL
COPYRIGHT © 2016 Clayton & Little Architects	
PROJECT NUMBER: 1531	

EXISTING CONDITIONS



View of proposed Building B from drive

FIELD INSPECTION REQUIRED

Prior to performing any bidding, new construction, and/or repairs, general contractor shall visit the site, inspect all existing conditions, and report any discrepancies to the architect.

GREEN PASTURES

811 W. LIVE OAK ST., AUSTIN, TX 78704

PHASE 2	
DATE	ISSUED FOR
12.23.15	HLC SUBMITTAL
COPYRIGHT © 2016 Clayton & Little Architects	
PROJECT NUMBER: 1531	

PROPOSED



View of Building B site from historic building



FIELD INSPECTION REQUIRED

Prior to performing any bidding, new construction, and/or repairs, general contractor shall visit the site, inspect all existing conditions, and report any discrepancies to the architect.

GREEN PASTURES

811 W. LIVE OAK ST., AUSTIN, TX 78704

PHASE 2

DATE	ISSUED FOR
12.23.15	HLC SUBMITTAL

COPYRIGHT © 2016
Clayton & Little Architects

PROJECT NUMBER: 1531

EXISTING CONDITIONS

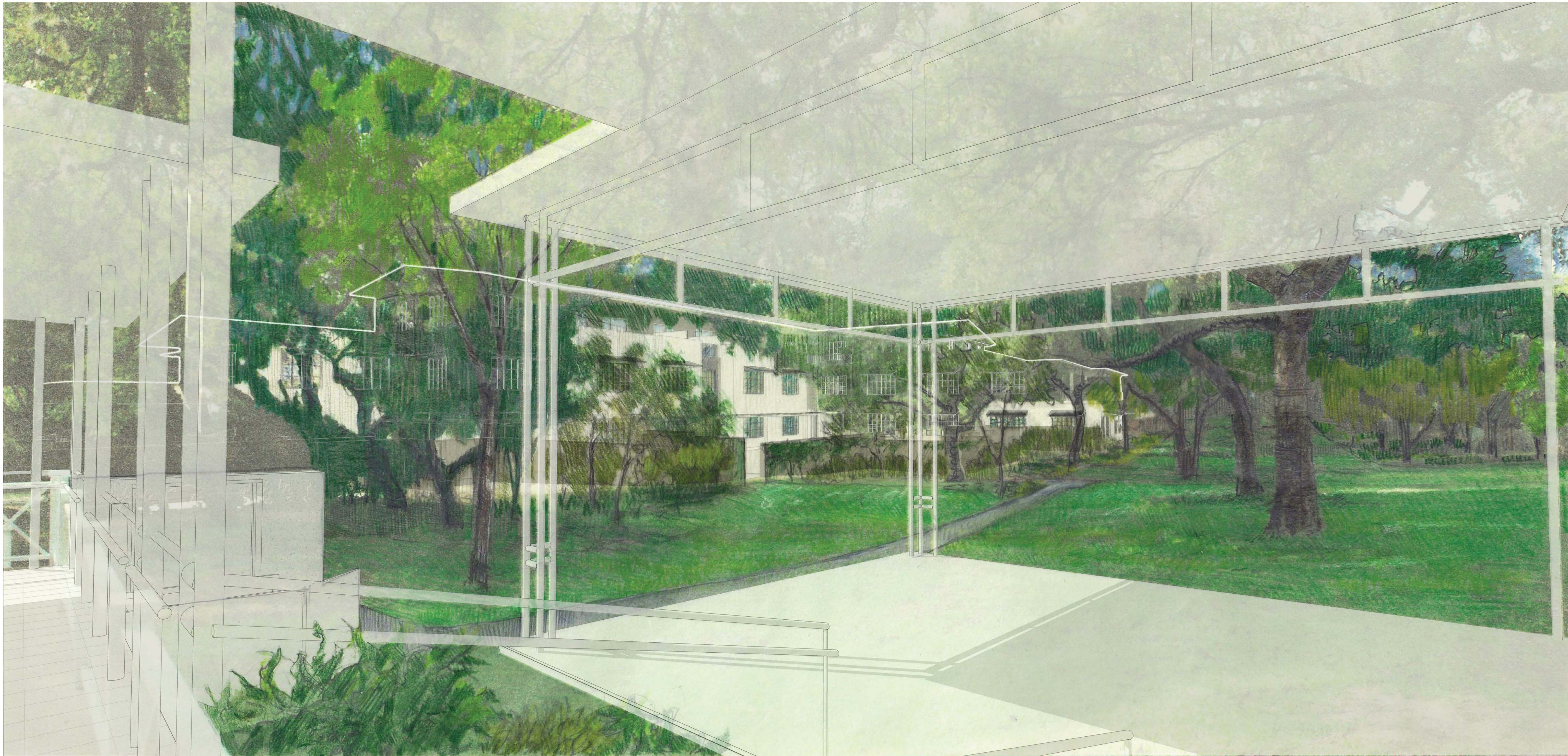

View of proposed Building B from pavilion



FIELD INSPECTION REQUIRED

Prior to performing any bidding, new construction, and/or repairs, general contractor shall visit the site, inspect all existing conditions, and report any discrepancies to the architect.

GREEN PASTURES

811 W. LIVE OAK ST., AUSTIN, TX 78704

PHASE 2

DATE	ISSUED FOR
12.23.15	HLC SUBMITTAL

COPYRIGHT © 2016
Clayton & Little Architects
PROJECT NUMBER: 1531

PROPOSED

A7.7



FIELD INSPECTION REQUIRED

Prior to performing any bidding, new construction, and/or repairs, general contractor shall visit the site, inspect all existing conditions, and report any discrepancies to the architect.

GREEN PASTURES

811 W. LIVE OAK ST., AUSTIN, TX 78704

PHASE 2

DATE	ISSUED FOR
12.23.15	HLC SUBMITTAL

COPYRIGHT © 2016
Clayton & Little Architects

PROJECT NUMBER: 1531

EXISTING CONDITIONS

A7.8



View towards Building D site from historic building



FIELD INSPECTION REQUIRED

Prior to performing any bidding, new construction, and/or repairs, general contractor shall visit the site, inspect all existing conditions, and report any discrepancies to the architect.

GREEN PASTURES

811 W. LIVE OAK ST., AUSTIN, TX 78704

PHASE 2

DATE	ISSUED FOR
12.23.15	HLC SUBMITTAL

COPYRIGHT © 2016
Clayton & Little Architects
PROJECT NUMBER: 1531

PROPOSED

A7.9

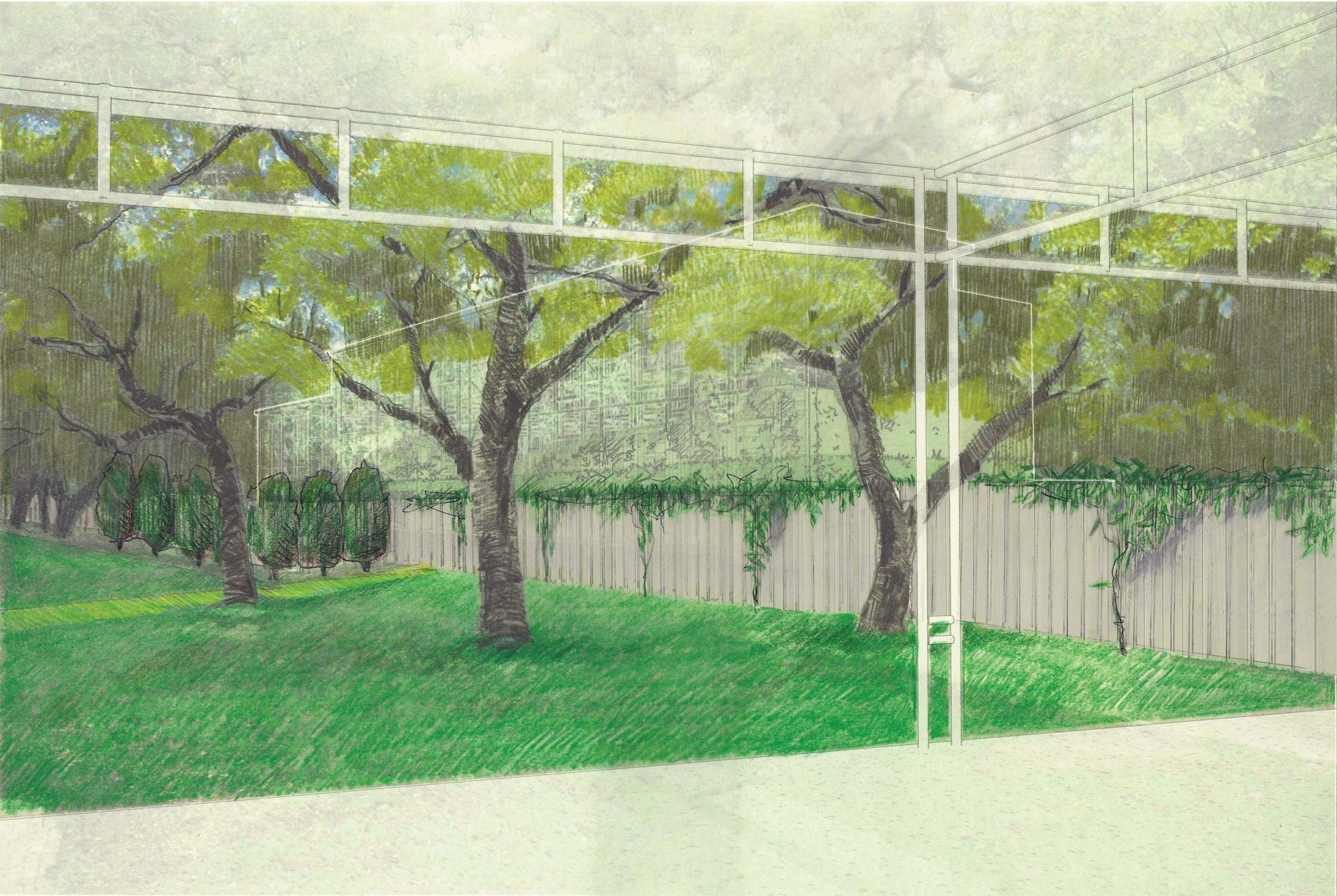

View towards proposed Building D from pavilion