

**ORDINANCE NO.** \_\_\_\_\_

**AN ORDINANCE ESTABLISHING INITIAL PERMANENT ZONING FOR THE PROPERTY LOCATED AT 12331 AND 12335 HYMEADOW DRIVE AND CHANGING THE ZONING MAP FROM INTERIM-SINGLE-FAMILY RESIDENCE STANDARD LOT (I-SF-2) DISTRICT TO LIMITED OFFICE (LO) DISTRICT.**

**BE IT ORDAINED BY THE CITY COUNCIL OF THE CITY OF AUSTIN:**

**PART 1.** The zoning map established by Section 25-2-191 of the City Code is amended to change the base district from interim-single-family residence standard lot (I-SF-2) district to limited office (LO) district on the property described in Zoning Case No. C14-2015-00158, on file at the Planning and Zoning Department, as follows:

Lots 4 and 5, J.M.K. Subdivision, a subdivision in Williamson County, Texas, according to the map or plat of record in Plat Book Cabinet E, Slide 303, Volume 1294 of the Plat Records of Williamson County, Texas, (the "Property"),

locally known as 12331 and 12335 Hymeadow Drive in the City of Austin, Williamson County, Texas, and generally identified in the map attached as Exhibit "A".

**PART 2.** This ordinance takes effect on \_\_\_\_\_, 2016.

**PASSED AND APPROVED**

ssss

**Steve Adler**  
Mayor

**APPROVED:** \_\_\_\_\_ **ATTEST:** \_\_\_\_\_  
Anne L. Morgan Jannette S. Goodall  
City Attorney City Clerk

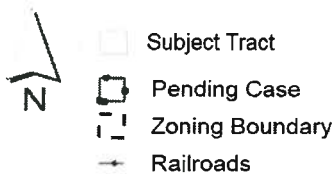
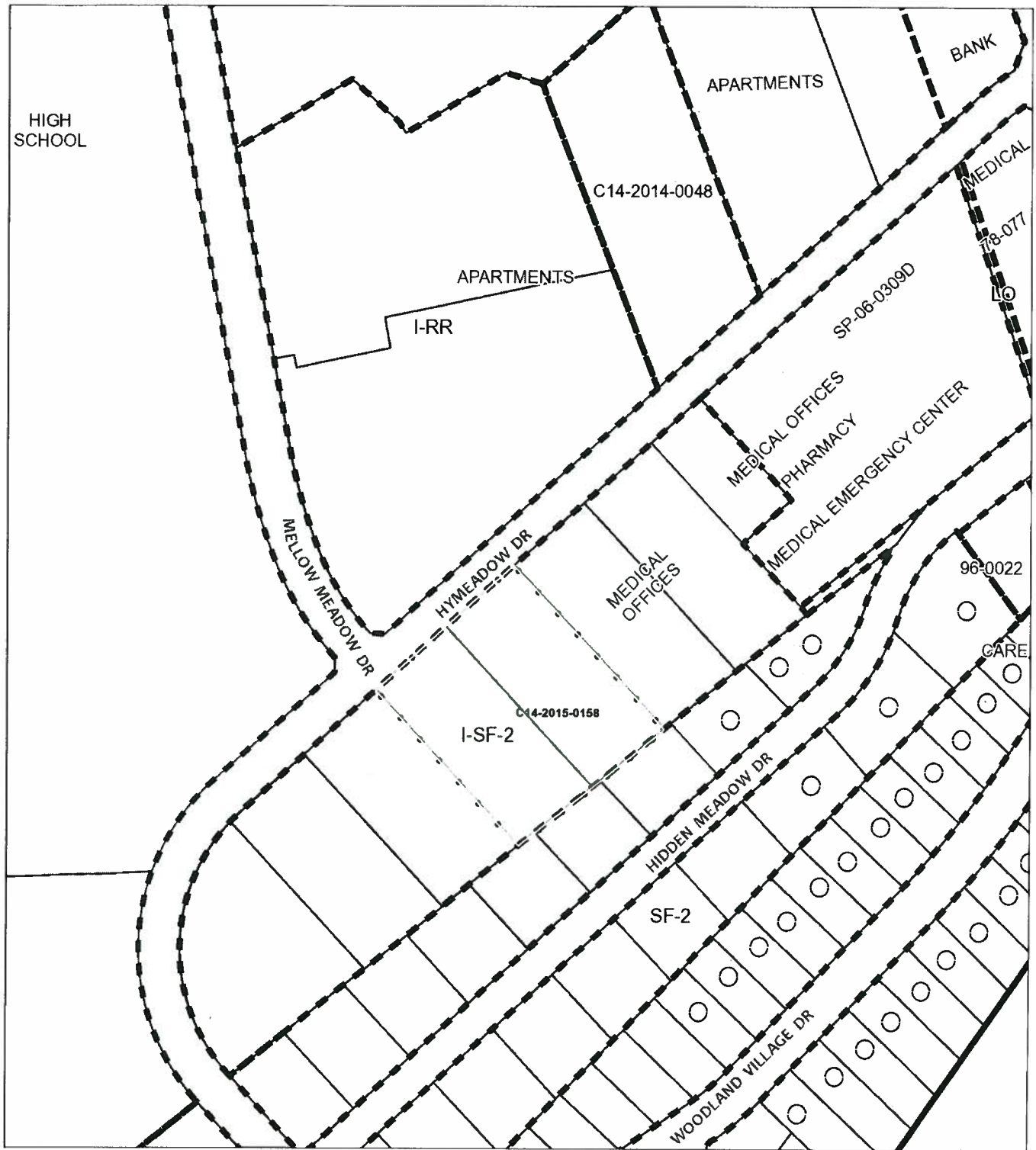

100 200 Feet

1" = 200'

## ZONING

ZONING CASE#: C14-2015-0158



This product is for informational purposes and may not have been prepared for or be suitable for legal, engineering, or surveying purposes. It does not represent an on-the-ground survey and represents only the approximate relative location of property boundaries.

This product has been produced by CTM for the sole purpose of geographic reference. No warranty is made by the City of Austin regarding specific accuracy or completeness.