

SUBDIVISION REVIEW SHEET**CASE NO.:** C8-2015-0133.2A**ZAP DATE:** 2/16/16**SUBDIVISION NAME:** Cottages at Beaver Creek, Phase 2**AREA:** 10.4 acres**LOT(S):** 92**OWNER/APPLICANT:** KB Home Lone Star, LP (John Zinsmeyer)**AGENT:** Garrett-Ihnen Civil Engineers (Norma Divine)**ADDRESS OF SUBDIVISION:** 1701 S Heatherwilde Boulevard**GRIDS:** MN36**COUNTY:****WATERSHED:** Harris Branch**JURISDICTION:** Full-Purpose**EXISTING ZONING:****MUD:** N/A**NEIGHBORHOOD PLAN:****PROPOSED LAND USE:** Single Family**ADMINISTRATIVE WAIVERS:** None**VARIANCES:** None**SIDEWALKS:** Sidewalks will be provided on both sides of all internal streets and the subdivision side of boundary streets.**DEPARTMENT COMMENTS:** The request is for the approval of Cottages at Beaver Creek, Phase 2. The proposed plat is composed of 92 lots on 10.4 acres.**STAFF RECOMMENDATION:** The staff recommends disapproval of the plat. This plat does not meet all applicable State and City of Austin LDC requirements.**PLANNING COMMISSION ACTION:**

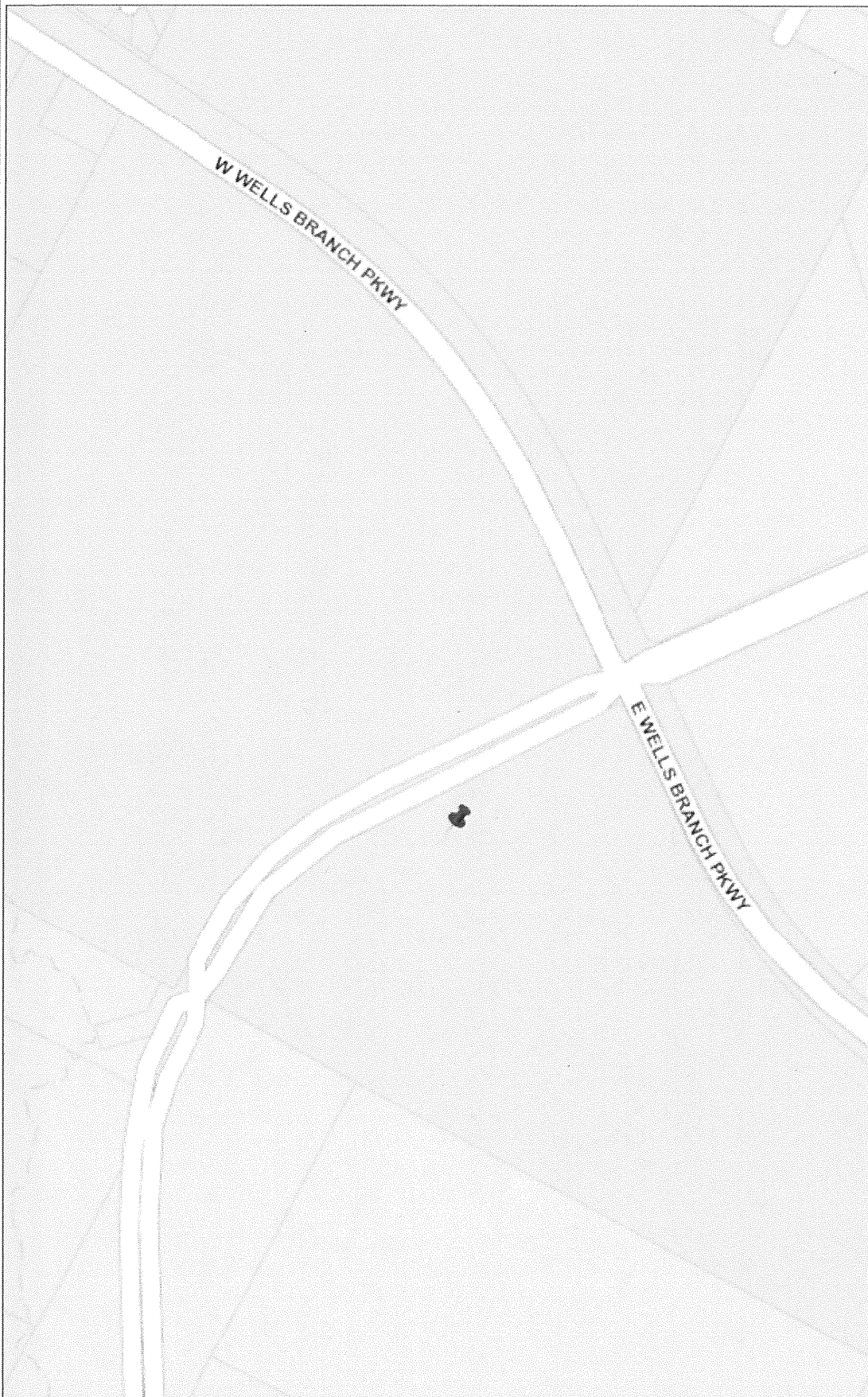

Legend

-  Lot Lines
-  Streets
-  Building Footprints
-  Named Creeks
-  Lakes and Rivers
-  Parks
-  County

ZAP
#11478577

THIS PRODUCT IS FOR INFORMATIONAL PURPOSES AND MAY NOT HAVE BEEN PREPARED FOR OR BE SUITABLE FOR LEGAL, ENGINEERING, OR SURVEYING PURPOSES. IT DOES NOT REPRESENT AN ON-THE-GROUND SURVEY AND REPRESENTS ONLY THE APPROXIMATE RELATIVE LOCATION OF PROPERTY BOUNDARIES. THIS PRODUCT HAS BEEN PRODUCED BY THE CITY OF AUSTIN FOR THE SOLE PURPOSE OF GEOGRAPHIC REFERENCE. NO WARRANTY IS MADE BY THE CITY OF AUSTIN REGARDING SPECIFIC ACCURACY OR COMPLETENESS.