

HISTORIC LANDMARK COMMISSION
PERMITS IN NATIONAL REGISTER HISTORIC DISTRICTS
MAY 23, 2016
NRD-2016-0026
1605 Mohle Drive
Old West Austin

PROPOSAL

Demolish a ca. 1940 house.

RESEARCH

The house was built in 1940 by Clark Petet; he and his wife Erin lived here until the late 1950s. Clark Petet was a native of Memphis, Tennessee; he moved to Austin with his family before 1930. His father, Charles F. Petet was the secretary of the State Railroad Commission. Clark Petet was a salesman for a garage at that point, but soon became involved in work for the Scottish Rite bodies in Austin. He served as the recorder for the Ben Hur Temple Shrine, and while living in this house, was the assistant secretary for the Scottish Rite bodies. He later served as the recorder for the Hella Temple Shrine, and in his later years, he moved to Dallas, where he passed away in 1992. The house was then owned by a widow, Florence McDonald, until around 1970, then a rental property until it was purchased by R. Frank Davis and his wife, around 1980.

ARCHITECTURE

One-story, wing-and-gable plan, stone-veneered cottage with a shed-roofed entry hood; metal-framed casement windows.

STAFF COMMENTS

The house is contributing to the Old West Austin National Register Historic District.

STAFF RECOMMENDATION

Release the permit upon the Commission's review of the plans for the new construction proposed for this site, and upon completion of a City of Austin Documentation Package, consisting of photographs of all elevations, a dimensioned sketch plan, and a narrative history, for archiving at the Austin History Center. While the house is contributing to the National Register Historic District, it lacks the requisite architectural and historical significance to warrant individual designation as a historic landmark.

LOCATION MAP

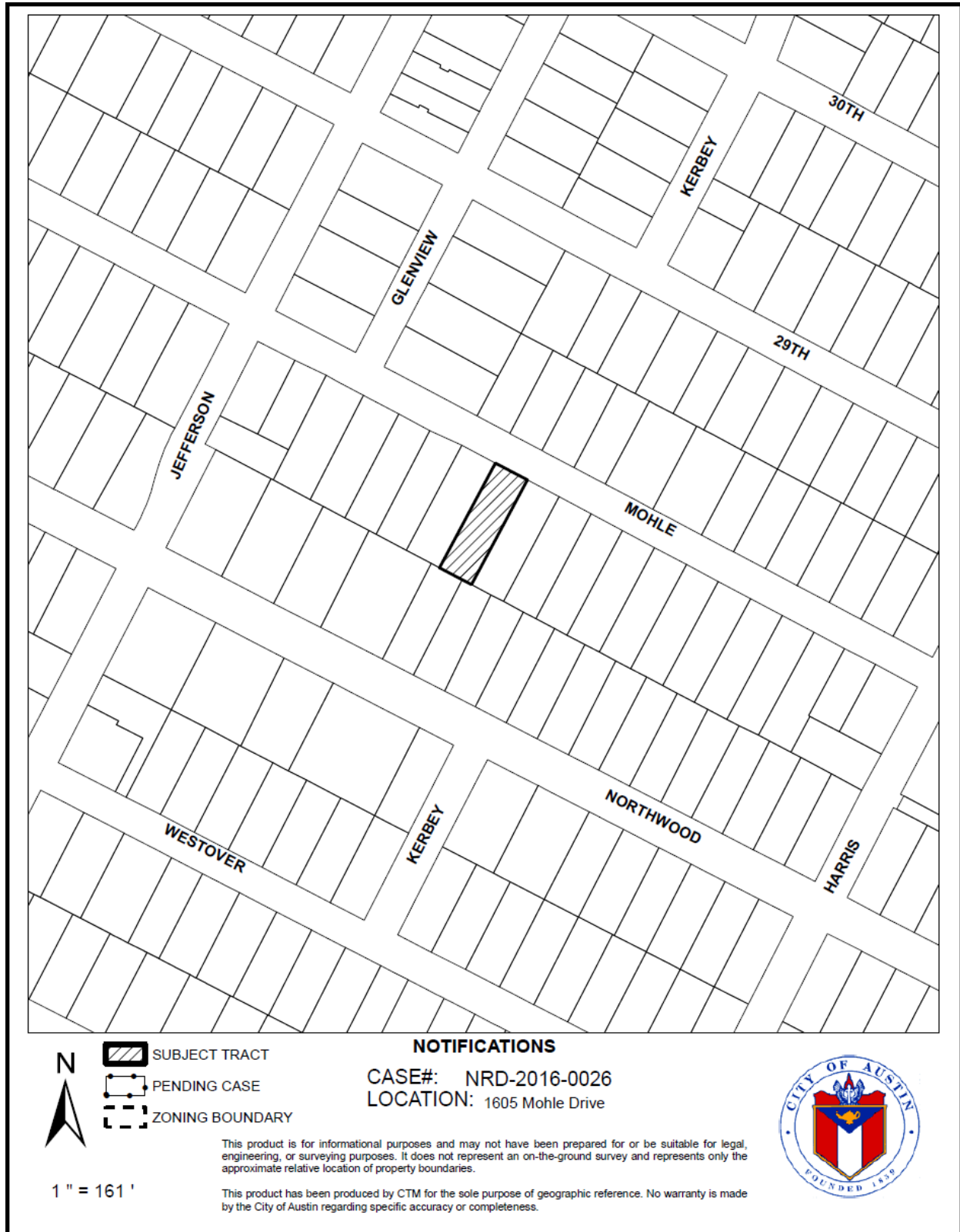

1605 Mohle Drive
ca. 1940



OCCUPANCY HISTORY
1605 Mohle Drive

City Directory Research, Austin History Center
By City Historic Preservation Office
April, 2016

1992	Frank R. Davis, owner Retired
1985-86	Mrs. Frank R. Davis, owner There is no listing for a Frank R. Davis or a Mrs. Frank R. Davis in the alphabetical section of the directory.
1981	R. Frank Davis, owner No occupation listed
1977	No return
1973	Andrew and Judy Fono, renters Systems analyst
1968	Florence McDonald, owner Widow, Earl McDonald Retired
1962	Florence McDonald, owner Widow, Earl McDonald No occupation listed

- 1959 Vacant
NOTE: Florence McDonald, the widow of Earl McDonald, is listed at 2004 Indian Trail; she was a checker for the State Department of Public Safety.
- 1955 Clarke J. and Erin Petet, owners
Secretary, Scottish Rite Bodies, 205 W. 18th Street.
- 1952 J. Clarke and Erin Petet, owners
Assistant secretary, Scottish Rite Bodies, 205 W. 18th Street.
- 1949 J. Clarke and Erin Petet (not listed as owners)
Assistant secretary, Scottish Rite Bodies, 205 W. 18th Street.
- 1947 J. Clarke and Erin Petet, renters
Assistant secretary, Scottish Rite Bodies, 205 W. 18th Street.
- 1944-45 Charles E. and Peggy B. Bickley, renters
U.S. Army

William J. and Shirley Samuels, renters
U.S. Army
NOTE: J. Clarke and Erin Petet are not listed in the directory.
- 1941 J. Clarke and Erin Petet, owners
Assistant secretary, Scottish Rite Bodies, 205 W. 18th Street.
- 1940 The address is not listed in the directory.
NOTE: J. Clarke Petet (no wife listed) was a clerk for the State Railroad Commission (his father, Charles F. Petet was the secretary of the Railroad Commission); he lived at his parents' house at 508 Crockett Street.

BIOGRAPHICAL NOTES

J. Clarke and Erin Petet (ca. 1940 – ca. 1957)

The 1940 U.S. Census shows Clark and Erin Petet as the renters of the house at 2517 Harris Boulevard in Austin. Clark Petet was 33, had been born in Tennessee, and was the assistant bookkeeper for the Masonic lodge. He had lived in Denison, Texas in 1935. Erin Petet was 26, had been born in Texas, and had no occupation listed. They had no children listed with them.

The 1930 U.S. Census shows Joseph Clark Petet as the 23-year old son of Charles F. and Mary A. Petet, who rented their house at 506 W. 18th Street in Austin. Joseph Clark Petet had been born in Tennessee, and was a salesman for a garage. His father, Charles F. Petet, had been born in Missouri, and was the secretary of the State Railroad Commission. His mother, Mary A. Petet, had been born in Canada. Joseph Clark Petet was the oldest of the 3 children listed in the census report. The Petet family also had 7 lodgers in their home, including 2 teachers at the University of Texas, a bank teller, a dry goods clerk, and a yardman.

Joseph Clarke Petet

Joseph Clarke Petet, age 85, passed away April 13, 1992. He was born in Memphis, Tennessee, August 29, 1906.

Mr. Petet is survived by his wife of 52 years, Erin Petet; daughters, Susan P. McKay, Sara Blaydes and husband, Bill, all of Dallas; son, Joe Petet and wife, Bonnie, Austin; five grandchildren; sister, Florence Beall and husband, Bill, Austin; brother, Charles F. Petet and wife, Dorothy, Denver, Colorado; and several nieces and nephews.

He was retired as the Recorder of Hella Temple Shrine, having served in that capacity from 1958 to 1974. He was employed in fraternal work throughout most of his adult life, having previously served as Recorder of Ben Hur Temple Shrine, Austin. He graduated from the University of Texas at Austin in 1931, and was a charter member of Sigma Phi Epsilon Fraternity. He held extensive fraternal memberships and associated offices and honors, including Past Master Austin Lodge #12.

Services at Sparkman/Hillcrest in Dallas, Texas, April 15, 1992, 2:30 PM.

Memorials may be made to Shrine Hospital for Crippled Children, Houston, or Texas Scottish Rite Hospital, Dallas.

Obituary of J. Clarke Petet
Austin American-Statesman, April 15, 1992

Clark J. Petet

1605 Mohle Dr.

61

32

Summit Place

Rock Ventr. Res & Frame Garage

19524 - 5-8-40

5

Building permit to Clark Petet for the construction of the house (1940)

WATER SERVICE PERMIT		No. 17579
Austin, Texas		Sec. 61
Received of	Clark Petet	Date May 8, 1940
Address	1605 Mohle Dr.	
Amount	Two and 50/100 - - - - -	\$ 2.50
Plumber	Harton	Size of Tap $\frac{1}{2}$ "
Date of Connection	5-10-40	
Size of Tap Made	1 1/4"	
Size Service Made	1 1/4"	
Size Main Tapped	6"	
From Front Prop. Line to Curb Cock	72"	
From Prop. Line to Curb Cock	12"	
Location of Meter	C. 1000	
Type of Box	1001A	
Depth of Main in St.	3'	
Depth of Service Line	12"	
From Curb Cock to Tap on Main	1001A	
Checked by Engr. Dept.	6-13-40 LE	

No. Fittings	Size	Description
1	Curb Cock	57C
1	Elbow	St. Elbow
1	Bushing	2 1/4" x 1 1/2"
1	Reducer	2 1/4" x 1 1/2"
2	Pipe	2 1/4" x 100'
1	Lead Comp.	2 1/4" x 100'
1	Nipples	2 1/4" x 100'
1	Union	2 1/4" x 100'
1	Plug	2 1/4" x 100'
1	Te	2 1/4" x 100'
1	Stop	2 1/4" x 100'
1	Box	2 1/4" x 100'
1	Lid	2 1/4" x 100'
1	Valves	2 1/4" x 100'
1	Job No.	46571
1	Req. No.	46571

Water service permit to Clark Petet for this address (1940)

Clark Petet 1605 Mohle Drive

61

32

Summit Place

Frame addition to rear of residence.

52549 11-18-52

\$4000.00

Cline Bros.

Building permit to Clark Petet for a rear frame addition (1952)