

**HISTORIC LANDMARK COMMISSION
MAY 23, 2016
DEMOLITION AND RELOCATION PERMITS
HDP-2016-0260
1007 W. MARY STREET**

PROPOSAL

Demolish a ca. 1931 house.

ARCHITECTURE

One-story, rectangular-plan, front-gabled frame bungalow with a central, partial-width, front-gabled independent porch on ornamental metal posts; single and paired 1:1 fenestration.

RESEARCH

The house appears to have been built around 1931 by N.A. Dawson, whose family developed large areas of South Austin, as a rental property, and the house has been a rent house for its entire existence. The first tenants were William J. and Viola Cloer, who lived here until around 1934. William Cloer was a house carpenter. There was a very high turnover of tenants from that time forward, with no occupants renting the house for more than a year or two. Tenants were generally blue-collar, including an electrician, an auto trimmer, a carpenter, a lineman, a machinist, a clerk at a drug store, a truck driver, a plumber, a book-keeper and his wife, who was a waitress, and in later years, students.

STAFF COMMENTS

The house is beyond the bounds of any City survey.

STAFF RECOMMENDATION

Encourage rehabilitation and adaptive re-use, but release the permit upon completion of a City of Austin Documentation Package, consisting of photographs of all elevations, a dimensioned sketch plan, and a narrative history, for archiving at the Austin History Center. The house has neither the architectural nor the historical significance to warrant individual designation as a historic landmark.

LOCATION MAP

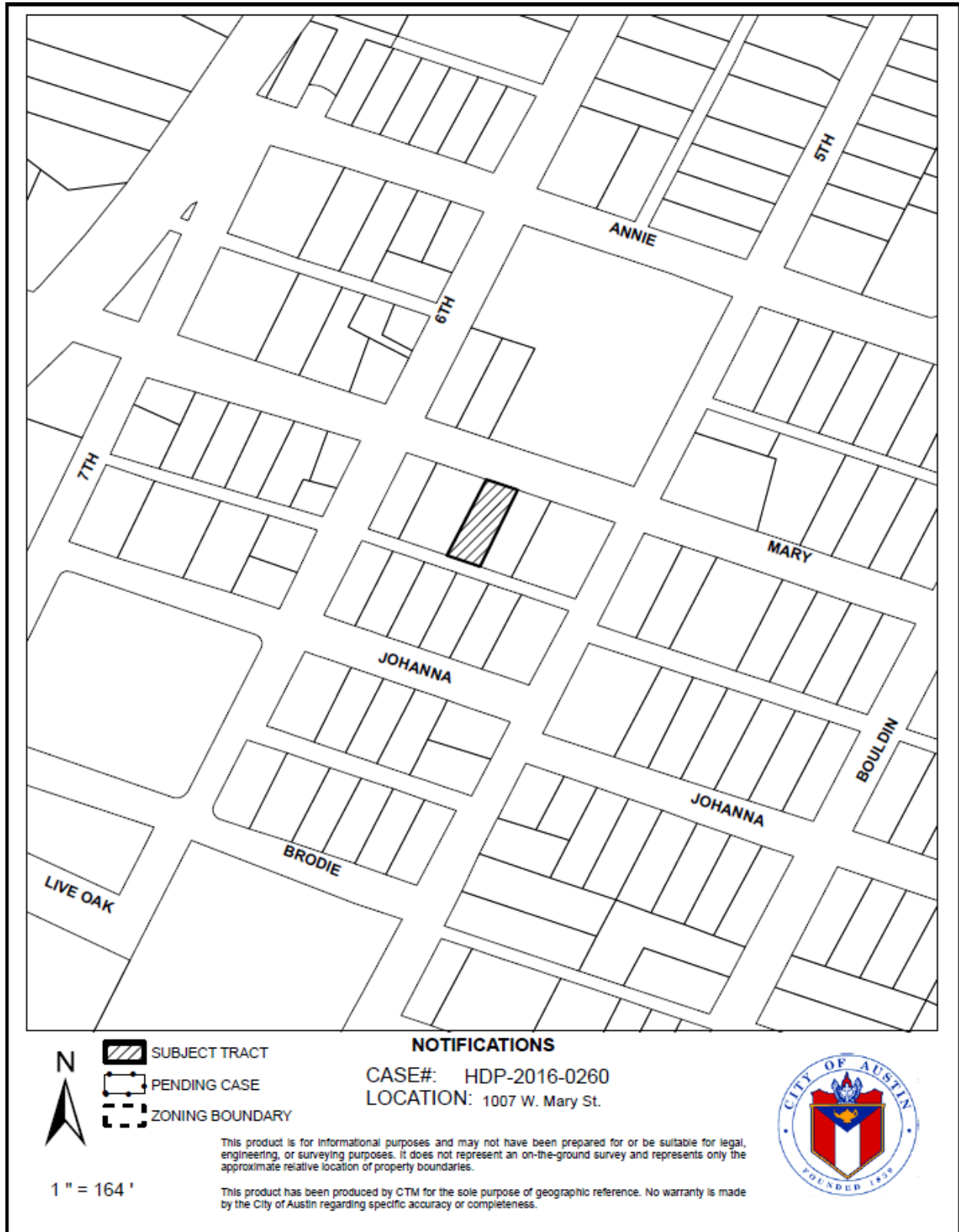

1007 W. Mary Street
ca. 1931



OCCUPANCY HISTORY 1007 W. Mary Street

City Directory Research, Austin History Center
By City Historic Preservation Office
May, 2016

1992	No return
1985-86	John Worrall, renter Consultant, Richardson Verdoorn, land developers, 333 Guadalupe Street. NOTE: The directory indicates that John Worrall was a new resident at this address.
1981	John Scruggs, renter Student
1977	Neil Murray, renter Manger, West Side Seafood, 1201 W. 5 th Street.
1973	Jeff Scott, renter Employed by Warehouse Supply Company (not listed in the alphabetical section of the directory).
1968	Ronnie M. and Barbara Scheffel, renters Ronnie: Book-keeper, Austin Goodyear, 101 Congress Avenue. Barbara: Waitress, Avenue Café, 211 Congress Avenue.

- 1962 Rupert B. and Obelia Lawrence, renters
Plumber, Middleton Plumbing Company, 1612 Manor Road.
- 1959 Howard A. and Elsie V. Kirk, renters
Driver, Brunson Transfer and Storage, 7035 Lamar Boulevard.
- 1955 Vacant
- 1952 Elmer R. and Dorothy Tatsch, renters
Elmer: Salesman
Dorothy: Clerk, Renfro Drugs (multiple locations)
Also listed is Catherine Tatsch, the widow of Reuben J. Tatsch; she had no occupation shown.
- 1949 Edmund and Dorothy Riggs, renters
No occupation listed
- 1947 Sloan E. and Lesa Loyd, renters
Machinist, Tips Engine Works, 300 Baylor Street.
- 1944-45 Sloan E. and Lesa Loyd, renters
Assembler, Tips Engine Works, 300 Baylor Street.
- 1941 Lewis M. and Mary Sawyer, renters
Lineman
- 1939 Gus E. and Fronie Almquist, renters
Carpenter, Stephen F. Austin Hotel, 7th Street and Congress Avenue.
- Murrah R. and Florine Withers, renters
Trimmer, Piland & Elliott, auto repair, 5th and Trinity Streets.
- 1937 Cecil A. and Olive Mazingo, renters
Electrician, R.W. Gissell, plumbing, heating, and electrical contractor, 1706 S. Congress Avenue.
- 1935 James J. and Bertie Farrell, renters
No occupation listed
Also listed is James J. Farrell, Jr., no occupation shown.
- 1932-33 William J. and Viola Cloer, renters
No occupation listed
Also listed are Annis Cloer and J.G. Cloer; neither had an occupation shown.
- 1930-31 The address is not listed in the directory.
NOTE: William J. and Viola Cloer are listed at 1810 Nickerson Street; he was a carpenter. Listed with them were Annis Cloer and J.T. Cloer; neither had an occupation shown.

BIOGRAPHICAL NOTES

William J. and Viola Cloer (ca. 1931 – ca. 1934)

The 1930 U.S. Census shows William J. and Viola Cloer as the renters of the house at 1810 Nickerson. William J. Cloer was 51, had been born in Tennessee, and was a house carpenter.

Viola Cloer was also 51, had been born in Texas, and had no occupation listed. They had 3 children: Annie, 17, a helper in a book bindery; J.T., 21, an auto mechanic; and Milton, 15, a helper in a produce company. All of the children had been born in Texas. They also had a lodger, Emil Bernhard, 70, who had been born in Texas to German-born parents, and had no occupation listed.

His 1918 World War I draft registration card shows William Jonas Cloer as living at Lott, Falls County, Texas, where he was a self-employed farmer. He was born in 1876, was of medium height and build, and had blue eyes and gray hair.



Obituary of William Cloer
 Austin American, October 19, 1961

1940 U.S. Census

The 1940 U.S. Census shows G.E. and Fronie Almquist as the renters of this house. G.E. Almquist was 34, had been born in Texas, and was a carpenter in building construction. Fronie Almquist was 26, had been born in Texas, and was a beauty operator in a beauty shop. They had a son, Steve, 5. With them lived G.E.'s brother, Eric Almquist, 21, who was a Texas-born painter for a hotel company.

Also listed as renters at this address are G.L. and Marie Pope. G.L. Pope was 30, had been born in Texas, and was a salesman for an auto supply store. Marie Pope was 23, had been born in Texas, and had no occupation listed. They had 2 sons: James, 3; and Gwendel, 1, both of whom had been born in Texas.

Connecting Charge \$ 12.00 No 10249A

Application for Sewer Connection.

Austin, Texas, 7-13-1931

To the Superintendent of Sewer and Public Improvements,
City of Austin, Texas.

Sir:-

I hereby make application for sewer connection and instructions on premises
owned by N.A. Dawson
at 1007 W. Mary Street
Lot 8 & 7-BLK 9 residence
which place is to be used as a residence

In this place there are to be installed 1 fixtures.

I agree to pay the City Sewer Department the regular ordinance charge.

2.00 Cash Respectfully, N.A. Dawson
\$ 2.00 per mo. with water bill until paid

Location of Public Sewer Sewer in St. Partially Relined
and elements 15"
Stub Out 4" C.I. with
Connected 7-20 1931 OK 15" 4" pipe
Size of Main 6 inches 7/13/31 tested 12"
Size of Service 4 inches 1" pipe 15"
to
6 Feet Deep NC 39 E. 100'
3.6 Feet from Property Line in St. 2.5 D.
Feet from Curb Line

Inspected by Alex. Boatright

Connection made by h. n. m. s. A-182

RICHTER-AUSTIN

Sewer connection application for this address by N.A. Dawson (1931)