

HISTORIC LANDMARK COMMISSION
SEPTEMBER 26, 2016
DEMOLITION AND RELOCATION PERMITS
HDP-2016-0603
3406 BONNIE ROAD

PROPOSAL

Demolish a ca. 1952 house.

ARCHITECTURE

One-story, rectangular-plan, mansard- and flat-roofed frame house with single 1:1 and fixed-sash fenestration; partial-width flat-roofed wraparound porch.

RESEARCH

The house was built in 1952; the first owners and occupants were Marvin and June Self, who lived here until around 1963. Marvin Self was a salesman at Montgomery Ward; June Self worked in the diamond department at Kruger's Jewelry. They later moved to the Houston area. From around 1963 to around 1970, the house was owned and occupied by Rupert and Clara Strawn. Rupert Strawn was a pharmacist. The house was a rental property after that.

STAFF COMMENTS

The house is beyond the bounds of any City survey.

STAFF RECOMMENDATION

Release the permit. The house has been substantially modified since the time of its original construction, and lacks the requisite historical and architectural significance for designation as a historic landmark.

LOCATION MAP

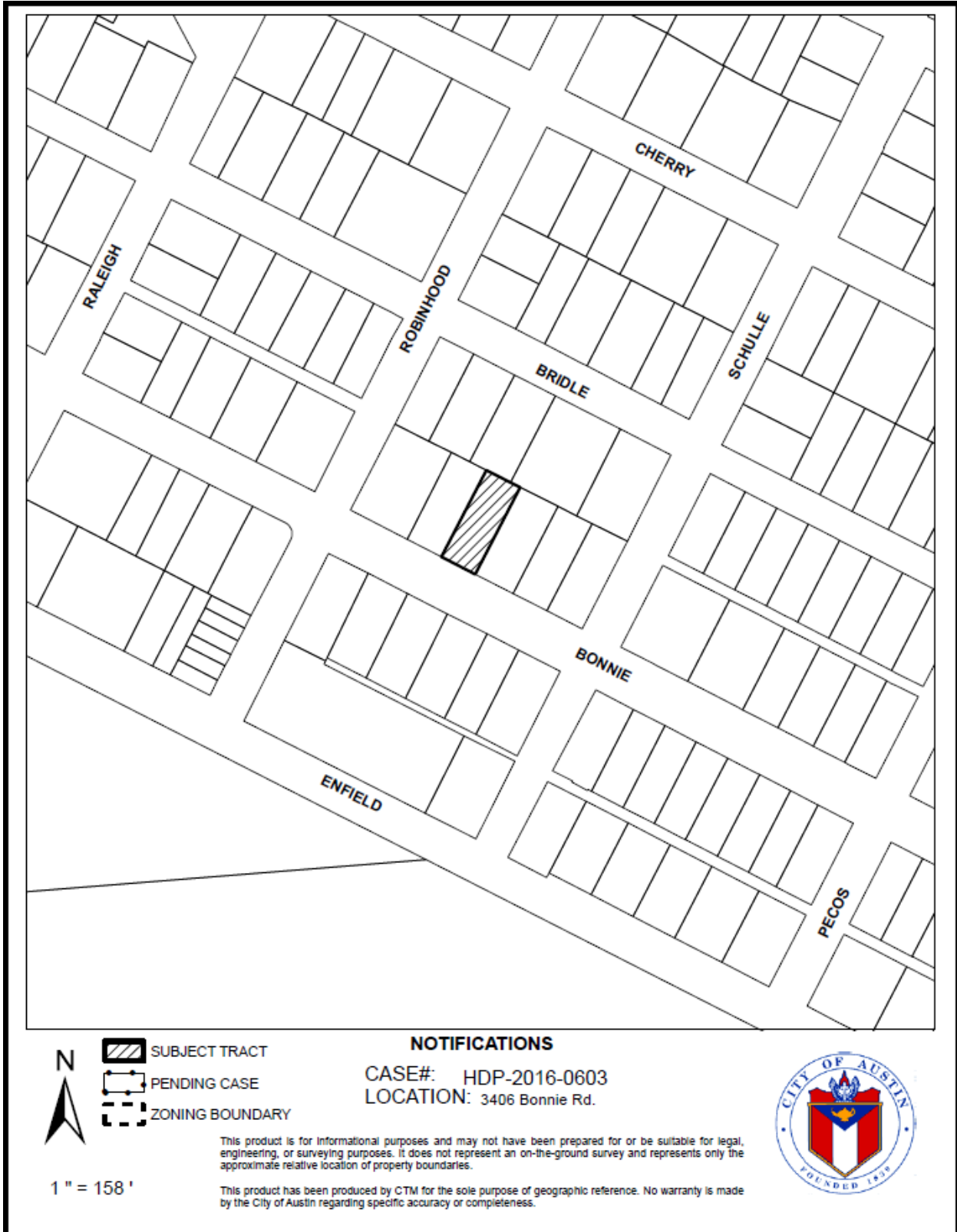

3406 Bonnie Road
ca. 1952



OCCUPANCY HISTORY 3406 Bonnie Road

City Directory Research, Austin History Center
By City Historic Preservation Office
August, 2016

- 1992 Edward and Neena Selig, renters
Manager, Texas Energy Research Association (no listing in the alphabetical section of the directory).
- 1985-86 Edward and Neena Selig, renters
Editor, State Energy Office
- 1981 Edward and Neena Selig, renters
Editor, State Energy Office
- 1977 Kirsten Weiss, renter
Checker, Foodland, supermarket (multiple locations)
NOTE: Edward and Neena Selig are listed at 1507 Pease Road, Apartment 2; he was a consultant.
- 1973 Larry W. and Mary A. Eckiert, owners
Unit director, Meridell Achievement Center (no listing in the alphabetical section of the directory).
- 1968 Rupert H. and Clara Strawn, owners

- Pharmacist, White Pharmacy, 523 Congress Avenue.
- 1965 Rupert H. and Clara Strawn, owners
Pharmacist, White Pharmacy, 523 Congress Avenue.
- 1962 Marvin C. and June Self, owners
Department manager, Montgomery Ward, department store, Capital Plaza.
NOTE: Rupert H. and Clara Strawn are listed at 3401 Oakmont Boulevard; he was a pharmacist for Renfro Drug Store (multiple locations).
- 1959 Marvin C. and C. June Self, owners
Marvin: Department manager, Montgomery Ward, department store, 409 Congress Avenue.
C. June: Saleslady, Kruger Jewelry, 722 Congress Avenue and 2236 Guadalupe Street.
- 1955 Marvin C. and June Self, owners
Marvin: Salesman, Montgomery Ward, department store, 409 Congress Avenue.
June: Clerk, Kruger Jewelry, 722 Congress Avenue and 2236 Guadalupe Street.
- 1954 Marvin and June Self, owners
Marvin: Salesman
June: Clerk, Kruger Jewelry, 722 Congress Avenue.
- 1953 Marvin and June Self, owners
Marvin: Salesman, Montgomery Ward, department store, 409 Congress Avenue.
June: Department manager, Kruger Jewelry, 722 Congress Avenue.
- 1952 The address is not listed in the directory.
NOTE: Marvin C. and June Self are listed at 2009 Peach Tree Street; he was a salesman for Montgomery Ward.

BIOGRAPHICAL NOTES

Marvin C. and June Self (ca. 1952 – ca. 1963)

Marvin Self, Jr. appears in the 1940 U.S. Census as the 17-year old son of Marvin and Edith Self, who rented their house at 3807 Duval Street in Austin. Marvin Self, Jr. was born in Texas and had no occupation listed. His father was a Texas-born insurance checker. His mother had no occupation listed. Marvin, Jr.'s older sister, Louise, 21, was a typist for a department store. The family had lived in Waco in 1935.

Cora June Self died in Harris County in 1982. Her death certificate shows that she was living in Spring, Texas at the time of her death. She had been born in Ohio in 1920 and was a diamond department manager for a jewelry store. She died from a crushed chest suffered in a motor vehicle accident. Marvin V. "Bub" Self, Jr. died in Houston in 2003.

Rupert and Clara Strawn (ca. 1963 – ca. 1970)

Rupert Strawn's 1973 death certificate shows that he was living in Burnet, Texas at the time of his death. He was born in Greenville, Texas in 1904 and was a pharmacist.

C. T. Johnson 3406 Bonnie Road
 143 East 36.8' of 5 & West 18.4' of 4 6 - -
 Walsh Place
 Frame residence and carport attached.
 50513 3-28-52 \$11,500.00
 Owner

5

Building permit to C.T. Johnson for the construction of this house (1952)

W 18.4' of 4 & E 36.8' of 5 - BK 6 *NW II* *143*

WATER SERVICE PERMIT

Austin, Texas

D No 5807

INDEXED

Received of C. T. JOHNSON Date 3-28-52

Address 3406 BONNIE RD.

Amount TWENTY THOUSAND \$ 20 00

Plumber W. H. PITTSFORD Size of Tap 3/4"

Date of Connection	No. Fittings	Size	Description
<u>4-2-52</u>	<u>1</u>	<u>3/8"</u>	<u>Curb Cock</u>
<u>Size of Tap Made</u> <u>3/4"</u>	<u>1</u>	<u>3/4"</u>	<u>Elbow</u>
<u>Size Service Made</u> <u>3/4"</u>	<u>1</u>	<u>3/4"</u>	<u>St. Elbow</u>
<u>Size Main Tapped</u> <u>6" C.I.</u>	<u>1</u>	<u>3/4"</u>	<u>Boasting</u>
<u>From Front Prop. Line to Curb Cock</u> <u>9.5'</u>			<u>Reducer</u>
<u>From E- Prop. Line to Curb Cock</u> <u>15'</u>			<u>28 Pipe</u>
<u>Location of Meter</u> <u>CURB</u>			<u>Lead Comp.</u>
<u>Type of Box</u> <u>LOCK</u>			<u>Nipples</u>
<u>Depth of Main in St.</u> <u>3'</u>			<u>Union</u>
<u>Depth of Service Line</u> <u>2'</u>			<u>Plug</u>
<u>From Curb Cock to Tap on Main</u> <u>26'</u>			<u>1 Tee</u>
<u>Checked by Engr. Dept.</u> <u>5-6-52 RC</u>			<u>1 Stop</u>
			<u>1 Box</u>
			<u>1 Lid</u>
			<u>Valves</u>
			<u>Job No. 20323-502</u>
			<u>Req. No. 20323-502</u>

INDEXED

Water service permit to C.T. Johnson for this address (1952)

SANITARY SEWER SERVICE PERMIT

No. 29846

Austin, Texas

KW/TT

Received of W.H. PITTSFORD Date 3-28-52

Address 3406 BONNIE RD.

Amount _____ \$ _____

Builder or Owner _____ Plumber _____

Lot E. 36.8' of 5+ Block 6 Subdivision WALSH PLACE Plat No. 143
W. 18.4' OF 4

Date of Connection	<u>5-29-52</u>	No. Fittings Price Size Pipe Pipe Wyes Bends Reducers Plugs Sand Gravel Remix Stoppers Castings Other 1-HR TRUCK Labor: 2 Hrs. 1 HR.
By City	<u>1 1/2' E/WLL</u>	
By Plumber	_____	
Checked By	<u>STRONG</u>	
Size Main	<u>6"</u> Depth <u>4'</u>	
Main Assign.	<u>10' N/SPL</u>	
Stub Depth	_____ Prop. Line <u>3'</u>	
Stub Location	_____	
Book No.	<u>A-1688</u>	
Paving Cut	_____ No. _____	
		1.0 6x6 Conc. .40 1.80 1.40 70

Sewer service permit for this address (1952)