

**APPLICATION FOR APPROVAL OF A SIGN IN NATIONAL REGISTER DISTRICTS
OR AT A CITY HISTORIC LANDMARK**

City of Austin Historic Preservation Office

(A separate form is required for each proposed sign on the building or site)

ADDRESS of Proposed Sign: 811 Live Oak St. Austin, TX 78704 Date of Application: September 28, 2016

APPLICANT:

Name: Greg Porter, AC Urban LLC
Address: 209 E Live Oak St.
Austin, TX 78704
Phone: (512) 971-9792
Fax: ()
E-mail: gporter@acurban.com

SIGN COMPANY:

Name: The Neon Jungle
Address: 1202 S. Congress Ave
Austin, TX 78704
Phone: (512) 680-0809
Fax: ()
E-mail: theneonjungle@gmail.com

SIGN TYPE:

Flush mounted Projecting (Blade) Window Awning Directory Free-standing

SIZE OF SIGN: Height: 18" Width: 30" Depth: 8" Total sign area: 3.75 sq. ft.

MATERIALS AND FINISH OF SIGN: Steel, painted finish

SIGN COLORS: Farrow & Ball, Railings 31; Farrow & Ball, Strong White 2001, See attached spec

SIGN LIGHTING TYPE: outrigger lamp, wash SIGN INSTALLATION METHOD: Hung from existing apparatus

SIGN CONTENT (Include name of establishment, size of letters, size of logo):

Mattie's 5" script
at Green Pastures 1" Letter

TURN THIS FORM IN TO CITY HISTORIC PRESERVATION OFFICE, ONE TEXAS CENTER, 505 BARTON SPRINGS ROAD AT LEAST 14 DAYS PRIOR TO HISTORIC LANDMARK COMMISSION MEETING WITH ALL OF THE FOLLOWING:

1. One color depiction of the sign itself on 8½" x 11" paper showing the design, colors, lighting, materials, and ALL dimensions of the sign (height, width and depth), as well as mounting detail (unless using existing mounting apparatus).
2. One dimensioned drawing on 8½" x 11" paper showing the exact placement of the sign on the building. For projecting and awning signs, show the distance from the bottom of the sign to the sidewalk. For awning, window, and flush-mounted signs, show the dimensions of the façade, window, or awning, as appropriate. For free-standing signs, include a dimensioned site layout showing the proposed placement of the sign on the site and its relationship to other buildings and landscape features.
3. Color photographs showing the location of the proposed sign.
4. Paint chip or surface finish sample for all proposed sign surfaces.

ONLY COMPLETED APPLICATIONS WITH ALL REQUIRED EXHIBITS CAN BE ACCEPTED AND REVIEWED.

Greg Porter *Mattyer AC 011 Mattyer LLC* *Mattyer AC 011 Mattyer LLC*
Signature of Property Owner/Agent (Required) *Greg Porter* *Mattyer AC 011 Mattyer LLC*
Signature of Applicant (Required)

CITY USE ONLY: Case No. _____ HLC Date: _____

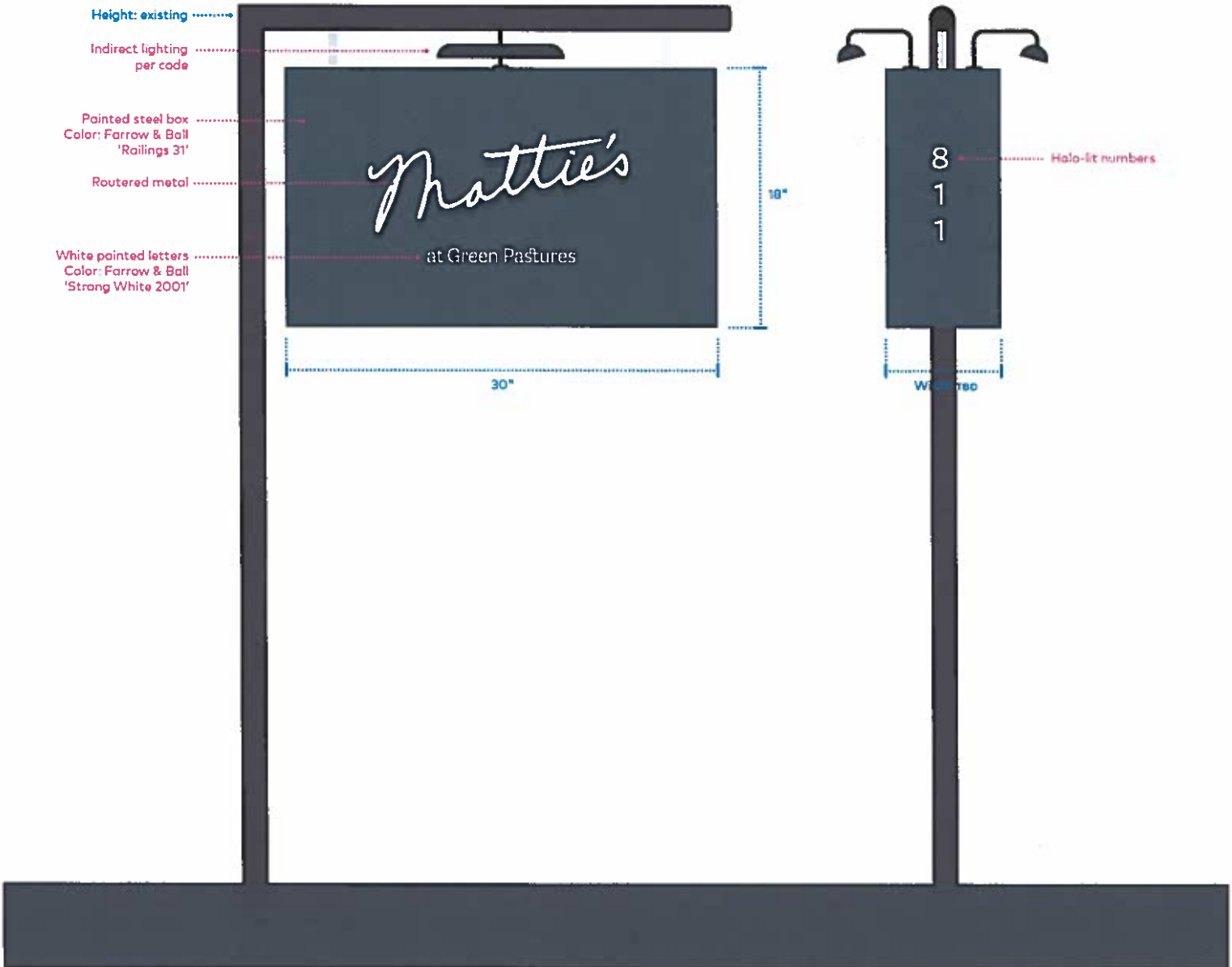

Mattie's

at Green Pastures

8
1
1

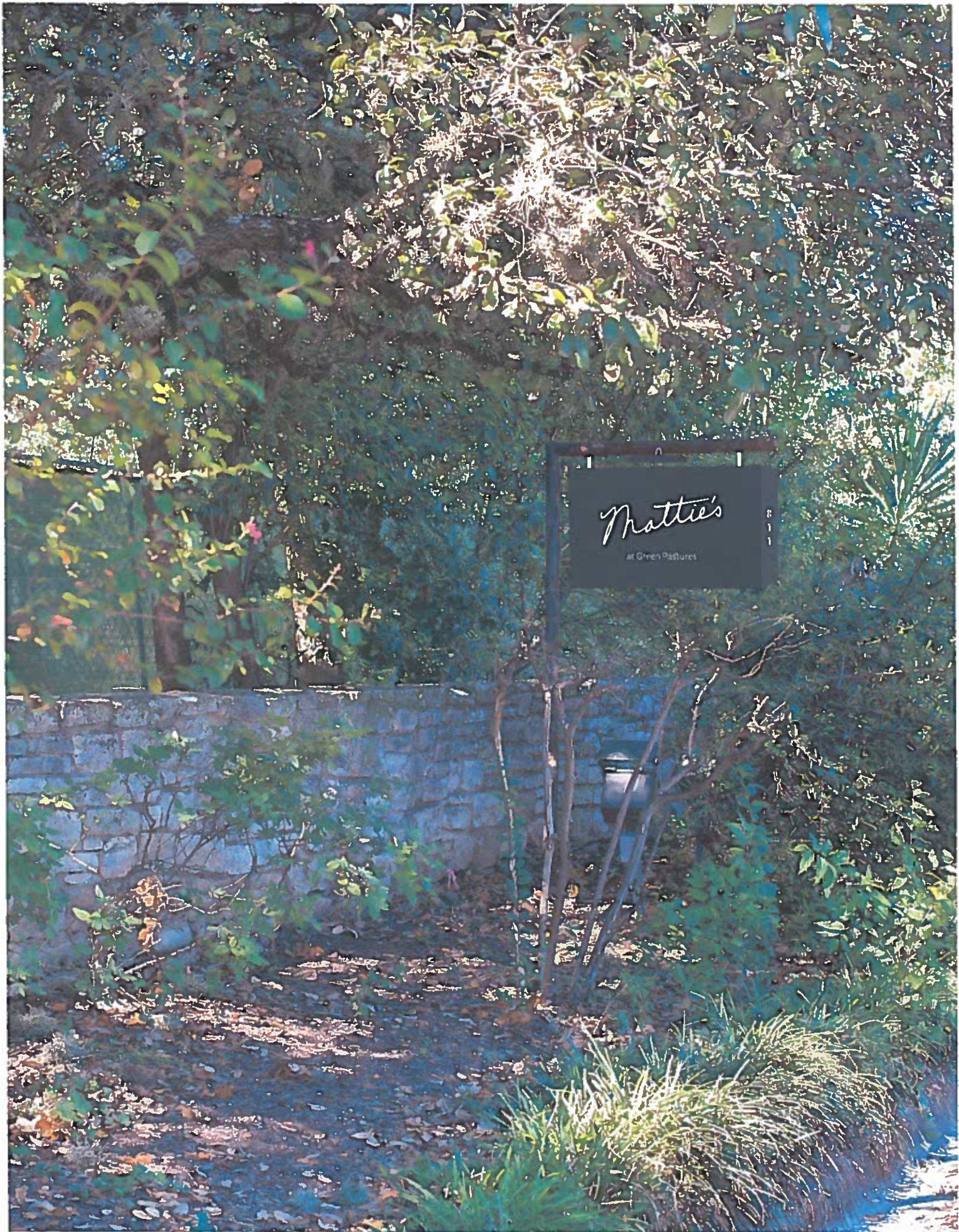

Mattie's

at Green Pastures

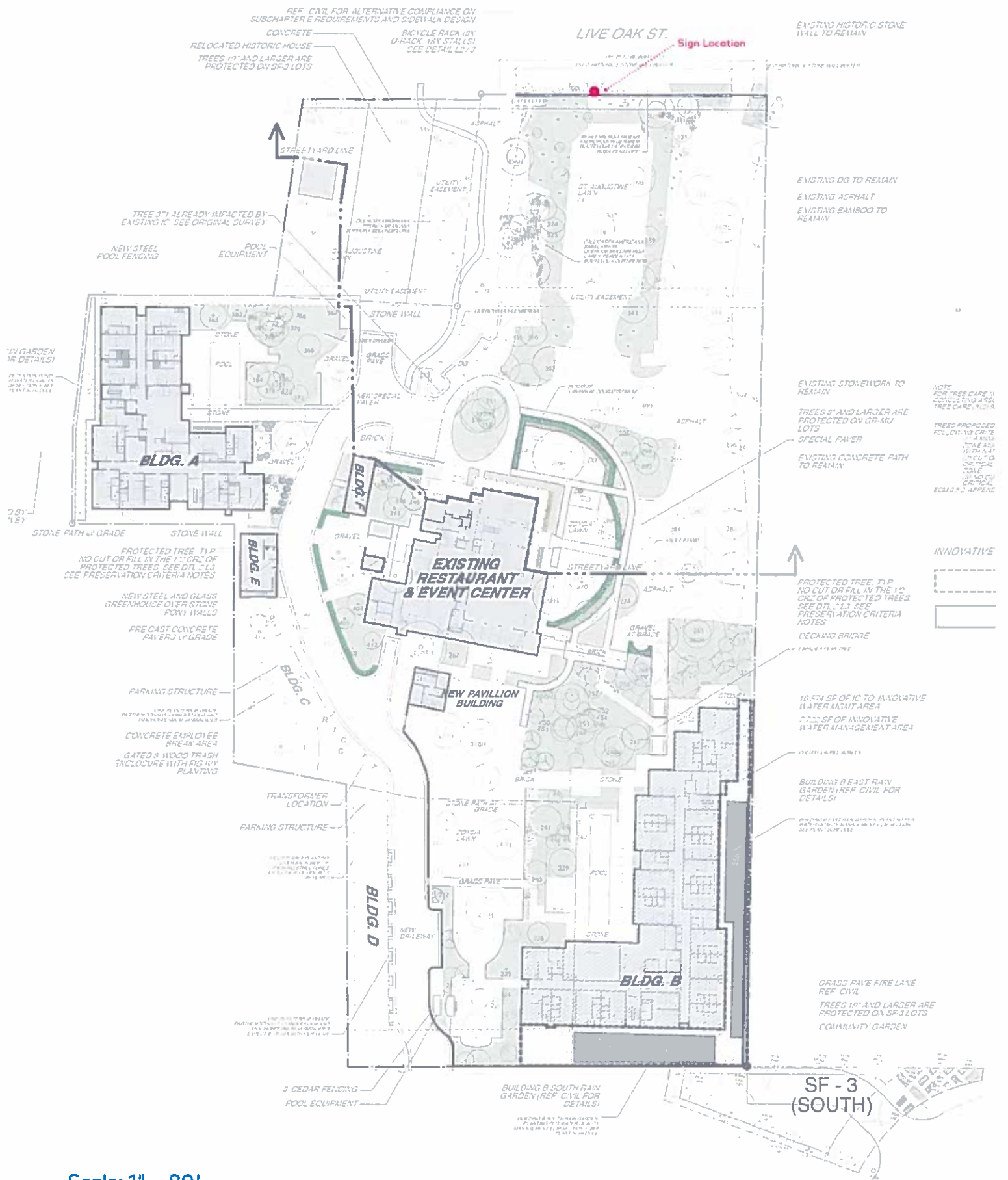

Scale: 1" = 80'